



The State of New Hampshire
Department of Environmental Services



Robert R. Scott, Commissioner

August 27, 2019

His Excellency, Governor Christopher T. Sununu
 and The Honorable Council
 State House
 Concord, NH 03301

REQUESTED ACTION

Approve Jean Ellen Sullivan Trust's request to perform the following work on Lake Winnepesaukee in Moultonborough. File # 2019-01071. This project will not have significant impact on or adversely affect the values of Lake Winnepesaukee.

Install 6 foot x 40 foot seasonal pier, single seasonal boatlift and two personal watercraft lifts 62 feet to the west of an existing 68 linear foot curved breakwater with a 4 foot x 70 foot cantilevered pier on an average of 173 linear feet of frontage along Lake Winnepesaukee on Long Island in Moultonborough.

The New Hampshire Department of Environmental Services (NHDES) imposed the following conditions as part of this approval:

1. All work shall be in accordance with revised plans by Watermark Marine Construction revision dated July 10, 2019 and received by the NH Department of Environmental Services (NHDES) on July 10, 2019.
2. This permit is not valid and effective until it has been recorded with the appropriate county Registry of Deeds by the applicant. Prior to starting work under this permit, the permittee shall submit a copy of the recorded permit to the NHDES Wetlands Program by certified mail, return receipt requested.
3. No work is authorized to the existing 68 linear foot curved breakwater with a 4 foot x 70 foot cantilevered pier.
4. All development activities associated with this project shall be conducted in compliance with applicable requirements of RSA 483-B and N.H. Code of Administrative Rules Env-Wq 1400 during and after construction.
5. Work shall be carried out in a time and manner to avoid disturbances to migratory waterfowl breeding and nesting areas.
6. Appropriate siltation and erosion controls shall be in place prior to construction, shall be maintained during construction, and shall remain until the area is stabilized. Temporary controls shall be removed once the area has been stabilized.
7. Appropriate turbidity controls shall be installed prior to construction, shall be maintained during construction such that no turbidity escapes the immediate dredge area and shall remain until suspended particles have settled and water at the work site has returned to normal clarity.
8. All excavated material and construction-related debris shall be placed outside of the areas subject to RSA 482-A. Any spoil material deposited within 250 feet of any surface water shall comply with RSA-483-B.
9. The permittee's contractor responsible for completion of the work shall use techniques described in the New Hampshire Stormwater Manual, Volume 3, Erosion and Sediment Controls During Construction (December 2008).
10. Only those structures shown on the approved plans shall be installed or constructed along this frontage. All portions of the structures, shall be at least 20 feet from the abutting property lines or the imaginary extension of those lines into the water.

www.des.nh.gov

29 Hazen Drive • PO Box 95 • Concord, NH 03302-0095

NHDES Main Line: (603) 271-3503 • Subsurface Fax: (603) 271-6683 • Wetlands Fax: (603) 271-6588

TDD Access: Relay NH 1 (800) 735-2964

11. Any subdivision of the property frontage will require removal of a sufficient portion of the docking structures to comply with the dock size and density requirements in effect at the time of the subdivision.
12. All seasonal structures shall be removed for the non-boating season.
13. No portion of the proposed seasonal pier shall extend more than 40 feet from the shoreline at full lake elevation (Elevation 504.32).

EXPLANATION

The NHDES approved this project on July 25, 2019. The NHDES supported its decision with the following findings:

1. This is a major impact project per Administrative Rule Env-Wt 303.02(d), construction of any docking structure adjacent to a breakwater.
2. The applicant has provided evidence which demonstrates that this proposal is the alternative with the least adverse impact to areas and environments under the department's jurisdiction per Env-Wt 302.03.
3. The applicant has demonstrated by plan and example that each factor listed in Env-Wt 302.04(a) Requirements for Application Evaluation, has been considered in the design of the project.
4. The NHDES finds that because the project is not of significant public interest and will not significantly impair the resources of Lake Winnepesaukee a public hearing under RSA 482-A:8 is not required.
5. The applicant has an average of 173 linear feet of shoreline frontage along Lake Winnepesaukee in Moultonborough.
6. The proposed docking facilities will provide 3 slips as defined per RSA 482-A:2, VIII and therefore meets Rule Env-Wt 402.13.

Application file documents are being forwarded to the Governor and the Executive Council in connection with their consideration of this matter pursuant to RSA 482-A:3,II.(a) as it is a major project in public waters of the state.

Respectfully submitted,



Robert R. Scott
Commissioner



WETLANDS PERMIT APPLICATION

Water Division/ Wetlands Bureau
Land Resources Management

Check the status of your application: www.des.nh.gov/onestop



RSA 482-A:17 Env-Wt 100-90

RECEIVED APR 11 2019 NHDES LAND RESOURCES MANAGEMENT	INCOMPLETE APR 11 2019 NHDES	RECEIVED APR 22 2019 NHDES LAND RESOURCES MANAGEMENT	File No: 2019-01071 CR# 19466 Amount: \$ 440.00 Date: 5/27/19
--	---	--	--

1. REVIEW TIME: Indicate your Review Time below. To determine review time, see www.des.nh.gov/landresourcesmanagement for instructions.

Standard Review (Minimum, Minor or Major Impact)
 Expedited Review (Minimum Impact only)

2. MITIGATION REQUIREMENT:
If mitigation is required, a Mitigation-Pre Application meeting must occur prior to submitting this Wetlands Permit Application. To determine if mitigation is required, please refer to the Determine if Mitigation is Required Frequently Asked Questions.

Mitigation Pre-Application Meeting Date: Month: ___ Day: ___ Year: ___
 N/A - Mitigation is not required

3. PROJECT LOCATION:
Separate wetland permit applications must be submitted for each municipality within which wetland impacts occur.

ADDRESS: **14 Captain's Walk** TOWN/CITY: **Moultonborough**

TAX MAP: **278** BLOCK: **003** LOT: **000** UNIT: **000**

USGS TOPO MAP WATERBODY NAME: **Lake Winnepesaukee** NA STREAM WATERSHED SIZE: NA

LOCATION COORDINATES (If known): Easting: _____ Northing: _____
 Latitude/Longitude UTM State Plane

4. PROJECT DESCRIPTION:
Provide a brief description of the project outlining the scope of work. Attach additional sheets as needed to provide a detailed explanation of your project. DO NOT reply "See Attached" in the space provided below.

Install a 6ft x 40ft seasonal dock, a seasonal boatlift and two seasonal PWC lifts. No work proposed to existing or previously approved shoreline structures.

5. SHORELINE FRONTAGE:

N/A This does not have shoreline frontage. SHORELINE FRONTAGE: **150ft**

Shoreline Frontage is calculated by determining the average of the distances of the actual natural navigable shoreline frontage and a straight line drawn between the property lines, both of which are measured at the normal high water line (Env-Wt 101.89).

6. RELATED NHDES LAND RESOURCES MANAGEMENT PERMIT APPLICATIONS ASSOCIATED WITH THIS PROJECT:
Please indicate if any of the following permit applications are required and, if required, the status of the application. To determine if other Land Resources Management Permits are required, refer to the Land Resources Management Webpage.

Permit Type	Permit Required	File Number	Permit Application Status
Alteration of Terrain Permit Per RSA 485-A:17	<input type="checkbox"/> YES <input checked="" type="checkbox"/> NO	_____	<input type="checkbox"/> APPROVED <input type="checkbox"/> PENDING <input type="checkbox"/> DENIED
Individual Sewerage Disposal per RSA 485-A:2	<input type="checkbox"/> YES <input checked="" type="checkbox"/> NO	_____	<input type="checkbox"/> APPROVED <input type="checkbox"/> PENDING <input type="checkbox"/> DENIED
Subdivision Approval Per RSA 485-A	<input type="checkbox"/> YES <input checked="" type="checkbox"/> NO	_____	<input type="checkbox"/> APPROVED <input type="checkbox"/> PENDING <input type="checkbox"/> DENIED
Shoreland Permit Per RSA 483-B	<input type="checkbox"/> YES <input checked="" type="checkbox"/> NO	_____	<input type="checkbox"/> APPROVED <input type="checkbox"/> PENDING <input type="checkbox"/> DENIED

7. NATURAL HERITAGE BUREAU & DESIGNATED RIVERS
See the Instructions & Required Attachments document for instructions to complete a & b below.

a. Natural Heritage Bureau File ID: **NHB 19 - 1065**

b. This project is within a Designated River corridor. The project is within 1/4 mile of: _____; and date a copy of the application was sent to the Local River Management Advisory Committee: Month: ___ Day: ___ Year: ___

N/A - This project is not within a Designated River corridor.

irm@des.nh.gov or (603) 271-2147

NHDES Wetlands Bureau, 29 Hazen Drive, PO Box 95, Concord, NH 03302-0095

www.des.nh.gov

8. APPLICANT INFORMATION (Desired permit holder)

LAST NAME, FIRST NAME, M.I.: Sullivan, Kevin and Jean Ellen

TRUST / COMPANY NAME: Jean Ellen Sullivan Trust

MAILING ADDRESS:

TOWN/CITY: -

STATE:

ZIP CODE:

EMAIL or FAX: N/A

PHONE: N/A

ELECTRONIC COMMUNICATION: By initialing here: N/A, I hereby authorize NHDES to communicate all matters relative to this application electronically.

9. PROPERTY OWNER INFORMATION (if different than applicant)

LAST NAME, FIRST NAME, M.I.: Sullivan, Kevin and Jean Ellen

TRUST / COMPANY NAME: Jean Ellen Sullivan Trust

MAILING ADDRESS:

TOWN/CITY:

STATE:

ZIP CODE: (

EMAIL or FAX: N/A

PHONE: N/A

ELECTRONIC COMMUNICATION: By initialing here N/A, I hereby authorize NHDES to communicate all matters relative to this application electronically.

10. AUTHORIZED AGENT INFORMATION

LAST NAME, FIRST NAME, M.I.: Irving, Jamie C.

COMPANY NAME: Watermark Marine Construction

MAILING ADDRESS: 1218 Union Avenue

TOWN/CITY: Laconia

STATE: NH

ZIP CODE: 03246

EMAIL or FAX: jci@watermarkmarine.com

PHONE: 603-293-4000

ELECTRONIC COMMUNICATION: By initialing here JCI, I hereby authorize NHDES to communicate all matters relative to this application electronically.

11. PROPERTY OWNER SIGNATURE:

See the Instructions & Required Attachments document for clarification of the below statements

By signing the application, I am certifying that:

1. I authorize the applicant and/or agent indicated on this form to act in my behalf in the processing of this application, and to furnish upon request, supplemental information in support of this permit application.
2. I have reviewed and submitted information & attachments outlined in the Instructions and Required Attachment document.
3. All abutters have been identified in accordance with RSA 482-A:3, I and Env-Wt 100-900.
4. I have read and provided the required information outlined in Env-Wt 302.04 for the applicable project type.
5. I have read and understand Env-Wt 302.03 and have chosen the least impacting alternative.
6. Any structure that I am proposing to repair/replace was either previously permitted by the Wetlands Bureau or would be considered grandfathered per Env-Wt 101.47.
7. I have submitted a Request for Project Review (RPR) Form (www.nh.gov/nhdhr/review) to the NH State Historic Preservation Officer (SHPO) at the NH Division of Historical Resources to identify the presence of historical/ archeological resources while coordinating with the lead federal agency for National Historic Preservation Act (NHPA) 106 compliance.
8. I authorize NHDES and the municipal conservation commission to inspect the site of the proposed project.
9. I have reviewed the information being submitted and that to the best of my knowledge the information is true and accurate.
10. I understand that the willful submission of falsified or misrepresented information to the NHDES is a criminal act, which may result in legal action.
11. I am aware that the work I am proposing may require additional state, local or federal permits which I am responsible for obtaining.
12. The mailing addresses I have provided are up to date and appropriate for receipt of NHDES correspondence. NHDES will not forward returned

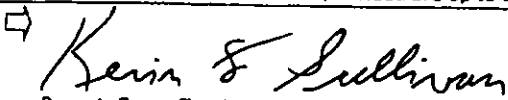
Property Owner Signature

Kevin F. Sullivan
Print name legibly

4/5/2019
Date

irm@des.nh.gov or (603) 271-2147

NHDES Wetlands Bureau, 29 Hazen Drive, PO Box 95, Concord, NH 03302-0095

www.des.nh.gov

MUNICIPAL SIGNATURES

12. CONSERVATION COMMISSION SIGNATURE

The signature below certifies that the municipal conservation commission has reviewed this application, and:

1. Waives its right to intervene per RSA 482-A:11;
2. Believes that the application and submitted plans accurately represent the proposed project; and
3. Has no objection to permitting the proposed work.

	Print name legibly	Date
--	--------------------	------

DIRECTIONS FOR CONSERVATION COMMISSION

1. Expedited review ONLY requires that the conservation commission's signature is obtained in the space above.
2. Expedited review requires the Conservation Commission signature be obtained prior to the submittal of the original application to the Town/City Clerk for signature.
3. The Conservation Commission may refuse to sign. If the Conservation Commission does not sign this statement for any reason, the application is not eligible for expedited review and the application will be reviewed in the standard review time frame.

13. TOWN / CITY CLERK SIGNATURE

As required by Chapter 482-A:3 (amended 2014), I hereby certify that the applicant has filed four application forms, four detailed plans, and four USGS location maps with the town/city indicated below.

	Julia Marchand <small>Print name legibly</small>	Moultonboro <small>Town/City</small>	4.9.19 <small>Date</small>
--	---	---	-------------------------------

DIRECTIONS FOR TOWN/CITY CLERK:

Per RSA 482-A:3,1

1. For applications where "Expedited Review" is checked on page 1, if the Conservation Commission signature is not present, NHDES will accept the permit application, but it will NOT receive the expedited review time.
2. IMMEDIATELY sign the original application form and four copies in the signature space provided above;
3. Return the signed original application form and attachments to the applicant so that the applicant may submit the application form and attachments to NHDES by mail or hand delivery.
4. IMMEDIATELY distribute a copy of the application with one complete set of attachments to each of the following bodies: the municipal Conservation Commission, the local governing body (Board of Selectmen or Town/City Council), and the Planning Board; and
5. Retain one copy of the application form and one complete set of attachments and make them reasonably accessible for public review.

DIRECTIONS FOR APPLICANT:

1. Submit the single, original permit application form bearing the signature of the Town/ City Clerk, additional materials, and the application fee to NHDES by mail or hand delivery.

14. IMPACT AREA:

For each jurisdictional area that will be/has been impacted, provide square feet and, if applicable, linear feet of impact.

Permanent: Impacts that will remain after the project is complete.

Temporary: Impacts not intended to remain (and will be restored to pre-construction conditions) after the project is completed.

Intermittent Streams: linear footage distance of disturbance is measured along the thread of the channel.

Perennial Streams/Rivers: the total linear footage distance is calculated by summing the lengths of disturbance to the channel and each bank.

JURISDICTIONAL AREA	PERMANENT Sq. Ft. / Lin. Ft.	TEMPORARY Sq. Ft. / Lin. Ft.
Forested wetland	<input type="checkbox"/> ATF	<input type="checkbox"/> ATF
Scrub-shrub wetland	<input type="checkbox"/> ATF	<input type="checkbox"/> ATF
Emergent wetland	<input type="checkbox"/> ATF	<input type="checkbox"/> ATF
Wet meadow	<input type="checkbox"/> ATF	<input type="checkbox"/> ATF
Intermittent stream channel	/ <input type="checkbox"/> ATF	/ <input type="checkbox"/> ATF
Perennial Stream / River channel	/ <input type="checkbox"/> ATF	/ <input type="checkbox"/> ATF
Lake / Pond	/ <input type="checkbox"/> ATF	/ <input type="checkbox"/> ATF
Bank - Intermittent stream	/ <input type="checkbox"/> ATF	/ <input type="checkbox"/> ATF
Bank - Perennial stream / River	/ <input type="checkbox"/> ATF	/ <input type="checkbox"/> ATF
Bank - Lake / Pond	/ <input type="checkbox"/> ATF	/ <input type="checkbox"/> ATF
Tidal water	/ <input type="checkbox"/> ATF	/ <input type="checkbox"/> ATF
Salt marsh	<input type="checkbox"/> ATF	<input type="checkbox"/> ATF
Sand dune	<input type="checkbox"/> ATF	<input type="checkbox"/> ATF
Prime wetland	<input type="checkbox"/> ATF	<input type="checkbox"/> ATF
Prime wetland buffer	<input type="checkbox"/> ATF	<input type="checkbox"/> ATF
Undeveloped Tidal Buffer Zone (TBZ)	<input type="checkbox"/> ATF	<input type="checkbox"/> ATF
Previously-developed upland in TBZ	<input type="checkbox"/> ATF	<input type="checkbox"/> ATF
Docking - Lake / Pond	<input type="checkbox"/> ATF	240 <input type="checkbox"/> ATF
Docking - River	<input type="checkbox"/> ATF	<input type="checkbox"/> ATF
Docking - Tidal Water	<input type="checkbox"/> ATF	<input type="checkbox"/> ATF
Vernal Pool	<input type="checkbox"/> ATF	<input type="checkbox"/> ATF
TOTAL	/	240 /

15. APPLICATION FEE: See the Instructions & Required Attachments document for further instruction

Minimum Impact Fee: Flat fee of \$200

Minor or Major Impact Fee: Calculate using the below table below

Permanent and Temporary (non-docking) _____ sq. ft. X \$0.20 = \$ _____

Temporary (seasonal) docking structure: **240** sq. ft. X \$1.00 = **\$ 240.00**

Permanent docking structure: _____ sq. ft. X \$2.00 = \$ _____

Projects proposing shoreline structures (including docks) add \$200 = **\$ 200.00**

Total = **\$ 440.00**

The Application Fee is the above calculated Total or \$200, whichever is greater = **\$ 440.00**



Sullivan Property

Moultonborough, NH



April 3, 2019

1 inch = 100 Feet

www.cai-tech.com

0 100 200 300

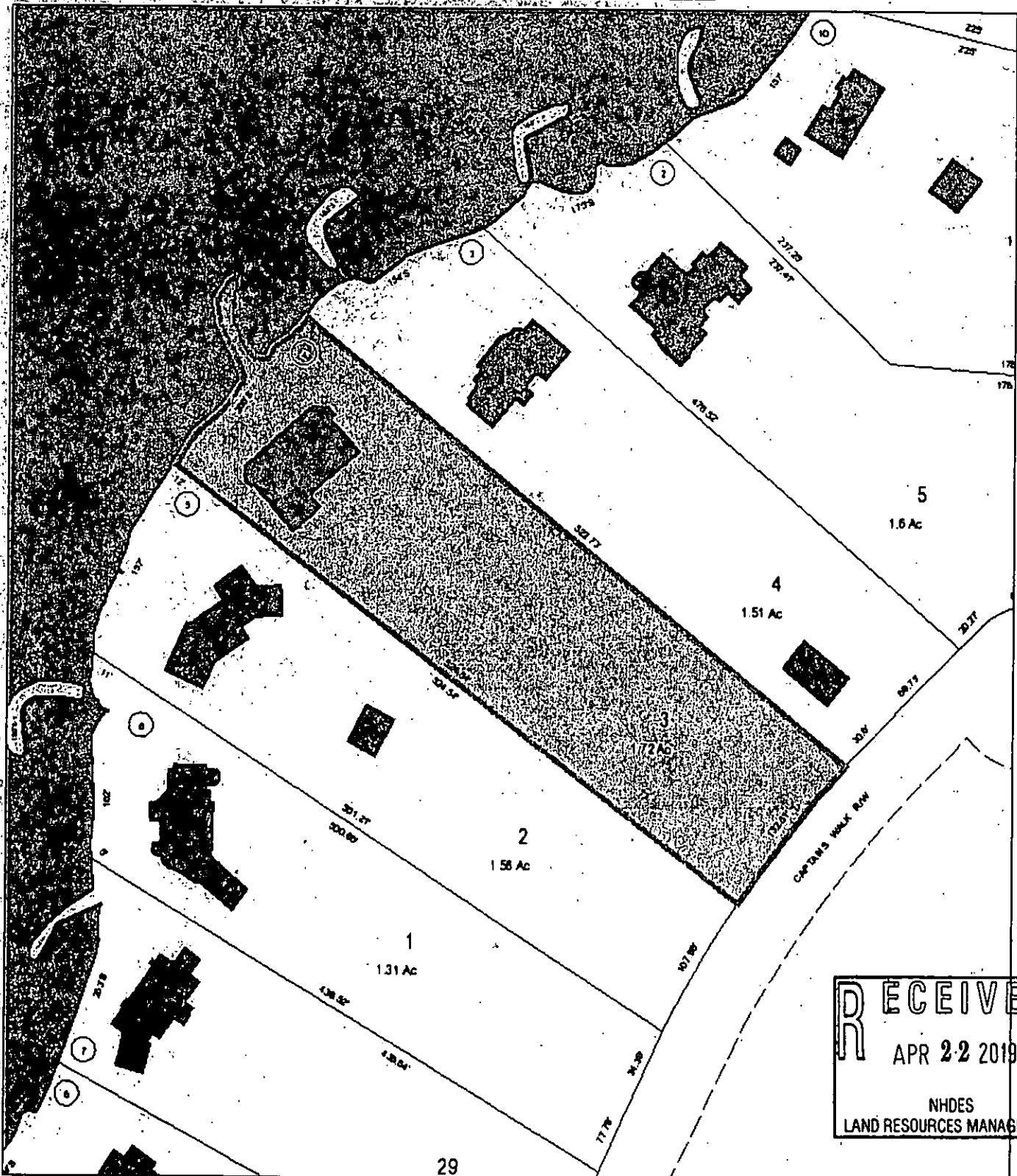

RECEIVED
 APR 22 2019
 NHDES
 LAND RESOURCES MANAGEMENT

Data shown on this map is provided for planning and informational purposes only. The municipality and CAI Technologies are not responsible for any use for other purposes or misuse or misrepresentation of this map.

Sullivan Property



Legend

- State
- County
- City/Town

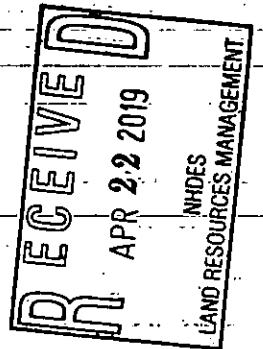

Map Scale

1:10,000



© NH GRANIT, www.granit.unh.edu

Map Generated: 4/4/2019

Notes

Kevin and Jean Ellen Sullivan
14 Captain's Walk, Moultonborough
TMA #278-003-000
NH Stateplane NAD83 (feet)
Easting: 1,066,480.95
Northing: 418,522.13





New Hampshire Natural Heritage Bureau

To: Jamie Irving
1218 Union Avenue
Laconia, NH 03246

Date: 4/5/2019

From: NH Natural Heritage Bureau

Re: Review by NH Natural Heritage Bureau of request dated 4/5/2019

NHB File ID: NHB19-1065

Applicant: Kevin and Jean Ellen Sullivan

Location: Tax Map(s)/Lot(s): #278-003-000
Moultonborough

Project Description: Install a 6ft x 40ft seasonal dock, a seasonal boatlift and two seasonal PWC lifts. No work proposed to existing or previously approved shoreline structures.

The NH Natural Heritage database has been checked for records of rare species and exemplary natural communities near the area mapped below. The species considered include those listed as Threatened or Endangered by either the state of New Hampshire or the federal government. We currently have no recorded occurrences for sensitive species near this project area.

A negative result (no record in our database) does not mean that a sensitive species is not present. Our data can only tell you of known occurrences, based on information gathered by qualified biologists and reported to our office. However, many areas have never been surveyed, or have only been surveyed for certain species. An on-site survey would provide better information on what species and communities are indeed present.

This report is valid through 4/4/2020.

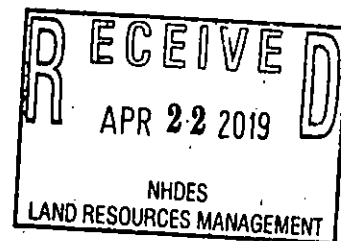



New Hampshire Natural Heritage Bureau

MAP OF PROJECT BOUNDARIES FOR NHB FILE ID: NHB19-1065

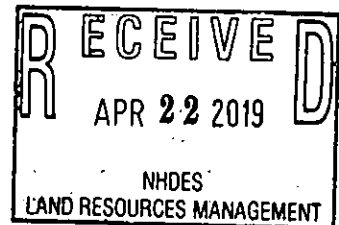



Abutters List Report

Moultonborough, NH
April 03, 2019

Subject Property:

Parcel Number: 278003000
CAMA Number: 278003000000000
Property Address: 14 CAPTAINS WALK Unit 000

Mailing Address: SULLIVAN JEAN ELLEN TRUST
SULLIVAN JEAN ELLEN & KEVIN F

Abutters:

Parcel Number: 278002000
CAMA Number: 278002000000000
Property Address: 18 CAPTAINS WALK Unit 000

Mailing Address: LAMARCHE CAROL B 2001 REV TRUST
LAMARCHE JAY R & CAROL B
TRUSTEES

Parcel Number: 278004000
CAMA Number: 278004000000000
Property Address: 8 CAPTAINS WALK Unit 000

Mailing Address: GARCEAU MICHAEL & ELIZABETH

7018 3090 0001 135A 3645 95E 1000 060E 9102

U.S. Postal Service™
CERTIFIED MAIL® RECEIPT
Domestic Mail Only

For delivery information, visit our website at www.usps.com®.

OFFICIAL USE

Certified Mail Fee \$ 3.50

Extra Services & Fees (check box, add fee as appropriate)

Return Receipt (hardcopy) \$

Return Receipt (electronic) \$

Certified Mail Restricted Delivery \$

Adult Signature Required \$

Adult Signature Restricted Delivery \$

Postage \$.50

Total Postage and Fees \$ 4.00

Jay and Carol LaMarche

APR 9 2019

See Reverse for Instructions

259E 95E 1000 060E 9102

U.S. Postal Service™
CERTIFIED MAIL® RECEIPT
Domestic Mail Only

For delivery information, visit our website at www.usps.com®.

OFFICIAL USE

Certified Mail Fee \$ 3.50

Extra Services & Fees (check box, add fee as appropriate)

Return Receipt (hardcopy) \$

Return Receipt (electronic) \$

Certified Mail Restricted Delivery \$

Adult Signature Required \$

Adult Signature Restricted Delivery \$

Postage \$.50

Total Postage and Fees \$ 4.00

Michael and Elizabeth Garceau

APR 9 2019

See Reverse for Instructions

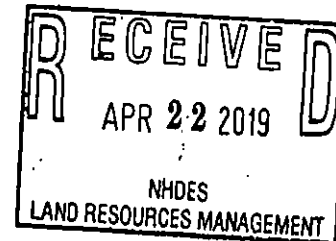

www.cai-tech.com

4/3/2019

Data shown on this report is provided for planning and informational purposes only. The municipality and CAI Technologies are not responsible for any use for other purposes or misuse or misrepresentation of this report.

Page 1 of 1

RECEIVED
 JUL 10 2019
 NHDES
 LAND RESOURCES MANAGEMENT

Lake Winnepesaukee

Full Lake Shoreline 504.32

