



Victoria F. Sheehan
Commissioner

THE STATE OF NEW HAMPSHIRE
DEPARTMENT OF TRANSPORTATION



William Cass, P.E.
Assistant Commissioner

His Excellency, Governor Christopher T. Sununu
and the Honorable Council
State House
Concord, New Hampshire 03301

Bureau of Right-of-Way
November 14, 2018

REQUESTED ACTION

Pursuant to RSA 4:39-c and 228:31, authorize the Department of Transportation to sell a parcel of State owned land consisting of a 0.19 +/- of an acre located on the southwesterly corner of NH Route 111 and NH Route 28 in the Town of Windham directly to the abutter, Rockingham Road Realty Trust, for \$25,000.00 plus a \$1,100.00 Administrative Fee, effective upon Governor and Executive Council approval.

The net proceeds are \$25,000.00. It has been determined by the Division of Finance that this parcel was originally purchased with 86.8% Federal Funds and 13.2% Highway Funds.

Funding is to be credited to the Highway Fund as follows:

04-096-096-960015-0000-UUU-402156 Administrative Fee	<u>FY 2019</u> \$1,100.00
04-096-096-960015-0000-UUU-409279 Sale of Parcel (13.2% of \$25,000.00)	<u>FY 2019</u> \$3,300.00
04-096-096-963515-3054-401771 Consolidated Federal Aid (86.8% of \$25,000.00)	<u>FY 2019</u> \$21,700.00

EXPLANATION

The Department of Transportation has received a request from an abutter, Rockingham Road Realty Trust, requesting the opportunity to purchase a 0.19 +/- of an acre parcel of State owned land located on the southwesterly corner of NH Route 111 and NH Route 28 in the Town of Windham.

This parcel was acquired in 1998 and is the remnant of a larger parcel used for the re-construction of NH Route 111 for the Windham-Salem project. The parcel will not be granted access from NH Route 111 or NH Route 28. The Department will reserve the slope easement along NH Route 28 as shown on highway plans.

The need for this parcel has been reviewed by the Department, which has determined that the sale of this parcel is surplus to our operational needs and interest for the purpose of disposal.

Approval of the sale of this property by the Council of Resources and Development is no longer necessary per RSA 4:39-c whereas the parcel to be sold was purchased with Highway and Federal funds.

On September 5, 2018, the Long Range Capital Planning and Utilization Committee approved the Department's request to sell the access point directly to Rockingham Road Realty Trust for \$25,000.00 plus an Administrative Fee of \$1,100.00.

In accordance with RSA 4:39-c. the Town of Windham and the New Hampshire Housing Finance Authority have been offered this parcel at the approved purchase price and neither expressed interest in purchasing this parcel.

Authorization is respectfully requested to sell this access point to Rockingham Road Realty Trust.

Respectfully,

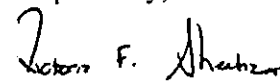

Victoria F Sheehan
Commissioner

VFS/DRP/
Attachments

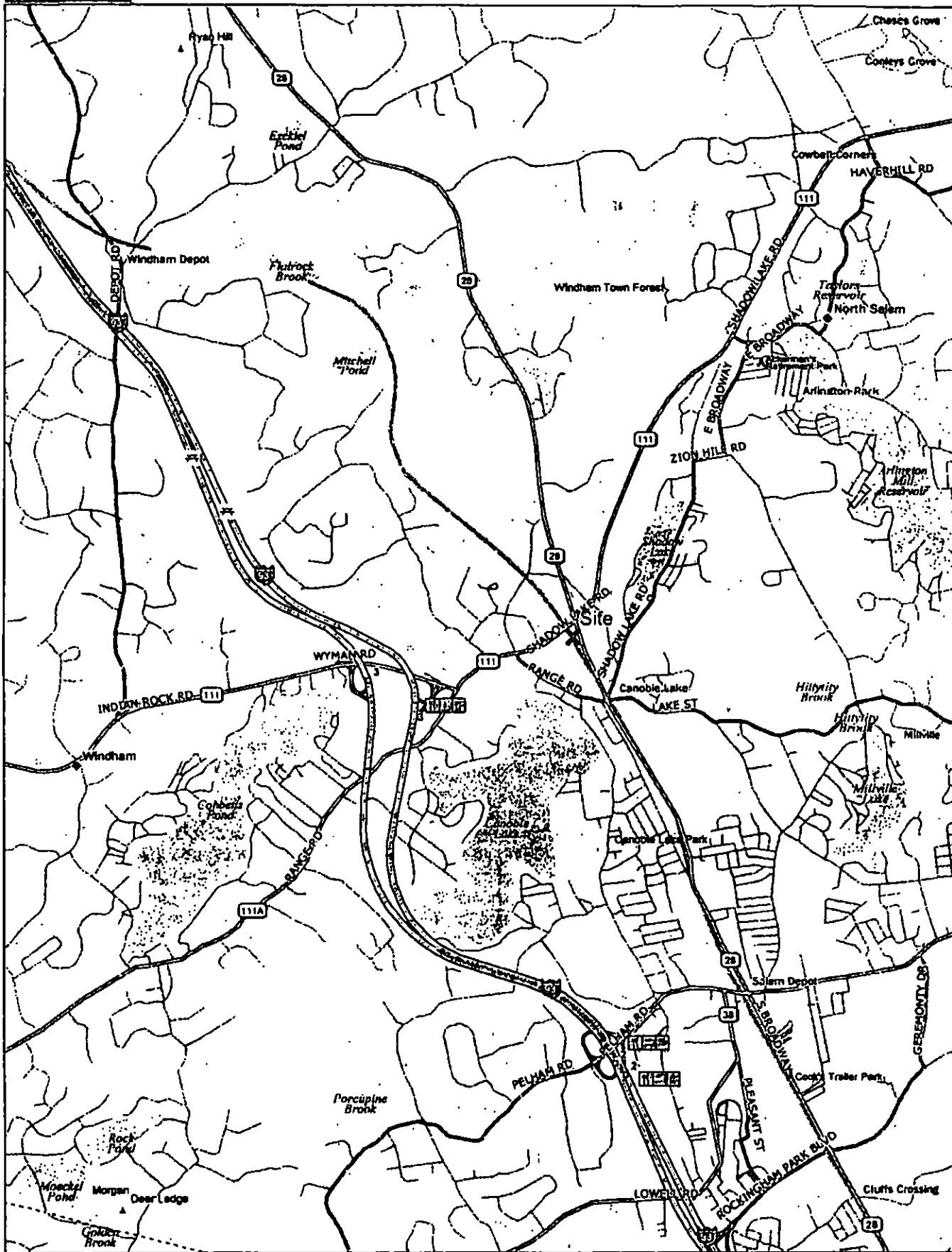

Data use subject to license.

© DeLorme, DeLorme Street Atlas USA © 2015.

www.delorme.com

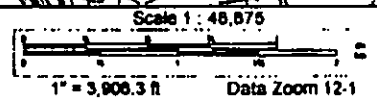

STATE OF NEW HAMPSHIRE
DEPARTMENT OF REVENUE
ADMINISTRATION

MOSAIC PARCEL
MAP SHARING
POOL

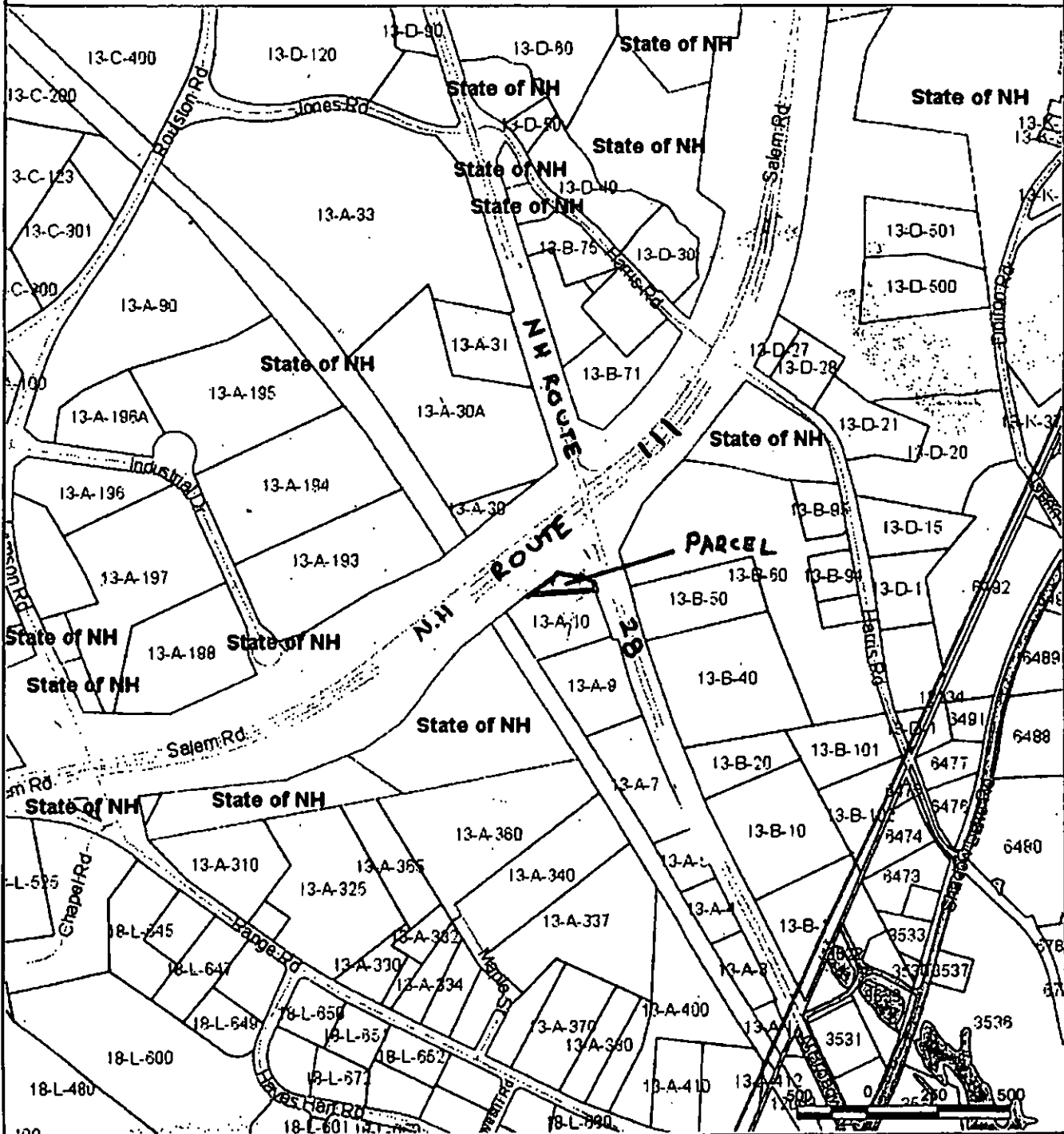

This map was compiled using data believed to be accurate; however, a degree of error is inherent in all maps. This map was distributed "AS-IS" without warranties of any kind, either expressed or implied, including but not limited to warranties of suitability to a particular purpose or use. No attempt has been made in either the design or production of the maps to define the limits or jurisdiction of any federal, state, or local government. Detailed on-the-ground surveys and historical analyses of sites may differ from the maps.



LRCP 18-033

MICHAEL W. KANE, MPA
Legislative Budget Assistant
(603) 271-3181

CHRISTOPHER M. SHEA, MPA
Deputy Legislative Budget Assistant
(603) 271-3181

State of New Hampshire
OFFICE OF LEGISLATIVE BUDGET ASSISTANT
State House, Room 102
Concord, New Hampshire 03301

STEPHEN C. SMITH, CPA
Director, Audit Division
(603) 271-2785

September 5, 2018

Charles R. Schmidt, P.E., Administrator
Department of Transportation
Bureau of Right-of-Way
John O. Morton Building
Concord, New Hampshire 03301

Dear Mr. Schmidt,

The Long Range Capital Planning and Utilization Committee, pursuant to the provisions of RSA 4:39-c, on September 5, 2018, approved the request of the Department of Transportation, Bureau of Right-of-Way, to sell a 0.19 +/- acre parcel of State owned land located on the southwesterly corner of N.H. Route 111 and N.H. Route 28 in the Town of Windham directly to the abutter, Rockingham Road Realty Trust, for \$26,100, which includes an \$1,100 Administrative Fee, subject to the conditions as specified in the request dated August 9, 2018.

Sincerely,

Christopher M. Shea
Deputy Legislative Budget Assistant

CMS/pe
Attachment