



The State of New Hampshire MAR 25 '20 PM 1:13 DAS
Department of Environmental Services



Sam
54

Robert R. Scott, Commissioner

March 20, 2020

His Excellency, Governor Christopher T. Sununu
and The Honorable Council
State House
Concord, NH 03301

REQUESTED ACTION

Approve the NH Department of Safety Marine Patrol's request for a five year permit time extension, in accordance with RSA 482-A:3, XIV-a(a), to perform the following work on Lake Winnepesaukee in Gilford. File #2015-00420. This project was originally approved by the Governor and Executive Council on July 22, 2015, Item #92 to the NH Department of Safety Marine Patrol, and will not have significant impact on or adversely affect the values of Lake Winnepesaukee.

For the purpose of replacing and upgrading NH Department of Safety, Marine Patrol facilities on Lake Winnepesaukee in Gilford: 1) Temporarily impact 170 sq. ft. of lakebed to install a 226 linear ft. cofferdam; 2) Dredge 68 cu. yd. from and otherwise alter 4,212 sq. ft. of lakebed; 3) Alter 246 linear ft. of shoreline; and 4) Reconfigure a major docking system.

The New Hampshire Department of Environmental Services (NHDES) finds that the applicant has demonstrated all of the following:

1. The permit for which the extension is being sought has not been revoked or suspended without reinstatement.
2. The extension will not violate a condition of law or rule.
3. The project is proceeding toward completion in accordance with the plans and other documentation referenced in the permit dated March 24, 2015.
4. The applicant proposes reasonable mitigation measures to protect the public waters of the state from deterioration during the period of extension.

The New Hampshire Department of Environmental Services (NHDES) imposed the following conditions as part of this approval:

1. All work shall be in accordance with revised plans submitted by Vanasse Hangen Brustlin, Inc. dated May 12, 2015, and received by the NH Department of Environmental Services (DES) on May 13, 2015.
2. The DES Biology Bureau's Limnologist/Exotic Species Program Coordinator shall be notified in writing of the date on which dredging will begin 14 days prior to the beginning of the project.
3. If, at any time during the dredging, DES determines that rising water levels pose significant risk to the containment of the site, DES may request that the work cease until water levels recede to an acceptable level. Work shall cease immediately upon notification of the applicant, or any agent of the applicant, that water levels have risen to an unacceptable level, and shall not resume until authorized by DES.
4. All procedures outlined in the Construction Sequence on Sheet W3 of the approved plans shall be followed with particular care in order to prevent the spread of invasive milfoil species.
5. All dredged material ("spoil material") shall be completely removed from surface waters, shall be deposited outside of the DES Wetlands Bureau jurisdiction and at least 250 ft. from any surface water or wetland in order to prevent the spread of invasive milfoil species.

6. All construction related debris shall be completely removed from surface waters and deposited outside of the DES Wetlands Bureau jurisdiction.
7. Equipment initially entering surface waters shall be completely free of any imported aquatic plants and animals.
8. Equipment washing/rinsing shall not take place in areas in Wetlands Bureau jurisdictional areas. 9. Appropriate siltation, erosion, and turbidity controls shall be in place prior to construction, shall be maintained during construction, and shall remain in place until the area is stabilized.
9. The ramp approach shall be crowned so that drainage is directed away from the slope of the ramp.
10. The cofferdam shall be constructed prior to commencing work on structures located within surface waters.
11. The temporary cofferdam shall be entirely removed immediately following construction.
12. The work authorized is also contingent on approval by the DES Alteration of Terrain Bureau.
13. This permit shall not be effective until it has been recorded with the Belknap County Registry of Deeds office by the Permittee. A copy of the recorded permit shall be submitted to the DES Wetlands Bureau by certified mail, return receipt requested, prior to construction.
14. Work shall be conducted in a manner so as to minimize turbidity and sedimentation to surface waters and wetlands.
15. Work shall be conducted in a manner that avoids discharges of sediments to fish spawning areas.
16. Rip-rap shall be located landward of the shoreline at the normal high water, where practical, and shall not extend more than 2 ft. lakeward of that line at any point.
17. Culvert outlets shall be properly rip rapped.
18. All activities shall be in accordance with the Shoreland Water Quality Protection Act, RSA 483-B. The owner is responsible for obtaining any Shoreland Permit that may be required per RSA 483-B, for construction, excavation or fill that will occur within the Protected Shoreland.

EXPLANATION

The NHDES approved this project on March 20, 2020. The NHDES supported its decision with the following findings:

1. The owner, authorized agent or applicant certifies that this permit qualifies for a permit extension in accordance with RSA 482-A:3, XIV-a(a), and Env-Wt 502.01.
2. This permit has been extended in accordance with RSA 482-A:3, XIV-a(a) and Env-Wt 502.01.

Application file documents are being forwarded to the Governor and the Executive Council in connection with their consideration of this matter pursuant to RSA 482-A:3,II.(a) as it is a major project in public waters of the state.

We respectfully request your approval of this item.



Robert R. Scott
Commissioner

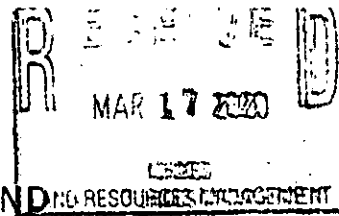

**WETLANDS AND SHORELAND
REQUEST FOR PERMIT EXTENSION**
Water Division/Land Resources Management
Wetlands Bureau



RSA/Rule: RSA 482-A:3 XIV-a; RSA 483-B:5-b, VI/ Env-Wt 314.05

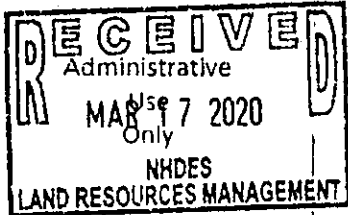

Administrative
Use
Only

Administrative
Use
Only

Permit Not to Extend Beyond
New Permit Expiration Date:

05/15/2025

Authorized By: [Signature]

Printed Name: Stephen Riches

Date: 3/20/20

Under Wetlands and Shoreland statutes RSA 482-A:3, XIV-a and RSA 483-B:5-b, VI, respectively, an applicant may request an extension of a permit if certain conditions are met (see Section 3). This request must be submitted before the Wetland or Shoreland permit expires. Once the permit expires, it is no longer eligible for an extension. The grey boxes above are for Administrative/Registry of Deeds use.

SECTION 1 - PROJECT INFORMATION			
PERMIT NUMBER: 2015-00420		PERMIT TYPE: <input type="checkbox"/> SHORELAND <input checked="" type="checkbox"/> WETLAND	
PERMIT EXPIRATION DATE (request must be filed before the permit expires): 05/15/2020			
SECTION 2 - APPLICANT INFORMATION			
OWNER/AUTHORIZED AGENT NAME: NH DEPT of SAFETY / MARINE PATROL c/o Executive Major Matthew S. Shapiro			
MAILING ADDRESS: 33 Hazen Drive		TOWN/CITY: Concord	STATE: NH ZIP CODE: 03305
EMAIL: matthew.shapiro@dos.nh.gov		PHONE: (603) 223-8775	FAX: (603) 271-0336
SECTION 3 - INFORMATION REQUIRED FOR PERMIT EXTENSION REQUEST ACCEPTANCE			
If your permit extension request includes all the required materials, initials and signature demonstrating that the following conditions have been met, your request will be granted, and you will receive this page, signed and annotated with the new permit expiration date as evidence of your extension. If your request package does not include all the required materials, initials and signature, a copy of the request will be returned to you with this page annotated with the missing/non-compliant items indicated. Initial each box to accept the conditions or check "N/A" if not applicable.			
Initials: M.S.	The length of the requested extension, not to exceed 5 years: <u>M.S.</u> (RSA 482-A:3, XIV-a, (a) and RSA 483-B:5-b, VI).		
Initials: M.S.	The permit for which extension is sought has not been revoked or suspended without reinstatement (RSA 482-A:3, XIV-a, (a) and RSA 483-B:5-b, VI, (a)).		
Initials: M.S.	Extension would not violate a condition of law or rule (RSA 482-A:3, XIV-a, (a) and RSA 483-B:5-b, VI, (b)).		

Initials: M.S.	The project is proceeding towards completion in accordance with plans and other documentation referenced by the permit (RSA 482-A:3, XIV-a, (a) and RSA 483-B:5-b, VI, (c)).
Initials: M.S.	The applicant proposes reasonable mitigation measures to protect the public waters of the state from deterioration during the period of extension (RSA 482-A:3, XIV-a, (a) and Env-Wt 314.05(c)). Check Not Applicable (N/A) if this is a Shoreland Permit: <input type="checkbox"/> N/A
Initials: M.S.	The wetland delineation is still valid pursuant to Env-Wt 406.01(b) (Env-Wt 314.05(c)). Check N/A if this is a Shoreland Permit: <input type="checkbox"/> N/A
Initials: M.S	The applicant proposes reasonable mitigation measures to protect the shorelands and public waters of the state from deterioration during the period of extension (RSA 483-B:5-b, VI, (d)). Check N/A if this is a Wetlands Permit: <input checked="" type="checkbox"/> N/A

SECTION 4 - REQUIRED CERTIFICATIONS (Required for Wetlands Permit Only)

N/A: If this is a Shoreland Permit, check N/A

Initial each box below to certify:

Initials: M.S	To the best of the signer's knowledge and belief, all required notifications have been provided.
Initials: M.S	The information submitted on or with the application is true, complete, and not misleading to the best of the signer's knowledge and belief.
Initials: M.S.	The signer understands that: <ul style="list-style-type: none"> • The submission of false, incomplete, or misleading information constitutes grounds for NHDES to: <ol style="list-style-type: none"> 1. Deny the application; 2. Revoke any approval that is granted based on the information. 3. If the signer is a certified wetland scientist, licensed surveyor, or professional engineer licensed to practice in New Hampshire, refer the matter to the joint board of licensure and certification established by RSA 310-A:1. • The signer is subject to the penalties specified in New Hampshire law for falsification in official matters, currently RSA 641. • The signature shall constitute authorization for the municipal conservation commission and the Department to inspect the site of the proposed project, except for minimum impact forestry SPN projects and minimum impact trail projects, where the signature shall authorize only the department to inspect the site pursuant to RSA 482-A:6, II.
Initials: M.S.	If the applicant is not the owner of the property, each property owner signature shall constitute certification by the signer that he or she is aware of the application being filed and does not object to the filing.

SECTION 5 - REQUIRED SIGNATURE (Required for Wetlands Permit Only)

N/A: If this is a Shoreland Permit, check N/A

SIGNATURE (OWNER):	PRINT NAME LEGIBLY:	DATE:
SIGNATURE (APPLICANT, IF DIFFERENT FROM OWNER):	PRINT NAME LEGIBLY:	DATE:
SIGNATURE (AGENT, IF APPLICABLE): <i>Matthew S. Shapiro</i>	PRINT NAME LEGIBLY: MATTHEW SHAPIRO	DATE: 03-10-20



THE STATE OF NEW HAMPSHIRE
 DEPARTMENT OF ENVIRONMENTAL SERVICES
 LAND RESOURCES MANAGEMENT
 WETLANDS BUREAU

29 Hazen Drive, PO Box 95, Concord, NH 03302-0095
 Phone: (603) 271-2147 Fax (603) 271-6538
<http://des.nh.gov/organization/divisions/water/wetlands>

PERMIT APPLICATION

		2015 - 00420
		291357
		# 2,442.40
		DB

1. REVIEW TIME:
 Indicate your Review Time below. Refer to Guidance Document A for instructions.

- Standard Review (Minimum, Minor or Major Impact) Expedited Review (Minimum Impact)

2. PROJECT LOCATION:
 Separate applications must be filed with each municipality that jurisdictional impacts will occur in.

ADDRESS: 31 Dock Road TOWN/CITY: Gilford

TAX MAP: 242 BLOCK: N/A LOT: 184, 186, 199 UNIT: N/A

USGS TOPO MAP WATERBODY NAME: Lake Winnepesaukee NA STREAM WATERSHED SIZE: NA

LOCATION COORDINATES (If known): 43° 35' 06" N 71° 23' 15" W Latitude/Longitude UTM State Plane

3. PROJECT DESCRIPTION:
 Provide a brief description of the project outlining the scope of work. Attach additional sheets as needed to provide a detailed explanation of your project. DO NOT reply "See Attached" in the space provided below.

The proposed project work will consist of the demolition of the existing 15,700 square foot New Hampshire Department of Safety (NHDS) Marine Patrol Headquarters building and adjacent 15,850 square foot Glendale Marine building, and the construction of a new two-story facility of approximately 33,000 square feet. This building would be placed on approximately the same footprint of the existing building. The purpose for the reconstruction of this building is to resolve general deficiencies discovered in the existing building. Other proposed site improvements include a two-boat garage, improved parking, and improved access to the Marine Patrol Headquarters. The project is expected to take place over a 50 year period. Refer to the attached Wetland Permit Application Narrative for additional information.

4. RELATED PERMITS, ENFORCEMENT, EMERGENCY AUTHORIZATION, SHORELAND, ALTERATION OF TERRAIN, ETC...

Shoreland, Alteration of Terrain

5. NATURAL HERITAGE BUREAU & DESIGNATED RIVERS:
 See the Instructions & Required Attachments document for instructions to complete a & b below.

- a. Natural Heritage Bureau File ID: NHB 14 - 4734.
- b. Designated River the project is in ¼ miles of _____; and
 date a copy of the application was sent to Local River Advisory Committee: Month: ___ Day: ___ Year: ___
- NA

6. APPLICANT INFORMATION (Desired permit holder)

LAST NAME, FIRST NAME, M.I.: **Dunleavy, Timothy**

TRUST / COMPANY NAME: **NHDOS Marine Patrol**

MAILING ADDRESS **31 Dock Road**

TOWN/CITY: **Gilford**

STATE: **NH**

ZIP CODE: **03249**

EMAIL or FAX: **timothy.dunleavy@dos.nh.gov**

PHONE **(603) 293-2037**

ELECTRONIC COMMUNICATION: By initialing here: _____, I hereby authorize DES to communicate all matters relative to this application electronically

7. PROPERTY OWNER INFORMATION (If different than applicant)

LAST NAME, FIRST NAME, M.I.:

TRUST / COMPANY NAME:

MAILING ADDRESS:

TOWN/CITY:

STATE:

ZIP CODE:

EMAIL or FAX:

PHONE:

ELECTRONIC COMMUNICATION: By initialing here _____, I hereby authorize DES to communicate all matters relative to this application electronically

8. AUTHORIZED AGENT INFORMATION

LAST NAME, FIRST NAME, M.I.: **Walker, Peter, J.**

COMPANY NAME: **VHB**

MAILING ADDRESS: **2 Bedford Farms Drive, Suite 200**

TOWN/CITY: **Bedford**

STATE: **NH**

ZIP CODE: **03110**

EMAIL or FAX: **pwalker@vhb.com**

PHONE: **(603) 391-3900**

ELECTRONIC COMMUNICATION: By initialing here , I hereby authorize DES to communicate all matters relative to this application electronically

9. PROPERTY OWNER SIGNATURE:

See the Instructions & Required Attachments document for clarification of the below statements

By signing the application, I am certifying that:

1. I authorize the applicant and/or agent indicated on this form to act in my behalf in the processing of this application, and to furnish upon request, supplemental information in support of this permit application.
2. I have reviewed and submitted information & attachments outlined in the Instructions and Required Attachment document.
3. All abutters have been identified in accordance with RSA 482-A:3, I and Env-Wt 100-900.
4. I have read and provided the required information outlined in Env-Wt 302.04 for the applicable project type.
5. I have read and understand Env-Wt 302.03 and have chosen the least impacting alternative.
6. Any structure that I am proposing to repair/replace was either previously permitted by the Wetlands Bureau or would be considered grandfathered per Env-Wt 101.47.
7. I have submitted a copy of the application materials to the NH State Historic Preservation Officer.
8. I authorize DES and the municipal conservation commission to inspect the site of the proposed project.
9. I have reviewed the information being submitted and that to the best of my knowledge the information is true and accurate.
10. I understand that the willful submission of falsified or misrepresented information to the New Hampshire Department of Environmental Services is a criminal act, which may result in legal action.
11. I am aware that the work I am proposing may require additional state, local or federal permits which I am responsible for obtaining.
12. The mailing addresses I have provided are up to date and appropriate for receipt of DES correspondence. DES will not forward returned mail.

Property Owner Signature

Timothy C Dunleavy
Print name legibly

2/18/2015
Date

MUNICIPAL SIGNATURES

10. CONSERVATION COMMISSION SIGNATURE

The signature below certifies that the municipal conservation commission has reviewed this application, and:

1. Waives its right to intervene per RSA 482-A:11; ~
2. Believes that the application and submitted plans accurately represent the proposed project; and
3. Has no objection to permitting the proposed work.

<input style="width: 100%; height: 100%;" type="text"/>	<input style="width: 100%; height: 100%;" type="text"/>	<input style="width: 100%; height: 100%;" type="text"/>
Authorized Commission Signature	Print name legibly	Date

DIRECTIONS FOR CONSERVATION COMMISSION

1. Expedited review ONLY requires that the conservation commission's signature is obtained in the space above.
2. The Conservation Commission signature should be obtained prior to the submittal of the original application and four copies to the town/city clerk for mailing to the DES.
3. The Conservation Commission may refuse to sign. If the Conservation Commission does not sign this statement for any reason, the application is not eligible for expedited review and the application will reviewed in the standard review time frame.

11. TOWN / CITY CLERK SIGNATURE

As required by Chapter 482-A:3 (amended 2014), I hereby certify that the applicant has filed four application forms, four detailed plans, and four USGS location maps with the town/city indicated below.

<input style="width: 100%; height: 100%;" type="text"/>	<input style="width: 100%; height: 100%;" type="text"/>	<input style="width: 100%; height: 100%;" type="text"/>	<input style="width: 100%; height: 100%;" type="text"/>
Town/City Clerk Signature <i>Deputy</i>	Print name legibly	Town/City	Date

DIRECTIONS FOR TOWN/CITY CLERK:

Per RSA 482-A:3.1

1. For applications where "Expedited Review" is checked on page 1, sign and accept the applications only if the Conservation Commission signature has been received;
2. IMMEDIATELY sign the original application form and four copies in the signature space provided above;
3. Return the signed original application form and attachments to the applicant so that the applicant may submit the application form and attachments to NHDES by mail or hand delivery.
4. IMMEDIATELY distribute a copy of the application with one complete set of attachments to each of the following bodies: the municipal Conservation Commission, the local governing body (Board of Selectmen or Town/City Council), and the Planning Board, and
5. Retain one copy of the application form and one complete set of attachments and make them reasonably accessible for public review.

DIRECTIONS FOR APPLICANT:

1. Submit the original permit application form bearing the signature of the Town/ City Clerk, additional materials, and the application fee to NHDES by mail or hand delivery.

12. IMPACT AREA:

For each jurisdictional area that will be/has been impacted, provide square feet and if applicable, linear feet of impact

Permanent: impacts that will remain after the project is complete.

Temporary: impacts not intended to remain (and will be restored to pre-construction conditions) after the project is complete

After-the-fact (ATF): work completed prior to receipt of this application by DES. Check box to indicate ATF.

JURISDICTIONAL AREA	PERMANENT Sq. Ft. / Lin. Ft.	ATF	TEMPORARY Sq. Ft. / Lin. Ft.	ATF
Forested wetland		<input type="checkbox"/>		<input type="checkbox"/>
Scrub-shrub wetland		<input type="checkbox"/>		<input type="checkbox"/>
Emergent wetland		<input type="checkbox"/>		<input type="checkbox"/>
Wet meadow		<input type="checkbox"/>		<input type="checkbox"/>
Intermittent stream		<input type="checkbox"/>		<input type="checkbox"/>
Perennial Stream / River	/	<input type="checkbox"/>	/	<input type="checkbox"/>
Lake / Pond	3,935 /	<input type="checkbox"/>	197 /	<input type="checkbox"/>
Bank - Intermittent stream	/	<input type="checkbox"/>	/	<input type="checkbox"/>
Bank - Perennial stream / River	/	<input type="checkbox"/>	/	<input type="checkbox"/>
Bank - Lake / Pond	/ 288	<input type="checkbox"/>	/	<input type="checkbox"/>
Tidal water	/	<input type="checkbox"/>	/	<input type="checkbox"/>
Salt marsh		<input type="checkbox"/>		<input type="checkbox"/>
Sand dune		<input type="checkbox"/>		<input type="checkbox"/>
Prime wetland		<input type="checkbox"/>		<input type="checkbox"/>
Prime wetland buffer		<input type="checkbox"/>		<input type="checkbox"/>
Undeveloped Tidal Buffer Zone (TBZ)		<input type="checkbox"/>		<input type="checkbox"/>
Previously-developed upland in TBZ		<input type="checkbox"/>		<input type="checkbox"/>
Docking - Lake / Pond		<input type="checkbox"/>		<input type="checkbox"/>
Docking - River		<input type="checkbox"/>		<input type="checkbox"/>
Docking - Tidal Water		<input type="checkbox"/>		<input type="checkbox"/>
TOTAL	3,935 / 288		197 /	

13. APPLICATION FEE: See the Instructions & Required Attachments' document for further instruction

Minimum Impact Fee: Flat fee of \$ 200

Minor or Major Impact Fee: Calculate using the below table below

Permanent and Temporary (non-docking) 4,132 sq. ft. X \$0.20 = \$ 826.40

Temporary (seasonal) docking structure: sq. ft. X \$1.00 = \$

Permanent docking structure: 708 sq. ft. X \$2.00 = \$ 1,416.00

Projects proposing shoreline structures (including docks) add \$200 = \$ 200.00

Total = \$ 2,442.40

The Application Fee is the above calculated Total or \$200, whichever is greater = \$ 2,442.40

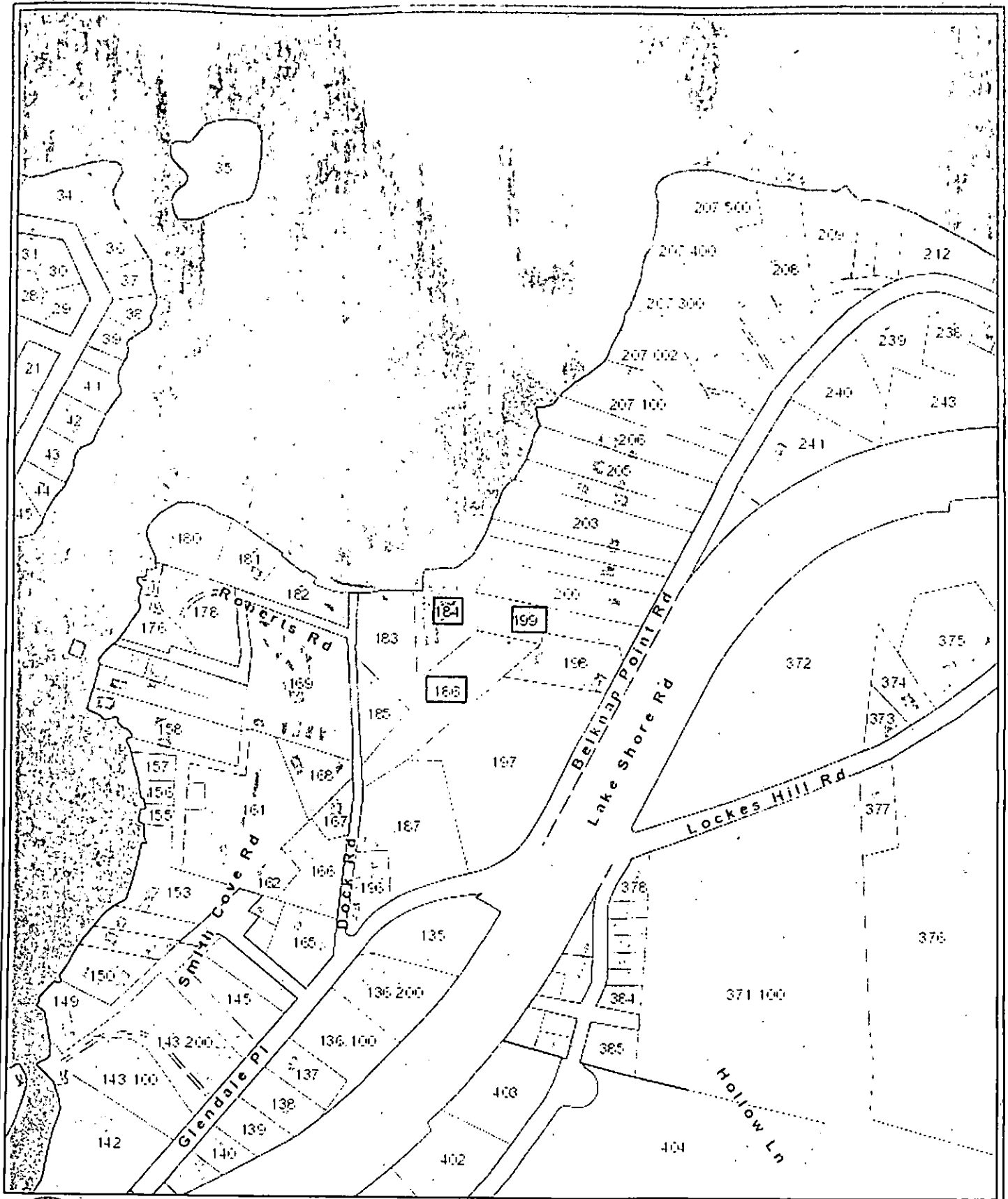

NHDOS Marine Patrol Headquarters
 Gilford, NH
 1 Inch = 360 Feet
 February 04, 2015



Data shown on this map is provided for planning and informational purposes only. The municipality and CAI Technologies are not responsible for any use for other purposes or misuse or misrepresentation of this map.

www.cai-tech.com
 CAI Technologies

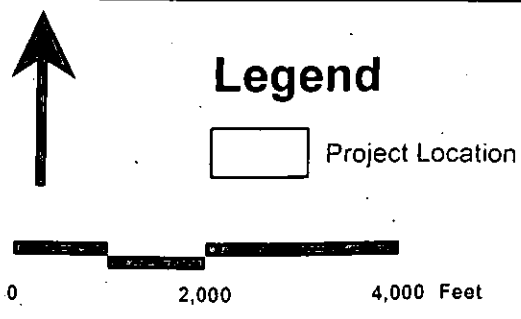
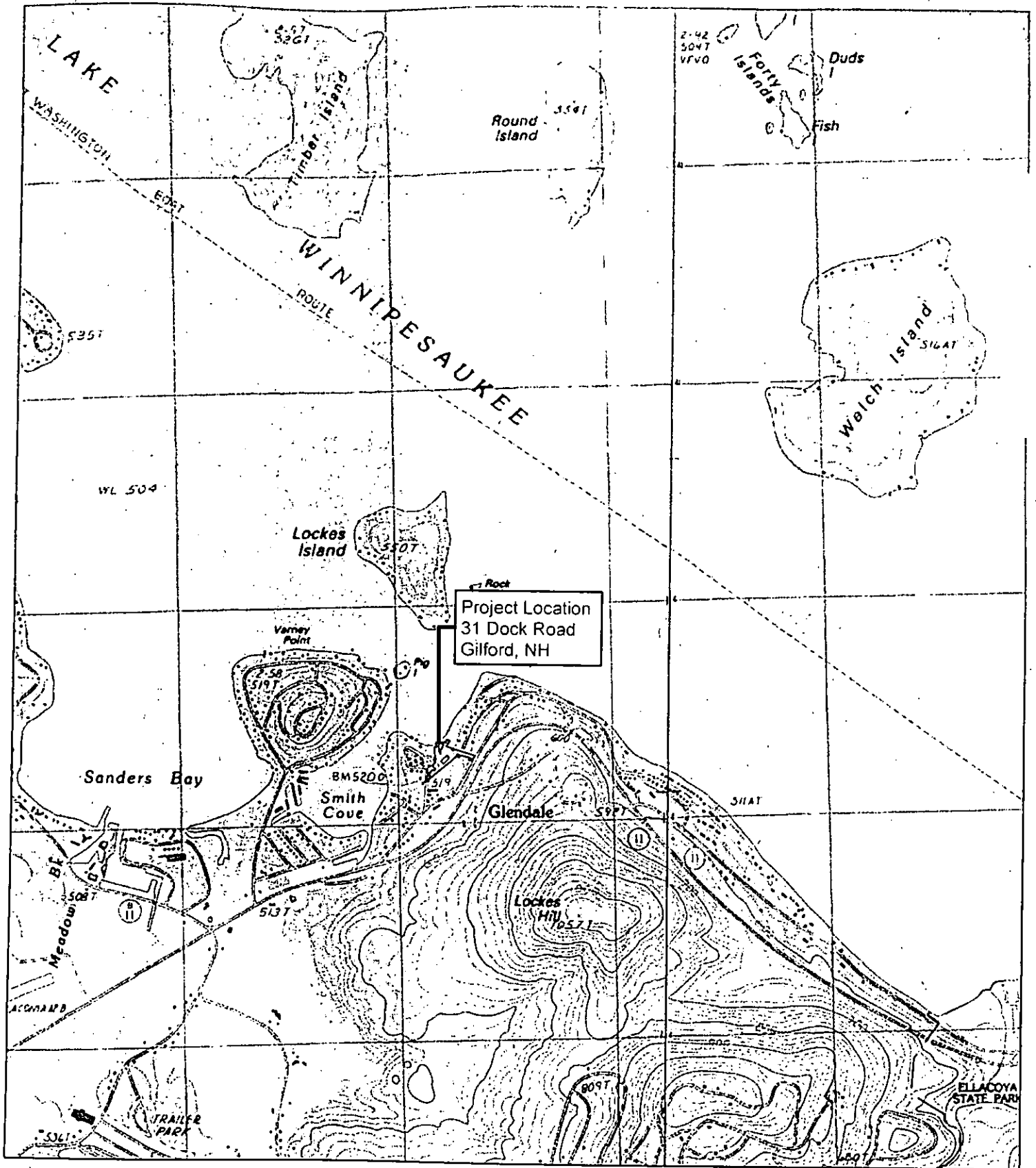

vhb Engineers | Scientists | Planners | Designers
 2 Bedford Farms Drive Suite 200 Bedford NH 03110

910
 /
 111

Figure 1- USGS Site Location Map

NH Marine Patrol Headquarters Redevelopment
 31 Dock Road
 Gilford, New Hampshire



New Hampshire Natural Heritage Bureau

To: Lindsay Jones
2 Bedford Farms Drive Suite 200
Bedford, NH 03110-6532

Date: 12/8/2014

From: NH Natural Heritage Bureau

Re: Review by NH Natural Heritage Bureau of request dated 12/8/2014

NHB File ID: NHB14-4734

Applicant: Captain Timothy Dunleavy

Location: Tax Map(s)/Lot(s): Tax Map 242 Lots 184, 186, 199
Gilford

Project Description: The New Hampshire Department of Safety (NHDOS) Marine Patrol plans to demolish the existing Marine Patrol Headquarters building located on Tax Map 242 Lot 184 and construct a new facility on the same general footprint. Other general construction is planned to occur on Lots 184, 186, and 199 including the demolition of the Glendale Marine building, new parking areas, improved driveway to Belknap Point Road, general re-shaping and re-grading of surrounding landscape, and reconfiguration of utility lines.

The NH Natural Heritage database has been checked for records of rare species and exemplary natural communities near the area mapped below. The species considered include those listed as Threatened or Endangered by either the state of New Hampshire or the federal government. We currently have no recorded occurrences for sensitive species near this project area.





A negative result (no record in our database) does not mean that a sensitive species is not present. Our data can only tell you of known occurrences, based on information gathered by qualified biologists and reported to our office. However, many areas have never been surveyed, or have only been surveyed for certain species. An on-site survey would provide better information on what species and communities are indeed present.

This report is valid through 12/7/2015.

MAP OF PROJECT BOUNDARIES FOR NHB FILE ID: NHB14-4734

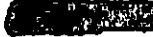

ABUTTERS TO NEW HAMPSHIRE MARSH PATROL BUILDING
REDEVELOPMENT
Tax Map 242 Lots 14, 18 - 199

Owner/Abutter	Tax Map Number (map-lot)	Mailing Address
Town of Gifford	242-183 242-184	47 Cherry Valley Road Gifford, NH 03249
Lyons' Den Restaurant & Tavern, Inc.	242-185	
Glendale Water Systems, Inc.	242-186.1	
A Summer Place	242-187	
Helen M. Clermont	242-198	
Richard L. & Jean A. Olson	242-200	
Olson Gifford Realty Trust	242-201	

Saved Wednesday, May 13, 2015 9:05:16 AM MICROSOFT REVISED Wednesday, May 13, 2015 9:05:33 AM Client

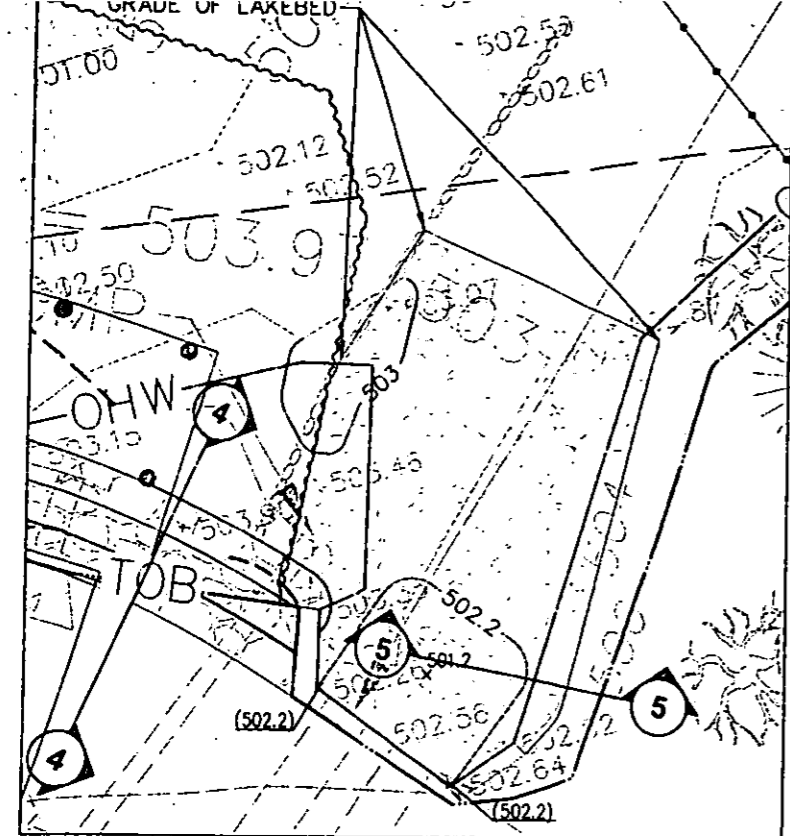

Inset
SCALE: 1"=5'

Wetland Impact Summary

Location	Bank Impacts (lf)	Permanent Lakebed Impacts (sf)	Dredge Volume (cy)	Temporary Lakebed Impacts (sf)
A	38	1,100	-	-
B	182	182	-	-
C	28	28	-	-
D	-	2,068	68	-
E	-	3.21	-	-
F	-	141	-	-
G	43	217.5	-	-
H	18	138	-	-
I	-	381	-	-
J	-	-	-	179
TOTAL	299	4,245	68	179

VHB
Vanasse Hangen Brustlin, Inc.

Transportation
Land Development
Environmental Services

2 Bedford Farms Drive, Suite 200
Bedford, New Hampshire 03110
603.391.3900 • FAX 603.518.7495

Notes:

- THE SHORELAND PROTECTION REFERENCE IS BASED ON THE LAKE FULL ELEVATION 503.87 (NAVD88) AS SHOWN ON THE "EXISTING CONDITIONS PLAN FOR STATE OF NEW HAMPSHIRE", DATED SEPTEMBER 10, 2010 PREPARED BY JOSEPH M. WISBERT, INC. THIS EQUATES TO ELEVATION 504.3 NAVD 1929.
- TOPOGRAPHIC ELEVATIONS ARE BASED ON NAVD 1988 AS PROVIDED ON THE SURVEY BASE PLANS PREPARED BY OTHERS. IN ORDER TO GO FROM NAVD 1988 TO NAVD 1929, ADD 0.45' TO PLAN ELEVATIONS.

LAKE WINNIPESAUKEE
SHORELAND PROTECTION REFERENCE LINE/LAKE FULL ELEVATION = 504.32 (NGVD 1929) = 503.87 (NAVD 1988)

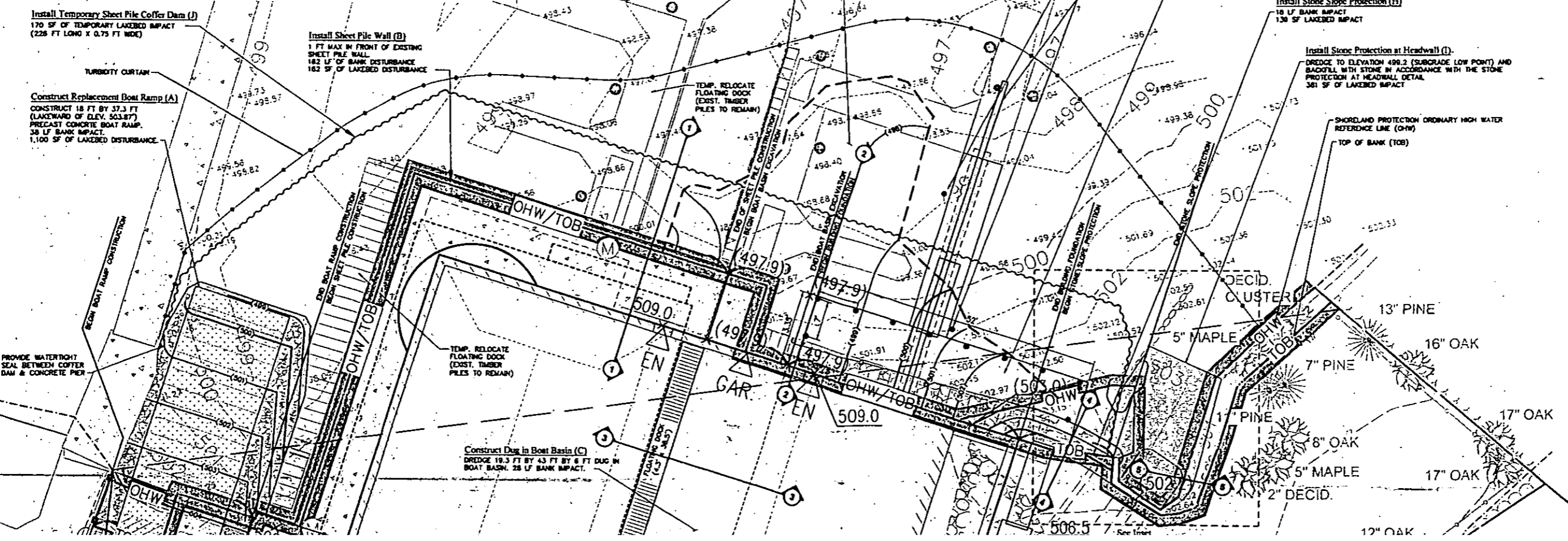

Install New Wood Piles (E)
INSTALL THREE 14 INCH DIAMETER TIMBER PILES (MATCH EXISTING)
3 x 1.07 SF = 3.21 SF LAKEBED IMPACT

Dredge for Boat Basin Approach (D)
DREDGE TO ELEVATION 497.87 FT (NAVD 88)/ 488.32 FT (NGVD 29).
2068 SF BY 68 CU YD LAKEBED IMPACT.

Construct Fire Protection Intake Line (F)
CONSTRUCT 12-INCH DIAMETER FIRE PROTECTION INTAKE LINE
47 FT x 3 FT TRENCH = 141 SF LAKEBED IMPACT

Construct Concrete Wharf (G)
CONSTRUCT 13.35 FT BY 52 FT CONCRETE WHARF
INSTALL TEN PERMANENT TIMBER PILE SUPPORTS
43 LF BANK IMPACT, 694 SF OF DOCK IMPACT
TIMBER PILES 10 x 0.55 SF = 5.5 SF
SLIPK PROTECTION = 217.5 SF
TOTAL LAKEBED IMPACT = 217.5 SF

Install Sheet Pile Wall (B)
1 FT MAX IN FRONT OF EXISTING SHEET PILE WALL
182 LF OF BANK DISTURBANCE
182 SF OF LAKEBED DISTURBANCE

Install Temporary Sheet Pile Cofferdam (J)
170 SF OF TEMPORARY LAKEBED IMPACT
(228 FT LONG X 0.75 FT WIDE)

Construct Replacement Boat Ramp (A)
CONSTRUCT 18 FT BY 37.3 FT (LAKEWARD OF ELEV. 503.87)
PRECAST CONCRETE BOAT RAMP.
38 LF BANK IMPACT
1,100 SF OF LAKEBED DISTURBANCE.

Construct Dug in Boat Basin (C)
DREDGE 19.3 FT BY 43 FT BY 6 FT DUG IN BOAT BASIN. 28 LF BANK IMPACT.

Install Stone Slope Protection (H)
18 LF BANK IMPACT
138 SF LAKEBED IMPACT

Install Stone Protection at Headwall (I)
DREDGE TO ELEVATION 499.2 (SUBGRADE LOW POINT) AND BACKFILL WITH STONE IN ACCORDANCE WITH THE STONE PROTECTION AT HEADWALL DETAIL.
381 SF OF LAKEBED IMPACT

NO.	REVISION	DATE
1	ISSUES WETLAND BUREAU REVIEW	5/12/2015

Designed by: _____ Drawn by: _____ Checked by: _____
CAD checked by: _____ Approved by: _____
Scale: 1"=10' Date: February 20, 2015
Project Title: _____

New Hampshire Marine Patrol Headquarters Redevelopment

31 Dock Road
Gilford, New Hampshire

Permitting

Not for Construction

Wetland Impact Plan

STATE OF NEW HAMPSHIRE
MARK & VEROSTOCK

W-2

