

Sam



119



The State of New Hampshire
Department of Environmental Services

Robert R. Scott, Commissioner

May 31, 2022

His Excellency, Governor Christopher T. Sununu
 and The Honorable Council
 State House
 Concord, NH 03301

REQUESTED ACTION

Approve Jeremy Stannard's request to perform the following work on Lake Winnepesaukee in Alton pursuant to NH Department of Environmental Services (NHDES) Wetlands Bureau permit #2022-00524, and in accordance with RSA 482-A:3. No comments were submitted by the Alton Conservation Commission regarding the project as proposed.

Place 158 cubic yards of fill on 1,020 square feet of lakebed to construct a 70 linear foot breakwater with an attached 4 foot x 52 foot cantilevered pier accessed by a 4 foot x 16 foot walkway on an average of 101 feet of frontage along Lake Winnepesaukee on the northwest tip of Rattlesnake Island in Alton.

NHDES imposed the following conditions as part of this approval:

1. In accordance with Env-Wt 307.16, all work shall be done in accordance with the approved plans dated February 24, 2022 by Folsom Design & Construction Management, as received by the NH Department of Environmental Services (NHDES) on March 9, 2022.
2. This permit shall not be effective until it has been recorded in the Belknap County Registry of Deeds and a copy of the recorded permit has been provided to the department as required pursuant to RSA 482-A:3, and Env-Wt 314.02.
3. Any subdivision of the property frontage will require removal of a sufficient portion of the docking structures to comply with the dock size and density requirements in effect at the time of the subdivision as required to maintain compliance with Env-Wt 314.02 and Env-Wt 513.12.
4. Only those structures shown on the approved plans shall be installed or constructed along this frontage as required per Env-Wt 513.22, (a).
5. All portions of the docking structures, including the breakwater toe -of-slope, shall be located at least 20 feet from the abutting property lines and no watercraft shall be secured to the docking facility such that it crosses over the imaginary extension of the property lines over the surface water as required by RSA 482-A:3, XIII.
6. In accordance with Env-Wt 307.16, the breakwater shall be constructed as shown in the approved plans and specifications.
7. In accordance with Env-Wt 512.05(b), no rocks shall be stockpiled in any jurisdictional area.
8. The use of this structure shall be limited to the docking and securing of watercraft as required to comply with Env-Wt 307.09.

www.des.nh.gov

29 Hazen Drive • PO Box 95 • Concord, NH 03302-0095

NHDES Main Line: (603) 271-3503 • Subsurface Fax: (603) 271-6683 • Wetlands Fax: (603) 271-6588

TDD Access: Relay NH 1 (800) 735-2964

9. Owners of permanent docking structures which are not maintained so as to be structurally sound and usable for their intended purpose shall remove those docking structures in accordance with Env-Wt 513.22(c), to prevent hazards to public safety, navigation, and recreation.
10. The owner understands and accepts that should these docking structures be found to have an unreasonable impact on the ability of abutting owners to use and enjoy their properties or the public's right to navigation, passage, and use of the resource for commerce and recreation the structures shall be subject to removal pursuant to RSA 482-A:1, RSA 482-A:11, II, and Env-Wt 513.03(a).
11. No agitating or heating device shall be installed for the purpose of inhibiting the formation of ice in proximity to the approved structures unless it has been registered with the municipal clerk of the town in which such device shall be operated pursuant to RSA 270:34 Registration Required.
12. Pursuant to RSA 270:33, Heating, Agitating, or Other Devices in Public Waters; Safety Hazard, no agitating or heating device installed in accordance with RSA 270:34 shall inhibit or prevent the natural formation of ice in such a manner as to impede either the ingress or egress to or from the ice from any property other than that of the owner of the device.
13. All development activities associated with any project shall be conducted in compliance with applicable requirements of RSA 483-B and Env-Wq 1400 during and after construction as required pursuant to RSA 483-B:3.
14. Pursuant to RSA 483-B:9, V(a)(2)(D), (v), this permit does not authorize the removal of trees or saplings within the waterfront buffer that would result in a tree and sapling point score below the minimum required per RSA 483-B:9, V(a)(2)(D), (iv).
15. In accordance with Env-Wt 307.10(c), turbidity controls shall be installed prior to construction and maintained during construction such that no turbidity escapes the immediate area and remain in place until suspended particles have settled and water at the work site has returned to normal clarity.
16. No activity shall be conducted in such a way as to cause or contribute to any violation of surface water quality standards specified in RSA 485-A:8 or Env-Wq 1700.
17. Pursuant to RSA 482-A:14, RSA 482-A:14-b, and RSA 482-A:14-c, NHDES is authorized to take appropriate compliance actions should it be determined that, based upon additional information which becomes available, any of the structures depicted as "existing" on the plans submitted by or on behalf of the permittee were not previously permitted or grandfathered.

EXPLANATION

NHDES approved this project on April 28, 2022. NHDES supported its decision with the following findings:

1. This is a major impact project per Administrative Rule Env-Wt 512.06, construction of a breakwater.
2. The applicant has an average of 101 feet of frontage along Lake Winnepesaukee.
3. A maximum of 2 slips may be permitted on this frontage per Rule Env-Wt 513.12, Frontage Requirements for Private and Non-commercial Docking Structures.
4. The proposed docking facility will provide 2 slips as defined per RSA 482-A:2, VIII, and therefore meets Rule Env-Wt 513.12.
5. The applicant has provided the NHDES with evidence that the property has insufficient water depth as required by Env-Wt 513.08, (b).
6. The NHDES has accepted the evidence of the physical hardship and approved the extension of a permanent supported pier beyond that permissible under Env-Wt 513.11, (a)(1)(b).

His Excellency, Governor Christopher T. Sununu
and The Honorable Council
Page 3 of 3

7. The NHDES finds that because the project is not of significant public interest and will not significantly impair the resources of Lake Winnepesaukee a public hearing under RSA 482-A:8 is not required.
8. No concerns were received from abutters nor the local Conservation Commission related to the project.
9. The Department finds that the project as proposed and conditioned meets the requirements of RSA 482-A and the Wetlands Program Code of Administrative Rules Chapters Env-Wt 100 - 900.

NHDES Wetlands Bureau permit #2022-00524 application documents are enclosed for review by the Governor and the Executive Council in consideration of this request and in accordance with RSA 482-A:3, II(a), as it is a major project located in New Hampshire public waters.

We respectfully request your approval of this item.

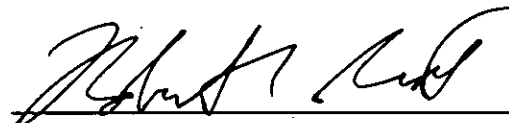

Robert R. Scott
Commissioner



**STANDARD DREDGE AND FILL
WETLANDS PERMIT APPLICATION**
Water Division/Land Resources Management
Wetlands Bureau
Check the Status of your Application



RSA/Rule: RSA 482-A/Env-Wt 100-900

APPLICANT'S NAME: Jeremy StannardTOWN NAME: Alton

| | | | |
|--|--|-------------------------------|----------------------------|
| RECEIVED Administrative MAR 09 2022 Only NHDES LAND RESOURCES MANAGEMENT | COMPLETE Administrative MAR 09 2022 Only | Administrative Use Only | File No. <u>2022-00524</u> |
| | | | Check No. <u>156</u> |
| | | | Amount <u>\$1,920.00</u> |
| | | | Initials <u>RS</u> |

A person may request a waiver of the requirements in Rules Env-Wt 100-900 to accommodate situations where strict adherence to the requirements would not be in the best interest of the public or the environment but is still in compliance with RSA 482-A. A person may also request a waiver of the standards for existing dwellings over water pursuant to RSA 482-A:26, III(b). For more information, please consult the Waiver Request Form.

| | |
|---|---|
| SECTION 1: REQUIRED PLANNING FOR ALL PROJECTS (Env-Wt 306.05; RSA 482-A:3, I(d)(2)) Please use the Wetland Permit Planning Tool (WPPT), the Natural Heritage Bureau (NHB) Datacheck Tool, the Aquatic Restoration Mapper, or other sources to assist in identifying key features such as priority resource areas (PRAs), protected species or habitats, coastal areas, designated rivers, or designated prime wetlands. | |
| Has the required planning been completed? | <input checked="" type="checkbox"/> Yes <input type="checkbox"/> No |
| Does the property contain a PRA? If yes, provide the following information: | <input type="checkbox"/> Yes <input checked="" type="checkbox"/> No |
| <ul style="list-style-type: none"> Does the project qualify for an Impact Classification Adjustment (e.g. NH Fish and Game Department (NHF&G) and NHB agreement for a classification downgrade) or a Project-Type Exception (e.g. Maintenance or Statutory Permit-by-Notification (SPN) project)? See Env-Wt 407.02 and Env-Wt 407.04. | <input type="checkbox"/> Yes <input checked="" type="checkbox"/> No |
| <ul style="list-style-type: none"> Protected species or habitat? <ul style="list-style-type: none"> If yes, species or habitat name(s): <u> </u> NHB Project ID #: <u>NHB22-0782</u> | <input type="checkbox"/> Yes <input checked="" type="checkbox"/> No |
| <ul style="list-style-type: none"> Bog? | <input type="checkbox"/> Yes <input checked="" type="checkbox"/> No |
| <ul style="list-style-type: none"> Floodplain wetland contiguous to a tier 3 or higher watercourse? | <input type="checkbox"/> Yes <input checked="" type="checkbox"/> No |
| <ul style="list-style-type: none"> Designated prime wetland or duly-established 100-foot buffer? | <input type="checkbox"/> Yes <input checked="" type="checkbox"/> No |
| <ul style="list-style-type: none"> Sand dune, tidal wetland, tidal water, or undeveloped tidal buffer zone? | <input type="checkbox"/> Yes <input checked="" type="checkbox"/> No |
| Is the property within a Designated River corridor? If yes, provide the following information: | <input type="checkbox"/> Yes <input checked="" type="checkbox"/> No |
| <ul style="list-style-type: none"> Name of Local River Management Advisory Committee (LAC): <u> </u> A copy of the application was sent to the LAC on Month: <u> </u> Day: <u> </u> Year: <u> </u> | |

irm@des.nh.gov or (603) 271-2147

NHDES Wetlands Bureau, 29 Hazen Drive, PO Box 95, Concord, NH 03302-0095

www.des.nh.gov

| | |
|---|---|
| For dredging projects, is the subject property contaminated? | <input type="checkbox"/> Yes <input checked="" type="checkbox"/> No |
| • If yes, list contaminant: | |
| Is there potential to impact impaired waters, class A waters, or outstanding resource waters? | <input type="checkbox"/> Yes <input checked="" type="checkbox"/> No |
| For stream crossing projects, provide watershed size (see WPPT or Stream Stats): | |
| SECTION 2 - PROJECT DESCRIPTION (Env. Wt. 311.04(i)) Provide a brief description of the project and the purpose of the project, outlining the scope of work to be performed and whether impacts are temporary or permanent. DO NOT reply "See attached"; please use the space provided below. | |
| Construct a 70' rock breakwater (1,020 sq. ft./158 cu. yds.) and a 4' x 52' cantilevered pier accessed by a 4' x 16' walkway (278 sq. ft.) on 101' of average frontage along the shore of Lake Winnepesaukee. | |
| SECTION 3 - PROJECT LOCATION Separate wetland permit applications must be submitted for each municipality within which wetland impacts occur. | |
| ADDRESS: | Rattlesnake Island |
| TOWN/CITY: | Alton |
| TAX MAP/BLOCK/LOT/UNIT: | 75/54 |
| US GEOLOGICAL SURVEY (USGS) TOPO MAP WATERBODY NAME: | Lake Winnepesaukee |
| <input checked="" type="checkbox"/> N/A | |
| (Optional) LATITUDE/LONGITUDE in decimal degrees (to five decimal places): | 43°57'293" North 71°30'653" West |

SECTION 4 - APPLICANT (DESIRED PERMIT HOLDER) INFORMATION (Env-Wt 311.04(a))

If the applicant is a trust or a company, then complete with the trust or company information.

NAME: Jeremy Stannard

MAILING ADDRESS: _____

TOWN/CITY: _____

STATE: _____

ZIP CODE: _____

EMAIL ADDRESS: _____

FAX: N/A

PHONE: _____

ELECTRONIC COMMUNICATION: By initialing here: N/A, I hereby authorize NHDES to communicate all matters relative to this application electronically.**SECTION 5 - AUTHORIZED AGENT INFORMATION (Env-Wt 311.04(c))**☒ N/ALAST NAME, FIRST NAME, M.I.: Folsom, Cynthia LCOMPANY NAME: Folsom Design & Construction ManagementMAILING ADDRESS: 46 Winona Shores RoadTOWN/CITY: MeredithSTATE: NHZIP CODE: 03253EMAIL ADDRESS: folsomdesign@atlanticbb.netFAX: N/APHONE: (603) 393-5751ELECTRONIC COMMUNICATION: By initialing here: CLF, I hereby authorize NHDES to communicate all matters relative to this application electronically.**SECTION 6 - PROPERTY OWNER INFORMATION (IF DIFFERENT THAN APPLICANT) (Env-Wt 311.04(b))**

If the owner is a trust or a company, then complete with the trust or company information.

☒ Same as applicant

NAME: _____

MAILING ADDRESS: _____

TOWN/CITY: _____

STATE: _____

ZIP CODE: _____

EMAIL ADDRESS: _____

FAX: _____

PHONE: _____

ELECTRONIC COMMUNICATION: By initialing here: _____, I hereby authorize NHDES to communicate all matters relative to this application electronically.

SECTION 7: RESOURCE-SPECIFIC CRITERIA ESTABLISHED IN Env-Wt 400, Env-Wt 500, Env-Wt 600, Env-Wt 700, OR Env-Wt 900 HAVE BEEN MET (Env-Wt 313.01(a)(3))

Describe how the resource-specific criteria have been met for each chapter listed above (please attach information about stream crossings, coastal resources, prime wetlands, or non-tidal wetlands and surface waters):

Part Env-Wt 512 Breakwaters

Env-Wt 512.02(a); (b)(1) and (c) Approval Criteria for Breakwaters

Env-Wt 512.04 Breakwater Design Requirements

Env-Wt 512.05 Breakwater Construction Requirements

Part Env-Wt 513 Docking Structures and Accessory Structures

Env-Wt 513.02(a) Applicability

Env-Wt 513.03(a) Approval Criteria for Docking Structures

Env-Wt 513.04 (e)(1) Approval Criteria For Permanent Docking Structures

Env-Wt 513.06(a) Application Requirements for All Docking Structures

Env-Wt 513.10(a) Setback Requirements for Docking Structures

Env-Wt 513.11(a)(1)(b) Dimensions of Docking Structures

Env-Wt 513.12(a) Frontage Requirements for Private and Non-commercial Docking Structures

Env-Wt 513.14 Navigation Space for Docking Structures

Env-Wt 513.15 Design Requirements for Permanent Docking Structures

Env-Wt 513.22(a) Construction and Maintenance of Docking Structures

SECTION 8: AVOIDANCE AND MINIMIZATION

Impacts within wetland jurisdiction must be avoided to the maximum extent practicable (Env-Wt 313.03(a)). * Any project with unavoidable jurisdictional impacts must then be minimized as described in the Wetlands Best Management Practice Techniques For Avoidance and Minimization and the Wetlands Permitting: Avoidance, Minimization and Mitigation Fact Sheet. For minor or major projects, a functional assessment of all wetlands on the project site is required (Env-Wt 311.03(b)(10)). *

Please refer to the application checklist to ensure you have attached all documents related to avoidance and minimization, as well as functional assessment (where applicable). Use the Avoidance and Minimization Checklist, the Avoidance and Minimization Narrative, or your own avoidance and minimization narrative.

*See Env-Wt 311.03(b)(6) and Env-Wt 311.03(b)(10) for shoreline structure exemptions.

SECTION 9: MITIGATION REQUIREMENT (Env-Wt 311.02)

If unavoidable jurisdictional impacts require mitigation, a mitigation pre-application meeting must occur at least 30 days but not more than 90 days prior to submitting this Standard Dredge and Fill Permit Application.

Mitigation Pre-Application Meeting Date: Month: Day: Year:

☒ N/A - Mitigation is not required

SECTION 10: THE PROJECT MEETS COMPENSATORY MITIGATION REQUIREMENTS (Env-Wt 313.01(a)(1)c)

Confirm that you have submitted a compensatory mitigation proposal that meets the requirements of Env-Wt 800 for all permanent unavoidable impacts that will remain after avoidance and minimization techniques have been exercised to the maximum extent practicable: ☒ I confirm submittal.

☒ N/A - Compensatory mitigation is not required

SECTION 11 - IMPACT AREA (Env-Wt 311.04(g))

For each jurisdictional area that will be/has been impacted, provide square feet (SF) and, if applicable, linear feet (LF) of impact, and note whether the impact is after-the-fact (ATF, i.e., work was started or completed without a permit).

For intermittent and ephemeral streams, the linear footage of impact is measured along the thread of the channel. *Please note: installation of a stream crossing in an ephemeral stream may be undertaken without a permit per Rule Env-Wt 309.02(d), however other dredge or fill impacts should be included below.*

For perennial streams/rivers, the linear footage of impact is calculated by summing the lengths of disturbances to the channel and banks.

Permanent impacts are impacts that will remain after the project is complete (e.g., changes in grade or surface materials).

Temporary impacts are impacts not intended to remain (and will be restored to pre-construction condition(s)) after the project is completed.

| JURISDICTIONAL AREA | | PERMANENT | | | TEMPORARY | | |
|---------------------|--|-------------|----------|-------------------------------------|-----------|----|-------------------------------------|
| | | SF | LF | ATF | SF | LF | ATF |
| Wetlands | Forested Wetland | | | <input checked="" type="checkbox"/> | | | <input checked="" type="checkbox"/> |
| | Scrub-shrub Wetland | | | <input checked="" type="checkbox"/> | | | <input checked="" type="checkbox"/> |
| | Emergent Wetland | | | <input checked="" type="checkbox"/> | | | <input checked="" type="checkbox"/> |
| | Wet Meadow | | | <input checked="" type="checkbox"/> | | | <input checked="" type="checkbox"/> |
| | Vernal Pool | | | <input checked="" type="checkbox"/> | | | <input checked="" type="checkbox"/> |
| | Designated Prime Wetland | | | <input checked="" type="checkbox"/> | | | <input checked="" type="checkbox"/> |
| | Duly-established 100-foot Prime Wetland Buffer | | | <input checked="" type="checkbox"/> | | | <input checked="" type="checkbox"/> |
| Surface Water | Intermittent / Ephemeral Stream | | | <input checked="" type="checkbox"/> | | | <input checked="" type="checkbox"/> |
| | Perennial Stream or River | | | <input checked="" type="checkbox"/> | | | <input checked="" type="checkbox"/> |
| | Lake / Pond | | | <input checked="" type="checkbox"/> | | | <input checked="" type="checkbox"/> |
| | Docking - Lake / Pond | 1298 | 4 | <input checked="" type="checkbox"/> | | | <input checked="" type="checkbox"/> |
| | Docking - River | | | <input checked="" type="checkbox"/> | | | <input checked="" type="checkbox"/> |
| Banks | Bank - Intermittent Stream | | | <input checked="" type="checkbox"/> | | | <input checked="" type="checkbox"/> |
| | Bank - Perennial Stream / River | | | <input checked="" type="checkbox"/> | | | <input checked="" type="checkbox"/> |
| | Bank / Shoreline - Lake / Pond | | | <input checked="" type="checkbox"/> | | | <input checked="" type="checkbox"/> |
| Tidal | Tidal Waters | | | <input checked="" type="checkbox"/> | | | <input checked="" type="checkbox"/> |
| | Tidal Marsh | | | <input checked="" type="checkbox"/> | | | <input checked="" type="checkbox"/> |
| | Sand Dune | | | <input checked="" type="checkbox"/> | | | <input checked="" type="checkbox"/> |
| | Undeveloped Tidal Buffer Zone (TBZ) | | | <input checked="" type="checkbox"/> | | | <input checked="" type="checkbox"/> |
| | Previously-developed TBZ | | | <input checked="" type="checkbox"/> | | | <input checked="" type="checkbox"/> |
| | Docking - Tidal Water | | | <input checked="" type="checkbox"/> | | | <input checked="" type="checkbox"/> |
| TOTAL | | 1298 | 4 | | | | |

SECTION 12 - APPLICATION FEE (RSA 482-A:3-I)

☒ **MINIMUM IMPACT FEE:** Flat fee of \$400.

☒ **NON-ENFORCEMENT RELATED, PUBLICLY-FUNDED AND SUPERVISED RESTORATION PROJECTS, REGARDLESS OF IMPACT CLASSIFICATION:** Flat fee of \$400 (refer to RSA 482-A:3, 1(c) for restrictions).

☒ **MINOR OR MAJOR IMPACT FEE:** Calculate using the table below:

Permanent and temporary (non-docking): 1020 SF × \$0.40 = \$408

Seasonal docking structure: 278 SF × \$2.00 = \$556

Permanent docking structure: 278 SF × \$4.00 = \$1112

Projects proposing shoreline structures (including docks) add \$400 = \$400

Total = \$1920

The application fee for minor or major impact is the above calculated total or \$400, whichever is greater = \$1920

lrm@des.nh.gov or (603) 271-2147

NHDES Wetlands Bureau, 29 Hazen Drive, PO Box 95, Concord, NH, 03302-0095.

www.des.nh.gov

| | | |
|---|--|---|
| SECTION 13 - PROJECT CLASSIFICATION (Env-Wt 306.05) | | |
| Indicate the project classification: | | |
| <input type="checkbox"/> Minimum Impact Project | <input type="checkbox"/> Minor Project | <input checked="" type="checkbox"/> Major Project |
| SECTION 14 - REQUIRED CERTIFICATIONS (Env-Wt 311.11) | | |
| Initial each box below to certify: | | |
| Initials: JS CLF [Signature] | To the best of the signer's knowledge and belief, all required notifications have been provided. | |
| Initials: JS CLF [Signature] | The information submitted on or with the application is true, complete, and not misleading to the best of the signer's knowledge and belief. | |
| Initials: JS CLF [Signature] | <p>The signer understands that:</p> <ul style="list-style-type: none"> The submission of false, incomplete, or misleading information constitutes grounds for NHDES to: <ol style="list-style-type: none"> Deny the application. Revoke any approval that is granted based on the information. If the signer is a certified wetland scientist, licensed surveyor, or professional engineer licensed to practice in New Hampshire, refer the matter to the joint board of licensure and certification established by RSA 310-A:1. The signer is subject to the penalties specified in New Hampshire law for falsification in official matters, currently RSA 641. The signature shall constitute authorization for the municipal conservation commission and the Department to inspect the site of the proposed project, except for minimum impact forestry SPN projects and minimum impact trail projects, where the signature shall authorize only the Department to inspect the site pursuant to RSA 482-A:6, II. | |
| Initials: JS CLF [Signature] | If the applicant is not the owner of the property, each property owner signature shall constitute certification by the signer that he or she is aware of the application being filed and does not object to the filing. | |
| SECTION 15 - REQUIRED SIGNATURES (Env-Wt 311.04(d); Env-Wt 311.11) | | |
| SIGNATURE (OWNER): [Signature] | PRINT NAME LEGIBLY: Jeremy Stannard | DATE: 02/28/2022 |
| SIGNATURE (APPLICANT, IF DIFFERENT FROM OWNER): [Signature] | PRINT NAME LEGIBLY: [Signature] | DATE: [Signature] |
| SIGNATURE (AGENT, IF APPLICABLE): [Signature] | PRINT NAME LEGIBLY: Cynthia L. Folsom | DATE: 02/28/2022 |
| SECTION 16 - TOWN/CITY CLERK SIGNATURE (Env-Wt 311.04(f)) | | |
| As required by RSA 482-A:3, I(a)(1), I hereby certify that the applicant has filed four application forms, four detailed plans, and four USGS location maps with the town/city indicated below. | | |
| TOWN/CITY CLERK SIGNATURE: [Signature] | PRINT NAME LEGIBLY: Lisa Noyes | |
| TOWN/CITY: Ailton | DATE: 3/3/2022 | |

RECEIVED
 MAR 09 2022
 NHDES
 LAND RESOURCES MANAGEMENT

WINNIPESAUKEE

LAKE

N/E GARRETT

N/E STANNARD

FOCUS

N/E STANNARD

76

Rattlesnake Island

15

LAKE

WINNIPESAUKEE

REVISED & REPRINTED BY
 'CAI TECHNOLOGIES'
 LITTLETON, NH 03561

PROPERTY MAP
 TOWN OF ALTON
 BELKNAP COUNTY, NEW HAMPSHIRE
 PREPARED BY
 JAMES W. SEWALL COMPANY OLD TOWN, MAINE
 SCALE 1" = 100' FEET

75

TAX MAP

LEGEND
 PARCEL NUMBERS 1
 ADJACENT MAPS 2
 MATCH LINE

For Assessment Purposes
 Not to be used for Conveyance

NO PARCEL 32

Stannard Property

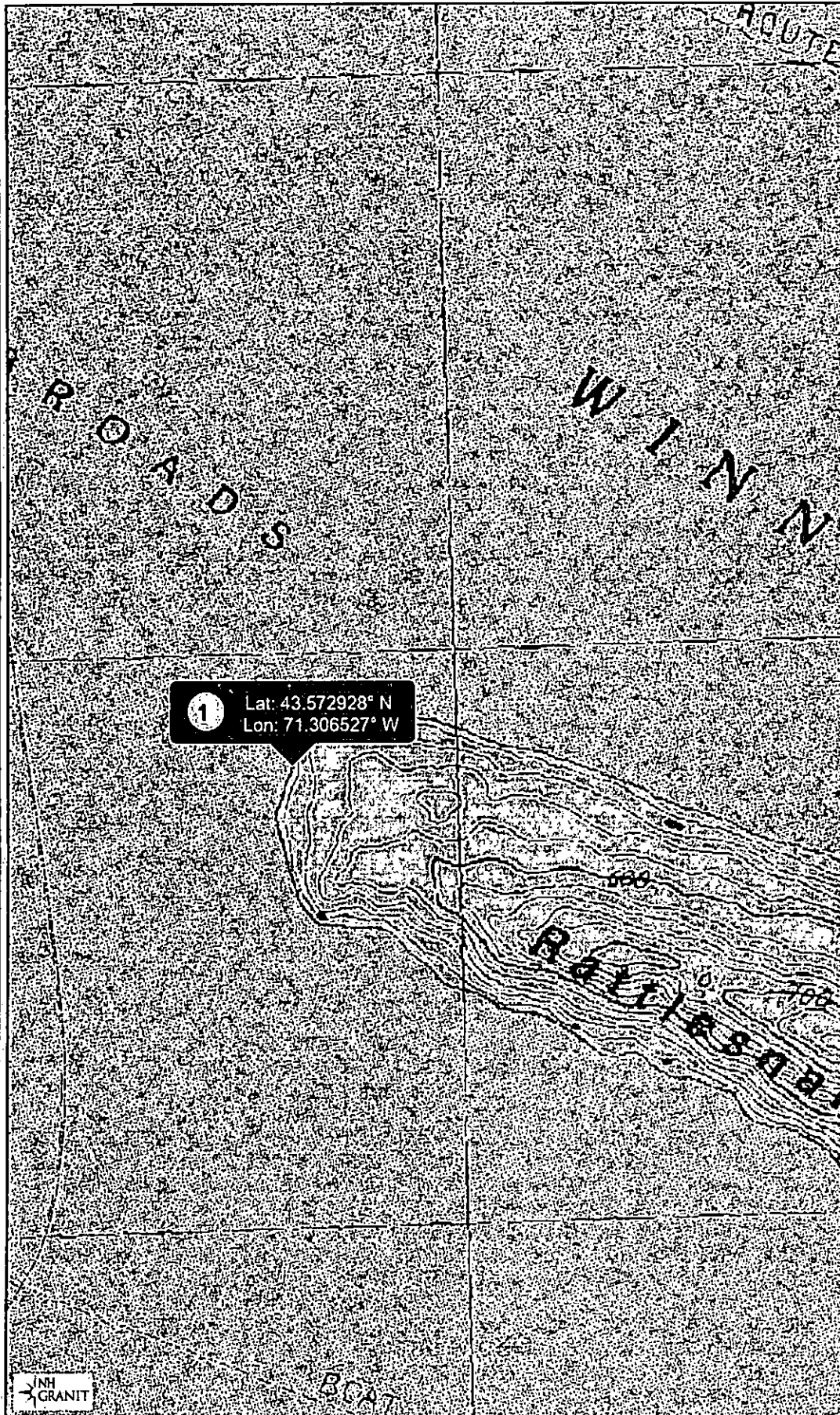

Legend

- State
- County
- City/Town

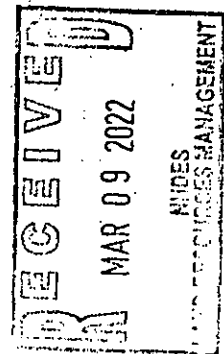

Map Scale

1: 10,000

© NH GRANIT, www.granit.unh.edu

Map Generated: 2/22/2022



Notes

Jeremy Stannard
Rattlesnake Island
Alton, NH 03809

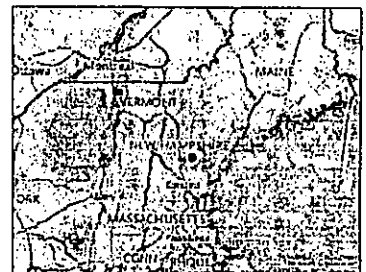

**New Hampshire Natural Heritage Bureau
NHB DataCheck Results Letter**

To: Cynthia Folsom
46 Winona Shores Road
Meredith, NH 03253

From: NH Natural Heritage Bureau

Date: 2/22/2022 (This letter is valid through 2/22/2023)

Re: Review by NH Natural Heritage Bureau of request dated 2/22/2022

Permit Type: Wetland Standard Dredge & Fill - Major

NHB ID: NHB22-0782

Applicant: Cynthia Folsom

Location: Alton
Tax Map: 75, Tax Lot: 54
Address: Rattlesnake

Proj. Description: Construct a rock breakwater with a (2) boatslip cantilevered docking structure

The NH Natural Heritage database has been checked for records of rare species and exemplary natural communities near the area mapped below. The species considered include those listed as Threatened or Endangered by either the state of New Hampshire or the federal government. We currently have no recorded occurrences for sensitive species near this project area.

A negative result (no record in our database) does not mean that a sensitive species is not present. Our data can only tell you of known occurrences, based on information gathered by qualified biologists and reported to our office. However, many areas have never been surveyed, or have only been surveyed for certain species. An on-site survey would provide better information on what species and communities are indeed present.

Based on the information submitted, no further consultation with the NH Fish and Game Department pursuant to Fis 1004 is required.

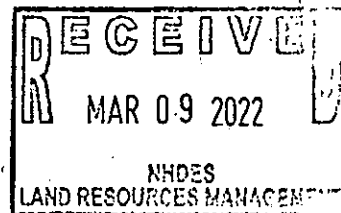

New Hampshire Natural Heritage Bureau
NHB DataCheck Results Letter

MAP OF PROJECT BOUNDARIES FOR: NHB22-0782

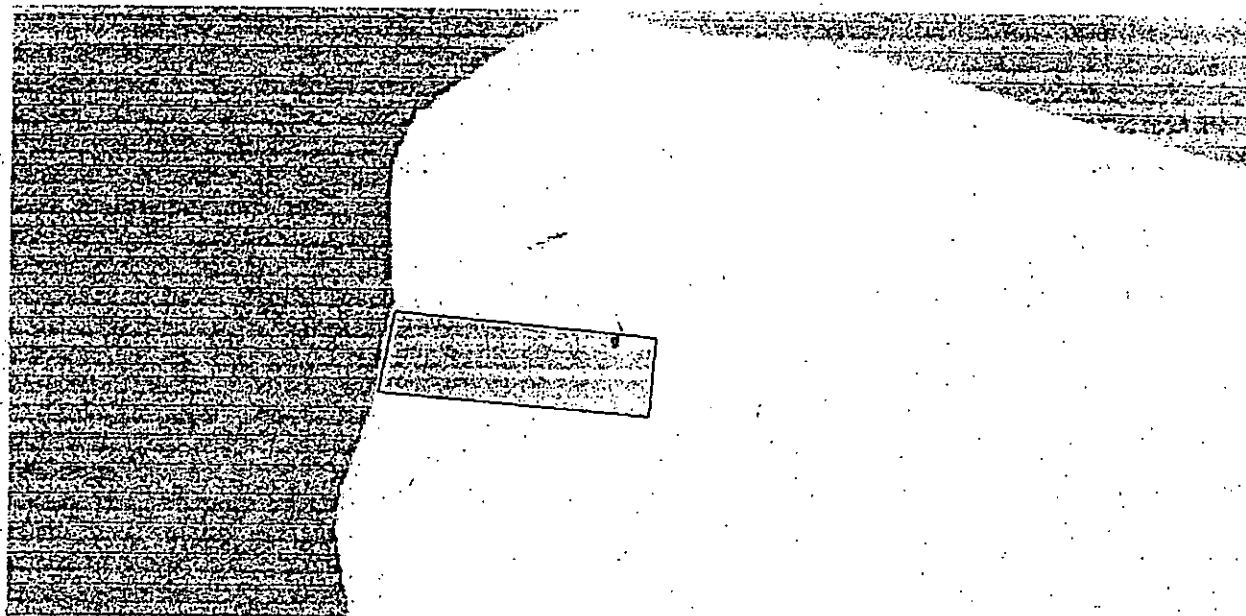

February 27, 2022

ABUTTER NOTIFICATION

RE: Stannard Property, Alton, NH
Tax Map No. 75 Lot No. 54

Dear Abutter:

Pursuant to NH RSA 482-A:3, this letter is notification of application submitted on behalf of Owners.

The proposed project consists of constructing a rock breakwater with a 4' wide cantilevered docking structure providing a total of (2) boatslips. No other work is proposed. The plans for the proposed project are on file at the town clerks office. If you should wish to view them.

If you have any questions, please do not hesitate to contact this office. We will be happy to discuss any aspect of the proposed project.

Sincerely,

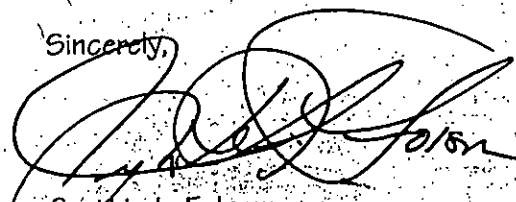

Cynthia L. Folsom
Folsom Design & Construction Management

ABUTTERS LIST:

Tax Map No. 75 Lot No. 53
Jeremy Stannard

CERTIFIED MAIL NO.:

(Also owned by applicant)

Tax Map No. 75 Lot No. 55
Nannene Erin Garrett

7014 0510 0001 4138 9402

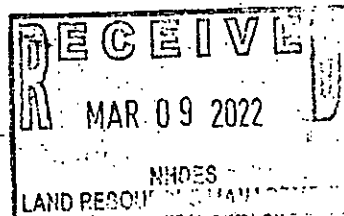

Lake Winnepesaukee
legal full lake elevation 504.32

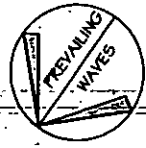

PROPOSED PERMANENT DOCKING STRUCTURE
CONSISTING OF A 4' X 52' CANTILEVERED PIER ACCESSED
BY A 4' X 16' WALKWAY (278 SQ. FT.). STRUCTURE PROVIDES
FOR (2) BOATSLIPS AS DEFINED AS 25'-X-8'-X-3'-DEEP (AS
MEASURED AT LEGAL FULL LAKE ELEVATION 504.32)

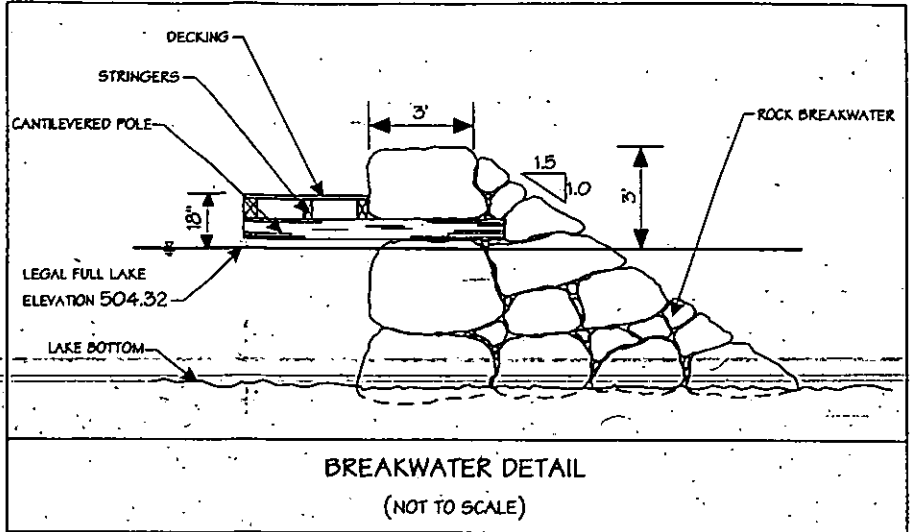

PROPOSED 70' ROCK BREAKWATER
(AS MEASURED AT LEGAL FULL LAKE ELEVATION 504.32)
(1,020 SQ. FT./ 158 CU. YDS.)

- CONSTRUCTION SEQUENCE**
1. MOBILIZE BARGE AND MATERIALS TO SITE;
 2. INSTALL APPROPRIATE SILTATION/TURBIDITY CONTROLS AROUND PROJECT AREA;
 3. CONSTRUCT BREAKWATER AND DOCKING STRUCTURE IN ACCORDANCE WITH APPROVED PLANS;
 4. REMOVE SILTATION/TURBIDITY CONTROLS ONCE SITE HAS BEEN STABILIZED

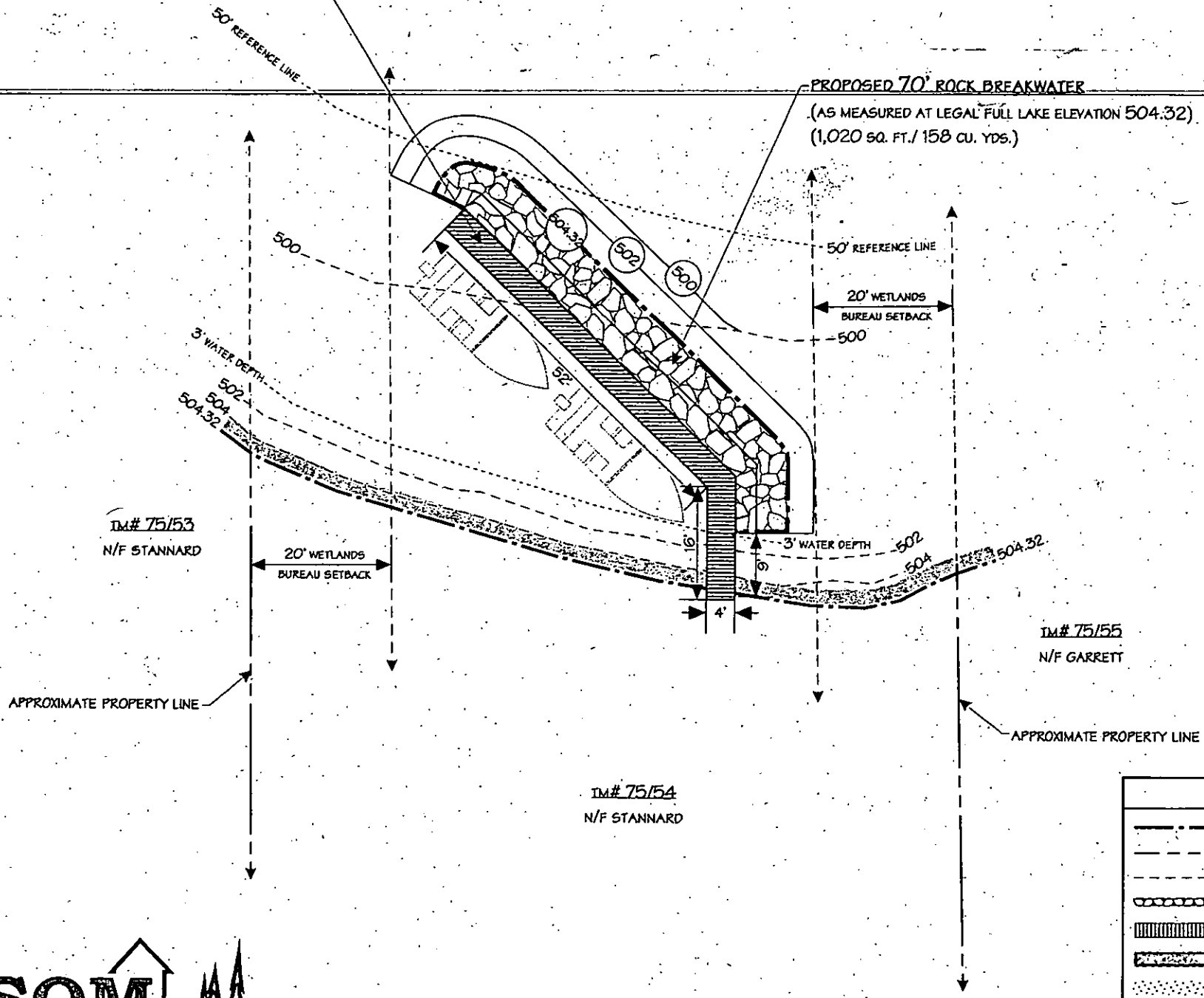

RECEIVED
MAR 09 2022
NHDES
LAND RESOURCES MANAGEMENT

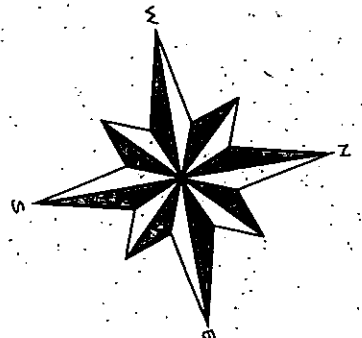

PLAN
SCALE: 1"=20'
0 10 20 40

| LEGEND: | NOTES: | PROPOSED PLAN |
|----------------------------|--|--------------------|
| LEGAL FULL LAKE ELEVATION | 1. AVERAGE SHORELINE FRONTAGE: 101'; | FOR |
| PROPERTY BOUNDARY | 2. APPROPRIATE SILTATION, EROSION, TURBIDITY CONTROLS TO BE UTILIZED | JEREMY STANNARD |
| PROPERTY LINE EXTENSION | | RATTLESNAKE ISLAND |
| ROCK WALL | | ALTON, NH 03809 |
| DECKING | | |
| SEASONAL CANOPY | | |
| BEACH SAND | | |
| IRON PIPE | | |
| IRON PIPE FOUND | | |
| PICTURE LOCATION/DIRECTION | | |