



The State of New Hampshire

## Department of Environmental Services



**Robert R. Scott, Commissioner**

October 18, 2017

His Excellency, Governor Christopher T. Sununu  
and The Honorable Council  
State House  
Concord, NH 03301

### REQUESTED ACTION

Approve Annamarie G. Vermette Revocable Trust's request to perform the following work on Lake Winnepesaukee, in Gilford. File # 2017-02074. This project will not have significant impact on or adversely affect the values of Lake Winnepesaukee.

Fill 550 sq. ft. to construct 40 linear ft. of breakwater with a 6 ft. gap at the shoreline, and repair two 6 ft. x 30 ft. piling piers connected by a 6 ft. x 12 ft. walkway in a "U" configuration, two ice clusters, two tie-off piling, and a 14 ft. x 30 ft. seasonal canopy "in-kind", install a permanent boatlift and maintain two personal watercraft lifts on an average of 150 ft. of frontage along Lake Winnepesaukee, on Governor's Island, in Gilford.

The Department imposed the following conditions as part of this approval:

1. All work shall be in accordance with plans by Watermark Marine Construction dated July 5, 2017, as received by NHDES on July 14, 2017.
2. This permit is not valid and effective until it has been recorded with the appropriate county Registry of Deeds by the applicant. Prior to starting work under this permit, the permittee shall submit a copy of the recorded permit to the NHDES Wetlands Program by certified mail, return receipt requested.
3. All development activities associated with this project shall be conducted in compliance with applicable requirements of RSA 483-B and N.H. Code of Administrative Rules Env-Wq 1400 during and after construction.
4. Work shall be carried out in a time and manner to avoid disturbances to migratory waterfowl breeding and nesting areas.
5. Appropriate turbidity controls shall be installed prior to construction, shall be maintained during construction such that no turbidity escapes the immediate dredge area and shall remain in place until suspended particles have settled and water at the work site has returned to normal clarity.
6. No portion of breakwater as measured at normal full lake (Elev. 504.32) shall extend more than 46 ft. from normal full lake shoreline.
7. The breakwater shall not exceed 3 ft. in height (Elev. 507.32) over the normal high water line (Elev. 504.32).
8. The width as measured at the top of the breakwater (Elev. 507.32) shall not exceed 3 ft.
9. This facility is permitted with the condition that future maintenance dredging, if needed, shall not be permitted more frequently than once every 6 years, and that a new permit shall be required for each dredge activity.
10. The owner understands and accepts the risk that if this facility requires dredging to maintain a minimum slip depth of 3 ft. more frequently than once every 6 years, or is shown to have an adverse impact on abutting frontages, it shall be subject to removal.

[www.des.nh.gov](http://www.des.nh.gov)

29 Hazen Drive • PO Box 95 • Concord, NH 03302-0095  
(603) 271-3503 • Fax: 271-7894 TDD Access: Relay NH 1-800-735-2964

# DES COPY WETLANDS PERMIT APPLICATION

Land Resources Management  
Wetlands Bureau

Check the status of your application: [www.des.nh.gov/onestop](http://www.des.nh.gov/onestop)



RSA/Rule: RSA 482-A/ Env-Wt 100-900

	<h2 style="margin: 0;">COMPLETE</h2> <p style="margin: 0;">JUL 14 2017</p>	<p style="margin: 0;">Administrative Use Only</p>	<p style="margin: 0; font-size: 1.2em;">2017-02074</p> <p style="margin: 0; font-size: 1.2em;">12897</p> <p style="margin: 0; font-size: 1.2em;">\$1,308.00</p> <p style="margin: 0; font-size: 1.2em;">Eric</p>
--	--	---	--

**1. REVIEW TIME:**  
Indicate your Review Time below. Refer to Guidance Document A for instructions.

Standard Review (Minimum, Minor or Major Impact)
  Expedited Review (Minimum Impact only)

**2. PROJECT LOCATION:**  
Separate applications must be filed with each municipality that jurisdictional impacts will occur in:

ADDRESS: <b>158 Edgewater Drive</b>		TOWN/CITY: <b>Gilford</b>	
TAX MAP: <b>217</b>	BLOCK: <b>011</b>	LOT: <b>000</b>	UNIT: <b>000</b>
USGS TOPO MAP WATERBODY NAME: <b>Lake Winnepesaukee</b>		<input type="checkbox"/> NA	STREAM WATERSHED SIZE: <input checked="" type="checkbox"/> NA
LOCATION COORDINATES (if known): <b>43°36'25.96"N 71°25'58.88"W</b>		<input checked="" type="checkbox"/> Latitude/Longitude <input type="checkbox"/> UTM <input type="checkbox"/> State Plane	

**3. PROJECT DESCRIPTION:**  
Provide a brief description of the project outlining the scope of work. Attach additional sheets as needed to provide a detailed explanation of your project. DO NOT rely on "See Attached" in the space provided below.

**Install a 40ft breakwater with an area of +/-550ft<sup>2</sup> (+/-100yds<sup>3</sup>). Additionally, install four support pilings for a permanent boatlift and replace or repair existing dockage and accessory pilings in-kind. This property qualifies for a breakwater under Env-Wt 402.07.**

**Turbidity control curtains shall be installed maintained for the duration of the project.**

**4. SHORELINE FRONTAGE**

NA This lot has no shoreline frontage.
 SHORELINE FRONTAGE: +/- **150ft**

Shoreline frontage is calculated by determining the average of the distances of the actual natural navigable shoreline frontage and a straight line drawn between the property lines, both of which are measured at the normal high water line.

**5. RELATED PERMITS, ENFORCEMENT, EMERGENCY AUTHORIZATION, SHORELAND, ALTERATION OF TERRAIN, ETC.**

**Permits #A-659 and #2007-00438**

**6. NATURAL HERITAGE BUREAU & DESIGNATED RIVERS:**  
See the Instructions & Required Attachments document for instructions to complete a & b below.

a. Natural Heritage Bureau File ID: NHB 17 - 2109

b.  Designated River the project is in ¼ miles of: \_\_\_\_\_; and  
date a copy of the application was sent to the Local River Management Advisory Committee: Month: \_\_\_ Day: \_\_\_ Year: \_\_\_

NA

**7. APPLICANT INFORMATION (Desired permit holder)**

LAST NAME, FIRST NAME, M.I.: **Vermette, Mike and Annamarie**

TRUST / COMPANY NAME: **Annamarie G Vermette Revocable Trust**

MAILING ADDRESS: [REDACTED]

TOWN/CITY: **Concord**

STATE: **NH**

ZIP CODE: **03301**

EMAIL or FAX: **N/A**

PHONE: **N/A**

ELECTRONIC COMMUNICATION: By initialing here: **N/A**, I hereby authorize NHDES to communicate all matters relative to this application electronically

**8. PROPERTY OWNER INFORMATION (If different than applicant)**

LAST NAME, FIRST NAME, M.I.: **Vermette, Mike and Annamarie**

TRUST / COMPANY NAME: **Annamarie G Vermette Revocable Trust**

MAILING ADDRESS: [REDACTED]

TOWN/CITY: **Concord**

STATE: **NH**

ZIP CODE: **03301**

EMAIL or FAX: **N/A**

PHONE: **N/A**

ELECTRONIC COMMUNICATION: By initialing here: **N/A**, I hereby authorize NHDES to communicate all matters relative to this application electronically

**9. AUTHORIZED AGENT INFORMATION**

LAST NAME, FIRST NAME, M.I.: **Irving, Jamie C.**

COMPANY NAME: **Watermark Marine Construction**

MAILING ADDRESS: **1218 Union Avenue**

TOWN/CITY: **Laconia**

STATE: **NH**

ZIP CODE: **03246**

EMAIL or FAX: **jci@watermarkmarine.com**

PHONE: **603-293-4000**

ELECTRONIC COMMUNICATION: By initialing here: **JCI**, I hereby authorize NHDES to communicate all matters relative to this application electronically

**10. PROPERTY OWNER SIGNATURE:**

See the Instructions & Required Attachments document for clarification of the below statements

By signing the application, I am certifying that:

1. I authorize the applicant and/or agent indicated on this form to act in my behalf in the processing of this application, and to furnish upon request, supplemental information in support of this permit application.
2. I have reviewed and submitted information & attachments outlined in the Instructions and Required Attachment document.
3. All abutters have been identified in accordance with RSA 482-A:3, I and Env-Wt 100-900.
4. I have read and provided the required information outlined in Env-Wt 302.04 for the applicable project type.
5. I have read and understand Env-Wt 302.03 and have chosen the least impacting alternative.
6. Any structure that I am proposing to repair/replace was either previously permitted by the Wetlands Bureau or would be considered grandfathered per Env-Wt 101.47.
7. I have submitted a Request for Project Review (RPR) Form ([www.nh.gov/nhdhr/review](http://www.nh.gov/nhdhr/review)) to the NH State Historic Preservation Officer (SHPO) at the NH Division of Historical Resources to identify the presence of historical/ archeological resources while coordinating with the lead federal agency for NHPA 106 compliance.
8. I authorize NHDES and the municipal conservation commission to inspect the site of the proposed project.
9. I have reviewed the information being submitted and that to the best of my knowledge the information is true and accurate.
10. I understand that the willful submission of falsified or misrepresented information to the New Hampshire Department of Environmental Services is a criminal act, which may result in legal action.
11. I am aware that the work I am proposing may require additional state, local or federal permits which I am responsible for obtaining.

  
Property Owner Signature

**Annamarie G. Vermette**  
Print name legibly

**7/7/2017**  
Date

## MUNICIPAL SIGNATURES

### 11. CONSERVATION COMMISSION SIGNATURE

The signature below certifies that the municipal conservation commission has reviewed this application, and:

1. Waives its right to intervene per RSA 482-A:11;
2. Believes that the application and submitted plans accurately represent the proposed project; and
3. Has no objection to permitting the proposed work.

<input style="width: 100%; height: 100%;" type="text"/>	Print name legibly	Date
---	--------------------	------

#### DIRECTIONS FOR CONSERVATION COMMISSION

1. Expedited review ONLY requires that the conservation commission's signature is obtained in the space above.
2. Expedited review requires the Conservation Commission signature be obtained prior to the submittal of the original application to the Town/City Clerk for signature.
3. The Conservation Commission may refuse to sign. If the Conservation Commission does not sign this statement for any reason, the application is not eligible for expedited review and the application will reviewed in the standard review time frame.

### 12. TOWN / CITY CLERK SIGNATURE

As required by Chapter 482-A:3 (amended 2014), I hereby certify that the applicant has filed four application forms, four detailed plans, and four USGS location maps with the town/city indicated below.

<input style="width: 100%; height: 100%;" type="text"/>	Jennifer L Mooney, Deputy	Gilford	7/10/17
Town/City Clerk Signature	Print name legibly	Town/City	Date

#### DIRECTIONS FOR TOWN/CITY CLERK:

Per RSA 482-A:3,1

1. For applications where "Expedited Review" is checked on page 1, if the Conservation Commission signature is not present, NHDES will accept the permit application, but it will NOT receive the expedited review time.
2. IMMEDIATELY sign the original application form and four copies in the signature space provided above;
3. Return the signed original application form and attachments to the applicant so that the applicant may submit the application form and attachments to NHDES by mail or hand delivery.
4. IMMEDIATELY distribute a copy of the application with one complete set of attachments to each of the following bodies: the municipal Conservation Commission, the local governing body (Board of Selectmen or Town/City Council), and the Planning Board; and
5. Retain one copy of the application form and one complete set of attachments and make them reasonably accessible for public review.

#### DIRECTIONS FOR APPLICANT:

1. Submit the single, original permit application form bearing the signature of the Town/ City Clerk, additional materials, and the application fee to NHDES by mail or hand delivery.

**13. IMPACT AREA**

For each jurisdictional area that will be/has been impacted, provide square feet and, if applicable, linear feet of impact.

~~Permanent impacts that will remain after the project is complete.~~

~~Temporary impacts not intended to remain (and will be restored to pre-construction conditions) after the project is complete.~~

JURISDICTIONAL AREA	PERMANENT Sq. Ft. / Lin. Ft.	TEMPORARY Sq. Ft. / Lin. Ft.
Forested wetland	<input type="checkbox"/> ATF	<input type="checkbox"/> ATF
Scrub-shrub wetland	<input type="checkbox"/> ATF	<input type="checkbox"/> ATF
Emergent wetland	<input type="checkbox"/> ATF	<input type="checkbox"/> ATF
Wet meadow	<input type="checkbox"/> ATF	<input type="checkbox"/> ATF
Intermittent stream	<input type="checkbox"/> ATF	<input type="checkbox"/> ATF
Perennial Stream / River	/	/
Lake / Pond	550 /	/
Bank - Intermittent stream	/	/
Bank - Perennial stream / River	/	/
Bank - Lake / Pond	/	/
Tidal water	/	/
Salt marsh	<input type="checkbox"/> ATF	<input type="checkbox"/> ATF
Sand dune	<input type="checkbox"/> ATF	<input type="checkbox"/> ATF
Prime wetland	<input type="checkbox"/> ATF	<input type="checkbox"/> ATF
Prime wetland buffer	<input type="checkbox"/> ATF	<input type="checkbox"/> ATF
Undeveloped Tidal Buffer Zone (TBZ)	<input type="checkbox"/> ATF	<input type="checkbox"/> ATF
Previously-developed upland in TBZ	<input type="checkbox"/> ATF	<input type="checkbox"/> ATF
Docking - Lake / Pond	4	<input type="checkbox"/> ATF
Docking - River	<input type="checkbox"/> ATF	<input type="checkbox"/> ATF
Docking - Tidal Water	<input type="checkbox"/> ATF	<input type="checkbox"/> ATF
<b>TOTAL</b>	<b>554 /</b>	<b>/</b>

**14. APPLICATION FEE:** See the Instructions & Required Attachments document for further instruction.

Minimum Impact Fee: Flat fee of \$ 200

Minor or Major Impact Fee: Calculate using the below table below

Permanent and Temporary (non-docking) \_\_\_\_\_ sq. ft. X \$0.20 = \$ \_\_\_\_\_

Temporary (seasonal) docking structure: \_\_\_\_\_ sq. ft. X \$1.00 = \$ \_\_\_\_\_

Permanent docking structure: **554** sq. ft. X \$2.00 = **\$ 1,108.00**

**Projects proposing shoreline structures (including docks) add \$200 = \$ 200.00**

Total = **\$ 1,308.00**

The Application Fee is the above calculated Total or \$200, whichever is greater = **\$ 1,308.00**

[shoreland@des.nh.gov](mailto:shoreland@des.nh.gov) or (603) 271-2147

NHDES Wetlands Bureau, 29 Hazen Drive, PO Box 95, Concord, NH 03302-0095

[www.des.nh.gov](http://www.des.nh.gov)



# Vermette Property

Gilford, NH



July 6, 2017

1 inch = 150 Feet

www.cai-tech.com

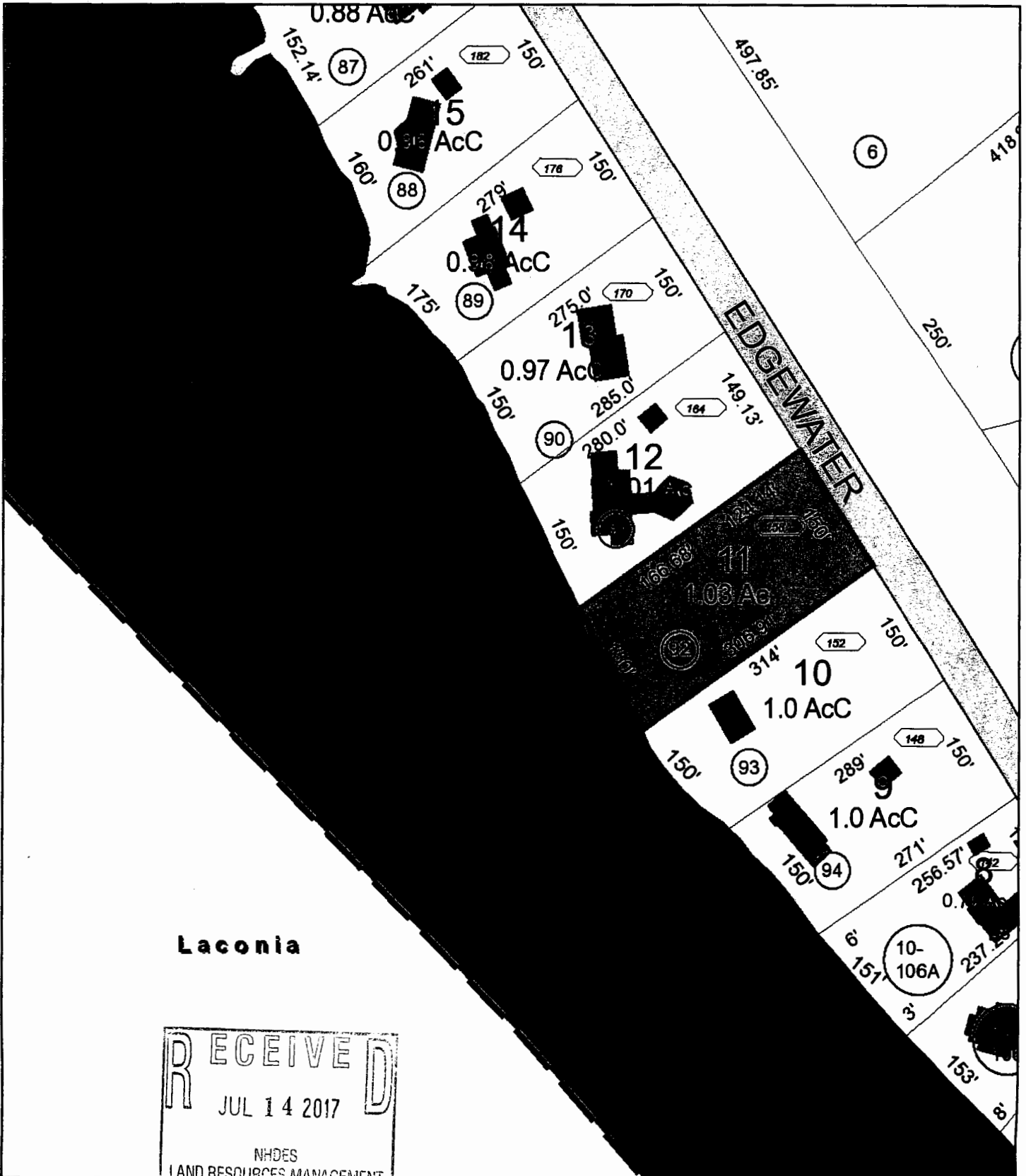

**Laconia**

**RECEIVED**  
 JUL 14 2017  
 NHDES  
 LAND RESOURCES MANAGEMENT

Data shown on this map is provided for planning and informational purposes only. The municipality and CAI Technologies are not responsible for any use for other purposes or misuse or misrepresentation of this map.

# Vermette Property

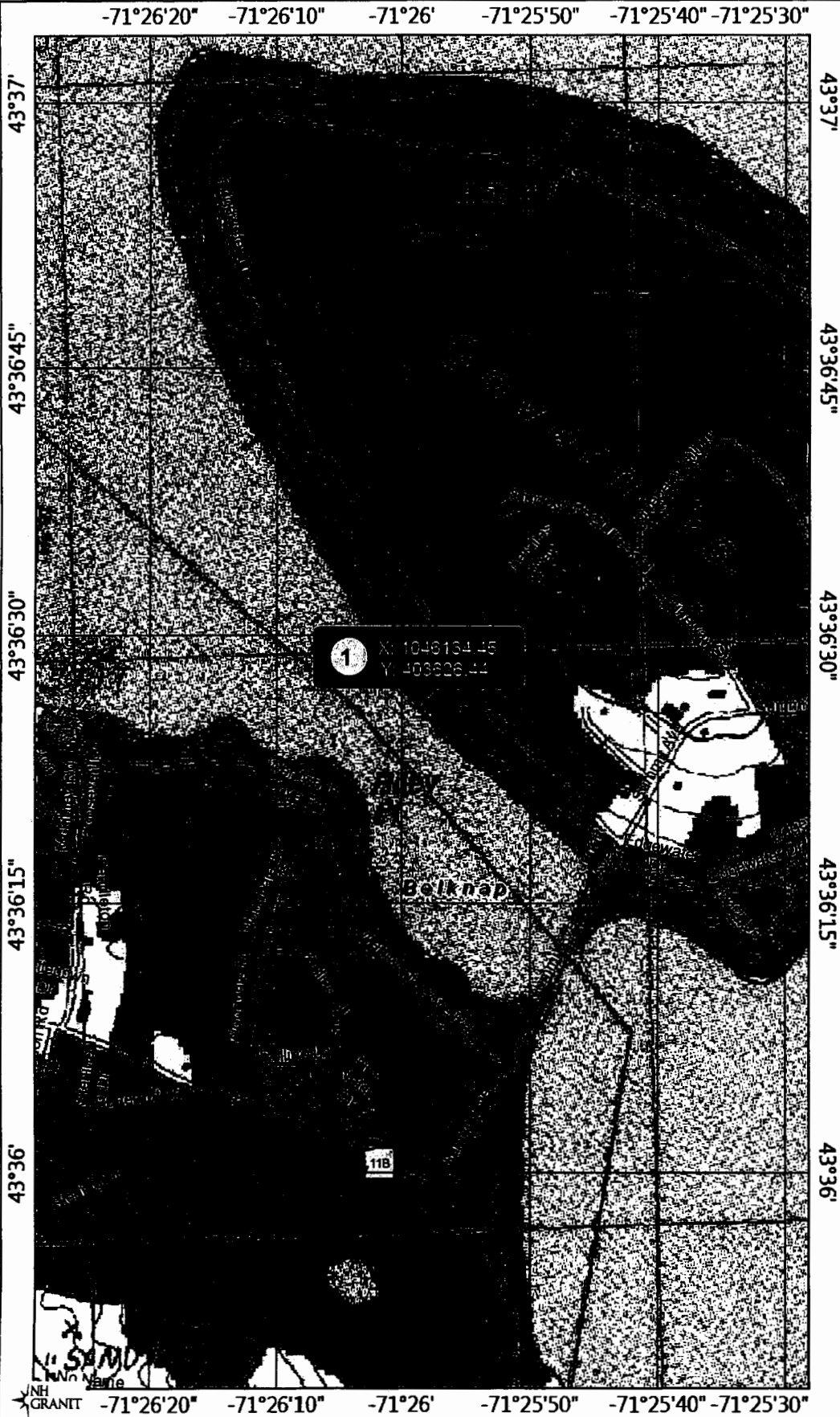

## Legend

- State
- County
- City/Town

R E C E I V E D  
 JUL 14 2017  
 NHDES  
 LAND RESOURCES MANAGEMENT

**Map Scale**  
 1: 10,000

© NH GRANIT, [www.granit.unh.edu](http://www.granit.unh.edu)  
 Map Generated: 7/6/2017

**Notes**

Mike and Annamarie Vermette  
 158 Edgewater Drive, Gilford  
 TM/L #217-011-000  
 NH Stateplane NAD83 (feet)  
 Easting: 1,046,134.45  
 Northing: 403,626.44



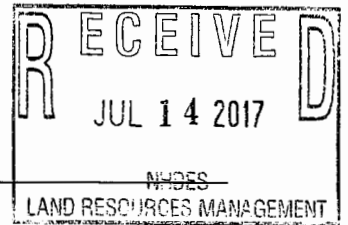

To: Jamie Irving  
Watermark Marine Construction  
PO Box 6840  
Laconia, NH 03247

Date: 7/6/2017

From: NH Natural Heritage Bureau

Re: Review by NH Natural Heritage Bureau of request dated 7/6/2017  
NHB File ID: NHB17-2109

Applicant: Mike and Annamarie  
Vermette

Location: Tax Map(s)/Lot(s): 217-011-000  
Gilford

Project Description: Install a 40ft breakwater that shall impact +/- 550ft<sup>2</sup> (+/- 100yds<sup>3</sup>). Additionally, replace or repair existing dockage and accessory pilings in-kind.

The NH Natural Heritage database has been checked for records on rare species and exemplary natural communities near the area mapped below. The species considered include those listed as Threatened or Endangered by either the state of New Hampshire or the federal government. We currently have no recorded occurrences for sensitive species near this project area.

A negative result (no record in our database) does not mean that a sensitive species is not present. Our data can only tell you of known occurrences, based on information gathered by qualified biologists and reported to our office. However, many areas have never been surveyed, or have only been surveyed for certain species. An on-site survey would provide better information on what species and communities are indeed present.

This report is valid through 7/5/2018.





**MAP OF PROJECT BOUNDARIES FOR NHB FILE ID: NHB17-2109**

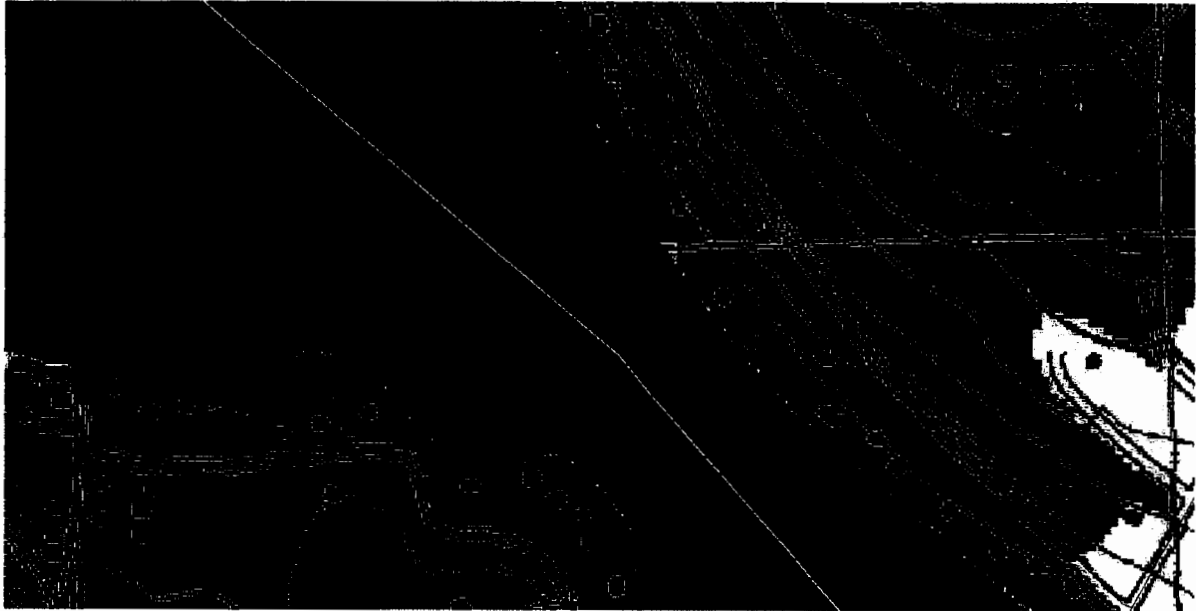



# 0 foot Abutters List Report

Gilford, NH  
July 06, 2017

### Subject Property:

Parcel Number: 217-011-000  
CAMA Number: 217-011-000  
Property Address: 158 EDGEWATER DR

Mailing Address: VERMETTE, ANNAMARIE G REV TRUST  
VERMETTE, ANNAMARIE G TTEE  
[REDACTED]  
CONCORD, NH 03301

### Abutters:

Parcel Number: 217-010-000  
CAMA Number: 217-010-000  
Property Address: 152 EDGEWATER DR

Mailing Address: RIGOLI, GARY C & JULIE A TRUSTEES  
RIGOLI, GARY TRST & JULIE TRST  
[REDACTED]  
BILLERICA, MA 01821

Parcel Number: 217-012-000  
CAMA Number: 217-012-000  
Property Address: 164 EDGEWATER DR

Mailing Address: 164 EDGEWATER DRIVE LLC  
[REDACTED]  
GILFORD, NH 03249

7017 0530 0000 9295 5146

U.S. Postal Service™ <b>CERTIFIED MAIL® RECEIPT</b> Domestic Mail Only	
For delivery information, visit our website at <a href="http://www.usps.com">www.usps.com</a>	
<b>OFFICIAL USE</b>	
Certified Mail Fee	\$ 3.35
Extra Services & Fees (check box, add fee as appropriate)	
<input type="checkbox"/> Return Receipt (hardcopy)	\$ _____
<input type="checkbox"/> Return Receipt (electronic)	\$ _____
<input type="checkbox"/> Certified Mail Restricted Delivery	\$ _____
<input type="checkbox"/> Adult Signature Required	\$ _____
<input type="checkbox"/> Adult Signature Restricted Delivery	\$ _____
Postage	\$ .46
Total Postage and Fees	\$ 3.81
Gary and Julie Rigoli [REDACTED] Billerica, MA 01821	
See Reverse for Instructions	

Postmark  
Here  
7-10-17

7017 0530 0000 9295 5139

U.S. Postal Service™ <b>CERTIFIED MAIL® RECEIPT</b> Domestic Mail Only	
For delivery information, visit our website at <a href="http://www.usps.com">www.usps.com</a>	
<b>OFFICIAL USE</b>	
Certified Mail Fee	\$ 3.35
Extra Services & Fees (check box, add fee as appropriate)	
<input type="checkbox"/> Return Receipt (hardcopy)	\$ _____
<input type="checkbox"/> Return Receipt (electronic)	\$ _____
<input type="checkbox"/> Certified Mail Restricted Delivery	\$ _____
<input type="checkbox"/> Adult Signature Required	\$ _____
<input type="checkbox"/> Adult Signature Restricted Delivery	\$ _____
Postage	\$ .46
Total Postage and Fees	\$ 3.81
164 Edgewater Drive, LLC [REDACTED] Gilford, NH 03249	
See Reverse for Instructions	

Postmark  
Here  
7-10-17

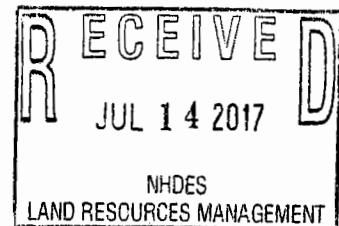

[www.cai-tech.com](http://www.cai-tech.com)

# Lake Winnepesaukee

Full Lake Shoreline 504.32

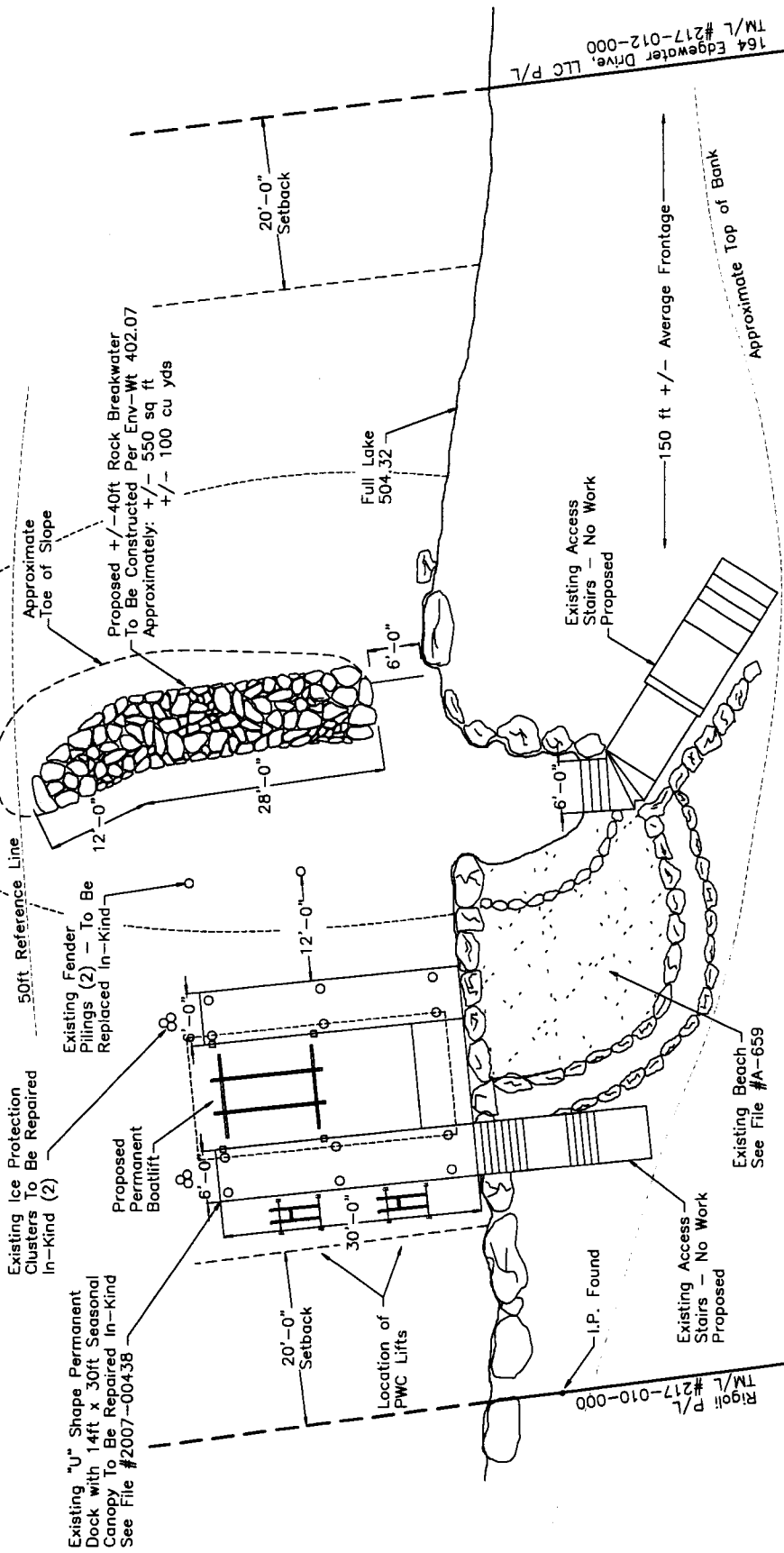

**RECEIVED**  
 JUL 14 2017  
 NHDES  
 LAND RESOURCES MANAGEMENT

Vermette Property  
 Gilford, NH  
 07/05/17 1" = 20'

