



The State of New Hampshire  
**Department of Environmental Services**

Robert R. Scott, Commissioner

JUN10'20 AM10:08 DAS



Sam

152

June 9, 2020

His Excellency, Governor Christopher T. Sununu  
and The Honorable Council  
State House  
Concord, NH 03301

**REQUESTED ACTION**

Approve Town of Seabrook's request to perform the following work on Hampton Harbor in Seabrook. File # 2020-00451. This project will not have significant impact on or adversely affect the values of Hampton Harbor.

Impact a total of 32 square feet of jurisdictional area to include 3 square feet within the previously-developed 100-foot tidal buffer zone and 29 square feet of tidal flat for the replacement of 20 existing piles, 4 sets of batter piles (8 piles) associated with the existing docking structure, and install 4 new piles to secure the existing float.

The New Hampshire Department of Environmental Services (NHDES) imposed the following conditions as part of this approval:

1. In accordance with New Hampshire Administrative Rule Env-Wt 307.16, all work shall be done in accordance with the 'NHDES Permit Plan' dated March 2, 2020 by Ambit Engineering, Inc. as received by the NH Department of Environmental Services (NHDES) on March 10, 2020.
2. In accordance with New Hampshire Administrative Rule (Rule) Env-Wt 314.02(b) and (c), for projects in the coastal area, the permittee shall record any permit issued for overwater structures, shoreline stabilization, and any work in the tidal buffer zone, tidal wetlands, or sand dunes at the Rockingham County Registry of Deeds. Any limitations or conditions in the permit so recorded shall run with the land beyond the expiration of the permit. The permittee shall provide the NHDES with a copy of the permit stamped by the registry with the book and page and date of receipt.
3. In accordance with Rule Env-Wt 307.15(a), heavy equipment shall not be operated in any jurisdictional area unless specifically authorized by this permit.
4. In accordance with Rule Env-Wt 307.15(b), mobile heavy equipment working in wetlands shall not be stored, maintained, or repaired in wetlands, except that repairing or refueling in a wetland is allowed if equipment cannot practicably be removed and secondary containment is provided.
5. In accordance with Rule Env-Wt 606.05(a), tidal docking construction shall be done in accordance with the standard conditions in New Hampshire Administrative Rule Env-Wt 307.
6. In accordance with Rule Env-Wt 606.05(b), tidal docking installation shall be done by barge or upland to prevent the driving of construction equipment in or through tidal waters/wetlands or on the bottom of the inter-tidal zone.

## EXPLANATION

The NHDES approved this project on April 30, 2020. The NHDES supported its decision with the following findings:

1. This is classified as a major project per New Hampshire Administrative Rule (Rule) Env-Wt 606.17(a)(1), for all new overwater structure construction in tidal waters/wetlands.
2. Per Rule Env-Wt 306.05, the applicant has addressed all of the required planning items that are used to determine the appropriate impact classification of a project and the type of approval required.
3. Per Rule Env-Wt 311.01(b), the applicant coordinated with the NH Fish and Game Department (NHF&G) and the Natural Heritage Bureau (NHB) to determine how to avoid and minimize project-related impacts on rare or protected animal species and habitat, and on protected plants or exemplary natural communities.
4. Per Rule 311.06(h), the municipal conservation commission did not provide comments on the proposed project.
5. Per Rule Env-Wt 313.03(a), the applicant has demonstrated that potential impacts to jurisdictional areas have been avoided to the maximum extent practicable and that any unavoidable impacts have been minimized.
6. The applicant has demonstrated specifically that each factor listed in Rule Env-Wt 313.03(b) has been considered in the design of the proposed major project.
7. Per Rule Env-Wt 606.02(a), the overwater structures have been located and designed to avoid impacts to important wetland and coastal resource functions and to minimize any impact that cannot be avoided.
8. Per Rule Env-Wt 606.03(c)(1) and (2), tidal dock infrastructure or specialized design features related to the unique function of a specific facility has been substantiated by the applicant with a justification tied to the specific purpose of the project, and certified by the applicant as meeting applicable local, industry, and legal standards.
9. Per Rule Env-Wt 606.09(a), the proposed transient public use access point structure provides a benefit to the public.
10. Per Rule Env-Wt 313.01(a)(2), all applicable conditions specified in Env-Wt 307 have been met.
11. Per Rule Env-Wt 311.06(j), the applicant has not received comments from any federal agency.
12. Per Rule Env-Wt 313.01(a)(4), all project-specific criteria established in New Hampshire Administrative Rule Env-Wt 600 have been met.
13. Per Rule Env-Wt 313.01(a)(3), all resource-specific criteria established in New Hampshire Administrative Rule Env-Wt 600 have been met.
14. Per Rule Env-Wt 202.01(b) and as required by RSA 482-A:8, the NHDES finds that the requirements for a public hearing do not apply as the project will not have a significant environmental impact, as defined in New Hampshire Administrative Rule Env-Wt 104.19, on the resources protected by RSA 482-A, or, is not of substantial public interest, as defined in New Hampshire Administrative Rule Env-Wt 104.32.

Application file documents are being forwarded to the Governor and the Executive Council in connection with their consideration of this matter pursuant to RSA 482-A:3,II.(a) as it is a major project in public waters of the state.

We respectfully request your approval of this item.



Robert R. Scott, Commissioner



**STANDARD DREDGE AND FILL  
WETLANDS PERMIT APPLICATION**  
Water Division/Land Resources Management



Wetlands Bureau

Check the Status of your Application

RSA/Rule: RSA 482-A/Env-Wt 100-900

APPLICANT'S NAME: Town of Seabrook

			File No. <u>2020-00451</u>
			Check No. <u>3235</u>
			Amount: <u>\$1528.00</u>
			Initials: <u>LSL</u>

A person may request a waiver to requirements in Rules Env-Wt 100-900 to accommodate situations where strict adherence to the requirements would not be in the best interests of the public or the environment. A person may also request a waiver of standard for existing dwellings over water pursuant to RSA 482-A:26, III (b). For more information, please consult the [request form](#).

**SECTION 1 - CONCURRENT PROCESSING OF RELATED SHORELAND/WETLANDS PERMIT APPLICATIONS (Env-Wt 313.05)**  
If the applicant is not requesting concurrent processing, please proceed to Section 2:

Is the proposed project eligible for the optional concurrent processing of related shoreland/wetlands permit applications (Env-Wt 313.05(d))? If the project is not eligible, proceed to Section 2 (the files will not be processed concurrently).  Yes  No

By signing this form and initialing this section, the applicant is requesting concurrent processing of related shoreland/wetlands permit applications and understands that concurrently filing the applications with a request to process the applications together constitutes:

- A waiver by the applicant of the shorter time frame, if application processing timelines are different for each permit program under the 2 statutes and their implementing rules; and Initials:
- An agreement by the applicant that any request for additional information by the department under either or both statutes shall affect the review timeframe of both applications being processed together. Initials:

**SECTION 2 - REQUIRED PLANNING FOR ALL PROJECTS (Env-Wt 306.05)**  
Please use the Wetland Permit Planning Tool (WPPT) or any other database or source to assist in identifying key features such as priority resource areas (PRA), protected species or habitat, coastal area, or designated river, or designated prime wetlands.

**Step 1:** A certified wetland scientist must delineate and classify all wetlands and identify the predominant resource functions of each wetland, unless the exceptions listed in Env-Wt 306.05(a)(1) are met (Env-Wt 306.05(a)(1)).

[lrn@des.nh.gov](mailto:lrn@des.nh.gov) or (603) 271-2147

NHDES Wetlands Bureau, 29 Hazen Drive, PO Box 95, Concord, NH 03302-0095

[www.des.nh.gov](http://www.des.nh.gov)

**Step 2: Determine whether the subject property is or contains a PRA by answering the following questions (Env-Wt 306.05(a)(2)):**

- 1. Does the property contain any documented occurrences of protected species or habitat for such species? Please use the Natural Heritage Bureau (NHB) DataCheck Tool to make this determination.  Yes  No
- 2. Is the property a bog? Please use the WPPT "Peatland" layer (under the PRA module) for general location of bogs or any other database or source.  Yes  No
- 3. Is the property a floodplain wetland contiguous to a tier 3 or higher watercourse? Please use the WPPT "Floodplain Wetlands Adjacent to Tier 3 Streams" layer (under PRA module) or any other database or source.  Yes  No
- 4. Is the property a designated prime wetland or a duly-established 100-foot buffer? Please use the WPPT "Prime Wetlands" layers (under PRA module) or any other database or source.  Yes  No
- 5. Is the property a sand dune, tidal wetland, tidal water, or undeveloped tidal buffer zone? Please use the WPPT "Coastal" layers module and PRA module or any other database or source.  Yes  No

**Step 3: For projects that are subject to Env-Wt 600, please attach the Coastal Functional Assessment (Env-Wt 603.04) and Vulnerability Assessment (Env-Wt 603.05) and conduct the data screening required by Env-Wt 603.03.**

**Step 4: Determine whether the following apply to the subject property (Env-Wt 306.05(a)(4); RSA 482-A:3, I(d)(2)):**

- 1. Is the property within a Local River Management Advisory Committee (LAC) jurisdiction?
  - If yes, please provide the following information:
    - The project is within ¼ mile of:   Yes  No
    - A copy of the application was sent to the LAC on Month:  Day:  Year: 
      - N/A (Env-Wt 311.01(e))
- 2. Is the property within or contains any areas that are subject to time of year restrictions under Env-Wt 307?  Yes  No

**Step 5: For stream crossing projects: what is the size of the watershed (Env-Wt 306.05(a)(5))?**

N/A

**Step 6: For dredge projects: is the subject property contaminated (Env-Wt 306.05(a)(6))?**  Yes  No

N/A

**Step 7: Does the project have the potential to impact any of the following (Env-Wt 306.05(a)(7)):**

N/A

- 1. Impaired waters?  Yes  No
- 2. Class A waters?  Yes  No
- 3. Outstanding resource waters?  Yes  No

**SECTION 3 - PROJECT DESCRIPTION (Env-Wt 311.04(i))**

Provide a brief description of the project and the purpose of the project, outlining the scope of work to be performed and whether impacts are temporary or permanent. DO NOT reply "See attached" in the space provided below.

The project proposes 29 sq. ft. of permanent impact to tidal wetland and 3 sq. ft. of permanent impact to the previously developed 100' Tidal Buffer Zone for the replacement of 20 piles, 4 sets of batter piles (8 piles) associated with the existing tidal docking structure, and the installation of 4 new piles to secure the existing float.

<b>SECTION 4 - PROJECT LOCATION</b>			
Separate wetland permit applications must be submitted for each municipality within which wetland impacts occur.			
ADDRESS: <u>6 River Street</u>		TOWN/CITY: <u>Seabrook</u>	
TAX MAP/BLOCK/LOT/UNIT: <u>Map 23 Lot 6</u>			
UNITED STATES GEOLOGICAL SURVEY (USGS) TOPO MAP WATERBODY NAME: <u>Hampton Harbor</u>			
<input type="checkbox"/> N/A			
LATITUDE (D.ddddd): <u>X:1:210.847.5920</u> ° North (Optional)		LONGITUDE (D.ddddd): <u>Y:142.468.2855</u> ° West (Optional)	
<b>SECTION 5 - APPLICANT (DESIRED PERMIT HOLDER) INFORMATION (Env-Wt 311.04(a))</b>			
If the applicant is a trust or a company, then the name of the trust or company should be written as the applicant's name.			
NAME: <u>Town of Seabrook</u> <u>G/O John Starkey</u>			
MAILING ADDRESS: <u>PO Box 456</u>			
TOWN/CITY: <u>Seabrook</u>		STATE: <u>NH</u>	ZIP CODE: <u>03874</u>
EMAIL ADDRESS: <u>jmstarkey@seabrooknh.org</u>		FAX: <input type="text"/>	PHONE: <u>603-918-4181</u>
ELECTRONIC COMMUNICATION: By initialing here: <input type="checkbox"/> I hereby authorize NHDES to communicate all matters relative to this application electronically.			
<b>SECTION 6 - AUTHORIZED AGENT INFORMATION (Env-Wt 311.04(c))</b>			
<input type="checkbox"/> N/A			
LAST NAME, FIRST NAME, M.I.: <u>Riker, Steven, D.</u> <u>Ambit Engineering, Inc.</u>			
COMPANY NAME: <u>Ambit Engineering, Inc.</u>		MAILING ADDRESS: <u>200 Griffin Road</u>	
TOWN/CITY: <u>Portsmouth</u>		STATE: <u>NH</u>	ZIP CODE: <u>03801</u>
EMAIL ADDRESS: <u>sdr@ambitengineering.com</u>		FAX: <input type="text"/>	PHONE: <u>603-430-9282</u>
ELECTRONIC COMMUNICATION: By initialing here <u>SR</u> I hereby authorize NHDES to communicate all matters relative to this application electronically.			
<b>SECTION 7 - PROPERTY OWNER INFORMATION (IF DIFFERENT THAN APPLICANT) (Env-Wt 311.04(b))</b>			
If the owner is a trust or a company, then the name of the trust or company should be written as the owner's name.			
<input type="checkbox"/> Same as applicant			
NAME: <input type="text"/>			
MAILING ADDRESS: <input type="text"/>			
TOWN/CITY: <input type="text"/>		STATE: <input type="text"/>	ZIP CODE: <input type="text"/>
EMAIL ADDRESS: <input type="text"/>		FAX: <input type="text"/>	PHONE: <input type="text"/>

lrm@des.nh.gov or (603) 271-2147

NHDES Wetlands Bureau, 29 Hazen Drive, PO Box 95, Concord, NH 03302-0095

www.des.nh.gov

ELECTRONIC COMMUNICATION: By initialing here  I hereby authorize NHDES to communicate all matters relative to this application electronically.

**SECTION 8 - RESOURCE-SPECIFIC CRITERIA ESTABLISHED IN Env-Wt 400, Env-Wt 500, Env-Wt 600, Env-Wt 700, OR Env-Wt 900 HAVE BEEN MET (Env-Wt 313.01(a)(3)).**

Describe how the resource-specific criteria have been met (please attach information about stream crossings, coastal resources, prime wetlands, or non-tidal wetlands and surface waters).

Please see attached narrative.

**SECTION 9 - AVOIDANCE AND MINIMIZATION**

Impacts within wetland jurisdiction must be avoided to the maximum extent practicable (Env-Wt 313.03(a)). If all impacts cannot be avoided, a functional assessment is required for minor and major projects (Env-Wt 311.03(b)(10)). Any project with unavoidable jurisdictional impacts must then be minimized as described in the Wetlands Best Management Practice Techniques For Avoidance and Minimization. Please refer to the application checklist to ensure that you have attached all documents related to avoidance and minimization, as well as functional assessment (where applicable).

**SECTION 10 - MITIGATION REQUIREMENT (Env-Wt 311.02)**

If unavoidable jurisdictional impacts require mitigation, a mitigation pre-application meeting must occur at least 30 days but not more than 90 days prior to submitting this Standard Dredge and Fill Permit Application.

Mitigation Pre-Application Meeting Date: Month:  Day:  Year:

N/A - Mitigation is not required

**SECTION 11 - THE PROJECT MEETS COMPENSATORY MITIGATION REQUIREMENTS (Env-Wt 313.01(a)(1)c)**

Have you submitted a compensatory mitigation proposal that meets the requirements of Env-Wt 800 for all permanent impacts that will remain after avoidance and minimization demonstration?

Yes  No

N/A - Mitigation is not required

**SECTION 12 - IMPACT AREA (Env-Wt 311.04(g))**

For each jurisdictional area that will be/has been impacted, provide square feet (SF) and, if applicable, linear feet (LF) of impact, and note whether the impact is after-the-fact (ATF; i.e., work was started or completed without required permitting).

For intermittent streams, the linear footage of impact is measured along the thread of the channel.

For perennial streams/rivers, the linear footage of impact is calculated by summing the lengths of disturbances to the channel and banks.

Permanent impacts are impacts that will remain after the project is complete (e.g., changes in grade or surface materials).

Temporary impacts are impacts not intended to remain (and will be restored to pre-construction conditions) after the project is completed.

JURISDICTIONAL AREA	PERMANENT SF / LF		TEMPORARY SF / LF	
Forested Wetland		<input checked="" type="checkbox"/> ATF		<input type="checkbox"/> ATF
Scrub-shrub Wetland		<input checked="" type="checkbox"/> ATF		<input type="checkbox"/> ATF
Emergent Wetland		<input checked="" type="checkbox"/> ATF		<input type="checkbox"/> ATF
Wet Meadow		<input checked="" type="checkbox"/> ATF		<input type="checkbox"/> ATF
Intermittent Stream		<input checked="" type="checkbox"/> ATF		<input type="checkbox"/> ATF
Perennial Stream or River		<input checked="" type="checkbox"/> ATF		<input type="checkbox"/> ATF
Lake / Pond		<input checked="" type="checkbox"/> ATF		<input type="checkbox"/> ATF
Bank - Intermittent Stream		<input checked="" type="checkbox"/> ATF		<input type="checkbox"/> ATF
Bank - Perennial Stream / River		<input checked="" type="checkbox"/> ATF		<input type="checkbox"/> ATF
Bank/shoreline - Lake / Pond		<input checked="" type="checkbox"/> ATF		<input type="checkbox"/> ATF
Tidal Waters		<input checked="" type="checkbox"/> ATF		<input type="checkbox"/> ATF
Tidal Marsh		<input checked="" type="checkbox"/> ATF		<input type="checkbox"/> ATF
Sand Dune		<input checked="" type="checkbox"/> ATF		<input type="checkbox"/> ATF
Designated Prime Wetland		<input checked="" type="checkbox"/> ATF		<input type="checkbox"/> ATF
Duly-established 100-foot Prime Wetland Buffer		<input checked="" type="checkbox"/> ATF		<input type="checkbox"/> ATF
Undeveloped Tidal Buffer Zone (TBZ)		<input checked="" type="checkbox"/> ATF		<input type="checkbox"/> ATF
Previously-developed TBZ	3	<input checked="" type="checkbox"/> ATF		<input type="checkbox"/> ATF
Docking - Lake / Pond		<input checked="" type="checkbox"/> ATF		<input type="checkbox"/> ATF
Docking - River		<input checked="" type="checkbox"/> ATF		<input type="checkbox"/> ATF
Docking - Tidal Water	29	<input checked="" type="checkbox"/> ATF		<input type="checkbox"/> ATF
Vernal Pool		<input checked="" type="checkbox"/> ATF		<input type="checkbox"/> ATF
TOTAL	32 /			

**SECTION 13 - APPLICATION FEE (RSA 482-A:3, I)**

MINIMUM IMPACT FEE: Flat fee of \$400

NON-ENFORCEMENT RELATED, PUBLICLY-FUNDED AND SUPERVISED RESTORATION PROJECTS, REGARDLESS OF IMPACT CLASSIFICATION: Flat fee of \$400 (refer to RSA 482-A:3, 1(c) for restrictions)

MINOR OR MAJOR IMPACT FEE: Calculate using the table below:

Permanent and temporary (non-docking):  SF × \$0.40 = \$

irm@des.nh.gov or (603) 271-2147

NHDES Wetlands Bureau, 29 Hazen Drive, PO Box 95, Concord, NH 03302-0095

www.des.nh.gov

Seasonal docking structure: <input type="checkbox"/> SF		x \$2.00 = \$ <input type="checkbox"/>
Permanent docking structure: <input checked="" type="checkbox"/> 32 SF		x \$4.00 = \$ <u>128.00</u>
Projects proposing shoreline structures (including docks) add \$400 =		\$ <u>400.00</u>
		Total = \$ <u>528.00</u>
The application fee for minor or major impact is the above calculated total or \$400, whichever is greater = \$ <input type="checkbox"/>		
<b>SECTION 14 - PROJECT CLASSIFICATION (Env-Wt 306.05)</b>		
Indicate the project classification:		
<input type="checkbox"/> Minimum Impact Project	<input type="checkbox"/> Minor Project	<input checked="" type="checkbox"/> Major Project
<b>SECTION 15 - ALL APPLICABLE CONDITIONS IN Env-Wt 307 HAVE BEEN MET (Env-Wt 311.04(j); Env-Wt 313.01(a)(2)).</b>		
Check all conditions applicable to your project below. Please ensure that your plan design and access, construction sequence, and timing appropriately meet applicable conditions below:		
<input checked="" type="checkbox"/> Env-Wt 307.02	US Army Corps of Engineers (USACE) Conditions	<input type="checkbox"/> Env-Wt 307.11 Filling Activity Conditions
<input checked="" type="checkbox"/> Env-Wt 307.03	Protection of Water Quality Required	<input checked="" type="checkbox"/> Env-Wt 307.12 Restoring Temporary Impacts: Site Stabilization
<input checked="" type="checkbox"/> Env-Wt 307.04	Protection of Fisheries and Breeding Areas Required	<input checked="" type="checkbox"/> Env-Wt 307.13 Property Line Setbacks
<input checked="" type="checkbox"/> Env-Wt 307.05	Protection Against Invasive Species Required	<input checked="" type="checkbox"/> Env-Wt 307.14 Rock Removal
<input checked="" type="checkbox"/> Env-Wt 307.06	Protection of Rare, Threatened or Endangered Species and Critical Habitat	<input type="checkbox"/> Env-Wt 307.15 Use of Heavy Equipment in Wetlands
<input checked="" type="checkbox"/> Env-Wt 307.07	Consistency Required with Shoreland Water Quality Protection Act	<input checked="" type="checkbox"/> Env-Wt 307.16 Adherence to Approved Plans Required
<input checked="" type="checkbox"/> Env-Wt 307.08	Protection of Designated Prime Wetlands and Duly-Established 100-Foot Buffers	<input type="checkbox"/> Env-Wt 307.17 Unpermitted Activities
<input checked="" type="checkbox"/> Env-Wt 307.09	Shoreline Structures	<input checked="" type="checkbox"/> Env-Wt 307.18 Reports
<input checked="" type="checkbox"/> Env-Wt 307.10	Dredging Activity Conditions	



Provide an explanation as to methods, timing, and manner as to how your project will meet standard permit conditions required in Env-Wt 307 (Env-Wt 311.03(b)(7)):  
Please see attached narrative.

**SECTION 16- REQUIRED CERTIFICATIONS (Env-Wt 311:11)**

Initial each box below to certify:

Initials: <i>SL</i>	To the best of the signer's knowledge and belief, all required notifications have been provided.
Initials: <i>SL</i>	The information submitted on or with the application is true, complete, and not misleading to the best of the signer's knowledge and belief.
Initials: <i>SL</i>	<p>The signer understands that:</p> <ul style="list-style-type: none"> <li>The submission of false, incomplete, or misleading information constitutes grounds for NHDES to:                     <ol style="list-style-type: none"> <li>Deny the application.</li> <li>Revoke any approval that is granted based on the information. And</li> <li>If the signer is a certified wetland scientist, licensed surveyor, or professional engineer licensed to practice in New Hampshire, refer the matter to the joint board of licensure and certification established by RSA 310-A:1.</li> </ol> </li> <li>The signer is subject to the penalties specified in New Hampshire law for falsification in official matters, currently RSA 641.</li> <li>The signature shall constitute authorization for the municipal conservation commission and the Department to inspect the site of the proposed project, except for minimum impact trail projects, where the signature shall authorize only the Department to inspect the site pursuant to RSA 482-A:6, II.</li> </ul>
Initials: <i>SL</i>	If the applicant is not the owner of the property, each property owner signature shall constitute certification by the signer that he or she is aware of the application being filed and does not object to the filing.

**SECTION 17- REQUIRED SIGNATURE (Env-Wt 311.04(d); Env-Wt 311:11)**

SIGNATURE (OWNER): 	PRINT NAME LEGIBLY: 	DATE: 
SIGNATURE (APPLICANT, IF DIFFERENT FROM OWNER): 	PRINT NAME LEGIBLY: 	DATE: 
SIGNATURE (AGENT, IF APPLICABLE): 	PRINT NAME LEGIBLY: Steven D. Riker	DATE: 3/5/2020

irm@des.nh.gov or (603) 271-2147

NHDES Wetlands Bureau, 29 Hazen Drive, PO Box 95, Concord, NH 03302-0095

[www.des.nh.gov](http://www.des.nh.gov)

<b>SECTION 18: TOWN/CITY CLERK SIGNATURE (Env-Wt 311.04(f))</b>	
As required by RSA 482-A:3, I(a),(1), I hereby certify that the applicant has filed four application forms, four detailed plans, and four USGS location maps with the town/city indicated below.	
TOWN/CITY CLERK SIGNATURE: <i>[Signature]</i>	PRINT NAME LEGIBLY <i>Cheryl L. Bower</i>
TOWN/CITY: <i>Seabrook NH</i>	DATE: <i>03/06/20</i>

**DIRECTIONS FOR TOWN/CITY CLERK:**  
Per RSA 482-A:3, I(a)(1)

1. IMMEDIATELY sign the original application form and four copies in the signature space provided above.
2. Return the signed original application form and attachments to the applicant so that the applicant may submit the application form and attachments to NHDES by mail or hand delivery.
3. IMMEDIATELY distribute a copy of the application with one complete set of attachments to each of the following bodies: the municipal Conservation Commission, the local governing body (Board of Selectmen or Town/City Council), and the Planning Board. And
4. Retain one copy of the application form and one complete set of attachments and make them reasonably accessible for public review.

**DIRECTIONS FOR APPLICANT:**

Submit the single, original permit application form bearing the signature of the Town/City Clerk, additional materials, and the application fee to NHDES by mail or hand delivery at the address at the bottom of this page.

**APPLICATION CHECKLIST**

(Items identified with an asterisk (\*) are required only for Minor and Major Projects)

- The completed, dated, signed and certified application (Env-Wt 311.03(b)(1)).
- Correct fee as determined in RSA 482-A:3, I(b) or (c), subject to any cap established by RSA 482-A:3, X (Env-Wt 311.03(b)(2)).
- USACE "Appendix B, New Hampshire General Permits (GPs), Required Information and Corps Secondary Impacts Checklist" and its required attachments (Env-Wt 307.02).
- The results of actions required by Env-Wt 311.01 as part of an application preparation for a standard permit (Env-Wt 311.03(b)(3)).
- Project plans described in Env-Wt 311.05 (Env-Wt 311.03(b)(4)).
- Maps, or electronic shape files and meta data, and other attachments specified in Env-Wt 311.06 (Env-Wt 311.03(b)(5)).
- Explanation as to methods, timing, and manner as to how the project will meet standard permit conditions required in Env-Wt 307 (Env-Wt 311.03(b)(7)).
- If applicable, the information regarding proposed compensatory mitigation specified in Env-Wt 311.08 and Chapter Env-Wt 800 – Mitigation Worksheet, unless not required under Env-Wt 313.04 (Env-Wt 311.03(b)(8); Env-Wt 311.08; Env-Wt 313.04).
- Any additional information specific to the type of resource as specified in Env-Wt 311.09 (Env-Wt 311.03(b)(9); Env-Wt 311.04(j)).
- Project specific information required by Env-Wt 500, Env-Wt 600, and Env-Wt 900 (Env-Wt 311.03(b)(11)).
- A list containing the name, mailing address and tax map/lot number of each abutter to the subject property (Env-Wt 311.03(b)(12)).
- Copies of certified postal receipts or other proof of receipt of the notices that are required by RSA 482-A:3, I(d) (Env-Wt 311.03(b)(13)).
- Project design considerations required by Env-Wt 313 (Env-Wt 311.04(j)).

[irm@des.nh.gov](mailto:irm@des.nh.gov) or (603) 271-2147

NHDES Wetlands Bureau, 29 Hazen Drive, PO Box 95, Concord, NH 03302-0095

[www.des.nh.gov](http://www.des.nh.gov)

- Town tax map showing the subject property, the location of the project on the property, and the location of properties of abutters with each lot labeled with the name and mailing address of the abutter (Env-Wt 311.06(a)).
  - Dated and labeled color photographs that:
    - (1) Clearly depict:
      - a. All jurisdictional areas, including but not limited to portions of wetland, shoreline, or surface water where impacts have or are proposed to occur. And
      - b. All existing shoreline structures. And
    - (2) Are mounted or printed no more than 2 per sheet on 8.5 x 11 inch sheets (Env-Wt 311.06(b)).
  - A copy of the appropriate USGS map or updated data based on LiDAR at a scale of one inch equals 24,000 feet showing the location of the subject property and proposed project (Env-Wt 311.06(c)).
  - A narrative that describes the work sequence, including pre-construction through post-construction, and the relative timing and progression of all work (Env-Wt 311.06(d)).
  - For all coastal projects, include a copy of the recorded deed with book and page numbers for the property (Env-Wt 311.06(e)).
- 
- If the applicant is not the owner in fee of the subject property, documentation of the applicant's legal interest in the subject property, provided that for utility projects in a utility corridor, such documentation may comprise a list that:
    - (1) Identifies the county registry of deeds and book and page numbers of all of the easements or other recorded instruments that provide the necessary legal interest. And
    - (2) Has been certified as complete and accurate by a knowledgeable representative of the applicant (Env-Wt 311.06(f)).
  - The NHB memo containing the NHB identification number and results and recommendations from NHB as well as any written follow-up communications such as additional memos or email communications with either NHB or New Hampshire Fish and Game Department (NHF&G) (Env-Wt 311.06(g)).
  - A statement of whether the applicant has received comments from the local conservation commission and, if so, how the applicant has addressed the comments (Env-Wt 311.06(h)).
  - For projects in LAC jurisdiction, a statement of whether the applicant has received comments from the LAC and, if so, how the applicant has addressed the comments (Env-Wt 311.06(i)).
  - If the applicant is also seeking to be covered by the state general permits, a statement of whether comments have been received from any federal agency and, if so, how the applicant has addressed the comments (Env-Wt 311.06(j)).
  - For after-the-fact applications: information required by Env-Wt 311.12 (Env-Wt 311.12).
  - Coastal Resource Worksheet for coastal projects as required under Env-Wt 600.
  - Prime Wetlands information required under Env-Wt 700.
  - Stream Crossing Worksheet required by Env-Wt 900.
  - Avoidance and Minimization Written Narrative, Avoidance and Minimization Checklist, or your own avoidance and minimization narrative (Env-Wt 311.07).
  - \* Attachment A: Minor and Major Projects (Env-Wt 311.10).
  - \* Functional Assessment (Env-Wt 311.10).

5 March, 2020

To Whom It May Concern:

**RE: State of New Hampshire Department of Environmental Services  
Application for proposed docking structure within the previously developed 100'  
Tidal Buffer Zone and jurisdictional wetlands for Town of Seabrook C/O John  
Starkey for the Town Pier, River Street, Seabrook, NH 03874**

This letter is to inform the State of New Hampshire DES and the Town of Seabrook  
in accordance with State Law that the following entities:

Riverside Marine Construction, Inc.  
Ambit Engineering, Inc.

Are individually authorized to represent us as our agents in the approval process.

Please feel free to call me if there is any question regarding this authorization.

Sincerely,

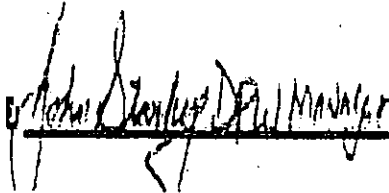
A handwritten signature in black ink that reads "John Starkey DEPT. MANAGER". The signature is written over a horizontal line.

*Town of Seabrook, NH  
Authorized Representative  
John Starkey  
PO Box 456  
Seabrook, NH 03874*



- USA Outline
- Complete Pipes - w/ Catch
- Lot
- Parcels
- Town Boundary
- MA Highways
- MA Interstate
- MA US Highway
- MA Numbered Routes
- NH Highways
- NH Interstate
- NH US Highway
- NH State Highway
- Street Lines
- NH Open Water
- NH Abutting Towns - No Tr
- MA Abutting Towns - No Tr
- Town Mask

21-22-25

26-97-0

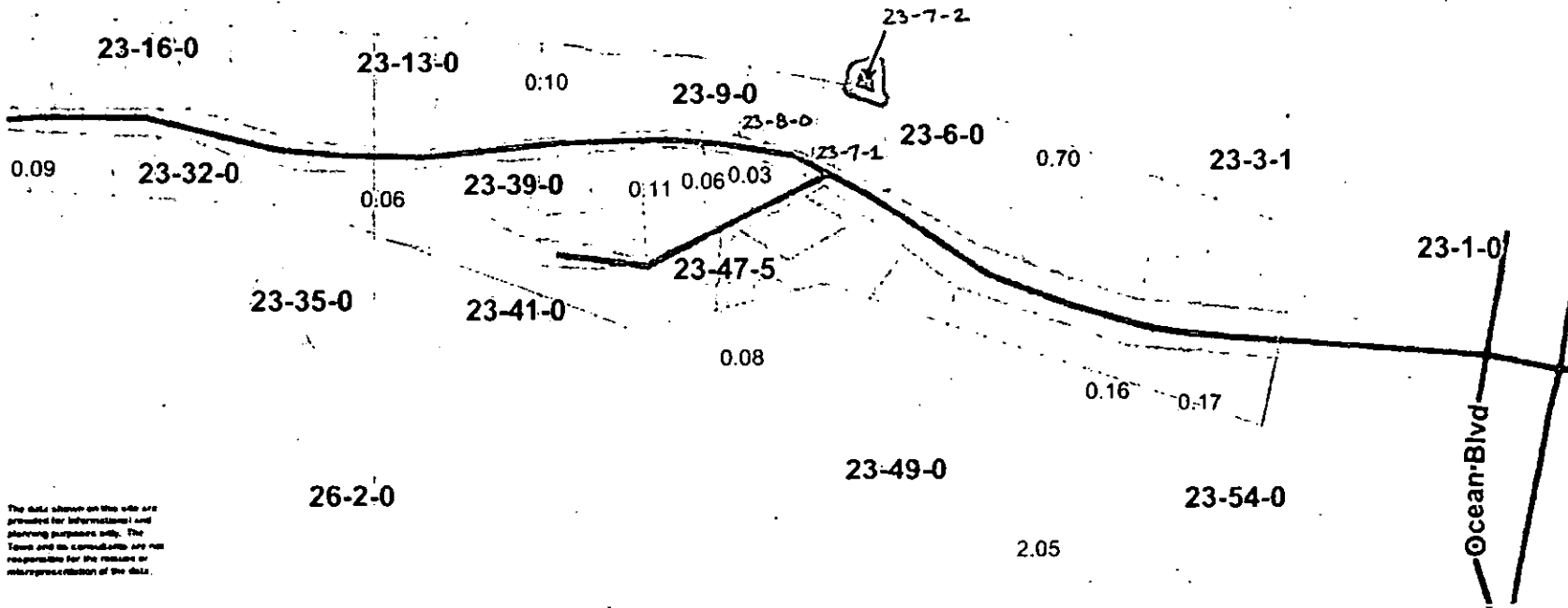

The data shown on this site are provided for informational and planning purposes only. The Town and its consultants are not responsible for the release or misrepresentation of the data.

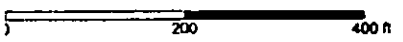

Printed on 01/17/2020 at 11:20 AM

# Seabrook NH Map

# Map by NH GRANIT

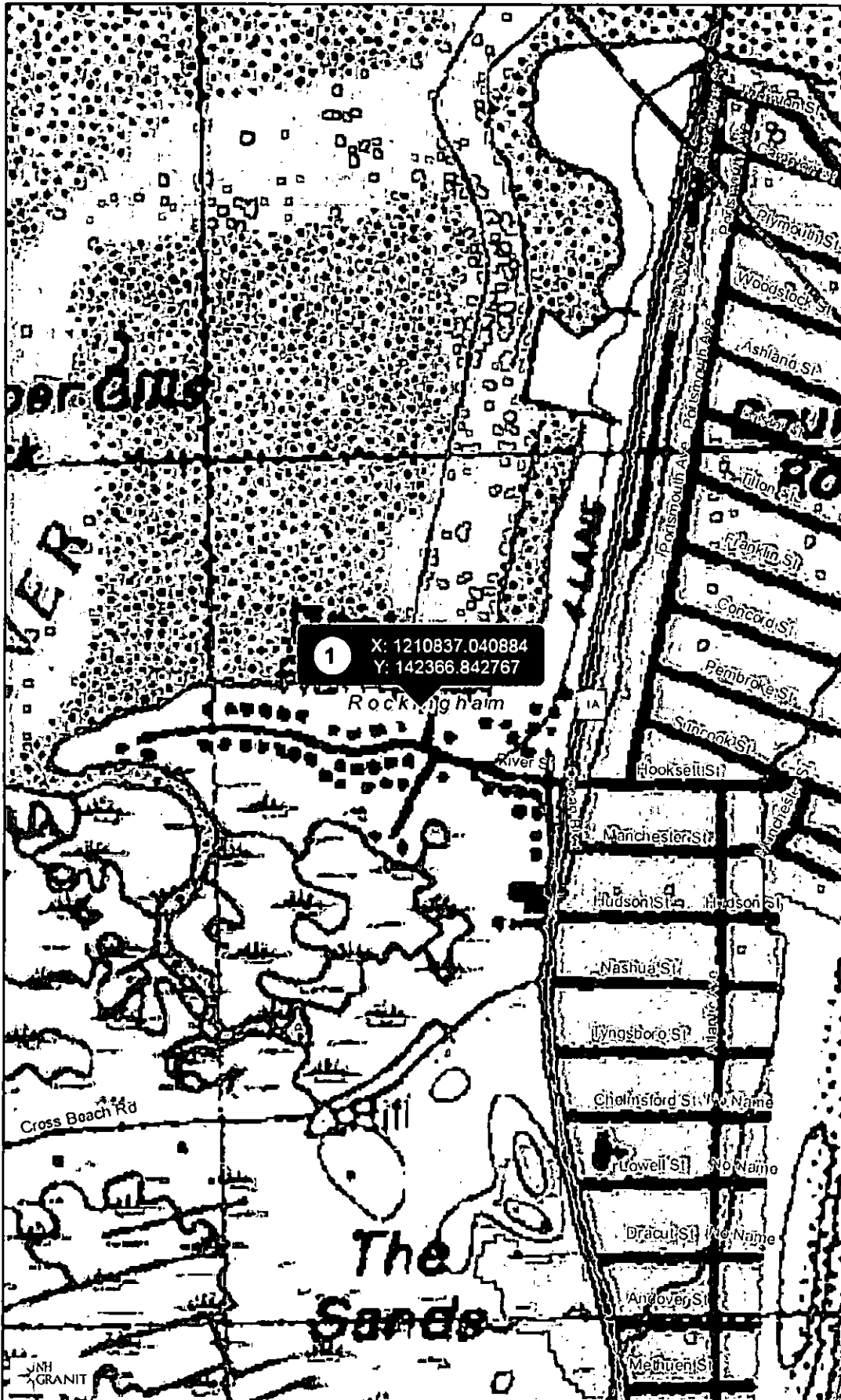

## Legend

- State
- County
- City/Town

1

X: 1210837.040884  
Y: 142366.842767

Map Scale

1: 6,494

© NH GRANIT, [www.granit.unh.edu](http://www.granit.unh.edu)

Map Generated: 1/17/2020



Notes

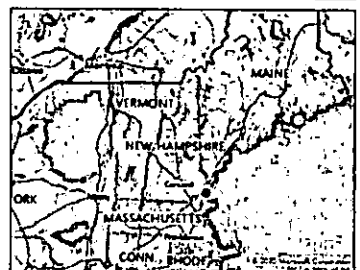



NEW HAMPSHIRE NATURAL HERITAGE BUREAU  
NHB DATACHECK RESULTS LETTER

---

**To:** John Chagnon, Ambit Engineering, Inc.  
200 Griffin Road  
Unit 3  
Portsmouth, NH 03801

**From:** NH Natural Heritage Bureau

**Date:** 1/23/2020 (valid for one year from this date)

**Re:** Review by NH Natural Heritage Bureau of request submitted 1/17/2020

**NHB File ID:** NHB20-0187

**Applicant:** Town of Seabrook

**Location:** Seabrook  
Tax Maps: Tax Map 23, Lot 7-2

**Project**

**Description:** The project proposes the replacement of piles associated with the existing docking structure and placement of new piles to secure the existing float.

The NH Natural Heritage database has been checked by staff of the NH Natural Heritage Bureau and/or the NH Nongame and Endangered Species Program for records of rare species and exemplary natural communities near the area mapped below. The species considered include those listed as Threatened or Endangered by either the state of New Hampshire or the federal government.

It was determined that, although there was a NHB record (e.g., rare wildlife, plant, and/or natural community) present in the vicinity, we do not expect that it will be impacted by the proposed project. This determination was made based on the project information submitted via the NHB Datacheck Tool on 1/17/2020, and cannot be used for any other project.



NEW HAMPSHIRE NATURAL HERITAGE BUREAU  
NHB DATACHECK RESULTS LETTER

MAP OF PROJECT BOUNDARIES FOR: NHB20-0187

NHB20-0187

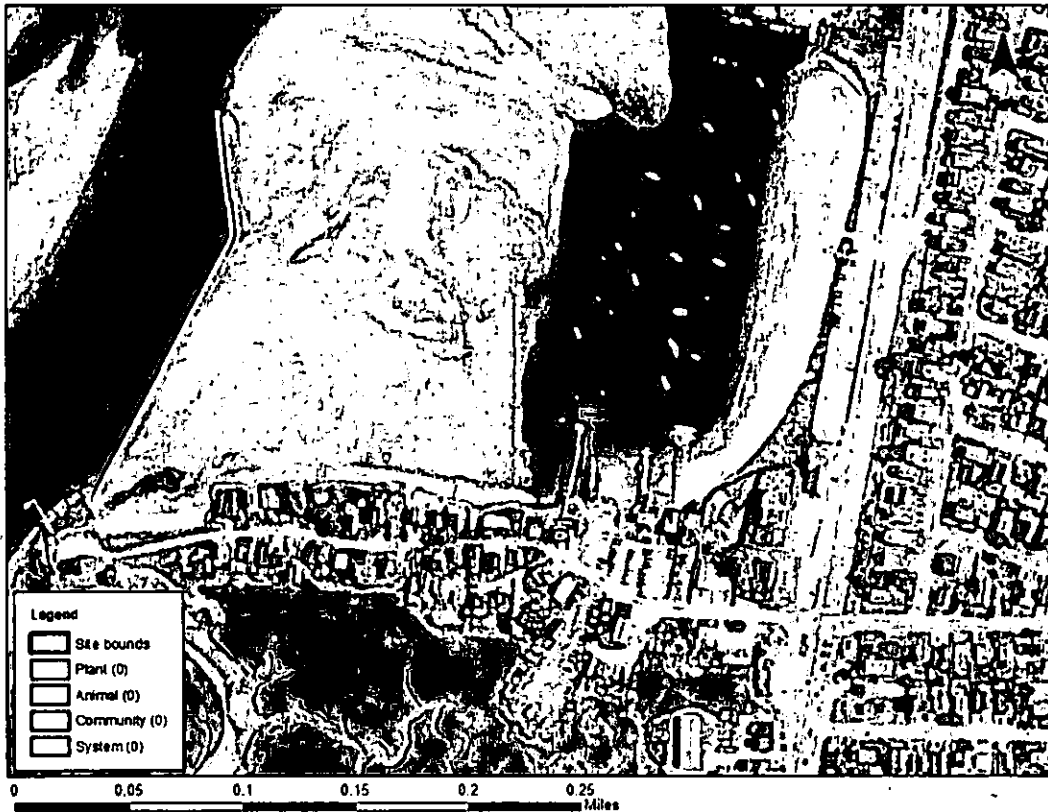



**ABUTTER'S LIST**

JN 3050.13

Client: Town of Seabrook

Project Address: 6 River Street, Seabrook, NH.

<b>MAP</b>	<b>LOT</b>	<b>NAME(S)</b>	<b>PO BOX</b>	<b>STREET ADDRESS</b>	<b>CITY/STATE/ZIP</b>
21	22-25	Town of Seabrook	456		Seabrook, NH 03874
23	7-1	7 River Street Realty Trust Thomas A. & Diane M. Wasson Trustees			
23	5	Eastmans Docks, LLC			



