



The State of New Hampshire
Department of Environmental Services

Robert R. Scott, Commissioner



45 lam

November 18, 2020

His Excellency, Governor Christopher T. Sununu
and The Honorable Council
State House
Concord, NH 03301

REQUESTED ACTION

Approve Nancy Elliott's and David Hagner's request to perform the following work on Great Bay in Greenland. File # 2020-02065. This project will not have significant impact on or adversely affect the values of Great Bay.

Impact 346 square feet of tidal wetland and 48 square feet of previously-developed 100-foot tidal buffer zone for the construction of tidal docking structure, resulting in a 4-foot by 4-foot access landing, 4-foot by 8-foot access stairway, 4-foot by 20-foot fixed pier connected to a 3-foot by 46-foot ramp connected to an 8-foot by 16-foot float. The overall structure length seaward of the highest observable tide line is 82-feet, providing one slip on 112-feet of frontage along Great Bay.

The New Hampshire Department of Environmental Services (NHDES) imposed the following conditions as part of this approval:

1. All work shall be done in accordance with the approved plans by Ambit Engineering, Inc. dated August 2020, revised through October 7, 2020, and received by the NH Department of Environmental Services (NHDES) on October 8, 2020, in accordance with Env-Wt 307.16
2. This permit shall not be effective until the permittee records this permit at the Rockingham County Registry of Deeds. Any limitations or conditions in the permit so recorded shall run with the land beyond the expiration of the permit. The permittee shall provide the NHDES with a copy of the permit stamped by the registry with the book and page and date of receipt, in accordance with New Hampshire Administrative Rule Env-Wt 314.02(b) and (c).
3. The ramp and float portions of residential tidal docks shall be seasonal and removed from the water during the non-boating season, in accordance with Env-Wt 606.06(b).
4. All work shall be done at low tide when the work area is fully exposed, in accordance with Env-Wt 609.10(b)(4).
5. Tidal docking installation shall be done by barge or upland to prevent the driving of construction equipment in or through tidal waters/wetlands or on the bottom of the inter-tidal zone, in accordance with Env-Wt 606.05(b).
6. Tidal docking construction shall be done in accordance with the standard conditions in Env-Wt 307, per Env-Wt 606.05(a).
7. Heavy equipment shall not be operated in any jurisdictional area unless specifically authorized by this permit, in accordance with Rule Env-Wt 307.15(a).

www.des.nh.gov

29 Hazen Drive • PO Box 95 • Concord, NH 03302-0095

NHDES Main Line: (603) 271-3503 • Subsurface Fax: (603) 271-6683 • Wetlands Fax: (603) 271-6588

TDD Access: Relay NH 1 (800) 735-2964

EXPLANATION

The NHDES approved this project on October 08, 2020. The NHDES supported its decision with the following findings:

1. This is classified as a major project per Rule Env-Wt 606.17(a)(1), for all new overwater structure construction in tidal waters/wetlands.
2. Per Rule Env-Wt 306.05, the applicant has addressed all of the required planning items that are used to determine the appropriate impact classification of a project and the type of approval required.
3. Per Rule Env-Wt 311.06(h), the Greenland Conservation Commission did not comment on the project.
4. Per Rule Env-Wt 311.01(b), the applicant coordinated with the NH Fish and Game Department and the Natural Heritage Bureau to determine how to avoid and minimize project-related impacts on rare or protected animal species and habitat, and on protected plants or exemplary natural communities.
5. Per Rule Env-Wt 313.01(a)(2), all applicable conditions specified in Env-Wt 307 have been met.
6. Per Rule Env-Wt 313.01(a)(3), all resource-specific criteria established in Env-Wt 600 have been met.
7. Per Rule Env-Wt 313.01(a)(4), all project-specific criteria established in Env-Wt 600 have been met.
8. Per Rule Env-Wt 313.01(a)(5), and as required by RSA 482-A:11, II, this permit for work to dredge or fill will not 'infringe on the property rights or unreasonably affect the value or enjoyment of property of abutting owners' based on documentation that the proposed dredge and fill activity will be located entirely within the boundary of the applicant's property interest and will not result in any observable change in off-site surface water levels or flows.
9. Per Rule Env-Wt 313.03(a) and (b), the applicant has demonstrated that potential impacts to jurisdictional areas have been avoided to the maximum extent practicable and that any unavoidable impacts have been minimized.
10. Per Rule Env-Wt 603.09, the applicant obtained a statement, dated September 25, 2020, from the Pease Development Authority, Division of Ports and Harbors regarding the projects impact on navigation and passage.
11. The residential tidal dock project meets the criteria listed in Rule Env-Wt 606.06(a) and (b).
12. Per Rule Env-Wt 202.01(b) and as required by RSA 482-A:8, the NHDES finds that the requirements for a public hearing do not apply as the project will not have a significant environmental impact, as defined in New Hampshire Administrative Rule Env-Wt 104.19, on the resources protected by RSA 482-A, or, is not of substantial public interest, as defined in New Hampshire Administrative Rule Env-Wt 104.32.

Application file documents are being forwarded to the Governor and the Executive Council in connection with their consideration of this matter pursuant to RSA 482-A:3, II.(a) as it is a major project in public waters of the state.

We respectfully request your approval of this item.



Robert R. Scott
Commissioner



STANDARD DREDGE AND FILL WETLANDS PERMIT APPLICATION

Water Division/Land Resources Management
Wetlands Bureau



Check the Status of your Application

RSA/Rule: RSA 482-A/Env-Wt 100-900

APPLICANT'S NAME: David L. Hagner & Nancy J. Elliott TOWN NAME: Greenland

<div style="border: 2px solid black; padding: 5px; text-align: center;"> <p>RECEIVED</p> <p>Administrative Use Only</p> <p>AUG 20 2020</p> <p>NHDES LAND RESOURCES MANAGEMENT</p> </div>	<p>COMPLETE</p> <p>Administrative Use Only</p> <p>AUG 21 2020</p>	<p>Administrative Use Only</p>	<table border="1" style="width: 100%; border-collapse: collapse;"> <tr> <td>File No. <u>2020-02065</u></td> </tr> <tr> <td>Check No. <u>3529</u></td> </tr> <tr> <td>Amount <u>\$1,444.00</u></td> </tr> <tr> <td>Initials: <u>LSJ</u></td> </tr> </table>	File No. <u>2020-02065</u>	Check No. <u>3529</u>	Amount <u>\$1,444.00</u>	Initials: <u>LSJ</u>
File No. <u>2020-02065</u>							
Check No. <u>3529</u>							
Amount <u>\$1,444.00</u>							
Initials: <u>LSJ</u>							

A person may request a waiver to the requirements in Rules Env-Wt 100-900 to accommodate situations where strict adherence to the requirements would not be in the best interest of the public or the environment. A person may also request a waiver of the standards for existing dwellings over water pursuant to RSA 482-A:26, III (b). For more information, please consult the [request form](#).

<p>SECTION 1 - REQUIRED PLANNING FOR ALL PROJECTS (Env-Wt 306.05; RSA 482-A:3, I(d)(2))</p> <p>Please use the Wetland Permit Planning Tool (WPPT), the Natural Heritage Bureau (NHB) DataCheck Tool, the Aquatic Restoration Mapper, or other sources to assist in identifying key features such as: priority resource areas (PRAs), protected species or habitats, coastal areas, designated rivers, or designated prime wetlands.</p>	
<p>Has the required planning been completed?</p>	<input checked="" type="checkbox"/> Yes <input type="checkbox"/> No
<p>Does the property contain a PRA? If yes, provide the following information:</p> <ul style="list-style-type: none"> • Does the project qualify for an Impact Classification Adjustment (e.g. NH Fish and Game Department (NHF&G) and NHB agreement for a classification downgrade) or a Project-Type Exception (e.g. Maintenance or Statutory Permit-by-Notification (SPN) project)? See Env-Wt 407.02 and Env-Wt 407.04). <input type="checkbox"/> Yes <input checked="" type="checkbox"/> No • Protected species or habitat? <input checked="" type="checkbox"/> Yes <input type="checkbox"/> No <ul style="list-style-type: none"> ○ If yes, species or habitat name(s): <u>Marsh elder (Iva frutescens)</u> ○ NHB Project ID #: <u>20-1938</u> • Bog? <input type="checkbox"/> Yes <input checked="" type="checkbox"/> No • Floodplain wetland contiguous to a tier 3 or higher watercourse? <input checked="" type="checkbox"/> Yes <input type="checkbox"/> No • Designated prime wetland or duly-established 100-foot buffer? <input type="checkbox"/> Yes <input checked="" type="checkbox"/> No • Sand dune, tidal wetland, tidal water, or undeveloped tidal buffer zone? <input checked="" type="checkbox"/> Yes <input type="checkbox"/> No 	
<p>Is the property within a Designated River corridor? If yes, provide the following information:</p> <ul style="list-style-type: none"> • Name of Local River Management Advisory Committee (LAC): <u>N/A</u> • A copy of the application was sent to the LAC on Month: <input type="checkbox"/> Day: <input type="checkbox"/> Year: <input type="checkbox"/> 	<input type="checkbox"/> Yes <input checked="" type="checkbox"/> No

irm@des.nh.gov or (603) 271-2147.

NHDES Wetlands Bureau, 29 Hazen Drive, PO Box 95, Concord, NH 03302-0095

www.des.nh.gov

For dredging projects, is the subject property contaminated? • If yes, list contaminant: <u>N/A</u>	<input type="checkbox"/> Yes <input checked="" type="checkbox"/> No
Is there potential to impact impaired waters, class A waters, or outstanding resource waters?	<input checked="" type="checkbox"/> Yes <input checked="" type="checkbox"/> No
For stream crossing projects, provide watershed size (se Wetland Permit Planning Tool or Stream Stats): <u>N/A</u>	
SECTION 2 - PROJECT DESCRIPTION (Env-Wt 311.04(i)) Provide a brief description of the project and the purpose of the project, outlining the scope of work to be performed and whether impacts are temporary or permanent. DO NOT reply "See attached"; please use the space provided below.	
<p><u>The project proposes</u> 346 sq. ft. of permanent impact to tidal wetland and 48 sq. ft. of permanent impact to the previously developed 100' Tidal Buffer Zone for the construction of a tidal docking structure including a 4' x 4' access landing, a 4' x 8' access stairway, a 4' x 20' fixed pier, a 3' x 46' gangway and a 8' x 16' float (overall structure length 74') providing one slip on 112+/- feet of frontage along Great Bay.</p>	
SECTION 3 - PROJECT LOCATION Separate wetland permit applications must be submitted for each municipality within which wetland impacts occur.	
ADDRESS: <u>97 Waters Edge</u>	
TOWN/CITY: <u>Greenland</u>	
TAX MAP/BLOCK/LOT/UNIT: <u>Msp R:13 Lot 15</u>	
US GEOLOGICAL SURVEY (USGS) TOPO MAP WATERBODY NAME: <u>Great Bay</u> <input checked="" type="checkbox"/> N/A	
(Optional) LATITUDE/LONGITUDE in decimal degrees (to five decimal places): <u>1:193:423:7305</u> ° North <u>204:888.0348</u> ° West	

SECTION 4 - APPLICANT (DESIRED PERMIT HOLDER) INFORMATION (Env-Wt 311.04(a)) If the applicant is a trust or a company, then complete with the trust or company information.		
NAME: <u>David L. Hagner & Nancy J. Elliott</u>		
MAILING ADDRESS: _____		
TOWN/CITY: _____	STATE: _____	ZIP CODE: _____
EMAIL ADDRESS: _____		
FAX: _____	PHONE: _____	
ELECTRONIC COMMUNICATION: By initialing here: _____, I hereby authorize NHDES to communicate all matters relative to this application electronically.		
SECTION 5 - AUTHORIZED AGENT INFORMATION (Env-Wt 311.04(c))		
<input type="checkbox"/> N/A		
LAST NAME, FIRST NAME, M.I.: <u>Riker, Steven, D.</u>		
COMPANY NAME: <u>Ambit Engineering, Inc.</u>		
MAILING ADDRESS: <u>200 Griffin Road, Unit 3</u>		
TOWN/CITY: <u>Portsmouth</u>	STATE: <u>NH</u>	ZIP CODE: <u>03801</u>
EMAIL ADDRESS: <u>sdr@ambitengineering.com</u>		
FAX: _____	PHONE: <u>603-430-9282</u>	
ELECTRONIC COMMUNICATION: By initialing here: <u>SR</u> , I hereby authorize NHDES to communicate all matters relative to this application electronically.		
SECTION 6 - PROPERTY OWNER INFORMATION (IF DIFFERENT THAN APPLICANT) (Env-Wt 311.04(b)) If the owner is a trust or a company, then complete with the trust or company information.		
<input checked="" type="checkbox"/> Same as applicant		
NAME: _____		
MAILING ADDRESS: _____		
TOWN/CITY: _____	STATE: _____	ZIP CODE: _____
EMAIL ADDRESS: _____		
FAX: _____	PHONE: _____	
ELECTRONIC COMMUNICATION: By initialing here: _____, I hereby authorize NHDES to communicate all matters relative to this application electronically.		

SECTION 7 - RESOURCE SPECIFIC CRITERIA ESTABLISHED IN Env-Wt 400, Env-Wt 500, Env-Wt 600, Env-Wt 700, OR Env-Wt 900 HAVE BEEN MET (Env-Wt 313.01(a)(3))

Describe how the resource-specific criteria have been met for each chapter listed above (please attach information about stream crossings, coastal resources, prime wetlands, or non-tidal wetlands and surface waters):

Please see attached narrative

SECTION 8 - AVOIDANCE AND MINIMIZATION

Impacts within wetland jurisdiction must be avoided to the maximum extent practicable (Env-Wt 313.03(a))* . Any project with unavoidable jurisdictional impacts must then be minimized as described in the Wetlands Best Management Practice Techniques For Avoidance and Minimization and the Wetlands Permitting: Avoidance, Minimization and Mitigation Fact Sheet. For minor or major projects, a functional assessment of all wetlands on the project site is required (Env-Wt 311.03(b)(10))* .

Please refer to the application checklist to ensure that you have attached all documents related to avoidance and minimization, as well as functional assessment (where applicable). You can use the Avoidance and Minimization Checklist, the Avoidance and Minimization Narrative, or your own avoidance and minimization narrative.

**See Env-Wt 311.03(b)(6) and Env-Wt 311.03(b)(10) for shoreline structure exemptions.*

SECTION 9 - MITIGATION REQUIREMENT (Env-Wt 311.02)

If unavoidable jurisdictional impacts require mitigation, a mitigation pre-application meeting must occur at least 30 days but not more than 90 days prior to submitting this Standard Dredge and Fill Permit Application.

Mitigation Pre-Application Meeting Date: Month: Day: Year:

N/A - Mitigation is not required

SECTION 10 - THE PROJECT MEETS COMPENSATORY MITIGATION REQUIREMENTS (Env-Wt 313.01(a)(1)(c))

Confirm that you have submitted a compensatory mitigation proposal that meets the requirements of Env-Wt 800 for all permanent unavoidable impacts that will remain after avoidance and minimization techniques have been exercised to the maximum extent practicable: I confirm submittal.

N/A - Compensatory mitigation is not required

SECTION 11 - IMPACT AREA (Env-Wt 311.04(g))

For each jurisdictional area that will be/has been impacted, provide square feet (SF) and, if applicable, linear feet (LF) of impact, and note whether the impact is after-the-fact (ATF; i.e. work was started or completed without a permit).

For intermittent and ephemeral streams, the linear footage of impact is measured along the thread of the channel. *Please note, installation of a stream crossing in an ephemeral stream may be undertaken without a permit per Rule Env-Wt 309.02(d), however other dredge or fill impacts should be included below.*

For perennial streams/ivers, the linear footage of impact is calculated by summing the lengths of disturbances to the channel and banks.

Permanent impacts are impacts that will remain after the project is complete (e.g., changes in grade or surface materials).

Temporary impacts are impacts not intended to remain (and will be restored to pre-construction conditions) after the project is completed.

JURISDICTIONAL AREA		PERMANENT			TEMPORARY		
		SF	LF	ATF	SF	LF	ATF
Wetlands	Forested Wetland			4			5
	Scrub-shrub Wetland			4			2
	Emergent Wetland			1			1
	Wet Meadow			2			2
	Vernal Pool			2			1
	Designated Prime Wetland			4			6
	Duly-established 100-foot Prime Wetland Buffer			1			1
Surface Water	Intermittent / Ephemeral Stream		1	4		1	2
	Perennial Stream or River		1	1		1	1
	Lake / Pond		1	1		1	1
	Docking - Lake / Pond		1	1		1	1
	Docking - River		1	1		1	1
Banks	Bank - Intermittent Stream		1	2		1	2
	Bank - Perennial Stream / River		1	2		1	2
	Bank / Shoreline - Lake / Pond		1	2		1	2
Tidal	Tidal Waters		1	2		1	2
	Tidal Marsh		1	2		1	2
	Sand Dune			1			1
	Undeveloped Tidal Buffer Zone (TBZ)			1			1
	Previously-developed TBZ	48		1			1
	Docking - Tidal Water	346		1			2
TOTAL		394					

SECTION 12 - APPLICATION FEE (RSA 482-A:3, I)

MINIMUM IMPACT FEE: Flat fee of \$400.

NON-ENFORCEMENT RELATED, PUBLICLY-FUNDED AND SUPERVISED RESTORATION PROJECTS, REGARDLESS OF IMPACT CLASSIFICATION: Flat fee of \$400 (refer to RSA 482-A:3, 1(c) for restrictions).

MINOR OR MAJOR IMPACT FEE: Calculate using the table below:

Permanent and temporary (non-docking):	346 SF	× \$0.40 =	\$ 138.40
Seasonal docking structure:	266 SF	× \$2.00 =	\$ 532
Permanent docking structure:	128 SF	× \$4.00 =	\$ 512
Projects proposing shoreline structures (including docks) add \$400 =			\$ 400
Total =			\$ 1,444

The application fee for minor or major impact is the above calculated total or \$400, whichever is greater = \$ 1,444

irm@des.nh.gov or (603) 271-2147

NHDES Wetlands Bureau, 29 Hazen Drive, PO Box 95, Concord, NH 03302-0095

www.des.nh.gov

SECTION 13 - PROJECT CLASSIFICATION (Env-Wt 306.05)
 Indicate the project classification.

Minimum Impact Project
 Minor Project
 Major Project

SECTION 14 - REQUIRED CERTIFICATIONS (Env-Wt 311.11)

Initial each box below to certify:

Initials:

 To the best of the signer's knowledge and belief, all required notifications have been provided.



Initials:

 The information submitted on or with the application is true, complete, and not misleading to the best of the signer's knowledge and belief.

Initials:

 The signer understands that:

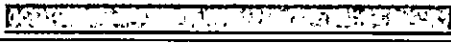
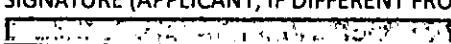
- The submission of false, incomplete, or misleading information constitutes grounds for NHDES to:
 - Deny the application.
 - Revoke any approval that is granted based on the information.
 - If the signer is a certified wetland scientist, licensed surveyor, or professional engineer licensed to practice in New Hampshire, refer the matter to the joint board of licensure and certification established by RSA 310-A:1.
- The signer is subject to the penalties specified in New Hampshire law for falsification in official matters, currently RSA 641.
- The signature shall constitute authorization for the municipal conservation commission and the Department to inspect the site of the proposed project, except for minimum impact forestry SPN projects and minimum impact trail projects, where the signature shall authorize only the Department to inspect the site pursuant to RSA 482-A:6, II.

Initials:

 If the applicant is not the owner of the property, each property owner signature shall constitute certification by the signer that he or she is aware of the application being filed and does not object to the filing.

SECTION 15 - REQUIRED SIGNATURES (Env-Wt 311.04(d); Env-Wt 311.11)

SIGNATURE (OWNER): 	PRINT NAME LEGIBLY: <input type="checkbox"/>	DATE: <input type="checkbox"/>
SIGNATURE (APPLICANT, IF DIFFERENT FROM OWNER): 	PRINT NAME LEGIBLY: <input type="checkbox"/>	DATE: <input type="checkbox"/>
SIGNATURE (AGENT) IF APPLICABLE: 	PRINT NAME LEGIBLY: Steven D. Riker	DATE: 8/17/20

SECTION 16 - TOWN/CITY CLERK SIGNATURE (Env-Wt 311.04(f))

As required by RSA 482-A:3, I(a), (1), I hereby certify that the applicant has filed four application forms, four detailed plans, and four USGS location maps with the town/city indicated below.

TOWN/CITY CLERK SIGNATURE: 	PRINT NAME LEGIBLY: Marguerite F. Morgan
TOWN/CITY: <input type="checkbox"/> <u>Breelund</u>	DATE: <input type="checkbox"/> <u>8-17-2020</u>

DIRECTIONS FOR TOWN/CITY CLERK:

Per RSA 482-A:3, I(a)(1)

1. IMMEDIATELY sign the original application form and four copies in the signature space provided above.
2. Return the signed original application form and attachments to the applicant so that the applicant may submit the application form and attachments to NHDES by mail or hand delivery.
3. IMMEDIATELY distribute a copy of the application with one complete set of attachments to each of the following bodies: the municipal Conservation Commission, the local governing body (Board of Selectmen or Town/City Council), and the Planning Board.
4. Retain one copy of the application form and one complete set of attachments and make them reasonably accessible for public review.

DIRECTIONS FOR APPLICANT:

Submit the original permit application form bearing the signature of the Town/City Clerk, additional materials, and the application fee to NHDES by mail or hand delivery at the address at the bottom of this page. Make check or money order payable to "Treasurer – State of NH".

14 August, 2020

To Whom It May Concern:

**RE: State of New Hampshire Department of Environmental Services
Application for proposed docking structure within the previously developed 100'
Tidal Buffer Zone and jurisdictional wetlands for David L. Hagner of 97 Waters
Edge Greenland, NH 03840.**

This letter is to inform the State of New Hampshire DES and the Town of Greenland
in accordance with State Law that the following entities:

Riverside Marine Construction, Inc.
Ambit Engineering, Inc

Is authorized to represent us as our agents in the approval process.

Please feel free to call me if there is any question regarding this authorization.

Sincerely,

A handwritten signature in black ink, appearing to read 'David L. Hagner', with a large, stylized flourish at the end.

David L. Hagner

Map by NH GRANIT

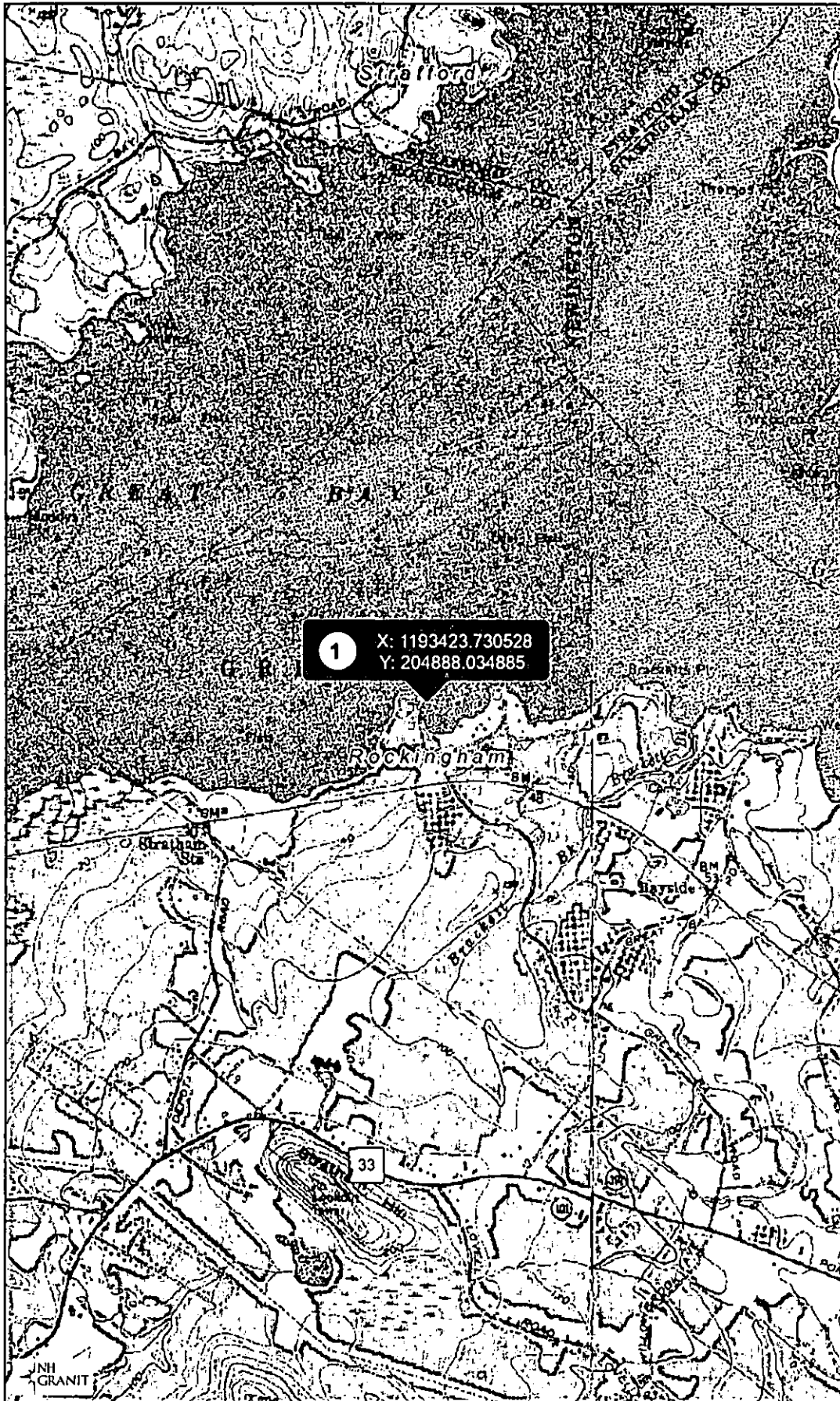

Legend

Map Scale

1: 25,977

© NH GRANIT, www.granit.unh.edu

Map Generated: 7/7/2020



Notes

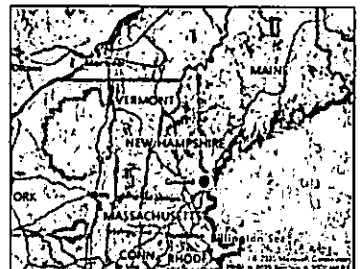

CONFIDENTIAL – NH Dept. of Environmental Services review

Memo



NH NATURAL HERITAGE BUREAU
NHB DATACHECK RESULTS LETTER

To: John Chagnon, Ambit Engineering, Inc.
200 Griffin Road
Unit 3
Portsmouth, NH 03801

From: Amy Lamb, NH Natural Heritage Bureau
Date: 7/9/2020 (valid for one year from this date)

Re: Review by NH Natural Heritage Bureau

NHB File ID: NHB20-1938

Town: Greenland

Location: Tax Maps: Tax Map R13, Lot 15

Description: The project proposes a tidal docking structure for recreational boating access to Great Bay.

As requested, I have searched our database for records of rare species and exemplary natural communities, with the following results.

Comments: Please address the potential for marsh elder to occur within the project area. Site plans and photos can be sent to Amy.Lamb@dncr.nh.gov.

Plant species

marsh elder (*Iva frutescens*)*

State Federal Notes

T

Threats are primarily alterations to the hydrology of the wetland, such as ditching or tidal restrictions that might affect the sheet flow of tidal waters across the intertidal flat, activities that eliminate plants, and increased input of nutrients and pollutants in storm runoff.

Codes: "E" = Endangered, "T" = Threatened, "SC" = Special Concern, "..." = an exemplary natural community, or a rare species tracked by NH Natural Heritage that has not yet been added to the official state list. An asterisk (*) indicates that the most recent report for that occurrence was more than 20 years ago.

A negative result (no record in our database) does not mean that a sensitive species is not present. Our data can only tell you of known occurrences, based on information gathered by qualified biologists and reported to our office. However, many areas have never been surveyed, or have only been surveyed for certain species. An on-site survey would provide better information on what species and communities are indeed present.

CONFIDENTIAL – NH Dept. of Environmental Services review

NHB20-1938

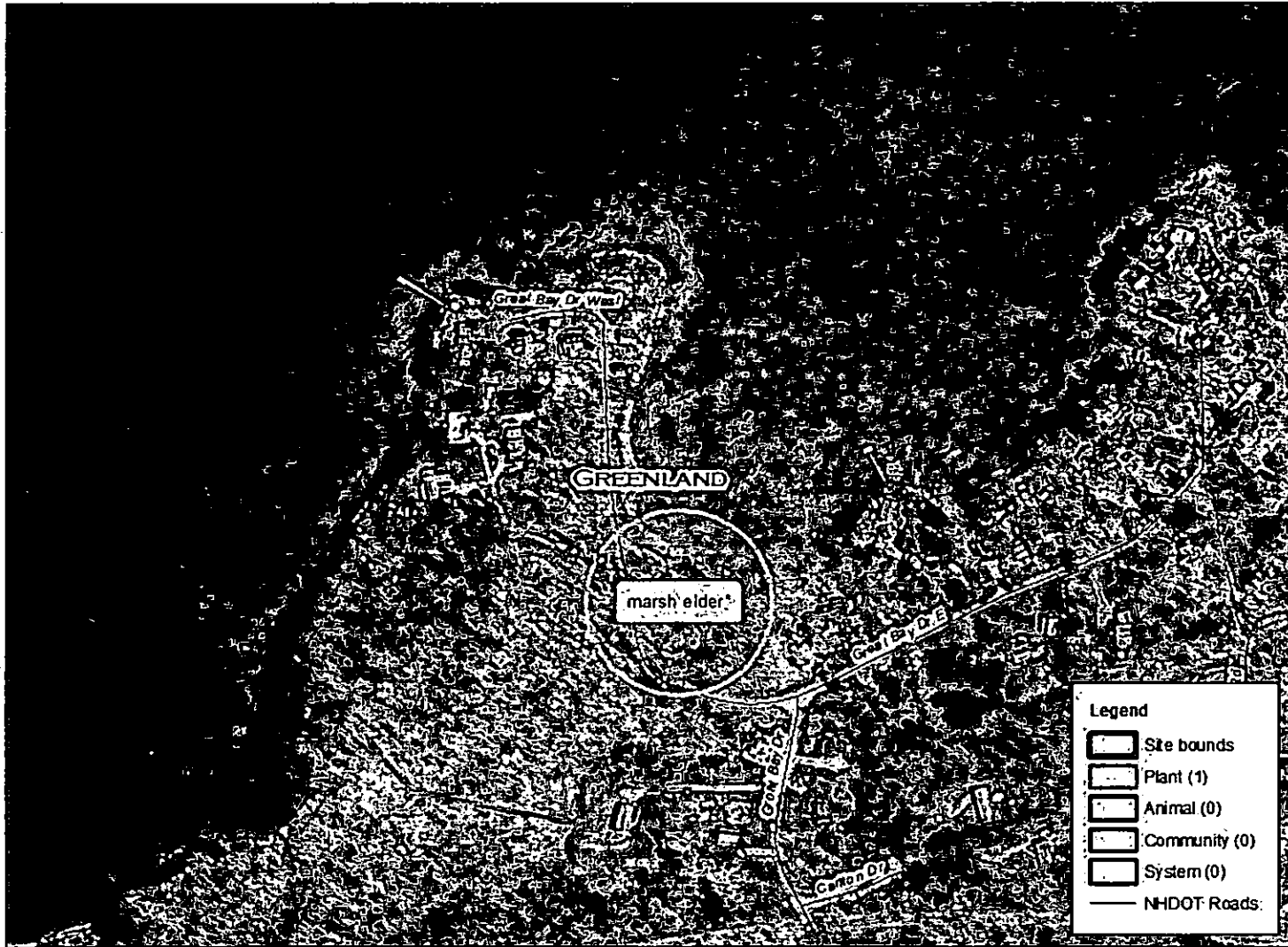

ABUTTER'S LIST

JN 3050.23

Client: David L. Hagner

Project Address: 97 Waters Edge, Greenland, NH

MAP	LOT	NAME(S)	PO BOX	STREET ADDRESS	CITY/STATE/ZIP
R13	12	Thomas J. Brackett III		-----	
R13	13	Stuart R. Bauder		- - -	
R13	14	David E. Strong		-	6
R13	16	Leonard Schwab, Trustee			
R13	18	David Wolowitz Revocable Trust of 2007			

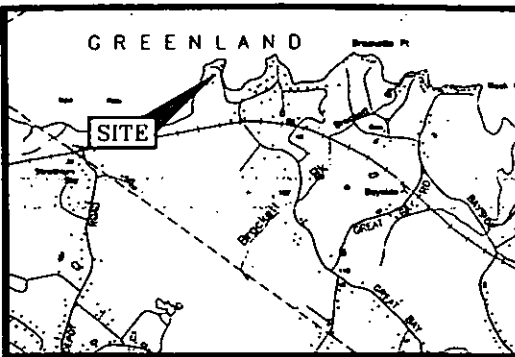

LOCATION MAP SCALE 1"=2,000'

LEGEND:

N/T	NOW OR FORMERLY
RP	RECORD OF PROBATE
RCRD	ROCKINGHAM COUNTY REGISTRY OF DEEDS
11/21	MAP 11 / LOT 21
○	RAILROAD SPIKE FOUND
○	IRON ROD/IRON PIPE FOUND
○	IRON PIPE FOUND
○	STONE/CONCRETE BOLLIO FOUND
○	RAILROAD SPIKE SET
○	IRON ROD SET
○	DRILL HOLE SET
○	GRANITE BOUND SET
---	BOUNDARY
---	BUILDING SETBACK
---	MEAN HIGH WATER LINE
---	MEAN LOW WATER LINE
---	NH DES HIGHEST OBSERVABLE TIDE LINE
---	FRESHWATER WETLAND LINE
---	WETLAND BUFFER LINE
---	OVERHEAD ELECTRIC/WIRES
---	CONTROL
---	SPOT ELEVATION
---	EDGE OF PAVEMENT (EP)
---	WOODS / TREE LINE
---	UTILITY POLE (+/- GUY)
---	GAS SHUT OFF
---	WATER SHUT OFF/CURB STOP
---	GATE VALVE
---	HYDRANT
---	METER (GAS, WATER, ELECTRIC)
---	EDGE OF WETLAND FLAGGING
---	SWAMP / MARSH
---	ELEVATION
---	EDGE OF PAVEMENT
---	FINISHED FLOOR
---	WARRANT
---	TEMPORARY BENCHMARK
---	TYPICAL
---	LANDSCAPED AREA

PLAN REFERENCES:

- 1) PLAN OF A PART OF THE FARM OF THOS. J. BRACKETT LOCATED IN GREENLAND, N.H. AND CALLED GREAT BAY DEVELOPMENT. PREPARED BY THOMAS J. BRACKETT, DATED AUGUST 1928. R.C.R.D. PLAN #0407.
- 2) PLAN OF LOTS GREENLAND, N.H., BRACKETT TO HINES, BRACKETT TO DEFILIPO, PREPARED BY JOHN W. DURGIN CIVIL ENGINEERS PROFESSIONAL ASSOCIATION, DATED AUGUST 1976. R.C.R.D. PLAN D-6330.
- 3) PLAN OF LAND ON GREAT BAY DRIVE WEST, GREENLAND, N.H. PREPARED FOR FREDERICK E. & DENISE L. SCHNODDER, PREPARED BY T.D. BROUILLETTE LAND SURVEYING, DATED MARCH 23, 2004. FINAL REVISION DATE JULY 12, 2004. R.C.R.D. PLAN D-31785.
- 4) PROPERTY STAKEOUT SKETCH, OWNER: GEORGE & JENNIE GRISWOLD, PROPERTY LOCATION: 59 GREAT BAY DRIVE WEST, GREENLAND, N.H. 03840, COUNTY OF ROCKINGHAM, PREPARED BY AMBIT ENGINEERING, INC. DATED AUGUST 2000. NOT RECORDED.

WETLAND NOTES:

- 1) HIGHEST OBSERVABLE TIDE LINE DELINEATED BY STEVEN D. RIKER, CWS ON 7/6/2020 IN ACCORDANCE WITH THE FOLLOWING STANDARDS:
 - A) U.S. ARMY CORPS OF ENGINEERS WETLANDS DELINEATION MANUAL TECHNICAL REPORT Y-87-1 (JAN. 1987), AND REGIONAL SUPPLEMENT TO THE CORPS OF ENGINEERS WETLAND DELINEATION MANUAL: NORTH-CENTRAL AND NORTHEAST REGION, VERSION 2.0, JANUARY 2012.
 - B) FIELD INDICATORS OF HYDRIC SOILS IN THE UNITED STATES, VERSION 8.2, USDA-NRCS, 2018 AND (FOR DISTURBED SITES) FIELD INDICATORS FOR IDENTIFYING HYDRIC SOILS IN NEW ENGLAND, VERSION 4, NEWFOC WETLANDS WORK GROUP (2019).
 - C) NATIONAL LIST OF PLANT SPECIES THAT OCCUR IN WETLANDS: NORTHEAST (REGION 1), USFWS (MAY 1988).
 - D) CLASSIFICATION OF WETLANDS AND DEEPWATER HABITATS OF THE UNITED STATES. USFW MANUAL FWS/OBS-79/31 (1997).
 - E) "IDENTIFICATION AND DOCUMENTATION OF VERNAL POOLS IN NEW HAMPSHIRE" (1997). NEW HAMPSHIRE FISH AND GAME DEPARTMENT.
- 2) WETLAND FLAGS WERE FIELD LOCATED BY AMBIT ENGINEERING, INC.

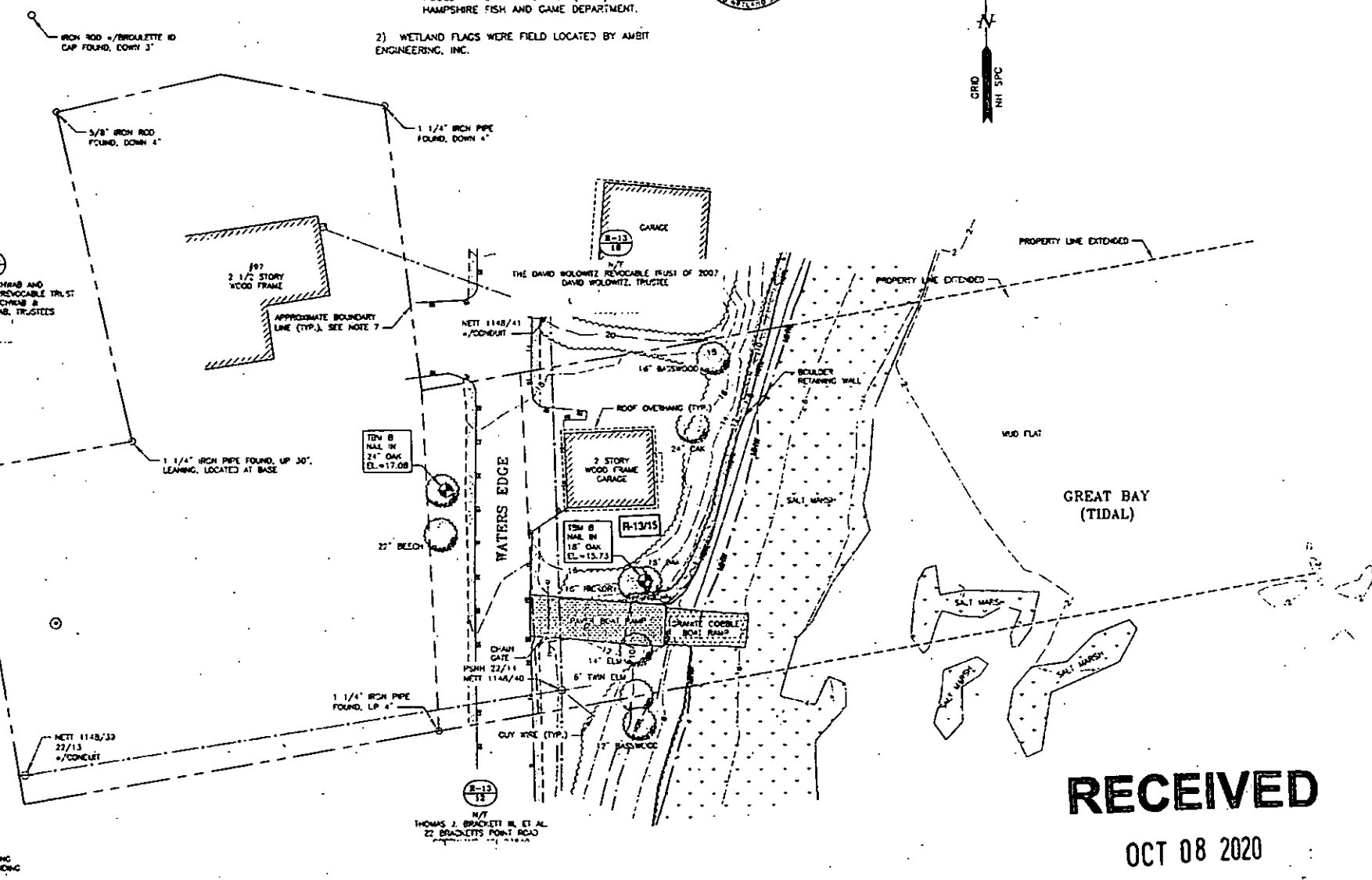

"I CERTIFY THAT THIS PLAN WAS PREPARED UNDER MY DIRECT SUPERVISION, THAT IT IS THE RESULT OF A FIELD SURVEY BY THIS OFFICE AND HAS AN ACCURACY OF THE CLOSED TRAVERSE THAT EXCEEDS THE PRECISION OF 1:15,000."

PAUL A. DOEBBERSTEIN, LLS DATE 7/7/2020

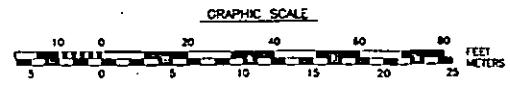

RECEIVED
OCT 08 2020
ENVIRONMENTAL SERVICES
"BY NH DES WETLANDS BUREAU"

AMBIT ENGINEERING, INC.
Civil Engineers & Land Surveyors
200 Griffin Road - Unit 3
Farmington, N.H. 03821-7111
Tel: (603) 436-9282
Fax: (603) 436-9215



NOTES:

- 1) PARCEL IS SHOWN ON THE TOWN OF GREENLAND ASSESSOR'S MAP R-13 AS LOT 15.
- 2) OWNERS OF RECORD: DAVID L. HAGER & NANCY J. ELLIOTT 97 WATERS EDGE GREENLAND, NH 03840 3241/2808 D-6330 & PLAN #0407 (LOTS 23 & 27)
- 3) PORTIONS OF THE PARCEL ARE IN A SPECIAL FLOOD HAZARD AREA AE (CL. 7) AS SHOWN ON FIRM PANEL 3301500245E, EFFECTIVE DATE MAY 17, 2005.
- 4) EXISTING LOT AREA: 30,100 ± S.F. (PER P.C.R.D. D-6330)
- 5) PARCEL IS LOCATED IN THE RESIDENTIAL (R) ZONING DISTRICT.
- 6) DIMENSIONAL REQUIREMENTS:

MIN. LOT AREA:	60,000 S.F.
FRONTAGE:	200 FEET
SETBACKS:	FRONT: 30 FEET
	SIDE: 20 FEET
	REAR: 20 FEET
MAXIMUM STRUCTURE HEIGHT:	35 FEET
MAXIMUM STRUCTURE COVERAGE:	20%
MINIMUM OPEN SPACE:	80%
- 7) THE PURPOSE OF THIS PLAN IS TO SHOW THE EXISTING CONDITIONS ON A PORTION OF ASSESSOR'S MAP R-13 LOT 15 IN THE TOWN OF GREENLAND. BOUNDARY LINES SHOWN HEREON ARE BASED ON R.C.R.D. PLAN D-6330. THIS IS NOT A BOUNDARY SURVEY.
- 8) VERTICAL DATUM IS MEAN LOWER LOW WATER (MLLW). BASIS OF VERTICAL DATUM IS REDUNDANT WITH GASS OBSERVATIONS (L9.2). REDUCTION FROM NAVD83 TO MLLW BASED ON NOAA STATION 8420411 COVER, COCHeco RIVER, YALLA BEING 3.93 FEET LOWER THAN 0.20 NAVD83. MEAN LOWER WATER (MLW) SHOWN HEREON AT ELEVATION 0.26. MEAN HIGH WATER (MHW) SHOWN HEREON AT ELEVATION 7.30.
- 9) PARCEL IS SUBJECT TO RIGHTS OF THOMAS J. BRACKETT & ALSON BRACKETT TO USE THE EXISTING BOAT RAMP ON THE PROPERTY. SEE R.C.R.D. 4627/2008.
- 10) PARCEL IS SUBJECT TO AND BENEFITS FROM RIGHTS IN COMMON WITH OTHERS FOR INGRESS AND EGRESS OVER THE ROADWAY SHOWN ON R.C.R.D. PLAN #007 & LAND NOW OR FORMERLY OF JOHN R. BRACKETT FROM THE PARCEL TO DEARBORN ROAD.

**TIDAL DOCKING STRUCTURE
HAGNER & ELLIOTT
RESIDENCE
97 WATERS EDGE
GREENLAND, N.H.**

1	ROAD DESIGNATION	10/7/20
0	ISSUED FOR COMMENT	7/28/20
NO.	DESCRIPTION	DATE
REVISIONS		

SCALE 1"=20' JULY 2020

EXISTING CONDITIONS PLAN **C1**

SEQUENCE OF CONSTRUCTION

- 1) MOBILIZATION OF A CRANE BARGE, PUSH BOAT, WORK SHUFF, MATERIALS AND PREFABRICATED COMPONENTS SUCH AS THE GANGWAY AND FLOAT TO THE SITE VIA APPROVED ACCESS.
- 2) MOBILIZATION OF EQUIPMENT TRUCKS TO THE SITE.
- 3) THE BARGE WILL BE POSITIONED ALONGSIDE THE PROPOSED LOCATION OF THE NEW DOCK AND WATERWARD OF ANY EMERGENT VEGETATION TO MINIMIZE IMPACTS.
- 4) INSTALLATION OF THE SUB STRUCTURE WILL BE PERFORMED FROM A CRANE BARGE OR SHUFF TO REDUCE THE AMOUNT OF FOOT TRAFFIC IN THE INTERTIDAL AREA.
- 5) ALL WORK WILL BE PERFORMED AT LOW TIDE TO MINIMIZE SEDIMENTATION.
- 6) PILING WILL BE MECHANICALLY DRIVEN BY A CRANE ELIMINATING ANY EXCAVATION FOR INSTALLATION OF THE PILING. PILING ARE DRIVEN TO REFUSAL.
- 7) PILING ARE CUT AND BEAM CAPS ARE INSTALLED AND THE SUPER STRUCTURE OF THE PIER IS BUILT. MATERIALS ARE LIFTED FROM THE BARGE AND SET INTO POSITION BY THE CRANE.
- 8) ONCE THE PIER IS COMPLETE, THE GANGWAY AND FLOAT ARE BROUGHT INTO POSITION AND INSTALLED.

DISCHARGES AVOIDANCE, MINIMIZATION AND MITIGATION

DISCHARGES OF DREDGED OR FILL MATERIAL INTO WATERS OF THE U.S. AND ANY SECONDARY IMPACTS SHALL BE AVOIDED AND MINIMIZED TO THE MAXIMUM EXTENT PRACTICABLE. PERMITTEES MAY ONLY FILL THOSE JURISDICTIONAL WETLANDS AND WATERWAYS THAT THE CORP AND NHEES AUTHORIZES TO BE FILLED AND IMPACT THOSE AREAS THAT THE CORPS AND NHEES AUTHORIZES AS SECONDARY IMPACTS. IF NOT SPECIFICALLY AUTHORIZED BY USACE AND AND NHEES, ANY UNAUTHORIZED FILL OR SECONDARY IMPACT TO WETLANDS MAY BE CONSIDERED AS A VIOLATION OF THE CWA.

UNLESS SPECIFICALLY AUTHORIZED USACE AND AND NHEES, NO WORK SHALL DRAW A WATER OF THE U.S. BY PROVIDING A CONDUIT FOR WATER ON OR BELOW THE SURFACE.

HEAVY EQUIPMENT IN FRESH WATER WETLANDS

WORKING IN WETLANDS SHALL NOT BE STORED, MAINTAINED OR REPAIRED IN WETLANDS, UNLESS IT IS LESS ENVIRONMENTALLY DAMAGING OTHERWISE, AND AS MUCH AS POSSIBLE SHALL NOT BE OPERATED WITHIN THE INTERTIDAL ZONE. WHERE CONSTRUCTION REQUIRES HEAVY EQUIPMENT OPERATION IN WETLANDS, THE EQUIPMENT SHALL EITHER HAVE LOW GROUND PRESSURE (<3 PSI), OR SHALL NOT BE LOCATED DIRECTLY ON WETLAND SOILS AND VEGETATION. IT SHALL BE PLACED ON SWAMP MATS THAT ARE ADEQUATE TO SUPPORT THE EQUIPMENT IN SUCH A WAY AS TO MINIMIZE DISTURBANCE OF WETLAND SOIL AND VEGETATION. SWAMP MATS ARE TO BE PLACED IN THE WETLAND FROM THE UPLAND OR FROM EQUIPMENT POSITIONED ON SWAMP MATS IF WORKING WITHIN A WETLAND. DRAGGING SWAMP MATS INTO POSITION IS PROHIBITED. OTHER SUPPORT STRUCTURES THAT ARE LESS IMPACTING AND ARE CAPABLE OF SAFELY SUPPORTING EQUIPMENT MAY BE USED WITH WRITTEN CORPS AND NHEES AUTHORIZATION. SIMILARLY, NOT USING MATS DURING FROZEN, DRY OR OTHER CONDITIONS MAY BE ALLOWED WITH WRITTEN CORPS AND NHEES AUTHORIZATION. AN ADEQUATE SUPPLY OF SPILL CONTAINMENT EQUIPMENT SHALL BE MAINTAINED ON SITE. CORRIDORY ROADS AND SWAMP/CONSTRUCTION MATS ARE CONSIDERED AS FILL WHETHER THEY'RE INSTALLED TEMPORARILY OR PERMANENTLY.

TIME OF YEAR WORK WINDOW AND NOISE RESTRICTIONS

- I. PILES INSTALLED IN-DRY DURING LOW WATER OR IN-WATER BETWEEN NOV. 8TH - APR. 9TH, OR
 - II. MUST BE DRILLED AND PINNED TO LEDGE, OR
 - III. VIBRATORY HAMMERS USED TO INSTALL ANY SIZE AND QUANTITY OF WOOD, CONCRETE OR STEEL PILES, OR
 - IV. IMPACT HAMMERS LIMITED TO ONE HAMMER AND <50 PILES INSTALLED/DAY WITH THE FOLLOWING: WOOD PILES OF ANY SIZE, CONCRETE PILES 18-INCHES DIAMETER, STEEL PILES 12-INCHES DIAMETER IF THE HAMMER IS 3,000 LBS. AND A WOOD CUSHION IS USED BETWEEN THE HAMMER AND STEEL PILE.
- FOR 8-IV ABOVE:
1. IN-WATER NOISE LEVELS SHALL NOT >187dB SEL RE WPa OR 206dB PEAK RE WPa AT A DISTANCE >10M FROM THE PILE BEING INSTALLED, AND
 2. IN-WATER NOISE LEVELS >155dB PEAK RE WPa SHALL NOT EXCEED 12 CONSECUTIVE HOURS ON ANY GIVEN DAY AND A 12 HOUR RECOVERY PERIOD (I.E. IN-WATER NOISE BELOW 132dB PEAK RE WPa) MUST BE PROVIDED BETWEEN WORK DAYS.

WORK SITE RESTORATION

- I. UPON COMPLETION OF CONSTRUCTION, ALL DISTURBED WETLAND AREAS SHALL BE PROPERLY STABILIZED. ANY SEED MIX SHALL CONTAIN ONLY PLANT SPECIES NATIVE TO NEW ENGLAND.
- II. THE INTRODUCTION OR SPREAD OF INVASIVE PLANT SPECIES IN DISTURBED AREAS IS PROHIBITED.
- III. IN AREAS OF AUTHORIZED TEMPORARY DISTURBANCE, IF TREES ARE CUT THEY SHALL BE CUT AT GROUND LEVEL AND NOT LIEBROTTEN IN ORDER TO PREVENT DISRUPTION TO THE WETLAND SOIL STRUCTURE AND TO ALLOW STUMP SPROUTS TO REVEGETATE THE WORK AREA UNLESS OTHERWISE AUTHORIZED.
- IV. WETLAND AREAS WHERE PERMANENT DISTURBANCE IS NOT AUTHORIZED SHALL BE RESTORED TO THEIR ORIGINAL CONDITION AND ELEVATION, WHICH UNDER NO CIRCUMSTANCES SHALL BE HIGHER THAN THE PRE-CONSTRUCTION ELEVATION. ORIGINAL CONDITION MEANS CAREFUL PROTECTION AND/OR REMOVAL OF EXISTING SOIL AND VEGETATION, AND REPLACEMENT BACK TO THE ORIGINAL LOCATION SUCH THAT THE ORIGINAL SOIL LAYERING AND VEGETATION SCHEMES ARE APPROXIMATELY THE SAME, UNLESS AUTHORIZED.

SEDIMENTATION AND EROSION CONTROL

ADEQUATE SEDIMENTATION AND EROSION CONTROL MEASURES, PRACTICES AND DEVICES, SUCH AS PHASED CONSTRUCTION, VEGETATED FILTER STRIPS, GEOTEXTILE SILT FENCES, STORMWATER DETENTION AND INFILTRATION SYSTEMS, SEDIMENT DETENTION BASINS, OR OTHER DEVICES SHALL BE INSTALLED AND PROPERLY MAINTAINED TO REDUCE EROSION AND RETAIN SEDIMENT ON-SITE DURING AND AFTER CONSTRUCTION. THEY SHALL BE CAPABLE OF PREVENTING EROSION, OF COLLECTING SEDIMENT, SUSPENDED AND FLOATING MATERIALS, AND OF FILTERING FINE SEDIMENT. THE DISTURBED AREAS SHALL BE STABILIZED AND THESE DEVICES SHALL BE REMOVED UPON COMPLETION OF WORK. THE SEDIMENT COLLECTED BY THESE DEVICES SHALL BE REMOVED AND PLACED AT AN UPLAND LOCATION, IN A MANNER THAT WILL PREVENT ITS LATER EROSION INTO A WATERWAY OR WETLAND. ALL EXPOSED SOIL AND OTHER FILLS SHALL BE PERMANENTLY STABILIZED AT THE EARLIEST PRACTICABLE DATE.

SPAWNING AREAS

DISCHARGES OF DREDGED OR FILL MATERIAL AND/OR SUSPENDED SEDIMENT PRODUCING ACTIVITIES IN FISH AND SHELLFISH SPAWNING OR NURSERY AREAS, OR AMPHIBIAN AND MIGRATORY BIRD BREEDING AREAS, DURING SPAWNING OR BREEDING SEASONS SHALL BE AVOIDED. IMPACTS TO THESE AREAS SHALL BE MINIMIZED TO THE MAXIMUM EXTENT PRACTICABLE DURING ALL TIMES OF THE YEAR. INFORMATION ON SPAWNING HABITAT FOR SPECIES MANAGED UNDER THE MAGNUSON-STEVENS FISHERY CONSERVATION AND MANAGEMENT ACT (I.E. EPI FOR SPAWNING ADULTS) CAN BE OBTAINED FROM THE NHEES WEBSITE AT: WWW.NHEES.NMMA.GOV/NHEES.

STORAGE OF SEASONAL STRUCTURES

COASTAL STRUCTURES SUCH AS PIER SECTIONS, FLOATS, ETC., THAT ARE REMOVED FROM THE WATERWAY FOR A PORTION OF THE YEAR (OFTEN REFERRED TO AS SEASONAL STRUCTURES) SHALL BE STORED IN AN UPLAND LOCATION, LOCATED ABOVE HIGHEST OBSERVABLE TIDE LINE (HOTL) AND NOT IN FRESH WETLANDS. THESE SEASONAL STRUCTURES MAY BE STORED ON THE FIXED, PILE-SUPPORTED PORTION OF THE STRUCTURE THAT IS SEAWARD OF HOTL. THIS IS INTENDED TO PREVENT STRUCTURES FROM BEING STORED ON THE MARSH SUBSTRATE AND THE SUBSTRATE SEAWARD OF WHM.

ENVIRONMENTAL FUNCTIONS AND VALUES

THE PERMITTEE SHALL MAKE EVERY REASONABLE EFFORT TO 1) CARRY OUT THE CONSTRUCTION OR OPERATION OF THE WORK AUTHORIZED BY USACE AND NHEES HEREIN IN A MANNER THAT MINIMIZES ADVERSE IMPACTS ON FISH, WILDLIFE AND NATURAL ENVIRONMENTAL VALUES, AND 2) PREVENT THE ESTABLISHMENT OR SPREAD OF PLANT SPECIES IDENTIFIED AS NON-NATIVE INVASIVE SPECIES BY ANY FEDERAL OR STATE AGENCY. SEE THE SECTION ON INVASIVE SPECIES AT HTTP://WWW.NAE.USACE.ARMY.MIL/REGULATORY/ FOR CONTROL METHODS.

INSPECTIONS

THE PERMITTEE SHALL ALLOW THE CORPS AND NHEES TO MAKE PERIODIC INSPECTIONS AT ANY TIME DEEMED NECESSARY IN ORDER TO ENSURE THAT THE WORK IS BEING OR HAS BEEN PERFORMED IN ACCORDANCE WITH THE TERMS AND CONDITIONS OF THIS PERMIT. THE CORPS AND NHEES MAY ALSO REQUIRE POST-CONSTRUCTION ENGINEERING DRAWINGS FOR COMPLETED WORK, AND POST-DREDGING SURVEY DRAWINGS FOR ANY DREDGING WORK.

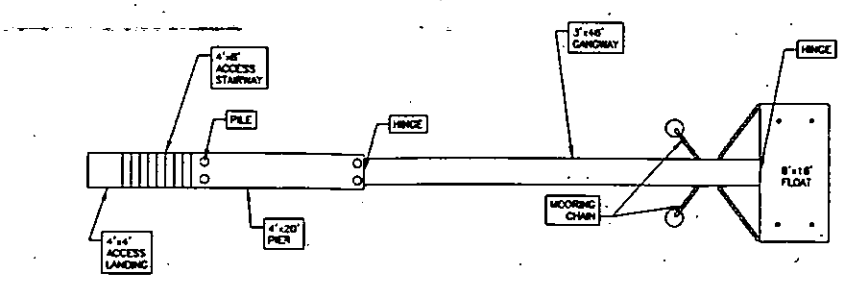

PROPOSED DOCK PLAN

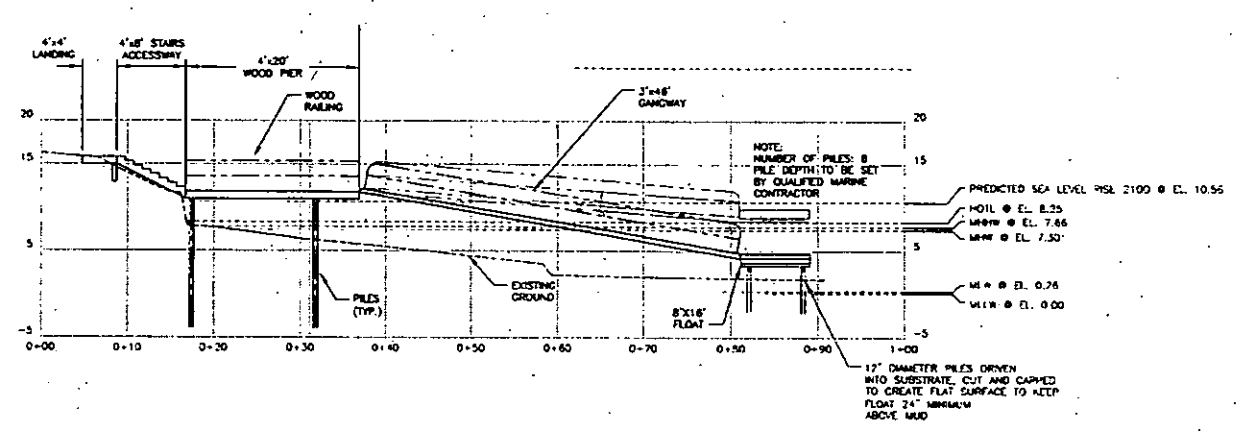

PROPOSED DOCK ELEVATION

PROPOSED PIER, GANGWAY & FLOAT w/ PILES

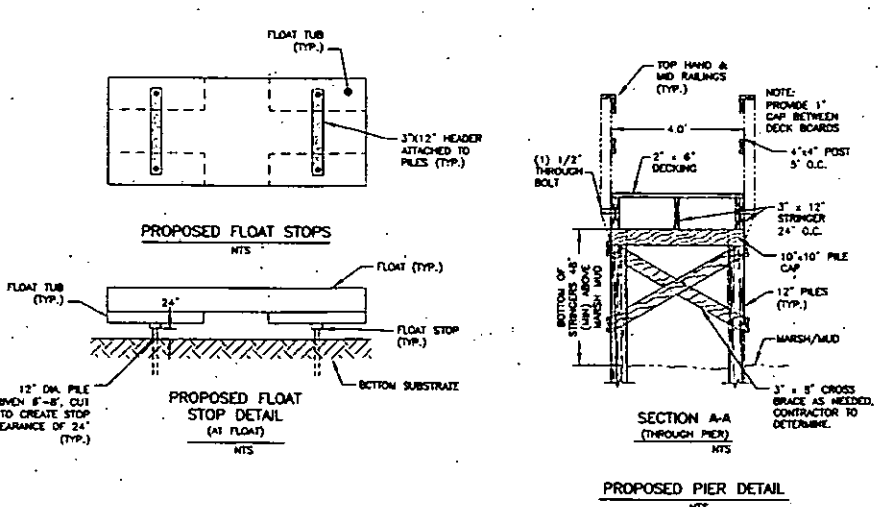
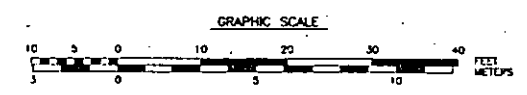

RECEIVED
OCT 08 2020
ENVIRONMENTAL SERVICES
"BY NH DES WETLANDS BUREAU"

AMBIT ENGINEERING, INC.
Civil Engineers & Land Surveyors
508 Griffin Road - Unit 3
Portsmouth, N.H. 03801-7114
Tel (603) 436-8282
Fax (603) 434-2315

RIVERSIDE PILING
MARINE CONTRACTORS

- NOTES:
- 1) THE CONTRACTOR SHALL NOTIFY DGS SAFE AT 1-888-DG-SAFE (1-888-344-7233) AT LEAST 72 HOURS PRIOR TO COMMENCING ANY EXCAVATION ON PUBLIC OR PRIVATE PROPERTY.
 - 2) UNDERGROUND UTILITY LOCATIONS ARE BASED UPON BEST AVAILABLE EVIDENCE AND ARE NOT FIELD VERIFIED. LOCATING AND PROTECTING ANY ABOVEGROUND OR UNDERGROUND UTILITIES IS THE SOLE RESPONSIBILITY OF THE CONTRACTOR AND/OR THE OWNER. UTILITY CONFLICTS SHOULD BE REPORTED AT ONCE TO THE DESIGN ENGINEER.
 - 3) CONTRACTOR SHALL INSTALL AND MAINTAIN EROSION CONTROL MEASURES IN ACCORDANCE WITH THE "NEW HAMPSHIRE STORMWATER MANUAL, VOLUME 3, EROSION AND SEDIMENT CONTROL" DURING CONSTRUCTION. (NHDES DECEMBER 2008).
 - 4) NUMBER OF PILES TO BE DRIVEN FOR DOCKING STRUCTURE NOT TO EXCEED B AS DEPICTED ON PROPOSED DOCK ELEVATION. ALSO NOTE TIME OF YEAR AND NOISE RESTRICTIONS FOR DRIVING OF PILES.

TIDAL DOCKING STRUCTURE
HAGNER & ELLIOTT
RESIDENCE.
97 WATERS EDGE
GREENLAND, N.H.

NO.	DESCRIPTION	DATE
1	1' FLOAT STOP HEIGHT	10/7/20
0	ISSUED FOR COMMENT	8/5/20

REVISIONS

SCALE 1"=10' AUGUST 2020
DOCK DETAILS
D1