

Jan  
JH



The State of New Hampshire  
**Department of Environmental Services**



**Robert R. Scott, Commissioner**

August 13, 2019

His Excellency, Governor Christopher T. Sununu  
and The Honorable Council  
State House  
Concord, NH 03301

**REQUESTED ACTION**

Approve PDA – Division of Ports & Harbors' request to perform the following work on the Atlantic Ocean in Hampton. File # 2019-00003. This project will not have significant impact on or adversely affect the values of Atlantic Ocean.

Maintenance dredge a total of 152,000 cubic yards of accumulated and/or shoaled sands and an area of 1,070,411 square feet (approximately 24.5 acres) within Hampton-Seabrook Harbor to restore the controlling depths within the federal anchorage, ancillary channels, the entrance channel and the NH State anchorages. Dredged materials will be disposed of on Hampton Beach State Park, Seabrook Beach, beneath the southern abutment of the Route 1A Bridge, and behind an existing sheet pile wall built in 2005 to protect the middle ground sand flat in Seabrook.

The New Hampshire Department of Environmental Services (NHDES) imposed the following conditions as part of this approval:

1. All work shall be in accordance with the following plans by the US Army Corps of Engineers:
  - a. Plans dated 10/25/2018 as received by the NH Department of Environmental Services Wetlands Bureau (NHDES) on February 22, 2019; and,
  - b. Plan dated 3/21/2019 as received by the NHDES on May 7, 2019.
2. Not less than 5 state business days prior to starting work authorized by this permit, the permittee shall notify the NHDES and the Hampton and Seabrook Conservation Commissions in writing of the date on which work under this permit is expected to start.
3. Any further alteration of areas on this property that are subject to RSA 482-A jurisdiction will require a new application further permitting.
4. At least 48 hours prior to the start of dredging, a pre-construction meeting shall be held with the NHDES technical staff at the project site to review the conditions of this wetlands permit. It shall be the responsibility of the permittee to schedule the pre-construction meeting, and the meeting shall be attended by the permittee, their professional engineer, the contractor(s) and any other party responsible for performing or overseeing the work.
5. No person undertaking any activity shall cause or contribute to, or allow the activity to cause or contribute to, any violations of the surface water quality standards in RSA 485-A and Env-Wq 1700.
6. Dredged materials shall be disposed of in designated beach nourishment areas as shown on the approved plans
7. Approved disposal locations may be modified by agreement between the NHDES, the NH Department of Natural & Cultural Resources (DNCR), the NH Fish and Game Department (NHFG), the US Fish and Wildlife Service and the permittee prior to the start of dredging.
8. Dredging time frame within Hampton-Seabrook Harbor shall occur between October 15 and March 15.
9. Beach nourishment activities shall occur between October 1 and March 15.
10. In the event a hopper dredge is used to dredge the harbor entrance channel, dredge and nearshore disposal shall occur between May 1 and July 31.

11. Any request for dredging outside this time frame will be for emergency conditions only, and must be coordinated with the NHDES and the NHFG.
12. There shall be no work to construct the temporary access roadway (TAR) prior to August 1st to eliminate concerns for Piping Plover interactions and September 1st for Least Tern interactions. However, there have been no Least Terns observed in this area to date. The NHFG will survey this area prior to August to assure no Least Terns are using this area. Work may begin August 1st if no Least Terns are observed, and piping plovers are no longer using the habitat.
13. The TAR adjacent to Rt. 1A south of the Rt. 1A Bridge to access shoreline work allowing construction vehicles access for both the NHDOT and the ACOE to stabilize the Rt. 1A Bridge footing/abutment structure and to distribute dredge spoils from the dredge project (during the dredge window), respectively.
14. Impacts to the sand dune within the TAR shall be monitored and restored in coordination with the NH Sea Grant.
15. Sand dune vegetation including, but not limited to, American Beachgrass (*Ammophila breviligulata*) can only be removed between April/May and September through November.
16. Transplanting of sand dune vegetation shall be done in coordination with the NH Sea Grant/UNH Extension. The NH Sea Grant/UNH Extension shall be contacted at least 14 days prior to starting work authorized by this permit.
17. This project shall not disturb any sand dune vegetation growing on adjacent properties.
18. Excavated plants shall be shaken gently to remove sand prior to the roots being stored in large, heavy garbage bags and stacked horizontally in the bags to prevent breaking the plants. Plants shall be stored in a cool, above freezing location so the plants can be replanted in the ground.
19. A post-construction report documenting status of the project area and transplanted locations including photographs shall be submitted to the NHDES within 7 days of the completion of project.
20. Extreme precautions shall be taken within riparian areas to prevent unnecessary removal of vegetation during construction. Areas cleared of vegetation must be revegetated with like native species within three days of the completion of the disturbance.
21. Construction equipment shall be inspected daily for leaking fuel, oil, and hydraulic fluid prior to entering surface waters or wetlands or operating in an area where such fluids could reach groundwater, surface waters, or wetlands.
22. The permittee's contractor shall maintain appropriate oil/diesel fuel spill kits on site that are readily accessible at all times during construction, and shall train each operator in the use of the kits.

#### EXPLANATION

The NHDES approved this project on July 03, 2019. The NHDES supported its decision with the following findings:

1. In 2004, the NHDES approved Wetlands and Non-Site Specific Permit 2003-01869 to: "Dredge a total of 742,000 sq. ft. (17 acres) of sandy marine sediments in Hampton-Seabrook Harbor for work associated with the realignment of the Blackwater River channel to abate shoreline and tidal flat erosion which has restricted use of the navigational channel and anchorage. Dredged material will be disposed of in a containment cell formed by the construction of two (2) driven composite sheet pile walls extending northward from the shoreline at River Street. The west wall will extend 1,100 linear feet with a 35-degree bend at 2/3rds the distance from River Street. The east wall will extend 500 linear feet from River Street."
2. Following the 2004 approval, the Hampton-Seabrook Harbor had been dredged in 2013 under Wetlands and Non-Site Specific Permit 2012-01073 to: "Maintenance dredge a total of 172,200 cu. yds. of accumulated and/or shoaled sands and gravel over an area of 1,530,000 sq. ft. (approx. 35 acres) within Hampton-Seabrook Harbor to restore the controlling depths within the NH State anchorages and navigational channels. Dredged materials will be disposed of in designated beach nourishment areas located northerly and southerly of the Hampton-Seabrook Harbor inlet."
3. Since 2013, the Blackwater River channel has deposited sediment back in the previously dredge areas at an accelerated rate.
4. This project has been reviewed extensively by the NHDES Dredge Management Task Force which has overseen a coordinated review process involving all stakeholders in the project including the NH Department of Transportation

(NHDOT), the NH Department of Fish and Game (NHFG), the NH Department of Natural and Cultural Resources (DNCR), the US Environmental Protection Agency, the National Oceanic and Atmospheric Administration National Marine Fisheries Service, the US Army Corps of Engineers, the Seabrook and Hampton Board of Selectmen and Conservation Commission, the Pease Development Authority (PDA) Division of Ports and Harbors, the applicant.

5. This is a major impact project per New Hampshire Administrative Rule Env-Wt 303.02(a), (a) Projects in sand dunes, tidal wetlands, or bogs, except for repair of existing structures pursuant to Env-Wt 303.04(v) and New Hampshire Administrative Rule Env-Wt 303.02(g) Removal of more than 20 cubic yards of rock, gravel, sand, mud, or other material from public waters.

6. The applicant has provided evidence which demonstrates that this proposal is the alternative with the least adverse impact to areas and environments under the NHDES' jurisdiction per New Hampshire Administrative Rule Env-Wt 302.03.

7. The applicant has demonstrated by plan and example that each factor listed in New Hampshire Administrative Rule Env-Wt 302.04(a) and (c), Requirements for Application Evaluation, has been considered in the design of the project.

8. The Wetlands Permit Application (Application) included NH Natural Heritage Bureau (NHB) Datacheck Results Letter NHB18-3393 identifying the following in the vicinity of the proposed project: four (4) natural communities, seven (7) State-Endangered/threatened plant species, and two (2) vertebrate species, State-Endangered Least Tern (*Sternula antillarum*) and the State-Endangered, Federally-Threatened Piping Plover (*Charadrius melodus*).

9. In response to the NHB letter, the applicant has coordinated with the NHFG relative to the Least Tern and Piping Plover.

10. The NH Division of Historical Resources reviewed the project and found "No Potential to cause Effects." With comments, "Please coordinate with NHDOT for scheduling as Hampton Bridge dredge material disposal site is within area of bridge replacement repair project and subject to historical resources survey."

11. A letter dated January 23, 2019 from the Hampton Conservation Commission stated, in summary, "The [Hampton] Conservation Commission does not oppose the granting of this NHDES Standard Dredge and Fill permit with the request the Commission be notified at the beginning and end of the project. The Commission recommends, if feasible, the placement of dredge spoils in beach area on the northeast side of the northeast side of the NH State Park that has experienced dune erosion."

12. On March 21, 2019, the NHDES approved the Water Quality Certification (WQC) in accordance with Section 401 of the Clean Water Act (33 U.S.C. 1341) and NH RSA 485-A:12, III.

13. On March 22, 2019, the NHDES Coastal Program found the proposal, "to be consistent, to the maximum extent practicable, with the enforceable polices of New Hampshire's federally approved coastal management program," pursuant to Section 307(c)(1) of the Coastal Zone Management Act, 16 U.S.C §1456(c)(1).

14. On April 26, 2019, the NHFG, the DNCR, the NHDOT, and the PDA entered into a Memorandum of Understanding relative to access on and impact to Hampton Parcel 21-22-24, Hampton Parcel 299-22, and the NHDOT right-of-way along the west side of NH Route 1A.

13. The PDA obtained written permission from the property owners of Seabrook Tax Map 21 Lots 6-1, 6-2, 500-4, and 500-7 for impacts to their property.

14. In accordance with RSA 482-A:8, the NHDES finds that the requirements for a public hearing do not apply as the permitted project is not of substantial public interest, and will not have a significant impact on or adversely affect the values of the estuarine and marine resources, as identified under RSA 482-A:1.

Application file documents are being forwarded to the Governor and the Executive Council in connection with their consideration of this matter pursuant to RSA 482-A:3,II.(a) as it is a major project in public waters of the state.

Respectfully submitted,

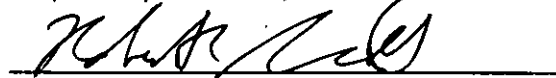

Robert R. Scott  
Commissioner



# WETLANDS PERMIT APPLICATION

Water Division/ Wetlands Bureau  
Land Resources Management

Check the status of your application: [www.des.nh.gov/onestop](http://www.des.nh.gov/onestop)



<b>RECEIVED</b> JAN 02 2019 NHDES LAND RESOURCES MANAGEMENT	<b>COMPLETE</b> JAN 02 2019	Administrative 2019-0003 211-11 70-000 517
--	--------------------------------	--

**1. REVIEW TIME:** Indicate your Review Time below. To determine review time, refer to Guidance Document A for instructions.

Standard Review (Minimum, Minor or Major Impact)
  Expedited Review (Minimum Impact only)

**2. MITIGATION REQUIREMENT:**

If mitigation is required a Mitigation Pre-Application meeting must occur prior to submitting this Wetlands Permit Application. To determine if Mitigation is Required, please refer to the Determine if Mitigation is Required Frequently Asked Question.

Mitigation Pre-Application Meeting Date: Month: \_\_\_ Day: \_\_\_ Year: \_\_\_

N/A - Mitigation is not required.

**3. PROJECT LOCATION:**

Separate wetland permit applications must be submitted for each municipality that wetland impacts occur within.

ADDRESS: **Hampton-Seabrook Harbor** TOWN/CITY: **Hampton & Seabrook**

TAX MAP: **N/A** BLOCK: **N/A** LOT: **N/A** UNIT: **N/A**

USGS TOPO MAP WATERBODY NAME: **Atlantic Ocean**  NA STREAM WATERSHED SIZE:  NA

LOCATION COORDINATES (if known): **42.8968, -70.8184**  Latitude/Longitude  UTM  State Plane

**4. PROJECT DESCRIPTION:**

Provide a brief description of the project outlining the scope of work. Attach additional sheets as needed to provide a detailed explanation of your project. **DO NOT** reply "See Attached" in the space provided below.

This project involves the maintenance dredging of the Federal Navigation Project (FNP) and the State anchorage of approximately 150,000 cubic yards (cy) of sandy material from the Hampton Harbor entrance channel, Seabrook Harbor, and Hampton Harbor with a hydraulic dredge. The clean sandy material will be placed for beneficial use as described in the attachments.

**5. SHORELINE FRONTAGE:**

NA This does not have shoreline frontage. SHORELINE FRONTAGE:

Shoreline frontage is calculated by determining the average of the distances of the actual natural navigable shoreline frontage and a straight line drawn between the property lines, both of which are measured at the normal high water line.

**6. RELATED NHDES LAND RESOURCES MANAGEMENT PERMIT APPLICATIONS ASSOCIATED WITH THIS PROJECT:**

Please indicate if any of the following permit applications are required and, if required, the status of the application. To determine if other Land Resources Management Permits are required, refer to the Land Resources Management Web Page.

Permit Type	Permit Required	File Number	Permit Application Status
Alteration of Terrain Permit Per RSA 485-A:17	<input type="checkbox"/> YES <input checked="" type="checkbox"/> NO	_____	<input type="checkbox"/> APPROVED <input type="checkbox"/> PENDING <input type="checkbox"/> DENIED
Individual Sewerage Disposal per RSA 485-A:2	<input type="checkbox"/> YES <input checked="" type="checkbox"/> NO	_____	<input type="checkbox"/> APPROVED <input type="checkbox"/> PENDING <input type="checkbox"/> DENIED
Subdivision Approval Per RSA 485-A	<input type="checkbox"/> YES <input checked="" type="checkbox"/> NO	_____	<input type="checkbox"/> APPROVED <input type="checkbox"/> PENDING <input type="checkbox"/> DENIED
Shoreland Permit Per RSA 483-B	<input type="checkbox"/> YES <input checked="" type="checkbox"/> NO	_____	<input type="checkbox"/> APPROVED <input type="checkbox"/> PENDING <input type="checkbox"/> DENIED

**7. NATURAL HERITAGE BUREAU & DESIGNATED RIVERS:**

See the Instructions & Required Attachments document for instructions to complete a & b below.

a. Natural Heritage Bureau File ID: **NHB 18 - 3393**

b.  Designated River the project is in ¼ miles of \_\_\_\_\_; and  
 date a copy of the application was sent to the **Local River Management Advisory Committee**: Month: \_\_\_ Day: \_\_\_ Year: \_\_\_

N/A

**8. APPLICANT INFORMATION (Desired permit holder)**LAST NAME, FIRST NAME, M.I.: **Geno J. Marconi**TRUST / COMPANY NAME: **PDA - Division of Ports & Harbors**MAILING ADDRESS: **555 Market Street**TOWN/CITY: **Portsmouth**STATE: **NH**ZIP CODE: **03801**EMAIL or FAX: **g.marconi@peasedev.org**PHONE: **603 436-8500**ELECTRONIC COMMUNICATION: By initialing here: **trs**, I hereby authorize NHDES to communicate all matters relative to this application electronically.**9. PROPERTY OWNER INFORMATION (If different than applicant)**

LAST NAME, FIRST NAME, M.I.:

TRUST / COMPANY NAME:

MAILING ADDRESS:

TOWN/CITY:

STATE:

ZIP CODE:

EMAIL or FAX:

PHONE:

ELECTRONIC COMMUNICATION: By initialing here \_\_\_\_\_, I hereby authorize NHDES to communicate all matters relative to this application electronically.

**10. AUTHORIZED AGENT INFORMATION**LAST NAME, FIRST NAME, M.I.: **Shattuck, Tracy R.**COMPANY NAME: **PDA - Division of Ports & Harbors**MAILING ADDRESS: **555 Market Street**TOWN/CITY: **Portsmouth**STATE: **NH**ZIP CODE: **03801**EMAIL or FAX: **t.shattuck@peasedev.org**PHONE: **603 436-8500**ELECTRONIC COMMUNICATION: By initialing here **trs**, I hereby authorize NHDES to communicate all matters relative to this application electronically.**11. PROPERTY OWNER SIGNATURE**

See the Instructions &amp; Required Attachments document for clarification of the below statements.

By signing the application, I am certifying that:

1. I authorize the applicant and/or agent indicated on this form to act in my behalf in the processing of this application, and to furnish upon request, supplemental information in support of this permit application.
2. I have reviewed and submitted information & attachments outlined in the Instructions and Required Attachment document.
3. All abutters have been identified in accordance with RSA 482-A:3, I and Env-Wt 100-900.
4. I have read and provided the required information outlined in Env-Wt 302.04 for the applicable project type.
5. I have read and understand Env-Wt 302.03 and have chosen the least impacting alternative.
6. Any structure that I am proposing to repair/replace was either previously permitted by the Wetlands Bureau or would be considered grandfathered per Env-Wt 101.47.
7. I have submitted a Request for Project Review (RPR) Form ([www.nh.gov/nhdhr/review](http://www.nh.gov/nhdhr/review)) to the NH State Historic Preservation Officer (SHPO) at the NH Division of Historical Resources to identify the presence of historical/ archeological resources while coordinating with the lead federal agency for NHPA 106 compliance.
8. I authorize NHDES and the municipal conservation commission to inspect the site of the proposed project.
9. I have reviewed the information being submitted and that to the best of my knowledge the information is true and accurate.
10. I understand that the willful submission of falsified or misrepresented information to the New Hampshire Department of Environmental Services is a criminal act, which may result in legal action.
11. I am aware that the work I am proposing may require additional state, local or federal permits which I am responsible for obtaining.
12. The mailing addresses I have provided are up to date and appropriate for receipt of NHDES correspondence. NHDES will not forward returned mail.

  
Property Owner Signature

**Geno Marconi**  
Print name legibly

**12/19/2018**  
Date

**MUNICIPAL SIGNATURES**

**12. CONSERVATION COMMISSION SIGNATURE**

The signature below certifies that the municipal conservation commission has reviewed this application, and:

1. Waives its right to intervene per RSA 482-A:11;
2. Believes that the application and submitted plans accurately represent the proposed project; and
3. Has no objection to permitting the proposed work.

Print name legibly

Date

**DIRECTIONS FOR CONSERVATION COMMISSION**

1. Expedited review ONLY requires that the conservation commission's signature is obtained in the space above.
2. Expedited review requires the Conservation Commission signature be obtained prior to the submittal of the original application to the Town/City Clerk for signature.
3. The Conservation Commission may refuse to sign. If the Conservation Commission does not sign this statement for any reason, the application is not eligible for expedited review and the application will be reviewed in the standard review time frame.

**13. TOWN / CITY CLERK SIGNATURE**

As required by Chapter 482-A:3 (amended 2014), I hereby certify that the applicant has filed four application forms, four detailed plans, and four USGS location maps with the town/city indicated below.

*Hampton Deputy Clerk*  
*Christi A. Biddette*

Town/City Clerk Signature

*Cheryl A. Hildreth*

Print name legibly

*Hampton*

Town/City

*12/27/18*

Date

**DIRECTIONS FOR TOWN/CITY CLERK:**

Per RSA 482-A:3,1

1. For applications where "Expedited Review" is checked on page 1, if the Conservation Commission signature is not present, NHDES will accept the permit application, but it will NOT receive the expedited review time.
2. IMMEDIATELY sign the original application form and four copies in the signature space provided above;
3. Return the signed original application form and attachments to the applicant so that the applicant may submit the application form and attachments to NHDES by mail or hand delivery.
4. IMMEDIATELY distribute a copy of the application with one complete set of attachments to each of the following bodies: the municipal Conservation Commission, the local governing body (Board of Selectmen or Town/City Council), and the Planning Board; and
5. Retain one copy of the application form and one complete set of attachments and make them reasonably accessible for public review.

**DIRECTIONS FOR APPLICANT:**

1. Submit the single, original permit application form bearing the signature of the Town/ City Clerk, additional materials, and the application fee to NHDES by mail or hand delivery.

[lm@des.nh.gov](mailto:lm@des.nh.gov) or (603) 271-2147

NHDES Wetlands Bureau, 29 Hazen Drive, PO Box 95, Concord, NH 03302-0095

[www.des.nh.gov](http://www.des.nh.gov)

**MUNICIPAL SIGNATURES**

**12. CONSERVATION COMMISSION SIGNATURE**

The signature below certifies that the municipal conservation commission has reviewed this application, and:

1. Waives its right to intervene per RSA 482-A:11
2. Believes that the application and submitted plans accurately represent the proposed project, and
3. Has no objection to permitting the proposed work.

Print name legibly

Date

**DIRECTIONS FOR CONSERVATION COMMISSION**

1. Expedited review ONLY requires that the conservation commission's signature is obtained in the space above.
2. Expedited review requires the Conservation Commission signature be obtained prior to the submittal of the original application to the Town/City Clerk for signature.
3. The Conservation Commission may refuse to sign. If the Conservation Commission does not sign this statement for any reason, the application is not eligible for expedited review and the application will be reviewed in the standard review time frame.

**13. TOWN / CITY CLERK SIGNATURE**

As required by Chapter 482-A:3 (amended 2014), I hereby certify that the applicant has filed four application forms, four detailed plans, and four USGS location maps with the town/city indicated below.

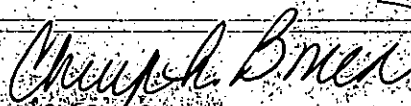
 Town/City Clerk Signature	Cheryl L. Bowen Print name legibly	Seabrook Town/City	12/27/18 Date
--	---------------------------------------	-----------------------	------------------

**DIRECTIONS FOR TOWN/CITY CLERK:**

Per RSA 482-A:3, I

1. For applications where "Expedited Review" is checked on page 1, if the Conservation Commission signature is not present, NHDES will accept the permit application, but it will NOT receive the expedited review time.
2. IMMEDIATELY sign the original application form and four copies in the signature space provided above;
3. Return the signed original application form and attachments to the applicant so that the applicant may submit the application form and attachments to NHDES by mail or hand delivery.
4. IMMEDIATELY distribute a copy of the application with one complete set of attachments to each of the following bodies: the municipal Conservation Commission, the local governing body (Board of Selectmen or Town/City Council), and the Planning Board; and
5. Retain one copy of the application form and one complete set of attachments and make them reasonably accessible for public review.

**DIRECTIONS FOR APPLICANT:**

1. Submit the single, original permit application form bearing the signature of the Town/ City Clerk, additional materials, and the application fee to NHDES by mail or hand delivery.



14. IMPACT AREA		
For each jurisdictional area that will be/has been impacted provide square feet and, if applicable, linear feet of impact.		
Permanent impacts that will remain after the project is complete		
Temporary impacts not intended to remain (and will be restored to pre-construction conditions) after the project is complete		
JURISDICTIONAL AREA	PERMANENT Sq. Ft. / Lin. Ft.	TEMPORARY Sq. Ft. / Lin. Ft.
Forested wetland	<input type="checkbox"/> ATF	<input type="checkbox"/> ATF
Scrub-shrub wetland	<input checked="" type="checkbox"/> ATF	<input type="checkbox"/> ATF
Emergent wetland	<input type="checkbox"/> ATF	<input checked="" type="checkbox"/> ATF
Wet meadow	<input type="checkbox"/> ATF	<input checked="" type="checkbox"/> ATF
Intermittent stream	<input checked="" type="checkbox"/> ATF	<input type="checkbox"/> ATF
Perennial Stream / River	/ <input type="checkbox"/> ATF	/ <input type="checkbox"/> ATF
Lake / Pond	/ <input type="checkbox"/> ATF	/ <input type="checkbox"/> ATF
Bank - Intermittent stream	/ <input checked="" type="checkbox"/> ATF	/ <input type="checkbox"/> ATF
Bank - Perennial stream / River	/ <input type="checkbox"/> ATF	/ <input type="checkbox"/> ATF
Bank - Lake / Pond	/ <input type="checkbox"/> ATF	/ <input type="checkbox"/> ATF
Tidal water	1,070,441 / <input type="checkbox"/> ATF	/ <input checked="" type="checkbox"/> ATF
Salt marsh	<input checked="" type="checkbox"/> ATF	<input type="checkbox"/> ATF
Sand dune	<input checked="" type="checkbox"/> ATF	<input checked="" type="checkbox"/> ATF
Prime wetland	<input checked="" type="checkbox"/> ATF	<input type="checkbox"/> ATF
Prime wetland buffer	<input type="checkbox"/> ATF	<input type="checkbox"/> ATF
Undeveloped Tidal Buffer Zone (TBZ)	1,030,000 <input type="checkbox"/> ATF	<input type="checkbox"/> ATF
Previously-developed upland in TBZ	<input type="checkbox"/> ATF	<input type="checkbox"/> ATF
Docking - Lake / Pond	<input type="checkbox"/> ATF	<input type="checkbox"/> ATF
Docking - River	<input type="checkbox"/> ATF	<input type="checkbox"/> ATF
Docking - Tidal Water	<input type="checkbox"/> ATF	<input type="checkbox"/> ATF
Vernal Pool	<input type="checkbox"/> ATF	<input type="checkbox"/> ATF
<b>TOTAL</b>	/	/

15. APPLICATION FEE. See the Instructions & Required Attachments document for further instruction

Minimum Impact Fee: Flat fee of \$ 200

Minor or Major Impact Fee: Calculate using the below table below

Permanent and Temporary (non-docking)	_____ sq. ft.	X \$0.20 =	\$ _____
Temporary (seasonal) docking structure:	_____ sq. ft.	X \$1.00 =	\$ _____
Permanent docking structure:	_____ sq. ft.	X \$2.00 =	\$ _____
Projects proposing shoreline structures (including docks) add \$200 =			\$ _____
Total =			\$ _____

The Application Fee is the above calculated Total or \$200, whichever is greater = **\$ 10,000**



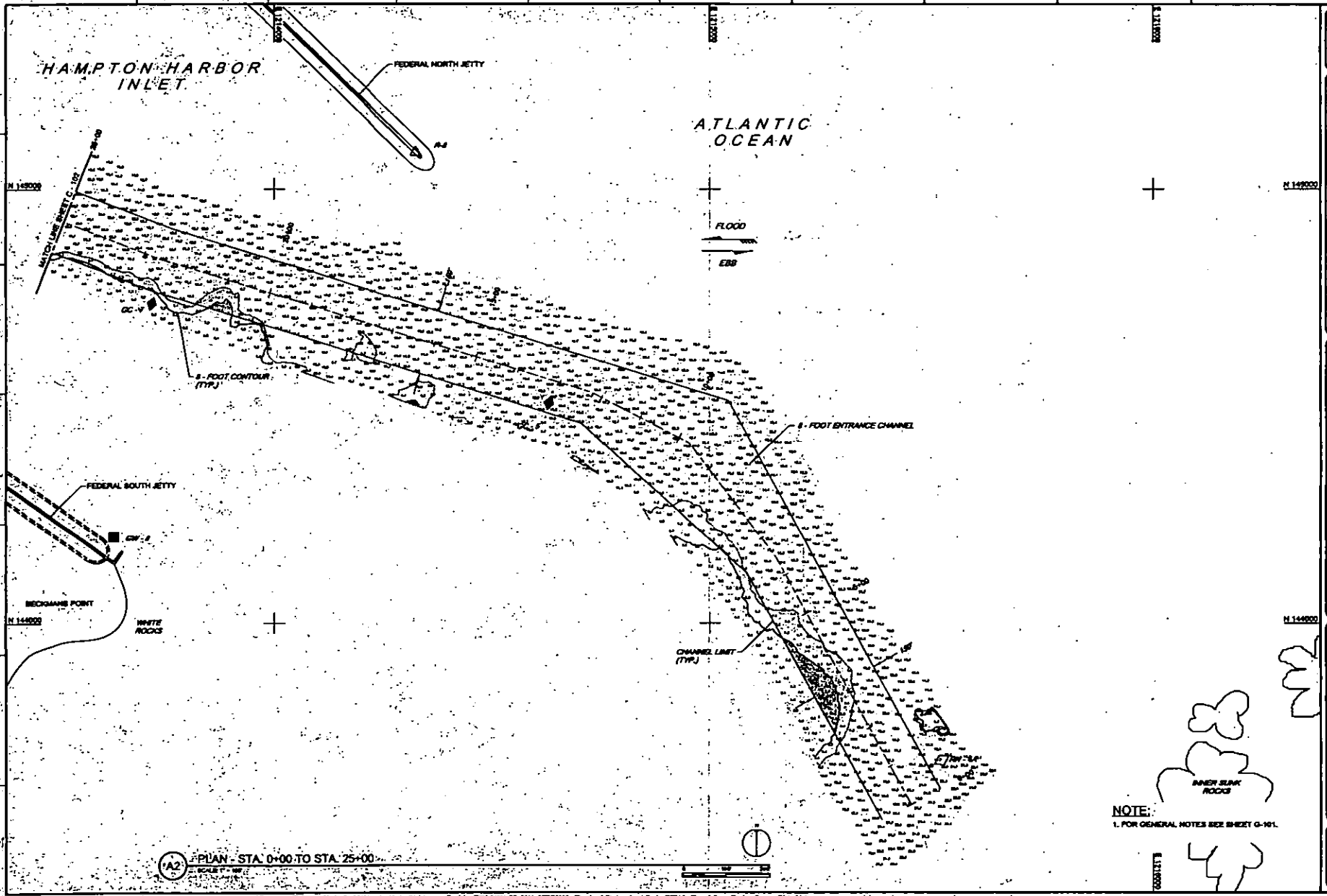

U.S. Army Corps of Engineers

NO.	DATE	DESCRIPTION

DESIGNED BY	DATE	SCALE
DRAWN BY	PROJECT NO.	AREA
CHECKED BY	DESIGNER'S NO.	

U.S. ARMY CORPS OF ENGINEERS  
 WASHINGTON FIELD OFFICE  
 400 MICHIGAN AVENUE, S.W.  
 WASHINGTON, D.C. 20319-0461

HAMPTON HARBOR  
 INLET AND ENTRANCE CHANNEL  
 8-FOOT CHANNEL AND ANCHORAGE

SHEET ID  
**C-101**

PRELIMINARY

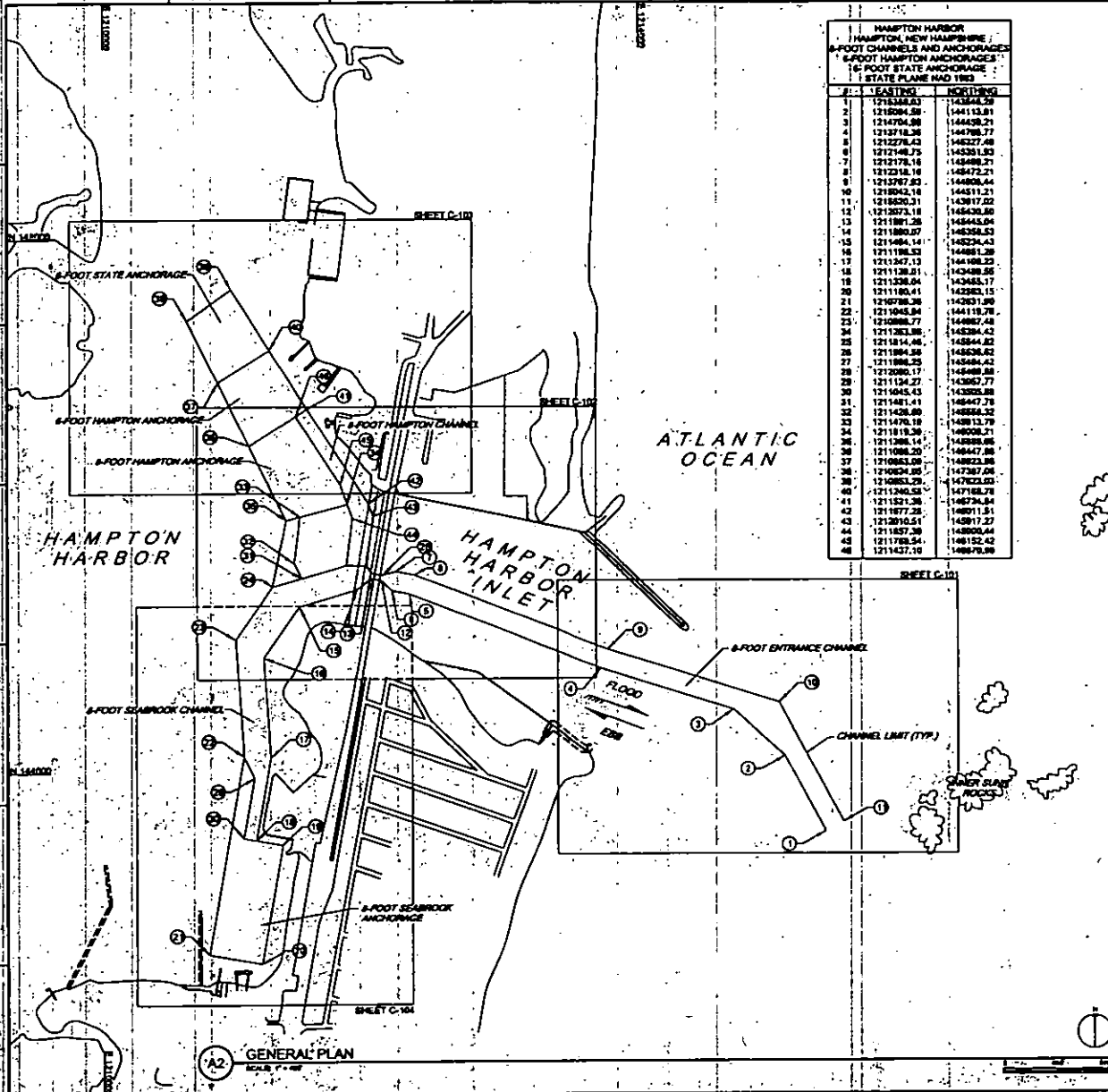

HAMPTON HARBOR  
6-FOOT CHANNELS AND ANCHORAGES  
6-FOOT HAMPTON ANCHORAGES  
16-FOOT STATE ANCHORAGE  
STATE PLANE NAD 1983

STATION	EASTING	NORTHING
1	121344.03	14354.53
2	121399.59	144113.81
3	1214704.98	144429.21
4	1213718.36	144788.77
5	121376.43	145227.69
6	1212148.75	145301.83
7	1212178.16	145488.21
8	1212318.16	145472.21
9	1213767.83	146008.44
10	1218042.18	146511.21
11	1216520.31	145917.02
12	1213037.18	145439.80
13	1211861.28	144845.04
14	1211880.07	145358.53
15	1211484.14	145324.43
16	1211188.53	144811.28
17	1211347.13	144188.22
18	1211138.01	143488.85
19	1211338.04	143485.17
20	1211180.41	143283.15
21	1210788.38	143283.15
22	1211045.84	144118.78
23	1210888.77	144887.48
24	1211283.86	145394.42
25	1211814.46	145448.82
26	1211864.58	145638.82
27	1211888.25	145684.42
28	1212088.13	145488.85
29	1211134.27	143057.77
30	1211045.43	143283.88
31	1211481.41	144472.78
32	1211428.80	145258.52
33	1211476.18	145811.21
34	1211818.38	146008.21
35	1211388.14	145398.85
36	1211088.20	144472.88
37	1210883.08	144822.88
38	121054.85	141781.08
39	1210883.29	147623.03
40	1211240.58	147188.78
41	1211521.28	148274.84
42	1211877.28	148811.51
43	1212010.51	148917.27
44	1211837.38	148888.44
45	1211785.54	148152.42
46	1211437.10	148878.88

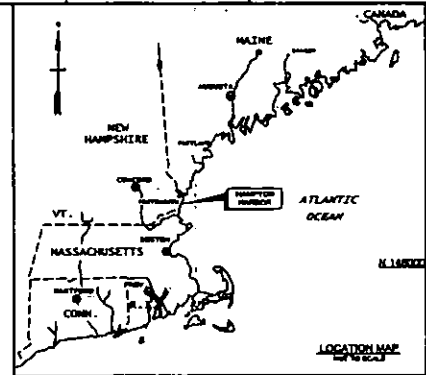

- GENERAL NOTES:**
- SOUNDINGS ARE IN FEET AND TENTHS. THE REFERENCE PLANE IS MEAN LOWER LOW WATER (MLLW) AND IS BASED ON THE 1983-2001 TIDAL EPOCH. SOUNDINGS NOTED WITH A (+) ARE ABOVE THE REFERENCE PLANE OF MLLW. SOUNDINGS WITHOUT A SIGN ARE BELOW THE REFERENCE PLANE OF MLLW AND SHOULD BE CONSIDERED NEGATIVE.
  - TOPOGRAPHY SHOWN IS FROM PREVIOUS SURVEYS, AERIAL IMAGERY AND/OR NOAA CHART NO. 13278. ALL TOPOGRAPHY, INCLUDING SHORELINE, BRIDGES, PIERLS, ETC., IS LOCATED APPROXIMATE UNLESS OTHERWISE NOTED AND SHOULD BE USED AS A GENERAL REFERENCE ONLY.
  - BENCH MARK DATA: TIDES WERE RECORDED USING RTK GPS. THE MLLW TO NAVD 83 CORRECTION FOR THIS PROJECT IS 5.17 FEET. THE CORRECTION IN REFERENCES FROM NOAA'S WOLFFM MODEL IN THE VICINITY OF HAMPTON HARBOR, NEW HAMPSHIRE, MAYOM IS ABOVE MLLW; THEREFORE THE CORRECTION SHOULD BE ADDED TO NAVD 83 TO CONVERT TO MLLW. NO TIDE GAUGES WERE USED ON THIS PROJECT. THE AVERAGE RANGE OF TIDE IS 8.3 FEET.
  - COORDINATES SHOWN ARE BASED ON THE TRANSVERSE MERCATOR GRID SYSTEM FOR THE STATE OF NEW HAMPSHIRE (ZONE 2800), NAD 1983 AND ARE BASED ON U.S. SURVEY FEET.
  - SURVEY WAS PERFORMED USING:  
AN ODOM MK 3 ECHO SOUNDER OPERATING AT 300 KHZ.  
A F2 SONIC 2024 MULTIBeam SONAR SYSTEM OPERATING AT 300 KHZ.  
HORIZONTAL POSITIONING AND REAL TIME TIDE READINGS WERE RECORDED UTILIZING A TRIMBLE GPS 868 RTK GPS SYSTEM.  
THE RTK BASE STATION/USED WERE STATIONS MTS SALESBURY AND TBM BEACH (2814).
  - THE SOUNDING INFORMATION SHOWN ON THESE MAPS REPRESENTS THE SHALLOWEST SOUNDINGS OF THOSE OBTAINED FROM HYDROGRAPHIC SURVEYS CONDUCTED DURING MARCH AND SEPTEMBER 2018. THE DATA DEPICTED ON THESE MAPS SHOULD NOT BE USED FOR VOLUME CALCULATION PURPOSES.
  - THE INFORMATION DEPICTED ON THESE MAPS REPRESENTS THE RESULTS OF SURVEYS MADE ON THE DATES INDICATED, AND CAN ONLY BE CONSIDERED AS INDICATING THE CONDITIONS EXISTING AT THAT TIME.
- FIELD BOOK: RSH 4582 AND RSH 3535  
 6-FOOT DEPTH CONTOUR SHOWN THUS: [Symbol]  
 4-FOOT DEPTH CONTOUR SHOWN THUS: [Symbol]  
 2-FOOT DEPTH CONTOUR SHOWN THUS: [Symbol]  
 SURVEYED BY: MARCH 2018 BY FREDERICK W PERRY AND CREW  
 OCTOBER 2018 BY MICHAEL J VADNAB AND CREW
- REFER TO SURVEY NO. HAM\_2018\_004 AND HAM\_SP\_2018\_072

US Army Corps of Engineers

DATE: \_\_\_\_\_

PROJECT: \_\_\_\_\_

SCALE: \_\_\_\_\_

PROJECT NO.: \_\_\_\_\_

CONTRACT NO.: \_\_\_\_\_

DATE OF SURVEY: \_\_\_\_\_

DATE OF PLOT: \_\_\_\_\_

U.S. ARMY CORPS OF ENGINEERS  
 NEW HAMPSHIRE DISTRICT OFFICE  
 CONCORD, NH 03301-2711

HAMPTON HARBOR  
 6-FOOT CHANNEL AND ANCHORAGE

SHEET ID  
**G-101**

PRELIMINARY

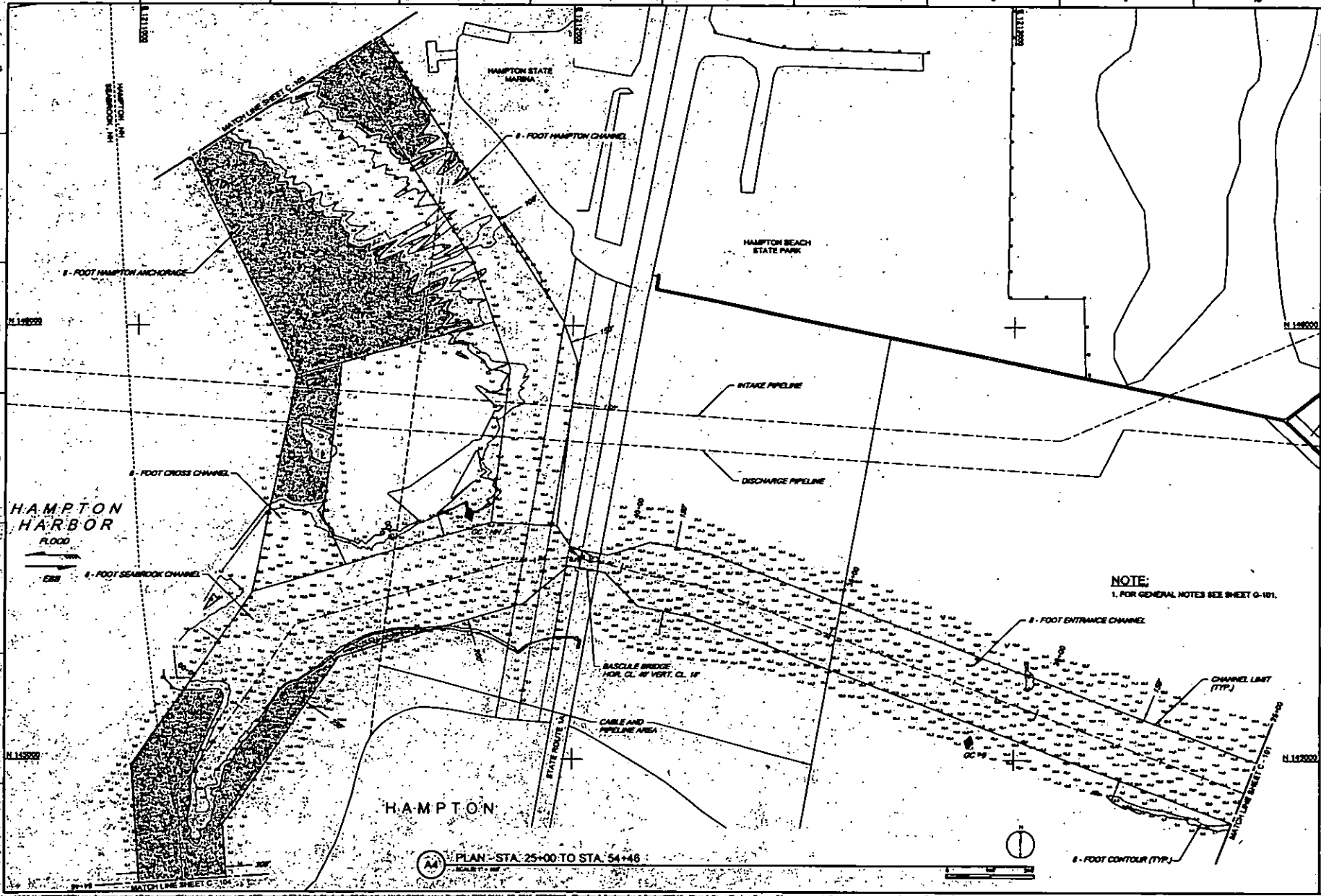

PLAN - STA. 25+00 TO STA. 54+46

**NOTE:**  
 1. FOR GENERAL NOTES SEE SHEET C-101.

US Army Corps of Engineers

DESIGNED BY:	ENGINEERED BY:	CONTRACT NO.:	PROJECT NO.:
DRAWN BY:	CHECKED BY:	DATE:	SCALE:
U.S. ARMY CORPS OF ENGINEERS WATERWAYS DIVISION CORPUS, TEXAS (1114-01)		SHEET NO. <b>C-102</b>	

8-FOOT CHANNEL AND ANCHORAGE

SHEET ID  
**C-102**

PRELIMINARY

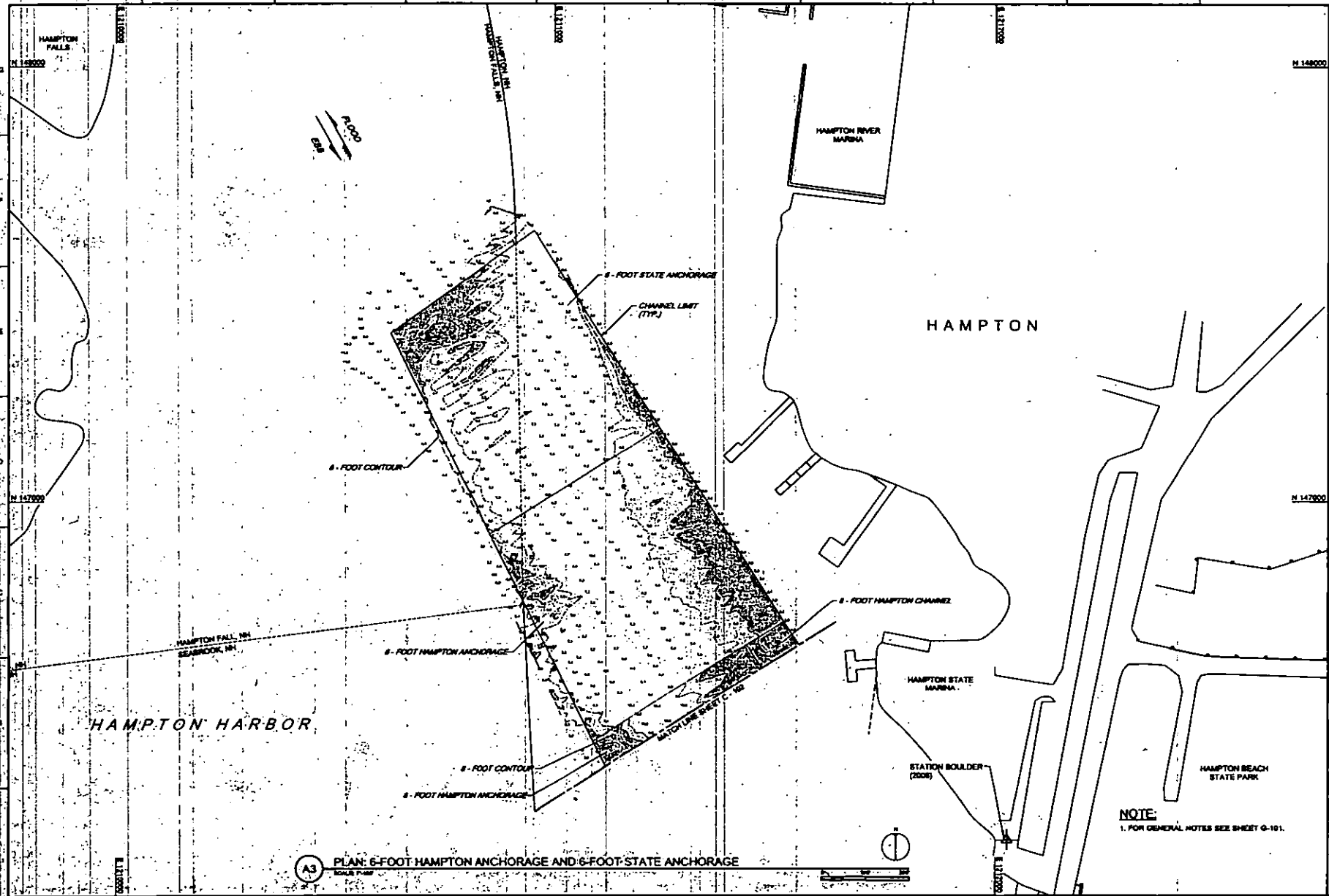

**A3 PLAN: 6-FOOT HAMPTON ANCHORAGE AND 6-FOOT STATE ANCHORAGE**

**NOTE:**  
1. FOR GENERAL NOTES SEE SHEET G-101.



US Army Corps of Engineers	
PROJECT NO.	DATE
DESIGN NO.	SCALE
CONTRACT NO.	PROJECT CODE
PROJECT NAME	PROJECT LOCATION
PROJECT NUMBER	PROJECT STATUS
PROJECT DESCRIPTION	PROJECT PHASE
PROJECT LOCATION	PROJECT STATUS
PROJECT NUMBER	PROJECT STATUS
PROJECT DESCRIPTION	PROJECT PHASE
PROJECT LOCATION	PROJECT STATUS
PROJECT NUMBER	PROJECT STATUS
PROJECT DESCRIPTION	PROJECT PHASE
PROJECT LOCATION	PROJECT STATUS

DESIGNED BY:	CHECKED BY:	DATE:
DRAWN BY:	APPROVED BY:	SCALE:
PROJECT NO.:	PROJECT CODE:	PROJECT STATUS:
PROJECT NAME:	PROJECT LOCATION:	PROJECT PHASE:
PROJECT NUMBER:	PROJECT DESCRIPTION:	PROJECT PHASE:
PROJECT LOCATION:	PROJECT STATUS:	PROJECT PHASE:
PROJECT NUMBER:	PROJECT STATUS:	PROJECT PHASE:
PROJECT DESCRIPTION:	PROJECT PHASE:	PROJECT PHASE:
PROJECT LOCATION:	PROJECT STATUS:	PROJECT PHASE:
PROJECT NUMBER:	PROJECT STATUS:	PROJECT PHASE:
PROJECT DESCRIPTION:	PROJECT PHASE:	PROJECT PHASE:
PROJECT LOCATION:	PROJECT STATUS:	PROJECT PHASE:

U.S. Army Corps of Engineers  
 1111 Water Street  
 Concord, MA 01732-1111

PROJECT NO. 11111111  
 PROJECT CODE 11111111  
 PROJECT STATUS 11111111  
 PROJECT NAME 11111111  
 PROJECT LOCATION 11111111  
 PROJECT PHASE 11111111

6-FOOT CHANNEL AND ANCHORAGE

SHEET ID  
**C-103**

PRELIMINARY

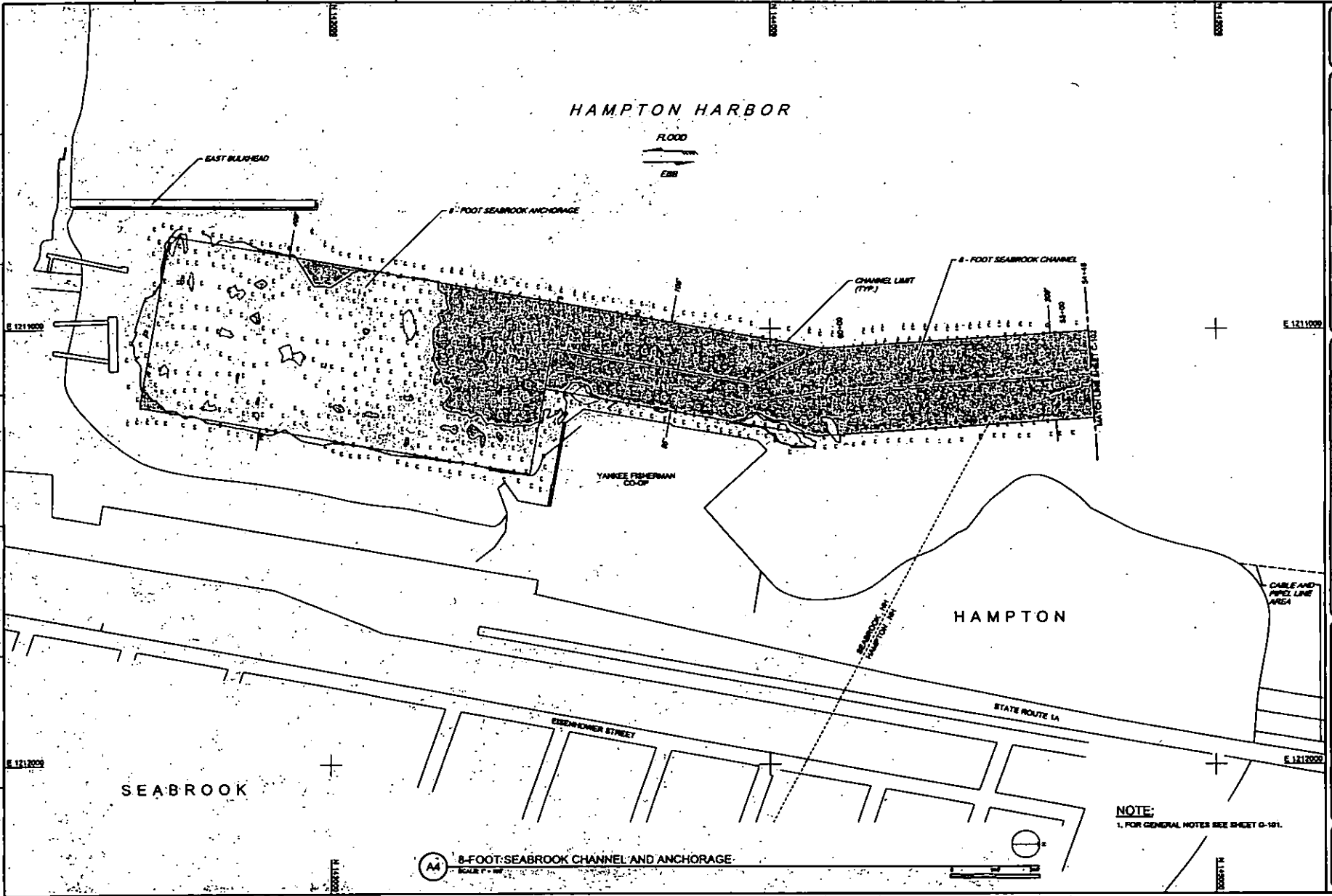

US Army Corps of Engineers

NO.	DATE	BY	CHKD.

DESIGNED BY	SCALE
DRAWN BY	DATE
CHECKED BY	PROJECT NO.
APPROVED BY	DATE

U.S. ARMY CORPS OF ENGINEERS  
 DISTRICT OFFICE  
 1000 EAST 12TH STREET  
 CORPUS CHRISTI, TEXAS 78401-2701

PROJECT NO. 62-1-100  
 SHEET NO. C-104

SHEET ID  
**C-104**

PRELIMINARY

Small text at the bottom left corner, likely a project or drawing number.

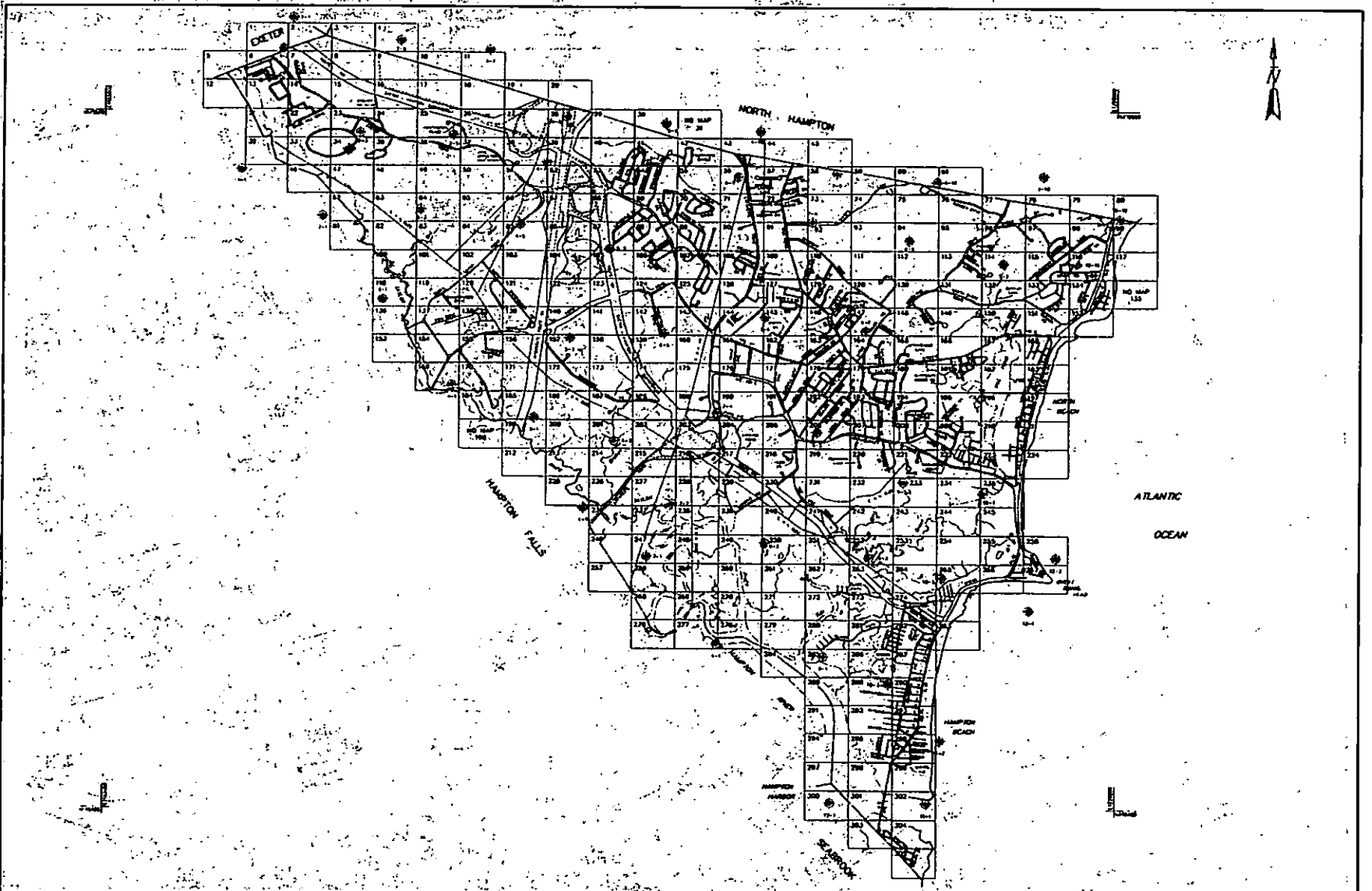

THIS MAP IS FOR INFORMATION PURPOSES ONLY. IT IS NOT TO BE USED FOR CONVEYANCE OF REAL ESTATE. NO WARRANTY, EXPRESS OR IMPLIED, IS MADE BY THE MAPPER. THE USER ASSUMES ALL LIABILITY FOR ANY AND ALL DAMAGES, INCLUDING REASONABLE ATTORNEY'S FEES, ARISING FROM THE USE OF THIS MAP.

DIGITIZED IN 1996 BY  
**CARTOGRAPHIC ASSOC., INC.**  
 PROFESSIONAL CONSULTANTS  
 100 PLEASANT STREET, LITTLETON, NEW HAMPSHIRE 03044  
 (603) 431-6700 • (603) 431-6800 • FAX (603) 431-1300

**LEGEND**  
 THE MAP BOUNDARIES AND SHEET LIMITS  
 APPROXIMATE COVERS OF  
 100' PHOTO ENLARGEMENT 1:25,000  
 PHOTOGRAPHY BASED 1/7/78

N. STATE PLANE COORDINATE SYSTEM AND 1983  
 SCALE: 1" = 1500'  
 FEET  
 METERS  
 REVISED 10/

PROPERTY MAPS  
**HAMPTON**  
 NEW HAMPSHIRE

**INDEX**

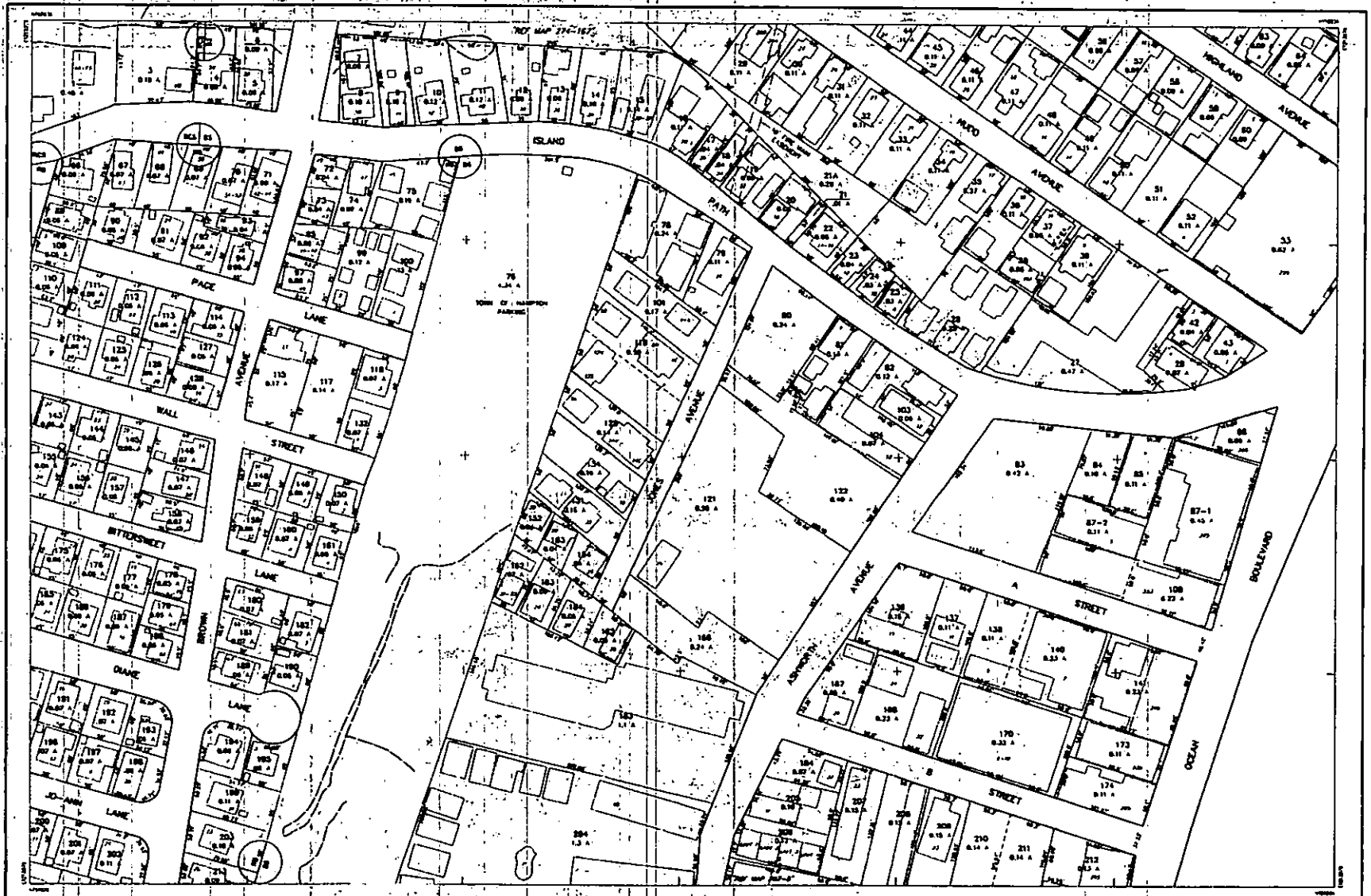

<p>THIS MAP IS FOR INFORMATION PURPOSES ONLY. IT IS NOT TO BE USED FOR CONVEYANCE OF INTERESTS IN REAL ESTATE. THE USER OF THIS MAP SHALL BE RESPONSIBLE FOR OBTAINING ALL NECESSARY RECORDS AND SURVEYS TO VERIFY THE ACCURACY OF THE INFORMATION SHOWN HEREON. THE USER OF THIS MAP SHALL BE RESPONSIBLE FOR OBTAINING ALL NECESSARY RECORDS AND SURVEYS TO VERIFY THE ACCURACY OF THE INFORMATION SHOWN HEREON.</p>	<p>DIGITIZED IN 1994 BY  <b>CARTOGRAPHIC ASSOC. INC.</b>      PROFESSIONAL CONSULTANTS      1000 PLEASANT STREET, SUITE 200, WEST HAMPSHIRE COLLEGE      HAMPSHIRE, NEW HAMPSHIRE 03824-1000      TEL: 603-883-1100 FAX: 603-883-1101</p>	<p>LEGEND</p> <ul style="list-style-type: none"> <li>Lot boundaries</li> <li>Street boundaries</li> <li>Water bodies</li> <li>Other features</li> </ul>	<p>SCALE: 1" = 50'</p> <p>FEET</p> <p>METERS</p> <p>NEWMARK TO:</p>	<p>PROPERTY MAPS  <b>HAMPTON</b>      NEW HAMPSHIRE</p>	<p>INDEX DIAGRAM</p> <p>MAP NO. <b>282</b></p>
--	---	---	---	---	--



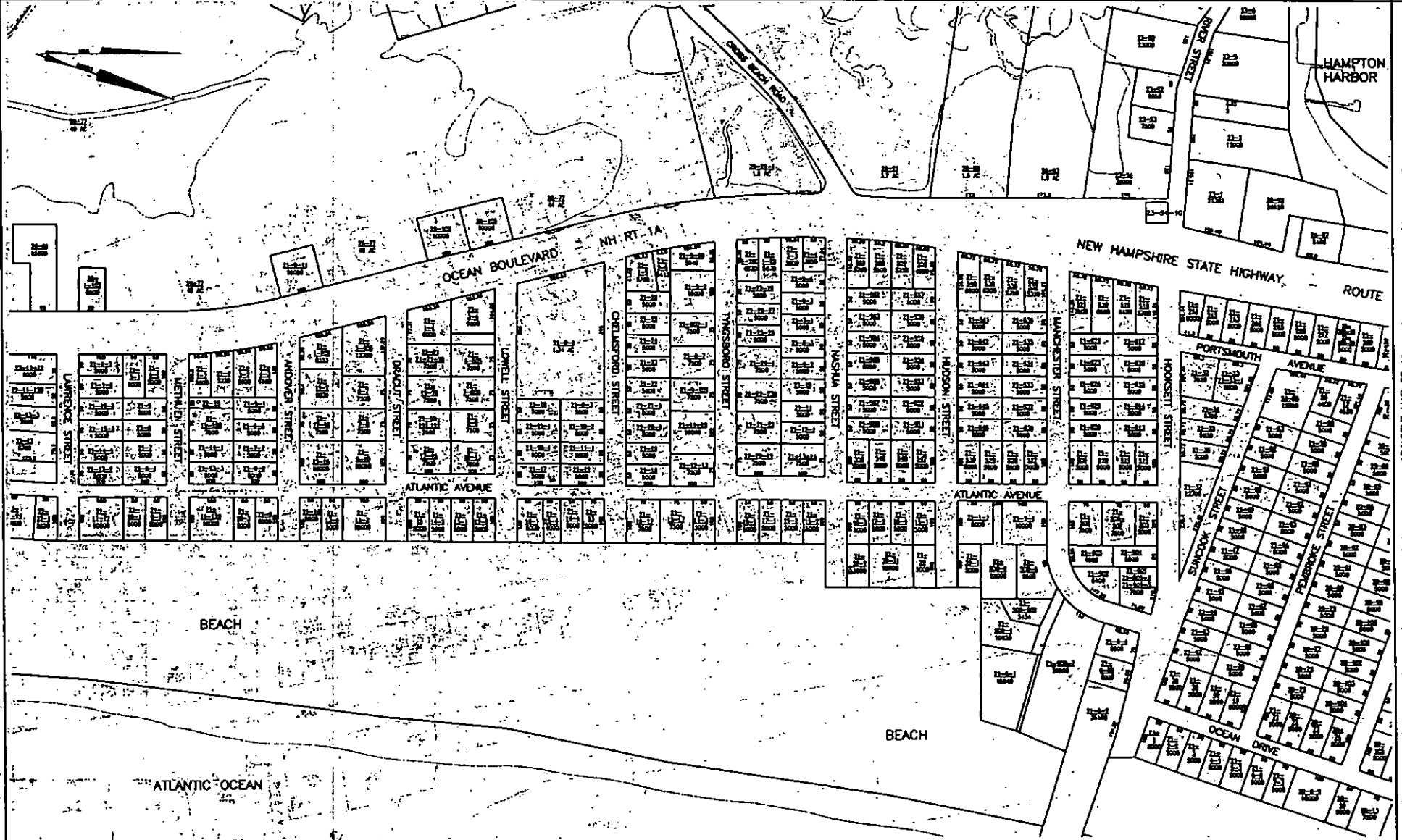

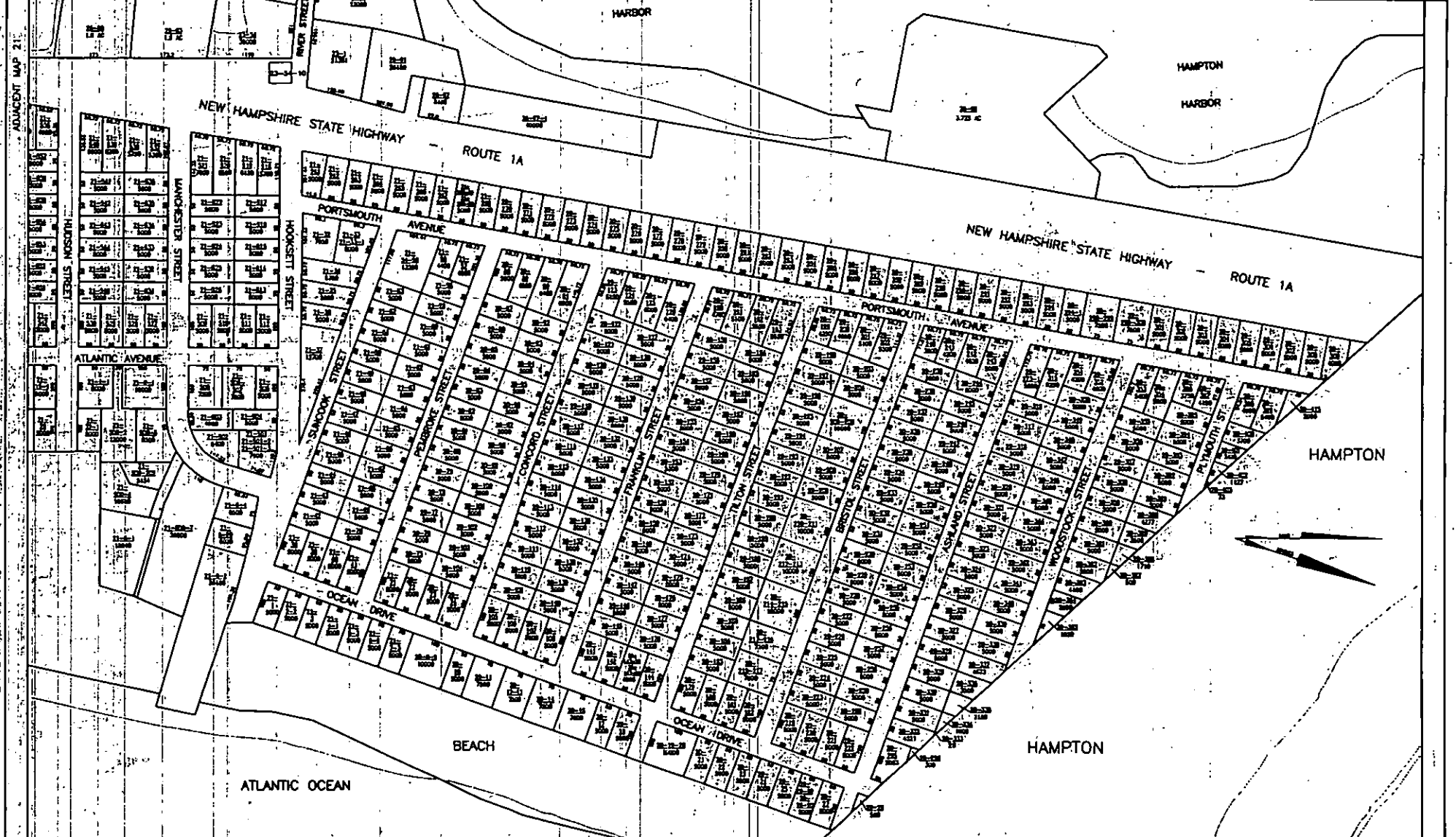

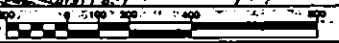
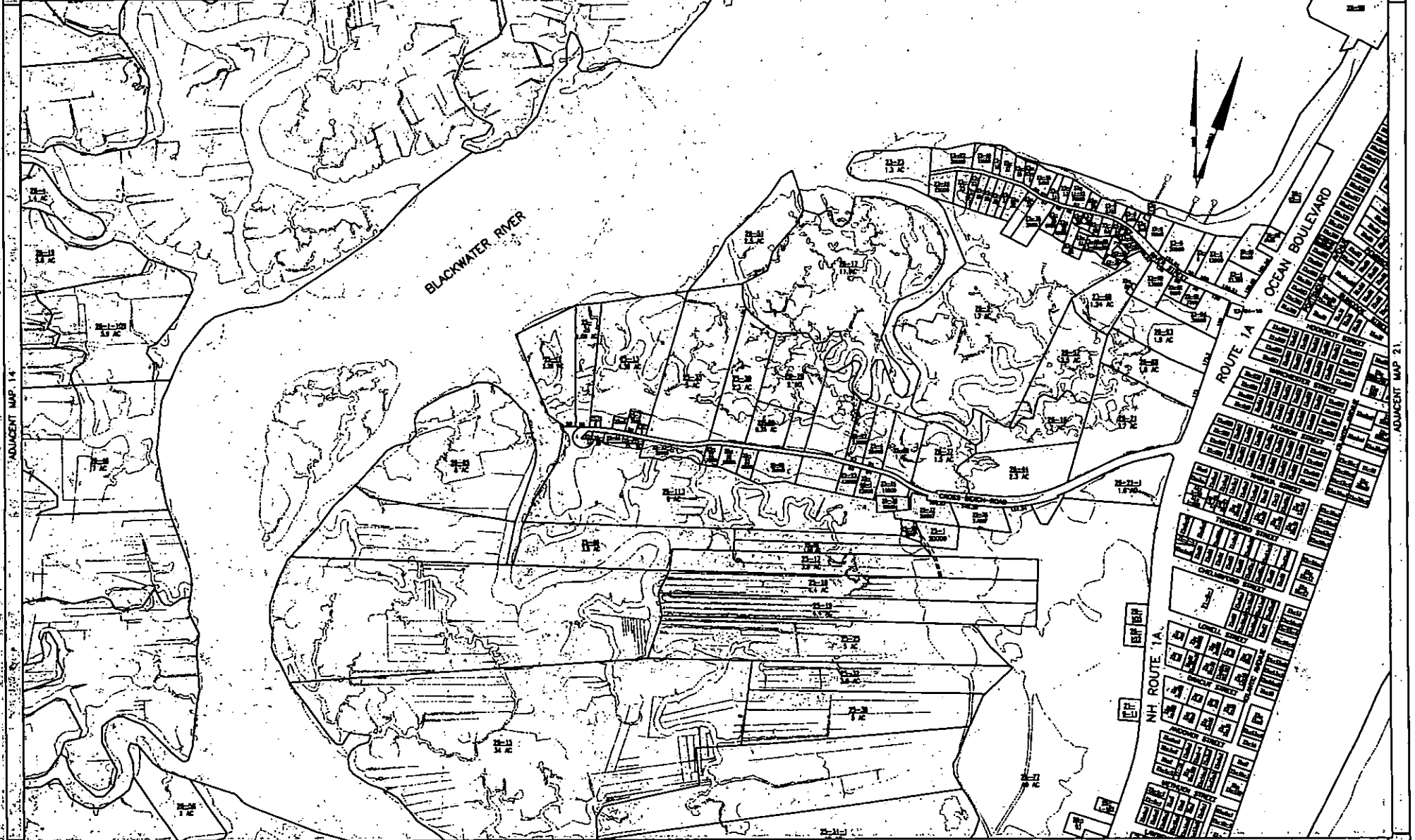

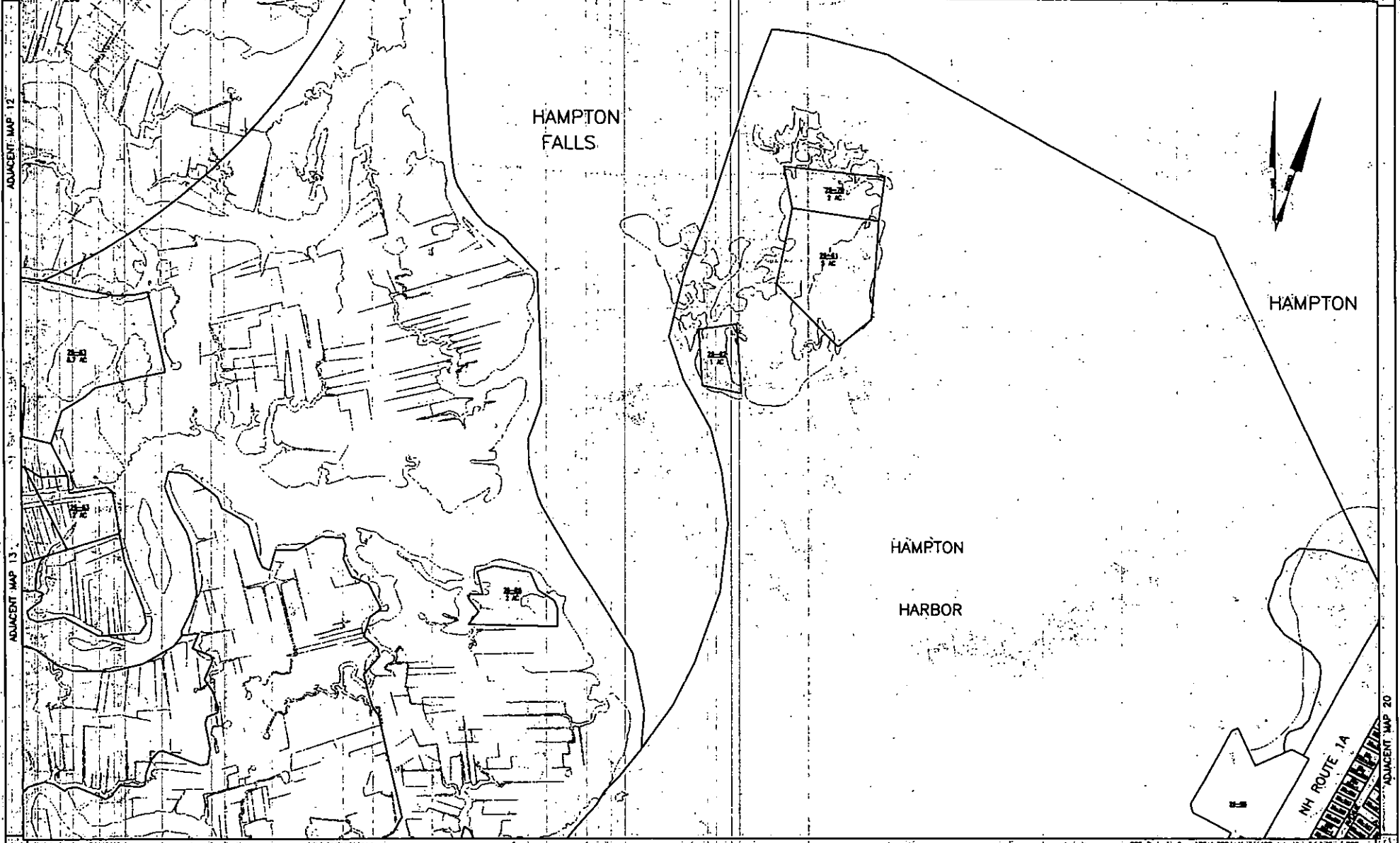



ADJACENT MAP 12

ADJACENT MAP 13

ADJACENT MAP 20

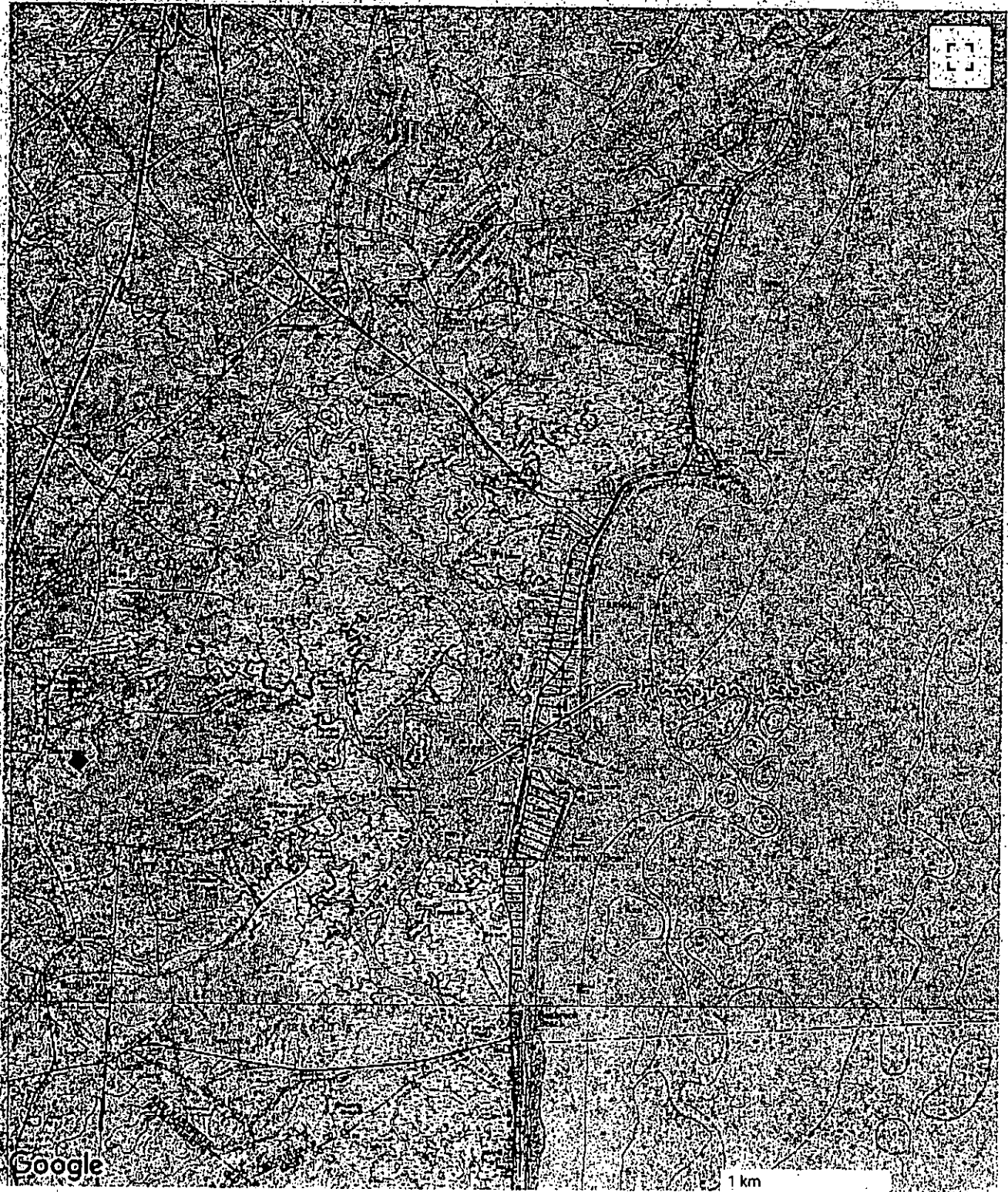
# North Hampton Topo Map in Rockingham County New Hampshire



 [Print this map](#)

Map provided by [TopoZone.com](http://TopoZone.com)

**CONFIDENTIAL – NH Dept. of Environmental Services review**

**Memo**



NH NATURAL HERITAGE BUREAU  
NHB DATACHECK RESULTS LETTER

**To:** Tracy Shattuck, Rease Development - Division of Ports & Harbors  
555 Market St  
Portsmouth, NH 03801

**From:** Amy Lamb, NH Natural Heritage Bureau

**Date:** 11/13/2018 (valid for one year from this date)

**Re:** Review by NH Natural Heritage Bureau

NHB File ID: NHB18-3393

Town: Hampton & Seabrook

Location: Hampton - Seabrook Harbor

Description: Maintenance dredge of existing Federal Navigation Project and existing State anchorage by means of hydraulic dredge. Dredge material is clean sand and will be placed for beneficial use.

cc: Kim Tuttle

As requested, I have searched our database for records of rare species and exemplary natural communities with the following results:

**Comments:** Please clarify whether there will be any dredging of areas which are exposed at low tide. One of the graphics provided to NHB seems to indicate that a portion of the dredge located just southwest of the Hampton-Seabrook Bridge will affect intertidal areas. Please also clarify whether any or the dredged sediments will be placed on top of existing vegetation, or if they will only be placed on open sand. Please contact the NH Fish & Game Department to address wildlife concerns as well.

Natural Community

State Federal Notes

Beach grass grassland

Dune communities are sensitive to trampling or recreational use that harms the vegetation since plants growing in the sand serve a critical function in anchoring it in place.

Hudsonia maritime shrubland

Threats are primarily development and recreational use that disturbs the dunes and/or vegetation.

Intertidal flat\*

Threats to these communities are primarily alterations to the hydrology of the wetland (such as ditching or tidal restrictions that might affect the sheet flow of tidal waters across the intertidal flat) and increased input of nutrients and pollutants in storm runoff.

Subtidal system

Threats to these communities are primarily alterations to the hydrology of the wetland (such as alterations that might affect the sheet flow of tidal waters across the intertidal flat) and increased input of nutrients and pollutants in storm runoff.

Plant species

State Federal Notes

field wormwood (*Artemisia campestris ssp.*)

E

This species grows in dry dune systems and is sensitive to disturbances that eliminate

Department of Natural and Cultural Resources  
Division of Forests and Lands  
(603) 271-2214 fax: 271-6488

DNCR/NHB  
172 Pembroke Rd.  
Concord, NH 03301



CONFIDENTIAL - NH Dept. of Environmental Services review

Memo



NH NATURAL HERITAGE BUREAU  
NHB DATACHECK RESULTS LETTER

<i>caudata</i>				
Gray's umbrella sedge ( <i>Cyperus grayi</i> )	E	-		its habitat or disturb the natural dynamics of the dune area.
hairy hudsonia ( <i>Hudsonia tomentosa</i> )	T	-		This species grows in sandplains and disturbed openings, and is sensitive to disturbances that eliminate its habitat.
long-spined sandbur ( <i>Cenchrus longispinus</i> )	E	-		This species requires periodic disturbance to its habitat (disturbed openings, river and streambanks). However, existing plants are very sensitive to trampling when growing on open sand.
sand dropseed ( <i>Sporobolus cryptandrus</i> )	E	-		This species grows in sandplain and disturbed openings, and is sensitive to disturbances that eliminate its habitat.
seaside sandmat ( <i>Euphorbia polygonifolia</i> )	E	-		This species grows in dry dune systems and is sensitive to disturbances that eliminate its habitat or disturb the natural dynamics of the dune area.
seaside threeawn ( <i>Aristida tuberculosa</i> )	E	-		This species grows on sandy coastal beaches and is sensitive to excessive disturbances such as trampling and ATV use as well as a significant reduction in disturbance (loss of dynamic dune movement) from habitat fragmentation.
	E	-		This species grows in dry dune systems and is sensitive to disturbances that eliminate its habitat or disturb the natural dynamics of the dune area.

Vertebrate species

	State	Federal	Notes
Least Tern ( <i>Sterna antillarum</i> )	E	-	Contact the NH Fish & Game Dept (see below).
Piping Plover ( <i>Charadrius melodus</i> )	E	T	Contact the NH Fish & Game Dept and the US Fish & Wildlife Service (see below).

Codes: "E" = Endangered, "T" = Threatened, "SC" = Special Concern, "-" = an exemplary natural community, or a rare species tracked by NH Natural Heritage that has not yet been added to the official state list. An asterisk (\*) indicates that the most recent report for that occurrence was more than 20 years ago.

Contact for all animal reviews: Kim Tuttle, NH F&G, (603) 271-6544

A negative result (no record in our database) does not mean that a sensitive species is not present. Our data can only tell you of known occurrences, based on information gathered by qualified biologists and reported to our office. However, many areas have never been surveyed, or have only been surveyed for certain species. An on-site survey would provide better information on what species and communities are indeed present.



CONFIDENTIAL - NH Dept. of Environmental Services review

NHB18-3393





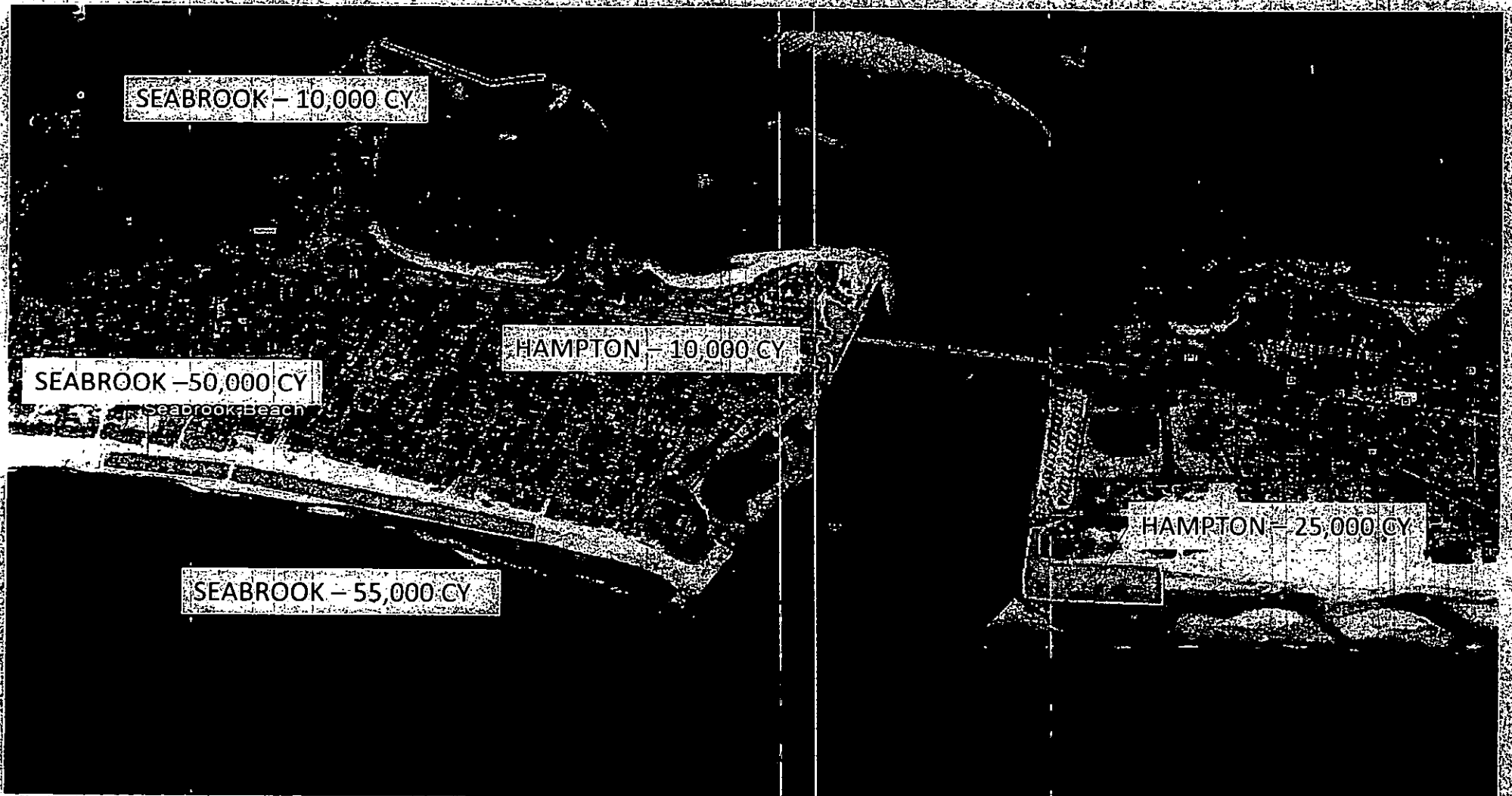

*Dredge Material Placement*

RECEIVED  
FEB 22 2019  
NHDES  
LAND RESOURCES MANAGEMENT



**RECEIVED**  
MAY 07 2018  
ENVIRONMENTAL SERVICES  
BY 810 CES WETLANDS BUREAU

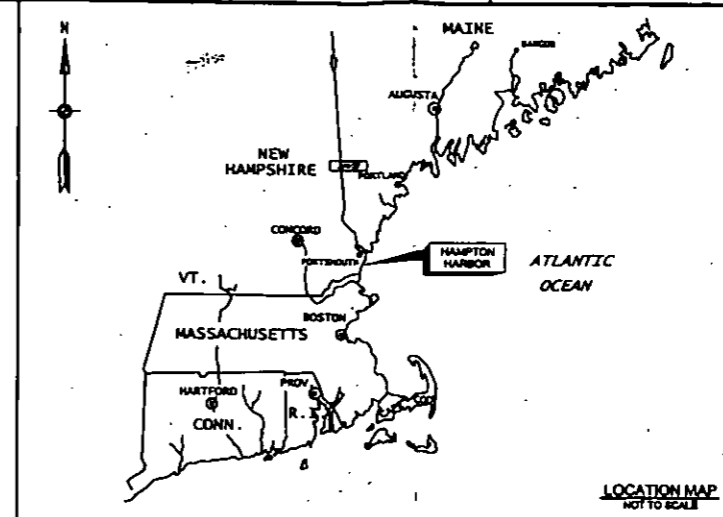

TOWN	MAP	PARCEL ID	PARCEL ADDRESS	PARCEL OWNER	TOTAL AREA OF PARCEL (ACRES)	AREA OF USAGE (ACRES)	TYPE OF USAGE
HAMPTON	298	22	OCEAN BOULEVARD	STATE OF NEW HAMPSHIRE	40	1.82	TEMPORARY ACCESS ROAD
						0.25	HYDRAULIC PIPELINE R.O.W.
						4.88	DREDGED MATERIAL PLACEMENT AREA
HAMPTON	304	25	OCEAN FRONT	TOWN OF HAMPTON	32.4	0.12	TEMPORARY ACCESS ROAD
						1.81	HYDRAULIC PIPELINE R.O.W.
						1.88	DREDGED MATERIAL PLACEMENT AREA
SEABROOK	20	20-21-22	OCEAN FRONT	TOWN OF SEABROOK	6.15	0.10	TEMPORARY ACCESS ROAD
						0.11	HYDRAULIC PIPELINE R.O.W.
						4.87	DREDGED MATERIAL PLACEMENT AREA
SEABROOK	21	21-22-24	DUNES NORTH OF PIER	STATE OF NEW HAMPSHIRE	8.38	0.0	TEMPORARY ACCESS ROAD
						0.38	DREDGED MATERIAL PLACEMENT AREA
SEABROOK	21	21-600-4	4 MANCHESTER STREET	MARGARET ZAPPALA	0.38	0.01	DREDGED MATERIAL PLACEMENT AREA
SEABROOK	21	21-4-1	8 MANCHESTER STREET	DEAN KORAYOS	0.88	0.05	DREDGED MATERIAL PLACEMENT AREA
SEABROOK	21	21-600-7	7 MANCHESTER STREET	KEVIN PICUCCI	1.40	0.33	DREDGED MATERIAL PLACEMENT AREA
SEABROOK	21	21-4-2	520 HOOKSETT STREET	520 HOOKSETT ST REALTY	0.74	0.27	DREDGED MATERIAL PLACEMENT AREA
SEABROOK	21	21-22-23	OCEAN FRONT	TOWN OF SEABROOK	15.00	1.28	DREDGED MATERIAL PLACEMENT AREA
SEABROOK	28	28-88-10	723 OCEAN BOULEVARD	TOWN OF SEABROOK	6.10	2.78	TEMPORARY ACCESS ROAD
SEABROOK	28	28-88	743 OCEAN BOULEVARD	TOWN OF SEABROOK	3.78	0.29	STAGING AND STORAGE AREA

LEGEND	
[Symbol]	STATE OF NEW HAMPSHIRE OWNED PROPERTY
[Symbol]	TOWN OWNED PROPERTY (HAMPTON)
[Symbol]	TOWN OWNED PROPERTY (SEABROOK)
[Symbol]	RESIDENTIAL OWNED PROPERTY (SEABROOK)
[Symbol]	NEW HAMPSHIRE FISH AND GAME PROPERTY
[Symbol]	PEASE DEVELOPMENT AUTHORITY PROPERTY
[Symbol]	PAVED ROADWAY OR PARKING AREA
[Symbol]	TEMPORARY ACCESS ROAD OR AREA
[Symbol]	57' RIGHT-OF-WAY FOR HYDRAULIC PIPELINE (HPL)
[Symbol]	DREDGED MATERIAL PLACEMENT AREA
[Symbol]	CONTRACTOR'S STAGING AND STORAGE AREA
[Symbol]	DUNE AND DUNE BOUNDARY
[Symbol]	TOWN BOUNDARY
[Symbol]	PARCEL BOUNDARY LINES
[Symbol]	TOWN RIGHT-OF-WAY LINE
[Symbol]	HYDRAULIC PIPELINE
[Symbol]	QUADRANT
[Symbol]	CHAIN LINK FENCING
[Symbol]	MIDDLE GROUND SAND FLAT
[Symbol]	ROUTE 1A DRAWBRIDGE
[Symbol]	MAP AND PARCEL NUMBER (HAMPTON)
[Symbol]	MAP AND PARCEL NUMBER (SEABROOK)

- NOTE:**
- THE CONTRACTOR WILL NOT BE ALLOWED TO TRAVEL ON OR ACROSS ANY DUNES.
  - THE LANDWARD SIDE EDGE OF THE TEMPORARY ACCESS ROAD RUNNING PARALLEL TO THE DUNES ALONG SEABROOK BEACH SHALL BE AT LEAST 15 FEET FROM THE DUNE'S TOE.
  - DIMENSION TAKEN FROM EXISTING CHAIN LINK FENCE.

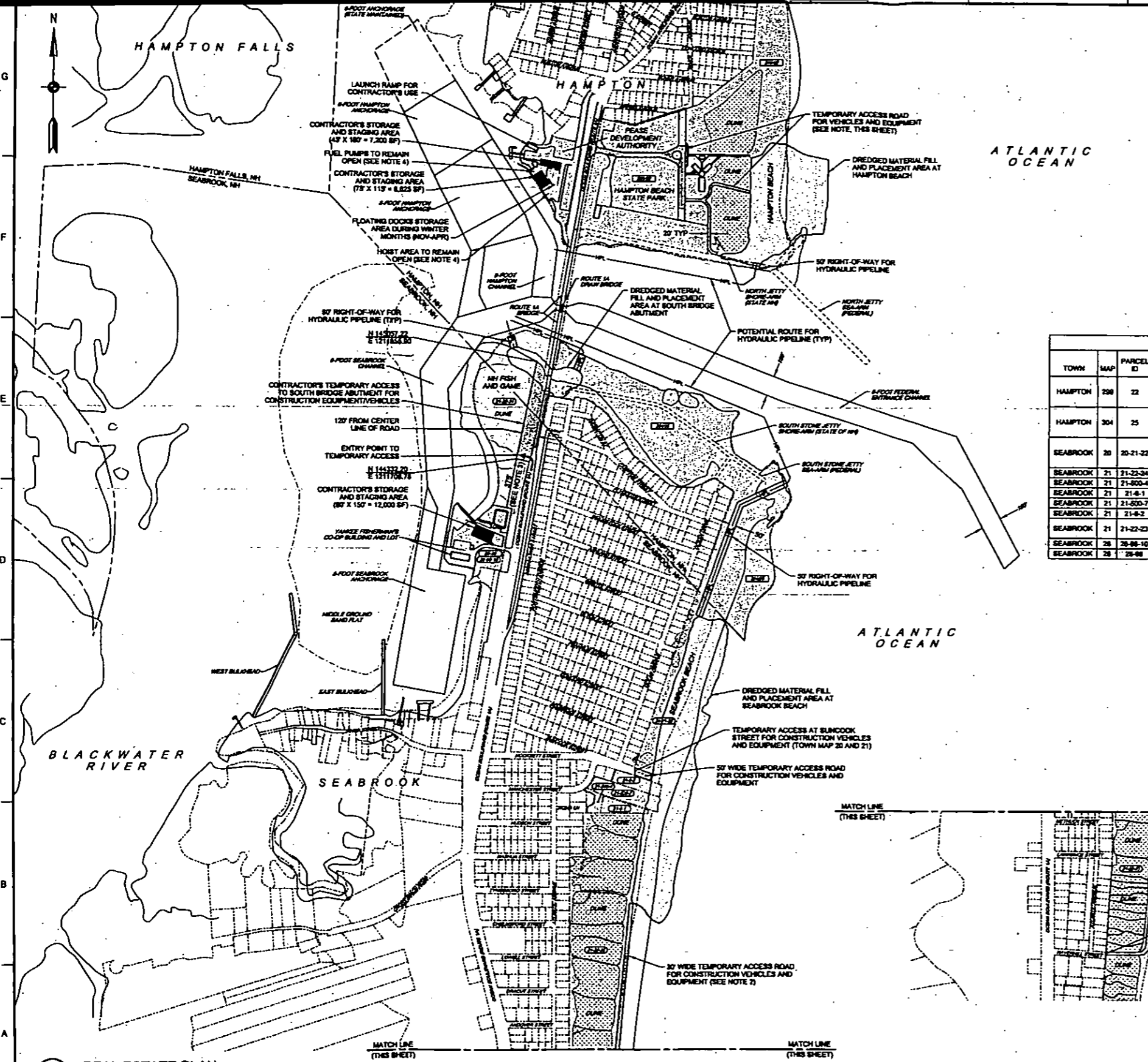

**A1 REAL ESTATE PLAN**  
SCALE: 1" = 400'

SHEET ID  
**RE100**