



The State of New Hampshire
Department of Environmental Services

Robert R. Scott, Commissioner

APR11'22 PM 2:18 RCVD



Sam
887A

April 11, 2022

His Excellency, Governor Christopher T. Sununu
and The Honorable Council
State House
Concord, NH 03301

REQUESTED ACTION

Approve Paula J. Panasis Revocable Trust's request to amend New Hampshire Department of Environmental Services (NHDES) permit file #2020-03253 to perform the following work on the Piscataqua River in Dover in accordance with RSA 482-A:3. This project was previously approved by the Governor and Executive Council on September 15, 2021, Item #66.

Impact 1,018 square feet of tidal wetland to modify an existing tidal docking structure by constructing a 149 foot extension consisting of a 6 foot by 80 foot fixed pier including four batter piles, connected to a 3 foot by 45 foot seasonal ramp connected to a 6 foot by 16 foot seasonal landing float connected to an 8 foot by 38 foot main float. The overall length of the extended docking structure, seaward of the highest observable tide line, is 195 feet, providing two slips on 244 feet of frontage along the Piscataqua River.

The NHDES imposed the following conditions as part of this approval:

1. AMENDED: All work shall be done in accordance with the approved plans dated November 2020, revised through June 11, 2021, by Ambit Engineering Inc., and last received by the NH Department of Environmental Services (NHDES) on June 15, 2021, and plans dated December 20, 2021, revised through December 20, 2021 by Ambit Engineering Inc., and last received by the NHDES on December 22, 2021, in accordance with Env-Wt 307.16.
2. This permit shall not be effective until the permittee records this permit at the Strafford County Registry of Deeds. Any limitations or conditions in the permit so recorded shall run with the land beyond the expiration of the permit. The permittee shall provide the NHDES with a copy of the permit stamped by the registry with the book and page and date of receipt, in accordance with New Hampshire Administrative Rule Env-Wt 314.02(b) and (c).
3. In-water pile installation shall not occur between March 15 and November 15, in order to protect anadromous fish, in accordance with Env-Wt 307.10(i) and Env-Wt 311.06(g)
4. All work shall be done at low tide, in the dry, when the work area is fully exposed, in accordance with Env-Wt 609.10(b)(4).
5. Tidal docking installation shall be done by barge or upland to prevent the driving of construction equipment in or through tidal waters/wetlands or on the bottom of the inter-tidal zone, in accordance with Env-Wt 606.05(b).
6. Tidal docking construction shall be done in accordance with the standard conditions in Env-Wt 307.
7. Heavy equipment shall not be operated in any jurisdictional area unless specifically authorized by this permit, in accordance with Env-Wt 307.15(a).

www.des.nh.gov

29 Hazen Drive • PO Box 95 • Concord, NH 03302-0095
NHDES Main Line: (603) 271-3503 • Subsurface Fax: (603) 271-6683 • Wetlands Fax: (603) 271-6588
TDD Access: Relay NH 1 (800) 735-2964

8. The ramp and float portions of residential tidal docks shall be seasonal and removed from the water during the non-boating season, in accordance with Env-Wt 606.06(b).

EXPLANATION

The NHDES approved this project on March 04, 2022. The NHDES supported its decision with the following findings:

1. This is classified as a major project per Rule Env-Wt 606.17(a)(1), for all new overwater structure construction in tidal waters/wetlands.
2. Per Rule Env-Wt 306.05, the applicant has addressed all of the required planning items that are used to determine the appropriate impact classification of a project and the type of approval required.
3. Per Rule Env-Wt 313.01(a)(2), all applicable conditions specified in Env-Wt 307 have been met.
4. Per Rule Env-Wt 313.01(a)(3), all resource and project-specific criteria established in Env-Wt 600 have been met.
5. Per Rule Env-Wt 313.01(a)(5), and as required by RSA 482-A:11, II, this permit for work to dredge or fill will not 'infringe on the property rights or unreasonably affect the value or enjoyment of property of abutting owners'.
6. In correspondence dated February 16, 2021, the applicant obtained signed, notarized, authorization from the abutting owner for a portion of the structure to extend beyond the property boundary extended over water.
7. Per Rule Env-Wt 313.03(a) and (b), the applicant has demonstrated that potential impacts to jurisdictional areas have been avoided to the maximum extent practicable and that any unavoidable impacts have been minimized.
8. Per Rule Env-Wt 603.09, the applicant obtained a statement, dated February 16, 2021, from the Pease Development Authority, Division of Ports and Harbors regarding the projects impact on navigation and passage.
9. The residential tidal dock project meets the criteria listed in Rule Env-Wt 606.06(a) and (b).
10. Per Rule Env-Wt 202.01(b) and as required by RSA 482-A:8, the NHDES finds that the requirements for a public hearing do not apply as the project will not have a significant environmental impact, as defined in New Hampshire Administrative Rule Env-Wt 104.19, on the resources protected by RSA 482-A, or, is not of substantial public interest, as defined in New Hampshire Administrative Rule Env-Wt 104.32.
11. AMENDED: Per Rule Env-Wt 314.07(a) and subject to Env-Wt 314.07(b), the permittee has requested an amendment on December 22, 2021 to the issued permit. The amended plan includes adding four batter piles to the fixed pier to minimize damage to the dock from ice floes.
12. AMENDED: In accordance with RSA-482-A:3, XIV.(e), the request does not constitute a "significant amendment".

Application file documents are being forwarded to the Governor and the Executive Council in connection with their consideration of this matter pursuant to RSA 482-A:3, II(a), as it is a major project in public waters of the state.

We respectfully request your approval of this item.



Robert R. Scott, Commissioner



STANDARD DREDGE AND FILL WETLANDS PERMIT APPLICATION

Water Division/Land Resources Management
Wetlands Bureau



Check the Status of your Application

RSA/Rule: RSA 482-A/Env-Wt 100-900

APPLICANT'S NAME: Paula J. Panasis Rev. Trust

TOWN NAME: Dover

RECEIVED Administrative Use Only DEC 28 2020 NHDES LAND RESOURCES MANAGEMENT	COMPLETE Administrative Use Only DEC 29 2020	Administrative Use Only	File No.: 2020-03253
			Check No.: 3659
			Amount: \$3,390.00
			Initials: LSL

A person may request a waiver to the requirements in Rules Env-Wt 100-900 to accommodate situations where strict adherence to the requirements would not be in the best interest of the public or the environment. A person may also request a waiver of the standards for existing dwellings over water pursuant to RSA 482-A:26, III (b). For more information, please consult the request form.

SECTION 1 - REQUIRED PLANNING FOR ALL PROJECTS (Env-Wt 306.05; RSA 482-A:3, I(d)(2))

Please use the Wetland Permit Planning Tool (WPPT), the Natural Heritage Bureau (NHB) DataCheck Tool, the Aquatic Restoration Mapper, or other sources to assist in identifying key features such as: priority resource areas (PRAs), protected species or habitats, coastal areas, designated rivers, or designated prime wetlands.

Has the required planning been completed?	<input checked="" type="checkbox"/> Yes <input type="checkbox"/> No
Does the property contain a PRA? If yes, provide the following information:	<input checked="" type="checkbox"/> Yes <input type="checkbox"/> No
<ul style="list-style-type: none"> Does the project qualify for an Impact Classification Adjustment (e.g. NH Fish and Game Department (NHF&G) and NHB agreement for a classification downgrade) or a Project-Type Exception (e.g. Maintenance or Statutory Permit-by-Notification (SPN) project)? See Env-Wt 407.02 and Env-Wt 407.04). 	<input type="checkbox"/> Yes <input checked="" type="checkbox"/> No
<ul style="list-style-type: none"> Protected species or habitat? <ul style="list-style-type: none"> If yes, species or habitat name(s): Atlantic sturgeon & shortnose sturgeon NHB Project ID #: 20-2566 	<input checked="" type="checkbox"/> Yes <input type="checkbox"/> No
<ul style="list-style-type: none"> Bog? 	<input type="checkbox"/> Yes <input checked="" type="checkbox"/> No
<ul style="list-style-type: none"> Floodplain wetland contiguous to a tier 3 or higher watercourse? 	<input checked="" type="checkbox"/> Yes <input type="checkbox"/> No
<ul style="list-style-type: none"> Designated prime wetland or duly-established 100-foot buffer? 	<input type="checkbox"/> Yes <input checked="" type="checkbox"/> No
<ul style="list-style-type: none"> Sand dune, tidal wetland, tidal water, or undeveloped tidal buffer zone? 	<input checked="" type="checkbox"/> Yes <input type="checkbox"/> No
Is the property within a Designated River corridor? If yes, provide the following information:	<input type="checkbox"/> Yes <input checked="" type="checkbox"/> No
<ul style="list-style-type: none"> Name of Local River Management Advisory Committee (LAC): N/A A copy of the application was sent to the LAC on Month: Day: Year: 	

lrn@des.nh.gov or (603) 271-2147

NHDES Wetlands Bureau, 29 Hazen Drive, PO Box 95, Concord, NH 03302-0095

www.des.nh.gov

For dredging projects, is the subject property contaminated? • If yes, list contaminant: N/A	<input type="checkbox"/> Yes <input checked="" type="checkbox"/> No
Is there potential to impact impaired waters, class A waters, or outstanding resource waters?	<input type="checkbox"/> Yes <input checked="" type="checkbox"/> No
For stream crossing projects, provide watershed size (see Wetland Permit Planning Tool or Stream Stats): N/A	
SECTION 2 - PROJECT DESCRIPTION (Env-Wt 311.04(i)) Provide a brief description of the project and the purpose of the project, outlining the scope of work to be performed and whether impacts are temporary or permanent. DO NOT reply "See attached"; please use the space provided below. The project proposes 1,015 sq. ft. of permanent impact to tidal wetland, for the modification of an existing tidal docking structure by constructing a 6' x 80' fixed pier extension onto the end of the existing pier, installing a 3' x 45' gangway, and installing a new 6' x 16' landing float and an 8' x 38' main float, (overall structure length 160') maintaining three slips on 244+/- feet of frontage along the Piscataqua River.	
SECTION 3 - PROJECT LOCATION Separate wetland permit applications must be submitted for each municipality within which wetland impacts occur.	
ADDRESS: 280A Dover Point Road	
TOWN/CITY: Dover	
TAX MAP/BLOCK/LOT/UNIT: Map L, Lot 105-F	
US GEOLOGICAL SURVEY (USGS) TOPO MAP WATERBODY NAME: Cochecho River <input type="checkbox"/> N/A	
(Optional) LATITUDE/LONGITUDE in decimal degrees (to five decimal places): 1,206,682.5135° North 233,855.7652° West	

SECTION 4 - APPLICANT (DESIRED PERMIT HOLDER) INFORMATION (Env-Wt 311.04(a))

If the applicant is a trust or a company, then complete with the trust or company information.

NAME: Charles N. & Paula J. Panasis Paula J. Panasis Revocable Trust

MAILING ADDRESS:

TOWN/CITY:

STATE:

ZIP CODE

EMAIL ADDRESS:

FAX:

PHONE:

ELECTRONIC COMMUNICATION: By initialing here: , I hereby authorize NHDES to communicate all matters relative to this application electronically.

SECTION 5 - AUTHORIZED AGENT INFORMATION (Env-Wt 311.04(c))☒ N/A

LAST NAME, FIRST NAME, M.I.: Riker, Steven, D.

COMPANY NAME: Ambit Engineering, Inc.

MAILING ADDRESS: 200 Griffin Road, Unit 3

TOWN/CITY: Portsmouth

STATE: NH

ZIP CODE: 03820

EMAIL ADDRESS: sdr@ambitengineering.com

FAX:

PHONE: 603-430-9282

ELECTRONIC COMMUNICATION: By initialing here: *SR*, I hereby authorize NHDES to communicate all matters relative to this application electronically.**SECTION 6 - PROPERTY OWNER INFORMATION (IF DIFFERENT THAN APPLICANT) (Env-Wt 311.04(b))**

If the owner is a trust or a company, then complete with the trust or company information.

☒ Same as applicant

NAME:

MAILING ADDRESS:

TOWN/CITY:

STATE:

ZIP CODE:

EMAIL ADDRESS:

FAX:

PHONE:

ELECTRONIC COMMUNICATION: By initialing here: , I hereby authorize NHDES to communicate all matters relative to this application electronically.

SECTION 7 - RESOURCE-SPECIFIC CRITERIA ESTABLISHED IN Env-Wt 400, Env-Wt 500, Env-Wt 600, Env-Wt 700, OR Env-Wt 900 HAVE BEEN MET (Env-Wt 313.01(a)(3))

Describe how the resource-specific criteria have been met for each chapter listed above (please attach information about stream crossings, coastal resources, prime wetlands, or non-tidal wetlands and surface waters):
Please see attached narrative.

SECTION 8 - AVOIDANCE AND MINIMIZATION

Impacts within wetland jurisdiction must be avoided to the maximum extent practicable (Env-Wt 313.03(a))* . Any project with unavoidable jurisdictional impacts must then be minimized as described in the Wetlands Best Management Practice Techniques For Avoidance and Minimization and the Wetlands Permitting: Avoidance, Minimization and Mitigation Fact Sheet. For minor or major projects, a functional assessment of all wetlands on the project site is required (Env-Wt 311.03(b)(10))* .

Please refer to the application checklist to ensure that you have attached all documents related to avoidance and minimization, as well as functional assessment (where applicable). You can use the Avoidance and Minimization Checklist, the Avoidance and Minimization Narrative, or your own avoidance and minimization narrative.

*See Env-Wt 311.03(b)(6) and Env-Wt 311.03(b)(10) for shoreline structure exemptions.

SECTION 9 - MITIGATION REQUIREMENT (Env-Wt 311.02)

If unavoidable jurisdictional impacts require mitigation, a mitigation pre-application meeting must occur at least 30 days but not more than 90 days prior to submitting this Standard Dredge and Fill Permit Application.

Mitigation Pre-Application Meeting Date: Month: Day: Year:

☒ N/A - Mitigation is not required

SECTION 10 - THE PROJECT MEETS COMPENSATORY MITIGATION REQUIREMENTS (Env-Wt 313.01(a)(1)c)

Confirm that you have submitted a compensatory mitigation proposal that meets the requirements of Env-Wt 800 for all permanent unavoidable impacts that will remain after avoidance and minimization techniques have been exercised to the maximum extent practicable: ☐ I confirm submittal.

☒ N/A – Compensatory mitigation is not required

SECTION 11 - IMPACT AREA (Env-Wt 311.04(g))

For each jurisdictional area that will be/has been impacted, provide square feet (SF) and, if applicable, linear feet (LF) of impact, and note whether the impact is after-the-fact (ATF; i.e., work was started or completed without a permit).

For intermittent and ephemeral streams, the linear footage of impact is measured along the thread of the channel. *Please note, installation of a stream crossing in an ephemeral stream may be undertaken without a permit per Rule Env-Wt 309.02(d), however other dredge or fill impacts should be included below.*

For perennial streams/ivers, the linear footage of impact is calculated by summing the lengths of disturbances to the channel and banks.

Permanent impacts are impacts that will remain after the project is complete (e.g., changes in grade or surface materials).

Temporary impacts are impacts not intended to remain (and will be restored to pre-construction conditions) after the project is completed.

JURISDICTIONAL AREA		PERMANENT			TEMPORARY		
		SF	LF	ATF	SF	LF	ATF
Wetlands	Forested Wetland			<input type="checkbox"/>			<input type="checkbox"/>
	Scrub-shrub Wetland			<input type="checkbox"/>			<input type="checkbox"/>
	Emergent Wetland			<input type="checkbox"/>			<input type="checkbox"/>
	Wet Meadow			<input type="checkbox"/>			<input type="checkbox"/>
	Vernal Pool			<input type="checkbox"/>			<input type="checkbox"/>
	Designated Prime Wetland			<input type="checkbox"/>			<input type="checkbox"/>
	Duly-established 100-foot Prime Wetland Buffer			<input type="checkbox"/>			<input type="checkbox"/>
Surface Water	Intermittent / Ephemeral Stream			<input type="checkbox"/>			<input type="checkbox"/>
	Perennial Stream or River			<input type="checkbox"/>			<input type="checkbox"/>
	Lake / Pond			<input type="checkbox"/>			<input type="checkbox"/>
	Docking - Lake / Pond			<input type="checkbox"/>			<input type="checkbox"/>
	Docking - River			<input type="checkbox"/>			<input type="checkbox"/>
Banks	Bank - Intermittent Stream			<input type="checkbox"/>			<input type="checkbox"/>
	Bank - Perennial Stream / River			<input type="checkbox"/>			<input type="checkbox"/>
	Bank / Shoreline - Lake / Pond			<input type="checkbox"/>			<input type="checkbox"/>
Tidal	Tidal Waters			<input type="checkbox"/>			<input type="checkbox"/>
	Tidal Marsh			<input type="checkbox"/>			<input type="checkbox"/>
	Sand Dune			<input type="checkbox"/>			<input type="checkbox"/>
	Undeveloped Tidal Buffer Zone (TBZ)			<input type="checkbox"/>			<input type="checkbox"/>
	Previously-developed TBZ			<input type="checkbox"/>			<input type="checkbox"/>
	Docking - Tidal Water	1,015		<input type="checkbox"/>			<input type="checkbox"/>
TOTAL		1,015					

SECTION 12 - APPLICATION FEE (RSA 482-A:3, I)

☐ **MINIMUM IMPACT FEE:** Flat fee of \$400.

☐ **NON-ENFORCEMENT RELATED, PUBLICLY-FUNDED AND SUPERVISED RESTORATION PROJECTS, REGARDLESS OF IMPACT CLASSIFICATION:** Flat fee of \$400 (refer to RSA 482-A:3, 1(c) for restrictions).

☒ **MINOR OR MAJOR IMPACT FEE:** Calculate using the table below:

Permanent and temporary (non-docking):	SF	×	\$0.40 =	\$	
Seasonal docking structure:	535 SF	×	\$2.00 =	\$	1,070
Permanent docking structure:	480 SF	×	\$4.00 =	\$	1,920
Projects proposing shoreline structures (including docks) add \$400 =					\$ 400
Total =					\$ 3,390
The application fee for minor or major impact is the above calculated total or \$400, whichever is greater =					\$ 3,390

lrn@des.nh.gov or (603) 271-2147

NHDES Wetlands Bureau, 29 Hazen Drive, PO Box 95, Concord, NH 03302-0095

www.des.nh.gov

SECTION 13 - PROJECT CLASSIFICATION (Env-Wt 306.05)

Indicate the project classification.

☐ Minimum Impact Project☐ Minor Project☒ Major Project**SECTION 14 - REQUIRED CERTIFICATIONS (Env-Wt 311.11)**

Initial each box below to certify:

Initials:

SR

To the best of the signer's knowledge and belief, all required notifications have been provided.

Initials:

SR

The information submitted on or with the application is true, complete, and not misleading to the best of the signer's knowledge and belief.

Initials:

SR

The signer understands that:

- The submission of false, incomplete, or misleading information constitutes grounds for NHDES to:
 1. Deny the application.
 2. Revoke any approval that is granted based on the information.
 3. If the signer is a certified wetland scientist, licensed surveyor, or professional engineer licensed to practice in New Hampshire, refer the matter to the joint board of licensure and certification established by RSA 310-A:1.
- The signer is subject to the penalties specified in New Hampshire law for falsification in official matters, currently RSA 641.
- The signature shall constitute authorization for the municipal conservation commission and the Department to inspect the site of the proposed project, except for minimum impact forestry SPN projects and minimum impact trail projects, where the signature shall authorize only the Department to inspect the site pursuant to RSA 482-A:6, II.

Initials:

SR

If the applicant is not the owner of the property, each property owner signature shall constitute certification by the signer that he or she is aware of the application being filed and does not object to the filing.

SECTION 15 - REQUIRED SIGNATURES (Env-Wt 311.04(d); Env-Wt 311.11)

SIGNATURE (OWNER):

PRINT NAME LEGIBLY:

DATE:

SIGNATURE (APPLICANT, IF DIFFERENT FROM OWNER):

PRINT NAME LEGIBLY:

DATE:

SIGNATURE (AGENT, IF APPLICABLE):

PRINT NAME LEGIBLY:

DATE:

Steven D. Riker

12/4/2020

SECTION 16 - TOWN / CITY CLERK SIGNATURE (Env-Wt 311.04(f))

As required by RSA 482-A:3, I(a),(1), I hereby certify that the applicant has filed four application forms, four detailed plans, and four USGS location maps with the town/city indicated below.

TOWN/CITY CLERK SIGNATURE:

PRINT NAME LEGIBLY:

TOWN/CITY:

DATE:

Dover

Susan Mistreha

12/7/2020

25 August, 2020

To Whom It May Concern

**RE: New Hampshire Department of Environmental Services Wetland Application
for residential site improvements for the Paula J. Panasis Revocable Trust, 280A
Dover Point Road, Dover NH.**

This letter is to inform the New Hampshire Department of Environmental Services in
accordance with State Law that Ambit Engineering, Inc. is authorized to obtain
approvals in regards to the above referenced property.

Please feel free to call me if there is any question regarding this authorization.

Sincerely,

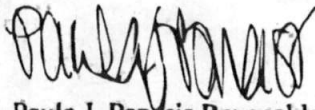
A handwritten signature in black ink, appearing to read "Paula J. Panasis", written in a cursive style.

Paula J. Panasis Revocable Trust
Charles & Paula J. Panasis Trustees
280 A Dover Point Road
Dover, NH 03820

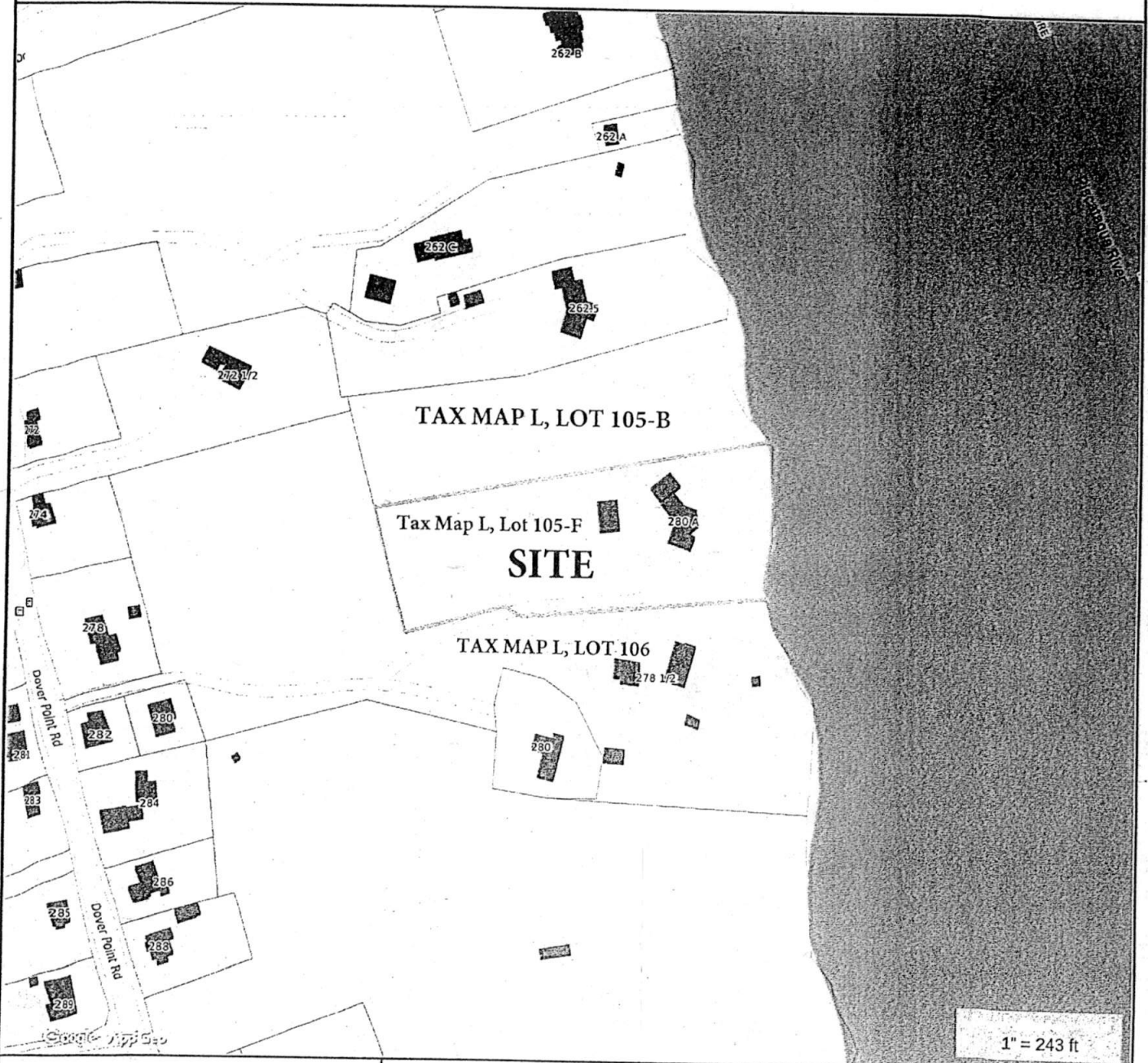

Property Information

Property ID L0105-F00000
Location 280 A DOVER POINT RD
Owner PANASIS CHARLES & PAULA TRUSTEES
Land Use 101



MAP FOR REFERENCE ONLY
NOT A LEGAL DOCUMENT

City of Dover, NH makes no claims and no warranties, expressed or implied, concerning the validity or accuracy of the GIS data presented on this map.

Geometry updated 5/20/2020
Data updated Daily

Map by NH GRANIT

Legend

- State
- County
- City/Town

Map Scale

1: 12,988

© NH GRANIT, www.granit.unh.edu

Map Generated: 8/24/2020

Notes

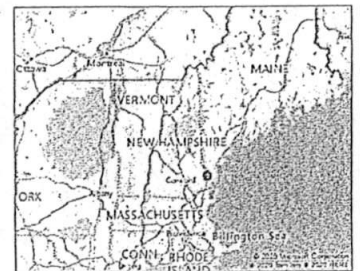

Memo

NH Dept. of Environmental Services review



NH NATURAL HERITAGE BUREAU
NHB DATACHECK RESULTS LETTER

To: John Chagnon, Ambit Engineering, Inc.
200 Griffin Road
Unit 3
Portsmouth, NH 03801

From: Amy Lamb, NH Natural Heritage Bureau
Date: 8/31/2020 (valid for one year from this date)

Re: Review by NH Natural Heritage Bureau
NHB File ID: NHB20-2566

Town: Dover

Location: Tax Maps: Tax Map L, Lots 105-F &
105-B

Description: The project proposes an extension of the existing tidal docking structure, construction of an in-ground pool, and construction of a storage shed.

cc: Kim Tuttle

As requested, I have searched our database for records of rare species and exemplary natural communities, with the following results.

Comments: Please contact the NH Fish & Game Department to address wildlife concerns.

Vertebrate species	State ¹	Federal	Notes
Atlantic Sturgeon (<i>Acipenser oxyrinchus</i>)	T	T	Contact the NH Fish & Game Dept and the US Fish & Wildlife Service (see below).
Shortnose Sturgeon (<i>Acipenser brevirostrum</i>)	E	E	Contact the NH Fish & Game Dept and the US Fish & Wildlife Service (see below).

¹Codes: "E" = Endangered, "T" = Threatened, "SC" = Special Concern, "--" = an exemplary natural community, or a rare species tracked by NH Natural Heritage that has not yet been added to the official state list. An asterisk (*) indicates that the most recent report for that occurrence was more than 20 years ago.

Contact for all animal reviews: Kim Tuttle, NH F&G, (603) 271-6544.

A negative result (no record in our database) does not mean that a sensitive species is not present. Our data can only tell you of known occurrences, based on information gathered by qualified biologists and reported to our office. However, many areas have never been surveyed, or have only been surveyed for certain species. An on-site survey would provide better information on what species and communities are indeed present.



The State of New Hampshire
**Department of Environmental
Services**



Robert R. Scott, Commissioner

This application contains confidential information from the NH Natural Heritage Bureau (NHB) Datacheck tool provided by the NH Department of Natural and Cultural Resources, NHB. This information is being withheld from disclosure to the public.

Please direct all questions regarding the confidential information to Pamela G. Monroe, Legal Unit Administrator, NH Department of Environmental Services, at: pamela.g.monroe@des.nh.gov, or (603) 271-3137.

ABUTTER'S LIST

JN 3050.28

Client: Paula J. Panasis Revocable Trust

Project Address: 280A Dover Point Road, Dover, NH

MAP	LOT	NAME(S)	PO BOX	STREET ADDRESS	CITY/STATE/ZIP
L	105-B	Charles N. Panasis Rev. Trust Charles N. & Paula J. Panasis Trustees	-		
L	106	Groux/Bow Street Realty Trust Roger C. Groux Trustee	--		

NOTES:

- 1) PARCEL IS SHOWN ON THE CITY OF DOVER ASSESSOR'S MAP L AS LOT 105-F.
- 2) OWNERS OF RECORD:
- LOT 105-F
PAULA J. PANASIS REVOCABLE TRUST
PAULA A. PANASIS & CHARLES N. PANASIS, TRUSTEES
280A DOVER POINT ROAD
DOVER, NH 03820
4023/167
S.C.R.D. PLAN 28-19 (TRACT B)
- 3) PORTION OF THE PARCEL IS IN A SPECIAL FLOOD HAZARD AREA, ZONE AE (EL8), AS SHOWN ON FIRM PANEL 3317C0340E, EFFECTIVE DATE SEPTEMBER 30, 2015.
- 4) EXISTING LOT AREAS:
- LOT 105-F
131,374± S.F. (TO MEAN HIGH WATER)
3.0159± ACRES (TO MEAN HIGH WATER)
- 5) PARCEL IS LOCATED IN THE LOW DENSITY RESIDENTIAL (R-20) ZONING DISTRICT AND PORTIONS ARE SUBJECT TO THE WETLAND PROTECTION & CONSERVATION OVERLAY DISTRICTS AND PORTIONS ARE SUBJECT TO THE PROVISIONS OF THE FLOODPLAIN DEVELOPMENT ORDINANCE.
- 6) THE PURPOSE OF THIS PLAN IS TO SHOW THE PROPOSED DOCK EXTENSION ON ASSESSOR'S MAP L LOT 105-F IN THE CITY OF DOVER.
- 7) VERTICAL DATUM IS MEAN LOWER LOW WATER (MLLW). BASIS OF VERTICAL DATUM IS REDUNDANT RTN GNS OBSERVATIONS (4.0.27). REDUCTION FROM NAVD83 TO MLLW BASED ON NGA STATION 8420411 DOVER, COCHECO RIVER. MLLW BEING 3.93 FEET LOWER THAN 0.00 NAVD83.
- 8) THE CONTRACTOR SHALL NOTIFY DIG SAFE AT 1-888-DIG-SAFE (1-888-344-7233) AT LEAST 72 HOURS PRIOR TO COMMENCING ANY EXCAVATION ON PUBLIC OR PRIVATE PROPERTY WITHIN 100 FEET OF UNDERGROUND UTILITIES. THE EXCAVATOR IS RESPONSIBLE TO MAINTAIN MARKS. DIG SAFE TICKETS EXPIRE IN THIRTY DAYS.
- 9) UNDERGROUND UTILITY LOCATIONS ARE BASED UPON BEST AVAILABLE EVIDENCE AND ARE NOT FIELD VERIFIED. LOCATING AND PROTECTING ANY ABOVEGROUND OR UNDERGROUND UTILITIES IS THE SOLE RESPONSIBILITY OF THE CONTRACTOR AND/OR THE OWNER. UTILITY CONFLICTS SHOULD BE REPORTED AT ONCE TO THE DESIGN ENGINEER.
- 10) THE CONTRACTOR SHALL INSTALL AND MAINTAIN EROSION CONTROL MEASURES IN ACCORDANCE WITH THE "NEW HAMPSHIRE STORMWATER MANUAL, VOLUME 3, EROSION AND SEDIMENT CONTROLS DURING CONSTRUCTION. (NHDES DECEMBER 2008).

**DOCK EXTENSION
PANASIS RESIDENCE
280A DOVER POINT ROAD
DOVER, N.H.**

0	ISSUED FOR COMMENT	11/17/20
1	REVISED FOR PERMIT AMENDMENT APP	12/20/2021

NO.	DESCRIPTION	DATE
REVISIONS		



SCALE 1"=20' DECEMBER 20, 2021

NH DES PERMIT
PLAN

C2



AMBIT ENGINEERING, INC.
Civil Engineers & Land Surveyors
200 Griffin Road - Unit 3
Portsmouth, N.H. 03801-7114
Tel: (603) 430-9552
Fax: (603) 430-2315

NOTES:

- 1) THE CONTRACTOR SHALL NOTIFY DIG SAFE AT 1-888-DIG-SAFE (1-888-344-7233) AT LEAST 72 HOURS PRIOR TO COMMENCING ANY EXCAVATION ON PUBLIC OR PRIVATE PROPERTY WITHIN 100 FEET OF UNDERGROUND UTILITIES. THE EXCAVATOR IS RESPONSIBLE TO MAINTAIN MARKS. DIG SAFE TICKETS EXPIRE IN THIRTY DAYS.
- 2) UNDERGROUND UTILITY LOCATIONS ARE BASED UPON BEST AVAILABLE EVIDENCE AND ARE NOT FIELD VERIFIED. LOCATING AND PROTECTING ANY ABOVEGROUND OR UNDERGROUND UTILITIES IS THE SOLE RESPONSIBILITY OF THE CONTRACTOR AND/OR THE OWNER. UTILITY CONFLICTS SHOULD BE REPORTED AT ONCE TO THE DESIGN ENGINEER.
- 3) CONTRACTOR SHALL INSTALL AND MAINTAIN EROSION CONTROL MEASURES IN ACCORDANCE WITH THE NEW HAMPSHIRE STORMWATER MANUAL, VOLUME 3, EROSION AND SEDIMENT CONTROLS DURING CONSTRUCTION. (NHDES DECEMBER 2008).
- 4) NUMBER OF PILES TO BE DRIVEN FOR DOCKING STRUCTURE NOT TO EXCEED 10 PILES AS DEPICTED ON PROPOSED DOCK ELEVATION. ALSO NOTE TIME OF YEAR AND NOISE RESTRICTIONS FOR DRIVING OF PILES.
- 5) VERTICAL DATUM IS MEAN LOWER LOW WATER (MLLW). BASIS OF VERTICAL DATUM IS REDUNDANT RTN GNSS OBSERVATIONS (+0.2'). REDUCTION FROM NAVD83 TO MLLW BASED ON NOAA STATION 8420411 DOVER, COCKEOD RIVER. MLLW BEING 3.93 FEET LOWER THAN 0.00 NAVD83.

DOCK EXTENSION PANASIS RESIDENCE 280A DOVER POINT ROAD DOVER, N.H.

NO.	DESCRIPTION	DATE
1	CHANGED TIME OF YEAR RESTRICTION	6/11/21
0	ISSUED FOR COMMENT	11/17/20
REVISIONS		



SCALE: 1" = 10' NOVEMBER 2020

DOCK
DETAILS

D1

FB 384 PG 51

3050.28

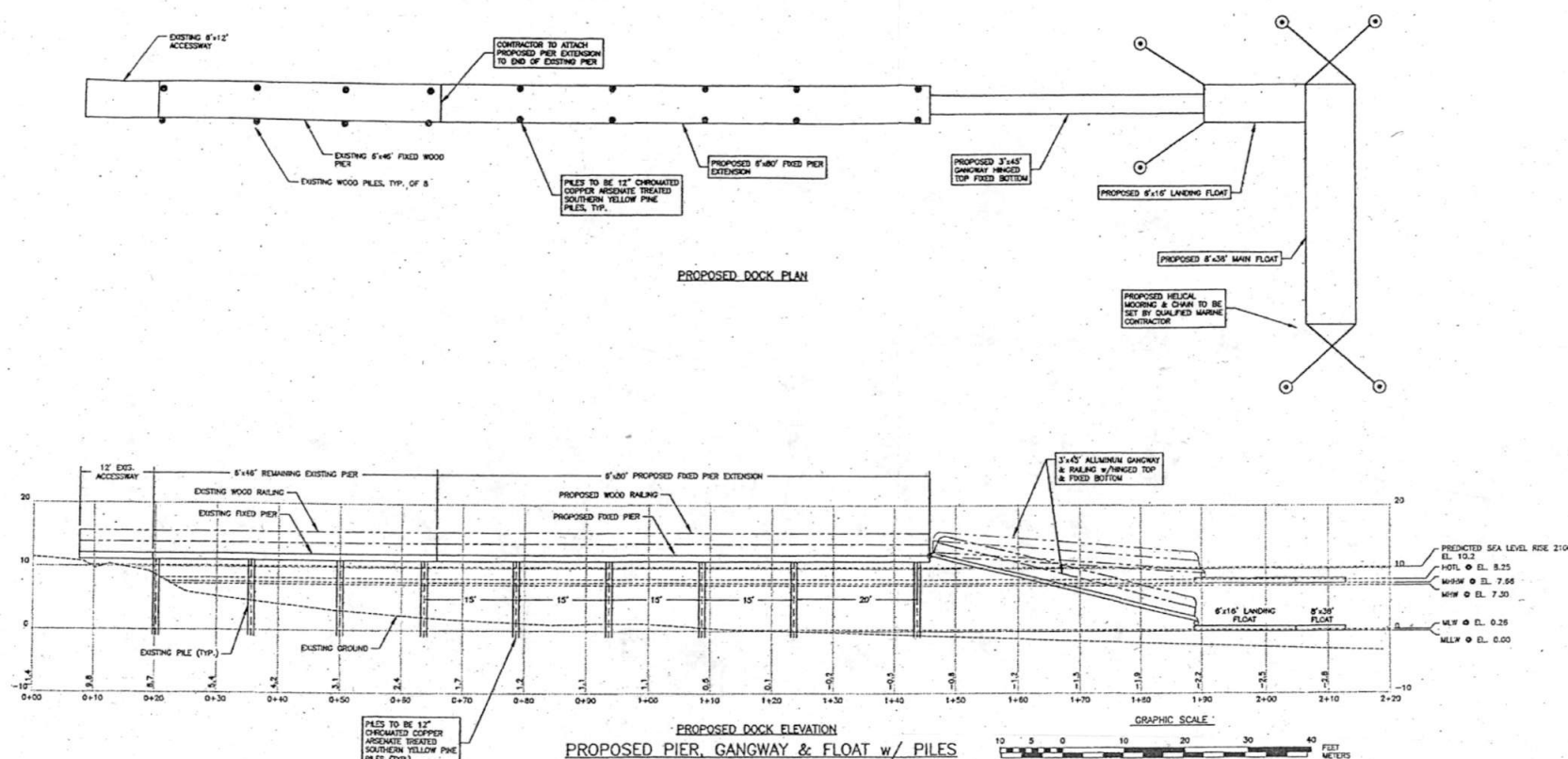

SEQUENCE OF CONSTRUCTION

- 1) MOBILIZATION OF A CRANE BARGE, PUSHER BOAT, WORK SKIFF, MATERIALS AND PREPARATION OF COMPONENTS SUCH AS THE GANGWAY AND FLOAT TO THE SITE VIA APPROVED ACCESS.
- 2) MOBILIZATION OF EQUIPMENT TRUCKS TO THE SITE.
- 3) THE BARGE WILL BE POSITIONED ALONGSIDE THE PROPOSED LOCATION OF THE NEW DOCK AND WATERWALL OF ANY EXISTING VEGETATION TO MINIMIZE IMPACTS.
- 4) INSTALLATION OF THE SUB STRUCTURE WILL BE PERFORMED FROM A CRANE BARGE OR SKIFF TO REDUCE THE AMOUNT OF FOOT TRAFFIC IN THE INTERIOR AREA.
- 5) ALL WORK WILL BE PERFORMED AT LOW TIDE TO MINIMIZE SEDIMENTATION.
- 6) PILES WILL BE MECHANICALLY DRIVEN BY A CRANE ELIMINATING ANY EXCAVATION FOR INSTALLATION OF THE PILES. PILING ARE DRIVEN TO REFUSE.
- 7) PILES ARE CUT AND BEAM CAPS ARE INSTALLED AND THE SUPER STRUCTURE OF THE PIER IS BUILT. MATERIALS ARE LIFTED FROM THE BARGE AND SET INTO POSITION BY THE CRANE.
- 8) ONCE THE PIER IS COMPLETE, THE GANGWAY AND FLOAT ARE BROUGHT INTO POSITION AND INSTALLED.

DISCHARGES, AVOIDANCE, MINIMIZATION AND MITIGATION

DISCHARGES OF DREDGED OR FILL MATERIAL INTO WATERS OF THE U.S. AND ANY SECONDARY IMPACTS SHALL BE AVOIDED AND MINIMIZED TO THE MAXIMUM EXTENT PRACTICABLE. PERMITTEES MAY ONLY FILL THOSE JURISDICTIONAL WETLANDS AND WATERWAYS THAT THE CORPS AND NHEDES AUTHORIZED TO BE FILLED AND IMPACT THOSE AREAS THAT THE CORPS AND NHEDES AUTHORIZED AS SECONDARY IMPACTS. IF NOT SPECIFICALLY AUTHORIZED BY USACE AND NHEDES, ANY UNAUTHORIZED FILL OR SECONDARY IMPACT TO WETLANDS MAY BE CONSIDERED AS A VIOLATION OF THE CWA.

HEAVY EQUIPMENT IN FRESH WATER WETLANDS

HEAVY EQUIPMENT OTHER THAN FIXED EQUIPMENT (DRILL RIGS, FIXED CRANES, ETC.) WORKING IN WETLANDS SHALL NOT BE STORED, MAINTAINED OR REPAIRED IN WETLANDS, UNLESS IT IS LESS ENVIRONMENTALLY DAMAGING OTHERWISE AND AS MUCH AS POSSIBLE SHALL NOT BE OPERATED WITHIN THE INTERIOR ZONE. WHERE CONSTRUCTION REQUIRES HEAVY EQUIPMENT OPERATION IN WETLANDS, THE EQUIPMENT SHALL EITHER HAVE LOW GROUND PRESSURE (C3 P3) OR SHALL NOT BE LOCATED DIRECTLY ON WETLAND SOILS AND VEGETATION. IT SHALL BE PLACED ON SWAMP MATS THAT ARE DESIGNED TO SUPPORT THE EQUIPMENT IN SUCH A MANNER AS TO MINIMIZE DISTURBANCE OF WETLAND SOILS AND VEGETATION. SWAMP MATS ARE TO BE PLACED IN THE WETLAND FROM THE UPLAND OR FROM EQUIPMENT POSITIONED ON SWAMP MATS IF WORKING WITHIN A WETLAND. DRAGGING SWAMP MATS INTO POSITION IS PROHIBITED. OTHER SUPPORT STRUCTURES THAT ARE LESS IMPACTING AND ARE CAPABLE OF SAFELY SUPPORTING EQUIPMENT MAY BE USED WITH WRITTEN CORPS AND NHEDES APPROVAL. SIMILARLY, NOT USING MATS DURING FROZEN, DRY OR OTHER CONDITIONS MAY BE ALLOWED WITH WRITTEN CORPS AND NHEDES APPROVAL. AN ADEQUATE SUPPLY OF SPILL CONTAINMENT EQUIPMENT SHALL BE MAINTAINED ON SITE. CORROSION RESISTANT AND SWAMP/CONSTRUCTION MATS ARE CONSIDERED AS FILL WHETHER THEY'RE INSTALLED TEMPORARILY OR PERMANENTLY.

TIME OF YEAR WORK WINDOW AND NOISE RESTRICTIONS

1. PILES INSTALLED IN-THE-DRY DURING LOW WATER OR IN-WATER BETWEEN NOV. 15TH - NOV. 15TH, OR
 2. MUST BE DRILLED AND PINNED TO LEGS, OR
 3. VIBRODRY HAMMERS USED TO INSTALL ANY SIZE AND QUANTITY OF WOOD, CONCRETE OR STEEL PILES, OR
 4. IMPACT HAMMERS LIMITED TO ONE HAMMER AND <50 PILES INSTALLED/DAY WITH THE FOLLOWING: WOOD PILES OF ANY SIZE, CONCRETE PILES 18-INCHES DIAMETER, STEEL PILES 12-INCHES DIAMETER IF THE HAMMER IS <3000 LBS. AND A WOOD CUSHION IS USED BETWEEN THE HAMMER AND STEEL PILE.
- FOR IN-WATER ABOVE:
1. IN-WATER NOISE LEVELS SHALL NOT >187dB SEL RE LPA OR 206dB PEAK RE LPA AT A DISTANCE 10M FROM THE PILE BEING INSTALLED, AND
 2. IN-WATER NOISE LEVELS >125dB PEAK RE LPA SHALL NOT EXCEED 12 CONSECUTIVE HOURS ON ANY GIVEN DAY AND A 12 HOUR RECOVERY PERIOD (I.E., IN-WATER NOISE BELOW 125dB PEAK RE LPA) MUST BE PROVIDED BETWEEN WORK DAYS.

WORK SITE RESTORATION

1. UPON COMPLETION OF CONSTRUCTION ALL DISTURBED WETLAND AREAS SHALL BE PROPERLY STABILIZED. ANY SEED MIX SHALL CONTAIN ONLY PLANT SPECIES NATIVE TO NEW ENGLAND.
2. THE INTRODUCTION OR SPREAD OF INVASIVE PLANT SPECIES IN DISTURBED AREAS IS PROHIBITED.
3. IN AREAS OF AUTHORIZED TEMPORARY DISTURBANCE, IF TREES ARE CUT THEY SHALL BE CUT AT GROUND LEVEL AND NOT UPROOTED IN ORDER TO PREVENT DISRUPTION TO THE WETLAND SOIL STRUCTURE AND TO ALLOW STUMP SPROUTS TO REGENERATE THE WORK AREA, UNLESS OTHERWISE AUTHORIZED.
4. WETLAND AREAS WHERE PERMANENT DISTURBANCE IS NOT AUTHORIZED SHALL BE RESTORED TO THEIR ORIGINAL CONDITION AND ELEVATION, WHICH UNDER NO CIRCUMSTANCES SHALL BE HIGHER THAN THE PRE-CONSTRUCTION ELEVATION. ORIGINAL CONDITION MEANS CAREFUL PROTECTION AND/OR REMOVAL OF EXISTING SOIL AND VEGETATION AND REPLACEMENT BACK TO THE ORIGINAL LOCATION BODY THAT THE ORIGINAL SOIL LAYERING AND VEGETATION SCHEMES ARE APPROXIMATELY THE SAME, UNLESS AUTHORIZED.

SEDIMENTATION AND EROSION CONTROL

ADEQUATE SEDIMENTATION AND EROSION CONTROL, MANAGEMENT MEASURES, PRACTICES AND DEVICES, SUCH AS PHASED CONSTRUCTION, VEGETATED FILTER STRIPS, DEBRIS/TEXTILE Silt FENCES, STORMWATER DETENTION AND INFILTRATION SYSTEMS, SEDIMENT DETENTION BASINS, OR OTHER DEVICES SHALL BE INSTALLED AND PROPERLY MAINTAINED TO REDUCE EROSION AND RETAIN SEDIMENT ON-SITE DURING AND AFTER CONSTRUCTION. THEY SHALL BE CAPABLE OF PREVENTING EROSION OF COLLECTING SEDIMENT, SUSPENDED AND FLOATING MATERIALS, AND OF FILTERING FINE SEDIMENT. THE DISTURBED AREAS SHALL BE STABILIZED AND THESE DEVICES SHALL BE REMOVED UPON COMPLETION OF WORK. THE SEDIMENT COLLECTED BY THESE DEVICES SHALL BE REMOVED AND PLACED AT AN UPLAND LOCATION, IN A MANNER THAT WILL PREVENT ITS LATER EROSION INTO A WATERWAY OR WETLAND. ALL EXPOSED SOIL AND OTHER FILLS SHALL BE PERMANENTLY STABILIZED AT THE EARLIEST PRACTICABLE DATE.

SPAWNING AREAS

DISCHARGES OF DREDGED OR FILL MATERIAL, AND/OR SUSPENDED SEDIMENT PRODUCING ACTIVITIES IN FISH AND SHELLFISH SPAWNING OR NURSERY AREAS, OR ANADROMOUS AND MIGRATORY FISH SPAWNING AREAS, DURING SPAWNING OR BREEDING SEASONS SHALL BE AVOIDED. IMPACTS TO THESE AREAS SHALL BE MINIMIZED TO THE MAXIMUM EXTENT PRACTICABLE DURING ALL TIMES OF THE YEAR. INFORMATION ON SPAWNING HABITAT FOR SPECIES MANAGED UNDER THE MANU-SHARES FISHERY CONSERVATION AND MANAGEMENT ACT (E.G., ERM FOR SPAWNING ADULTS) CAN BE OBTAINED FROM THE NHEDES WEBSITE AT: <http://www.nhe.gov/nhe/>.

STORAGE OF SEASONAL STRUCTURES

COASTAL STRUCTURES SUCH AS PIER SECTIONS, FLOATS, ETC., THAT ARE REMOVED FROM THE WATERWAY FOR A PORTION OF THE YEAR (OFTEN REFERRED TO AS SEASONAL STRUCTURES) SHALL BE STORED IN AN UPLAND LOCATION, LOCATED ABOVE HIGHEST OBSERVABLE TIDE LINE (HOTT) AND NOT IN TIDEAL WETLANDS. THESE SEASONAL STRUCTURES MAY BE STORED ON THE FIXED, PILE-SUPPORTED PORTION OF THE STRUCTURE THAT IS SEPARATED FROM THE TIDEAL ZONE TO PREVENT STRUCTURES FROM BEING STORED ON THE MARSH SUBSTRATE AND THE SUBSTRATE SEAWARD OF MARSH.

ENVIRONMENTAL FUNCTIONS AND VALUES

THE PERMITTEE SHALL MAKE EVERY REASONABLE EFFORT TO 1) CARRY OUT THE CONSTRUCTION OR OPERATION OF THE WORK AUTHORIZED BY USACE AND NHEDES HEREIN IN A MANNER THAT MINIMIZES ADVERSE IMPACTS ON FISH, WILDLIFE AND NATURAL ENVIRONMENTAL VALUES, AND 2) PROHIBIT THE ESTABLISHMENT OR SPREAD OF PLANT SPECIES IDENTIFIED AS NON-NATIVE INVASIVE SPECIES BY ANY FEDERAL OR STATE AGENCY. SEE THE SECTION ON INVASIVE SPECIES AT <http://www.nhe.gov/nhe/regulatory/> FOR CONTROL METHODS.

INSPECTIONS

THE PERMITTEE SHALL ALLOW THE CORPS AND NHEDES TO MAKE PERIODIC INSPECTIONS AT ANY TIME DEEMED NECESSARY IN ORDER TO ENSURE THAT THE WORK IS BEING OR HAS BEEN PERFORMED IN ACCORDANCE WITH THE TERMS AND CONDITIONS OF THIS PERMIT. THE CORPS AND NHEDES MAY ALSO REQUIRE POST-CONSTRUCTION ENGINEERING DRAWINGS FOR COMPLETED WORK, AND POST-DREDGING SURVEY DRAWINGS FOR ANY DREDGING WORK.

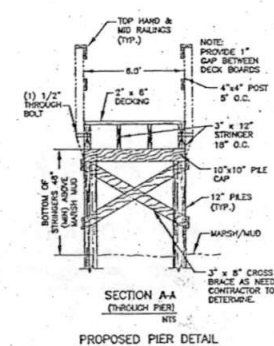

SECTION A-A
(THROUGH PIER)

PROPOSED PIER DETAIL

NOTES

NOTES APPROVED
PLAN

Received By NHEDES 06/15/2021

NOTES:

- 1) THE CONTRACTOR SHALL NOTIFY DIG SAFE AT 1-888-DIG-SAFE (1-888-344-7233) AT LEAST 72 HOURS PRIOR TO COMMENCING ANY EXCAVATION ON PUBLIC OR PRIVATE PROPERTY WITHIN 100 FEET OF UNDERGROUND UTILITIES. THE EXCAVATOR IS RESPONSIBLE TO MAINTAIN MARKS. DIG SAFE TICKETS EXPIRE IN THIRTY DAYS.
- 2) UNDERGROUND UTILITY LOCATIONS ARE BASED UPON BEST AVAILABLE EVIDENCE AND ARE NOT FIELD VERIFIED. LOCATING AND PROTECTING ANY ABOVEGROUND OR UNDERGROUND UTILITIES IS THE SOLE RESPONSIBILITY OF THE CONTRACTOR AND/OR THE OWNER. UTILITY CONFLICTS SHOULD BE REPORTED AT ONCE TO THE DESIGN ENGINEER.
- 3) CONTRACTOR SHALL INSTALL AND MAINTAIN EROSION CONTROL MEASURES IN ACCORDANCE WITH THE "NEW HAMPSHIRE STORMWATER MANUAL, VOLUME 3, EROSION AND SEDIMENT CONTROLS DURING CONSTRUCTION. (NHDES DECEMBER 2008).
- 4) NUMBER OF PILES TO BE DRIVEN FOR DOCKING STRUCTURE NOT TO EXCEED 10 PILES AS DEPICTED ON PROPOSED DOCK ELEVATION. ALSO NOTE TIME OF YEAR AND NOISE RESTRICTIONS FOR DRIVING OF PILES.
- 5) VERTICAL DATUM IS MEAN LOWER LOW WATER (MLLW). BASIS OF VERTICAL DATUM IS REDUNDANT RTN GNSS OBSERVATIONS ($\pm 0.2'$). REDUCTION FROM NAVD88 TO MLLW BASED ON NOAA STATION 8420411 DOVER, COCHECO RIVER. MLLW BEING 3.93 FEET LOWER THAN 0.00 NAVD88.

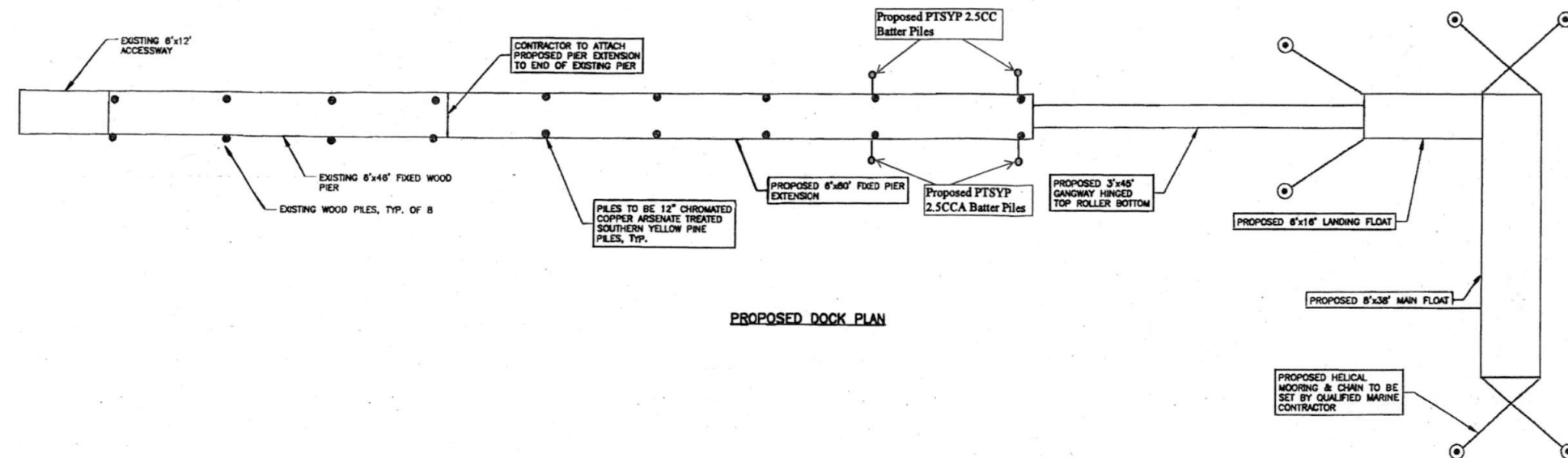

PROPOSED DOCK PLAN

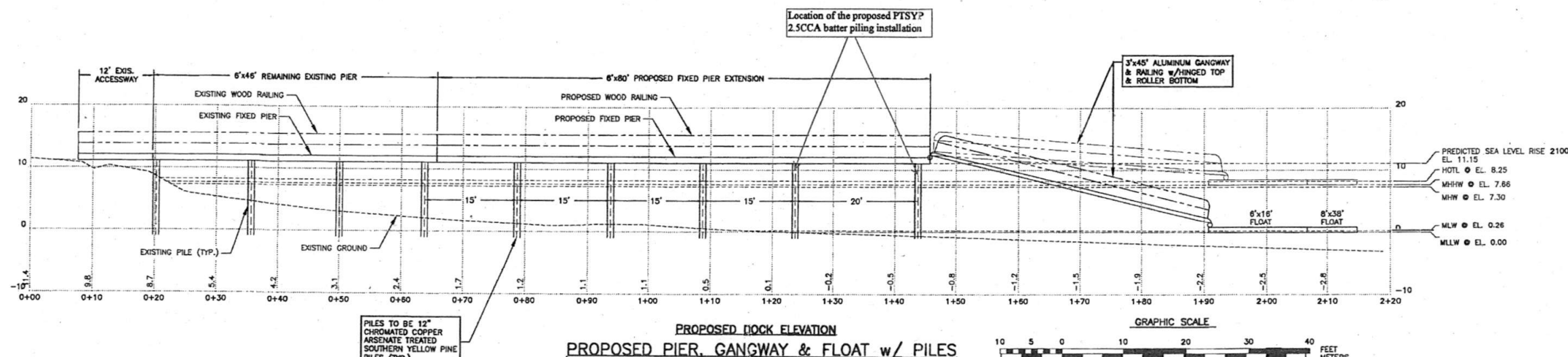

PROPOSED DOCK ELEVATION
PROPOSED PIER, GANGWAY & FLOAT w/ PILES

SEQUENCE OF CONSTRUCTION

- 1) MOBILIZATION OF A CRANE BARGE, PUSH BOAT, WORK SKIFF, MATERIALS AND PREFABRICATED COMPONENTS SUCH AS THE GANGWAY AND FLOAT TO THE SITE VIA APPROVED ACCESS.
- 2) MOBILIZATION OF EQUIPMENT TRUCKS TO THE SITE.
- 3) THE BARGE WILL BE POSITIONED ALONGSIDE THE PROPOSED LOCATION OF THE NEW DOCK AND WATERWARD OF ANY EMERGENT VEGETATION TO MINIMIZE IMPACTS.
- 4) INSTALLATION OF THE SUB STRUCTURE WILL BE PERFORMED FROM A CRANE BARGE OR SKIFF TO REDUCE THE AMOUNT OF FOOT TRAFFIC IN THE INTERTIDAL AREA.
- 5) ALL WORK WILL BE PERFORMED AT LOW TIDE TO MINIMIZE SEDIMENTATION.
- 6) PILING WILL BE MECHANICALLY DRIVEN BY A CRANE ELIMINATING ANY EXCAVATION FOR INSTALLATION OF THE PILING. PILING ARE DRIVEN TO REFUSAL.
- 7) PILING ARE CUT AND BEAM CAPS ARE INSTALLED AND THE SUPER STRUCTURE OF THE PIER IS BUILT. MATERIALS ARE LIFTED FROM THE BARGE AND SET INTO POSITION BY THE CRANE.
- 8) ONCE THE PIER IS COMPLETE, THE GANGWAY AND FLOAT ARE BROUGHT INTO POSITION AND INSTALLED.

DISCHARGES, AVOIDANCE, MINIMIZATION AND MITIGATION

DISCHARGES OF DREDGED OR FILL MATERIAL INTO WATERS OF THE U.S. AND ANY SECONDARY IMPACTS SHALL BE AVOIDED AND MINIMIZED TO THE MAXIMUM EXTENT PRACTICABLE. PERMITTEES MAY ONLY FILL THOSE JURISDICTIONAL WETLANDS AND WATERWAYS THAT THE CORP AND NHDES AUTHORIZES TO BE FILLED AND IMPACT THOSE AREAS THAT THE CORP AND NHDES AUTHORIZES AS SECONDARY IMPACTS. IF NOT SPECIFICALLY AUTHORIZED BY USACE AND NHDES, ANY UNAUTHORIZED FILL OR SECONDARY IMPACT TO WETLANDS MAY BE CONSIDERED AS A VIOLATION OF THE CWA.

HEAVY EQUIPMENT IN FRESH WATER WETLANDS

HEAVY EQUIPMENT OTHER THAN FIXED EQUIPMENT (DRILL RIGS, FIXED CRANES, ETC.) WORKING IN WETLANDS SHALL NOT BE STORED, MAINTAINED OR REPAIRED IN WETLANDS, UNLESS IT IS LESS ENVIRONMENTALLY DAMAGING OTHERWISE, AND AS MUCH AS POSSIBLE SHALL NOT BE OPERATED WITHIN THE INTERTIDAL ZONE. WHERE CONSTRUCTION REQUIRES HEAVY EQUIPMENT OPERATION IN WETLANDS, THE EQUIPMENT SHALL EITHER HAVE LOW GROUND PRESSURE (<3 PSI), OR SHALL NOT BE LOCATED DIRECTLY ON WETLAND SOILS AND VEGETATION; IT SHALL BE PLACED ON SWAMP MATS THAT ARE ADEQUATE TO SUPPORT THE EQUIPMENT IN SUCH A WAY AS TO MINIMIZE DISTURBANCE OF WETLAND SOIL AND VEGETATION. SWAMP MATS ARE TO BE PLACED IN THE WETLAND FROM THE UPLAND OR FROM EQUIPMENT POSITIONED ON SWAMP MATS IF WORKING WITHIN A WETLAND. DRAGGING SWAMP MATS INTO POSITION IS PROHIBITED. OTHER SUPPORT STRUCTURES THAT ARE LESS IMPACTING AND ARE CAPABLE OF SAFELY SUPPORTING EQUIPMENT MAY BE USED WITH WRITTEN CORPS AND NHDES AUTHORIZATION. SIMILARLY, NOT USING MATS DURING FROZEN, DRY OR OTHER CONDITIONS MAY BE ALLOWED WITH WRITTEN CORPS AND NHDES AUTHORIZATION. AN ADEQUATE SUPPLY OF SPILL CONTAINMENT EQUIPMENT SHALL BE MAINTAINED ON SITE. CORRODIOUS ROADS AND SWAMP/CONSTRUCTION MATS ARE CONSIDERED AS FILL WHETHER THEY'RE INSTALLED TEMPORARILY OR PERMANENTLY.

TIME OF YEAR WORK WINDOW AND NOISE RESTRICTIONS

- I. PILES INSTALLED IN-THE-DRY DURING LOW WATER OR IN-WATER BETWEEN NOV. 8TH - APR. 9TH, OR
- II. MUST BE DRILLED AND PINNED TO LEDGE, OR
- III. VIBRATORY HAMMERS USED TO INSTALL ANY SIZE AND QUANTITY OF WOOD, CONCRETE OR STEEL PILES, OR
- IV. IMPACT HAMMERS LIMITED TO ONE HAMMER AND <50 PILES INSTALLED/DAY WITH THE FOLLOWING: WOOD PILES OF ANY SIZE, CONCRETE PILES ± 18 -INCHES DIAMETER, STEEL PILES 12-INCHES DIAMETER IF THE HAMMER IS ≤ 3000 LBS. AND A WOOD CUSHION IS USED BETWEEN THE HAMMER AND STEEL PILE.

WORK SITE RESTORATION

- I. UPON COMPLETION OF CONSTRUCTION, ALL DISTURBED WETLAND AREAS SHALL BE PROPERLY STABILIZED. ANY SEED MIX SHALL CONTAIN ONLY PLANT SPECIES NATIVE TO NEW ENGLAND.
- II. THE INTRODUCTION OR SPREAD OF INVASIVE PLANT SPECIES IN DISTURBED AREAS IS PROHIBITED.
- III. IN AREAS OF AUTHORIZED TEMPORARY DISTURBANCE, IF TREES ARE CUT THEY SHALL BE CUT AT GROUND LEVEL AND NOT UPROOTED IN ORDER TO PREVENT DISRUPTION TO THE WETLAND SOIL STRUCTURE AND TO ALLOW STUMP SPROUTS TO REVEGETATE THE WORK AREA, UNLESS OTHERWISE AUTHORIZED.
- IV. WETLAND AREAS WHERE PERMANENT DISTURBANCE IS NOT AUTHORIZED SHALL BE RESTORED TO THEIR ORIGINAL CONDITION AND ELEVATION, WHICH UNDER NO CIRCUMSTANCES SHALL BE HIGHER THAN THE PRE-CONSTRUCTION ELEVATION. ORIGINAL CONDITION MEANS CAREFUL PROTECTION AND/OR REMOVAL OF EXISTING SOIL AND VEGETATION, AND REPLACEMENT BACK TO THE ORIGINAL LOCATION SUCH THAT THE ORIGINAL SOIL LAYERING AND VEGETATION SCHEMES ARE APPROXIMATELY THE SAME, UNLESS AUTHORIZED.

SEDIMENTATION AND EROSION CONTROL

ADEQUATE SEDIMENTATION AND EROSION CONTROL MEASURES, PRACTICES AND DEVICES, SUCH AS PHASED CONSTRUCTION, VEGETATED FILTER STRIPS, GEOTEXTILE SILT DEVICES, STORMWATER DETENTION AND INFILTRATION SYSTEMS, SEDIMENT DETENTION BASINS, OR OTHER DEVICES SHALL BE INSTALLED AND PROPERLY MAINTAINED TO REDUCE EROSION AND RETAIN SEDIMENT ON-SITE DURING AND AFTER CONSTRUCTION. THEY SHALL BE CAPABLE OF PREVENTING EROSION, OF COLLECTING SEDIMENT, SUSPENDED AND FLOATING MATERIALS, AND OF FILTERING FINE SEDIMENT. THE DISTURBED AREAS SHALL BE STABILIZED AND THESE DEVICES SHALL BE REMOVED UPON COMPLETION OF WORK. THE SEDIMENT COLLECTED BY THESE DEVICES SHALL BE REMOVED AND PLACED AT AN UPLAND LOCATION, IN A MANNER THAT WILL PREVENT ITS LATER EROSION INTO A WATERWAY OR WETLAND. ALL EXPOSED SOIL AND OTHER FILLS SHALL BE PERMANENTLY STABILIZED AT THE EARLIEST PRACTICABLE DATE.

SPAWNING AREAS

DISCHARGES OF DREDGED OR FILL MATERIAL AND/OR SUSPENDED SEDIMENT PRODUCING ACTIVITIES IN FISH AND SHELLFISH SPAWNING OR NURSERY AREAS, OR AMPHIBIAN AND MIGRATORY BIRD BREEDING AREAS, DURING SPAWNING OR BREEDING SEASONS SHALL BE AVOIDED. IMPACTS TO THESE AREAS SHALL BE MINIMIZED TO THE MAXIMUM EXTENT PRACTICABLE DURING ALL TIMES OF THE YEAR. INFORMATION ON SPAWNING HABITAT FOR SPECIES MANAGED UNDER THE MAGNUSON-STEVENS FISHERY CONSERVATION AND MANAGEMENT ACT (I.E. EFH FOR SPAWNING ADULTS) CAN BE OBTAINED FROM THE NMFS WEBSITE AT: WWW.NMFS.NOAA.GOV/HCD.

STORAGE OF SEASONAL STRUCTURES

COASTAL STRUCTURES SUCH AS PIER SECTIONS, FLOATS, ETC., THAT ARE REMOVED FROM THE WATERWAY FOR A PORTION OF THE YEAR (OFTEN REFERRED TO AS SEASONAL STRUCTURES) SHALL BE STORED IN AN UPLAND LOCATION, LOCATED ABOVE HIGHEST OBSERVABLE TIDE LINE (HOTL) AND NOT IN TIDAL WETLANDS. THESE SEASONAL STRUCTURES MAY BE STORED ON THE FIXED, PILE-SUPPORTED PORTION OF THE STRUCTURE THAT IS SEAWARD OF HOTL. THIS IS INTENDED TO PREVENT STRUCTURES FROM BEING STORED ON THE MARSH SUBSTRATE AND THE SUBSTRATE SEAWARD OF MHW.

ENVIRONMENTAL FUNCTIONS AND VALUES

THE PERMITTEE SHALL MAKE EVERY REASONABLE EFFORT TO 1) CARRY OUT THE CONSTRUCTION OR OPERATION OF THE WORK AUTHORIZED BY USACE AND NHDES HEREIN IN A MANNER THAT MINIMIZES ADVERSE IMPACTS ON FISH, WILDLIFE AND NATURAL ENVIRONMENTAL VALUES, AND 2) PROHIBIT THE ESTABLISHMENT OR SPREAD OF PLANT SPECIES IDENTIFIED AS NON-NATIVE INVASIVE SPECIES BY ANY FEDERAL OR STATE AGENCY. SEE THE SECTION ON INVASIVE SPECIES AT [HTTP://WWW.NAEUSACEARMY.MIL/REGULATORY/](http://WWW.NAEUSACEARMY.MIL/REGULATORY/) FOR CONTROL METHODS.

INSPECTIONS

THE PERMITTEE SHALL ALLOW THE CORPS AND NHDES TO MAKE PERIODIC INSPECTIONS AT ANY TIME DEEMED NECESSARY IN ORDER TO ENSURE THAT THE WORK IS BEING OR HAS BEEN PERFORMED IN ACCORDANCE WITH THE TERMS AND CONDITIONS OF THIS PERMIT. THE CORPS AND NHDES MAY ALSO REQUIRE POST-CONSTRUCTION ENGINEERING DRAWINGS FOR COMPLETED WORK, AND POST-DREDGING SURVEY DRAWINGS FOR ANY DREDGING WORK.

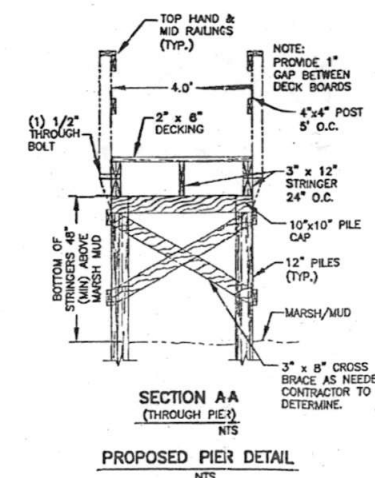

SECTION AA
(THROUGH PIER)
NTS

DOCK EXTENSION PANASIS RESIDENCE 280A DOVER POINT ROAD DOVER, N.H.

NO.	DESCRIPTION	DATE
0	ISSUED FOR COMMENT	11/17/20
1	REVISED FOR PERMIT AMENDMENT APP	12/28/2021
REVISIONS		

SCALE: 1" = 10'	NOVEMBER 2020
-----------------	---------------

DOCK
DETAILS

D1