

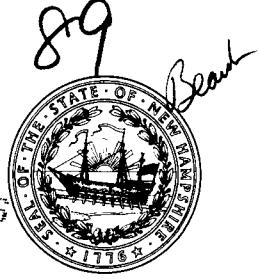

The State of New Hampshire
DEPARTMENT OF ENVIRONMENTAL SERVICES

Thomas S. Burack, Commissioner



May 21, 2015

Her Excellency, Governor Margaret Wood Hassan
and The Honorable Council
State House
Concord, NH 03301

REQUESTED ACTION

Approve Ship Ahoy's request to perform the following work on Lake Winnepesaukee, in Laconia. File # 2014-02892. This project will not have significant impact on or adversely affect the values of Lake Winnepesaukee.

Request to expand docking structures within the 20 ft. setback to the abutter following submittal of the required written abutter permission for impacts.

The Department imposed the following conditions as part of this approval:

1. All work shall be in accordance with plans by Diversified Marine Construction revision dated December 27, 2014, as received by the NH Department of Environmental Services (DES) on February 16, 2015.
2. This permit shall not be effective until it has been recorded with the Belknap County Registry of Deeds office by the Permittee. A copy of the recorded permit shall be submitted to the DES Wetlands Bureau by certified mail, return receipt requested, prior to construction.
3. Repairs to these structures may be conducted, as necessary, throughout the duration of this permit provided that the permittee notifies the Wetlands Bureau and Conservation Commission, in writing, of the proposed start and completion date prior to performing any repair.
4. Such repairs shall maintain existing size, location and configuration.
5. Appropriate siltation, erosion, and turbidity controls shall be in place prior to construction, maintained during construction, and shall remain in place until the area is stabilized.
6. This permit does not allow for maintenance dredging.
7. The minimum spacing between piles shall be 12 ft. as measured center pile to center pile.
8. All seasonal watercraft lifts, to include the seasonal boatlift within the boathouse, shall be removed from the lake for the non-boating season.
9. This permit does not allow for any work to the existing boathouse other than the installation of the seasonal boatlift.
10. All activities shall be in accordance with the Shoreland Water Quality Protection Act, RSA 483-B. The owner is responsible for obtaining any Shoreland Permit that may be required per RSA 483-B, for construction, excavation or fill that will occur within the Protected Shoreland.

DES Web site: www.des.nh.gov

P.O. Box 95, 29 Hazen Drive, Concord, New Hampshire 03302-0095

Telephone: (603) 271-3501 • Fax: (603) 271-6683 • TDD Access: Relay NH 1-800-735-2964

EXPLANATION

The DES Wetlands Bureau approved this project on April 21, 2015. DES supported its decision with the following findings:

1. This project is classified as a major project per Rule Env-Wt 303.02(d), modification of a docking facility providing 5 or more slips.
2. The Applicant has an average of 418 ft. of frontage along Lake Winnepesaukee.
3. A maximum of 6 slips may be permitted on this frontage per Rule Env-Wt 402.13, Frontage Over 75 ft.
4. The existing docking facilities on the frontage provide 14 slips.
5. The docking facilities as proposed will continue to provide 14 slips as defined per RSA 482-A:2, VIII.
6. The applicant submitted signed notarized permission from the affected abutter for impacts within the abutter's 20 ft. setback.

Application file documents are being forwarded to the Governor and Executive Council in connection with their consideration of this matter pursuant to RSA 482-A:3,II.(a) as it is a major project in public waters of the state.

We respectfully submit this request for your consideration.

Thomas S. Burack
Commissioner

Forst, Darlene

From: David Farley <dfarley@divermarine.com>
Sent: Tuesday, October 14, 2014 9:34 AM
To: cityclerk@city.laconia.nh.us; mcphies@city.laconia.nh.us; Forst, Darlene
Subject: Ship A'hoy Wetlands Permit Application (DES File No. 2014-02892)
Attachments: Ship Ahoy Updated Wetlands Permit.pdf

Hi,

Attached is an updated Wetlands Application for the Ship A'hoy Association, there was an error in section 3 (project description) on the previous application. If you should have any questions or concerns please contact us at (603) 293-2628.

Thank You,

Kelli

Diversified Marine Construction
PO Box 7464
Gilford, NH 03247
Phone 603-293-2628
Fax 603-293-9900
<http://www.divermarine.com>

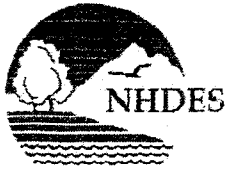

THE STATE OF NEW HAMPSHIRE
DEPARTMENT OF ENVIRONMENTAL SERVICES
LAND RESOURCES MANAGEMENT
WETLANDS BUREAU

29 Hazen Drive, PO Box 95, Concord, NH 03302-0095
Phone: (603) 271-2147 Fax: (603) 271-6588
<http://des.nh.gov/organization/divisions/water/wetlands>

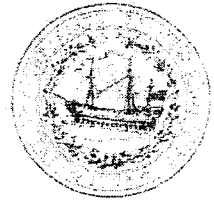

PERMIT APPLICATION

--	--

1. REVIEW TIME:
Indicate your Review Time below. Refer to Guidance Document A for instructions.

- Standard Review (Minimum, Minor or Major Impact) Expedited Review (Minimum Impact)

2. PROJECT LOCATION:
Separate applications must be filed with each municipality that jurisdictional impacts will occur in.

ADDRESS: **301 WEIRS BLVD** TOWN/CITY: **LACONIA**

TAX MAP: 241	BLOCK:	LOT: 248-12	UNIT:
---------------------	--------	--------------------	-------

USGS TOPO MAP WATERBODY NAME: **LAKE WINNIPESAUKEE** NA STREAM WATERSHED SIZE: NA

LOCATION COORDINATES (if known): Latitude/Longitude UTM State Plane

3. PROJECT DESCRIPTION:
Provide a brief description of the project outlining the scope of work. Attach additional sheets as needed to provide a detailed explanation of your project. DO NOT reply "See Attached" in the space provided below.

Rebuild the docking facility in a new configuration to meet required needs, creating no new slips as per pre-application meetings with Wetlands Bureau personnel.

4. RELATED PERMITS, ENFORCEMENT, EMERGENCY AUTHORIZATION, SHORELAND, ALTERATION OF TERRAIN, ETC...

5. NATURAL HERITAGE BUREAU & DESIGNATED RIVERS:
See the Instructions & Required Attachments document for instructions to complete a & b below.

- a. Natural Heritage Bureau File ID: **NHB 14 - 3846**
- b. Designated River the project is in ¼ miles of _____; and
date a copy of the application was sent to Local River Advisory Committee: Month: ___ Day: ___ Year: ___
- NA



THE STATE OF NEW HAMPSHIRE
DEPARTMENT OF ENVIRONMENTAL SERVICES
LAND RESOURCES MANAGEMENT
WETLANDS BUREAU

29 Hazen Drive, PO Box 95, Concord, NH 03302-0095
Phone: (603) 271-2147 Fax: (603) 271-6588
<http://des.nh.gov/organization/divisions/water/wetlands>



PERMIT APPLICATION

OCT 13 2014

COMPLETE

OCT 13 2014

2014-02892

14099

\$ 1,224.00

DB

1. REVIEW TIME:
Indicate your Review Time below. Refer to Guidance Document A for instructions.

Standard Review (Minimum, Minor or Major Impact)

Expedited Review (Minimum Impact)

2. PROJECT LOCATION:
Separate applications must be filed with each municipality that jurisdictional impacts will occur in.

ADDRESS: **301 WEIRS BLVD**

TOWN/CITY: **LACONIA**

TAX MAP: **241**

BLOCK:

LOT: **248-12**

UNIT:

USGS TOPO MAP WATERBODY NAME: **LAKE WINNIPESAUKEE**

NA STREAM WATERSHED SIZE:

NA

LOCATION COORDINATES (If known):

Latitude/Longitude UTM State Plane

3. PROJECT DESCRIPTION:
Provide a brief description of the project outlining the scope of work. Attach additional sheets as needed to provide a detailed explanation of your project. DO NOT reply "See Attached" in the space provided below.

REBUILD THE DOCKING FACILITY, DAMAGED BY ICE, TO THE SAME SIZE AND CONFIGURATION.

4. RELATED PERMITS, ENFORCEMENT, EMERGENCY AUTHORIZATION, SHORELAND, ALTERATION OF TERRAIN, ETC...

5. NATURAL HERITAGE BUREAU & DESIGNATED RIVERS:
See the Instructions & Required Attachments document for instructions to complete a & b below.

a. Natural Heritage Bureau File ID: NHB 14 - 3846

b. Designated River the project is in ¼ miles of: _____; and
date a copy of the application was sent to Local River Advisory Committee: Month: ___ Day: ___ Year: ___

NA

6. APPLICANT INFORMATION (Desired permit holder)

LAST NAME, FIRST NAME, M.I.

TRUST / COMPANY NAME: SHIP AHOY

MAILING ADDRESS: 301 WEIRS BLVD

TOWN/CITY: LACONIA

STATE: NH

ZIP CODE: 03246

EMAIL or FAX:

PHONE:

ELECTRONIC COMMUNICATION: By initialing here: _____ I hereby authorize DES to communicate all matters relative to this application electronically.

7. PROPERTY OWNER INFORMATION (If different than applicant)

LAST NAME, FIRST NAME, M.I.

TRUST / COMPANY NAME:

MAILING ADDRESS:

TOWN/CITY:

STATE:

ZIP CODE:

EMAIL or FAX:

PHONE:

ELECTRONIC COMMUNICATION: By initialing here: _____ I hereby authorize DES to communicate all matters relative to this application electronically.

8. AUTHORIZED AGENT INFORMATION

LAST NAME, FIRST NAME, M.I.: FARLEY, DAVE

COMPANY NAME: DIVERSIFIED MARINE CONSTRUCTION

MAILING ADDRESS: PO BOX 7464

TOWN/CITY: GILFORD

STATE: NH

ZIP CODE: 03247

EMAIL or FAX: dfarley@divermarine.com

PHONE: (603) 630-2259

ELECTRONIC COMMUNICATION: By initialing here df I hereby authorize DES to communicate all matters relative to this application electronically.

9. PROPERTY OWNER SIGNATURE:

See the Instructions & Required Attachments document for clarification of the below statements

By signing the application, I am certifying that:

1. I authorize the applicant and/or agent indicated on this form to act in my behalf in the processing of this application, and to furnish upon request, supplemental information in support of this permit application.
2. I have reviewed and submitted information & attachments outlined in the Instructions and Required Attachment document.
3. All abutters have been identified in accordance with RSA 482-A:3, I and Env-Wt 100-900.
4. I have read and provided the required information outlined in Env-Wt 302.04 for the applicable project type.
5. I have read and understand Env-Wt 302.03 and have chosen the least impacting alternative.
6. Any structure that I am proposing to repair/replace was either previously permitted by the Wetlands Bureau or would be considered grandfathered per Env-Wt 101.47.
7. I have submitted a copy of the application materials to the NH State Historic Preservation Officer.
8. I authorize DES and the municipal conservation commission to inspect the site of the proposed project.
9. I have reviewed the information being submitted and that to the best of my knowledge the information is true and accurate.
10. I understand that the willful submission of falsified or misrepresented information to the New Hampshire Department of Environmental Services is a criminal act, which may result in legal action.
11. I am aware that the work I am proposing may require additional state, local or federal permits which I am responsible for obtaining.
12. The mailing addresses I have provided are up to date and appropriate for receipt of DES correspondence. DES will not forward returned mail.

Property Owner Signature

THOMAS D SALES
FILED FOR PERMITTING

Print name legibly

9/12/2014

Date

MUNICIPAL SIGNATURES

10. CONSERVATION COMMISSION SIGNATURE

The signature below certifies that the municipal conservation commission has reviewed this application, and:

1. Waives its right to intervene per RSA 482-A:11;
2. Believes that the application and submitted plans accurately represent the proposed project; and
3. Has no objection to permitting the proposed work.

Authorized Commission Signature	Print name legibly	Date
---------------------------------	--------------------	------

DIRECTIONS FOR CONSERVATION COMMISSION

1. Expedited review **ONLY** requires that the conservation commission's signature is obtained in the space above.
2. The Conservation Commission signature should be obtained **prior** to the submittal of the original application and four copies to the town/city clerk for mailing to the DES.
3. The Conservation Commission may refuse to sign. If the Conservation Commission does not sign this statement for any reason, the application is not eligible for expedited review and the application will reviewed in the standard review time frame.

11. TOWN / CITY CLERK SIGNATURE

As required by Chapter 482-A:3 (amended 2014), I hereby certify that the applicant has filed four application forms, four detailed plans, and four USGS location maps with the town/city indicated below.

Town/City Clerk Signature	Mary Reynolds Print name legibly	Laconia Town/City	10-10-14 Date
---------------------------	-------------------------------------	----------------------	------------------

DIRECTIONS FOR TOWN/CITY CLERK:

Per RSA 482-A:3,1

1. For applications where "Expedited Review" is checked on page 1, sign and accept the applications **only** if the Conservation Commission signature has been received;
2. **IMMEDIATELY** sign the original application form and four copies in the signature space provided above;
3. Return the signed original application form and attachments to the applicant so that the applicant may submit the application form and attachments to NHDES by mail or hand delivery.
4. **IMMEDIATELY** distribute a copy of the application with one complete set of attachments to each of the following bodies: the municipal Conservation Commission, the local governing body (Board of Selectmen or Town/City Council), and the Planning Board; and
5. Retain one copy of the application form and one complete set of attachments and make them reasonably accessible for public review.

DIRECTIONS FOR APPLICANT:

1. Submit the original permit application form bearing the signature of the Town/ City Clerk, additional materials, and the application fee to NHDES by mail or hand delivery.

12. IMPACT AREA:

For each jurisdictional area that will be/has been impacted, provide square feet and, if applicable, linear feet of impact

Permanent: impacts that will remain after the project is complete.

Temporary: impacts not intended to remain (and will be restored to pre-construction conditions) after the project is complete.

After-the-fact (ATF): work completed prior to receipt of this application by DES. Check box to indicate ATF.

JURISDICTIONAL AREA	PERMANENT Sq. Ft. / Lin. Ft.	TEMPORARY Sq. Ft. / Lin. Ft.
Forested wetland		<input type="checkbox"/> ATF
Scrub-shrub wetland		<input type="checkbox"/> ATF
Emergent wetland		<input type="checkbox"/> ATF
Wet meadow		<input type="checkbox"/> ATF
Intermittent stream		<input type="checkbox"/> ATF
Perennial Stream / River	/	<input type="checkbox"/> ATF
Lake / Pond	/	<input type="checkbox"/> ATF
Bank - Intermittent stream	/	<input type="checkbox"/> ATF
Bank - Perennial stream / River	/	<input type="checkbox"/> ATF
Bank - Lake / Pond	/	<input type="checkbox"/> ATF
Tidal water	/	<input type="checkbox"/> ATF
Salt marsh		<input type="checkbox"/> ATF
Sand dune		<input type="checkbox"/> ATF
Prime wetland		<input type="checkbox"/> ATF
Prime wetland buffer		<input type="checkbox"/> ATF
Undeveloped Tidal Buffer Zone (TBZ)		<input type="checkbox"/> ATF
Previously-developed upland in TBZ		<input type="checkbox"/> ATF
Docking - Lake / Pond	512 Sq. Ft	<input type="checkbox"/> ATF
Docking - River		<input type="checkbox"/> ATF
Docking - Tidal Water		<input type="checkbox"/> ATF
TOTAL	512 Sq Ft/	/

13. APPLICATION FEE: See the Instructions & Required Attachments document for further instruction

Minimum Impact Fee: Flat fee of \$ 200

Minor or Major Impact Fee: Calculate using the below table below

Permanent and Temporary (non-docking) _____ sq. ft. X \$0.20 = \$ _____

Temporary (seasonal) docking structure: _____ sq. ft. X \$1.00 = \$ _____

Permanent docking structure: **512** sq. ft. X \$2.00 = **\$ 1024.00**

Projects proposing shoreline structures (including docks) add \$200 = \$ 200.00

Total = **\$ 1224.00**

The Application Fee is the above calculated Total or \$200, whichever is greater = **\$ 1224.00**

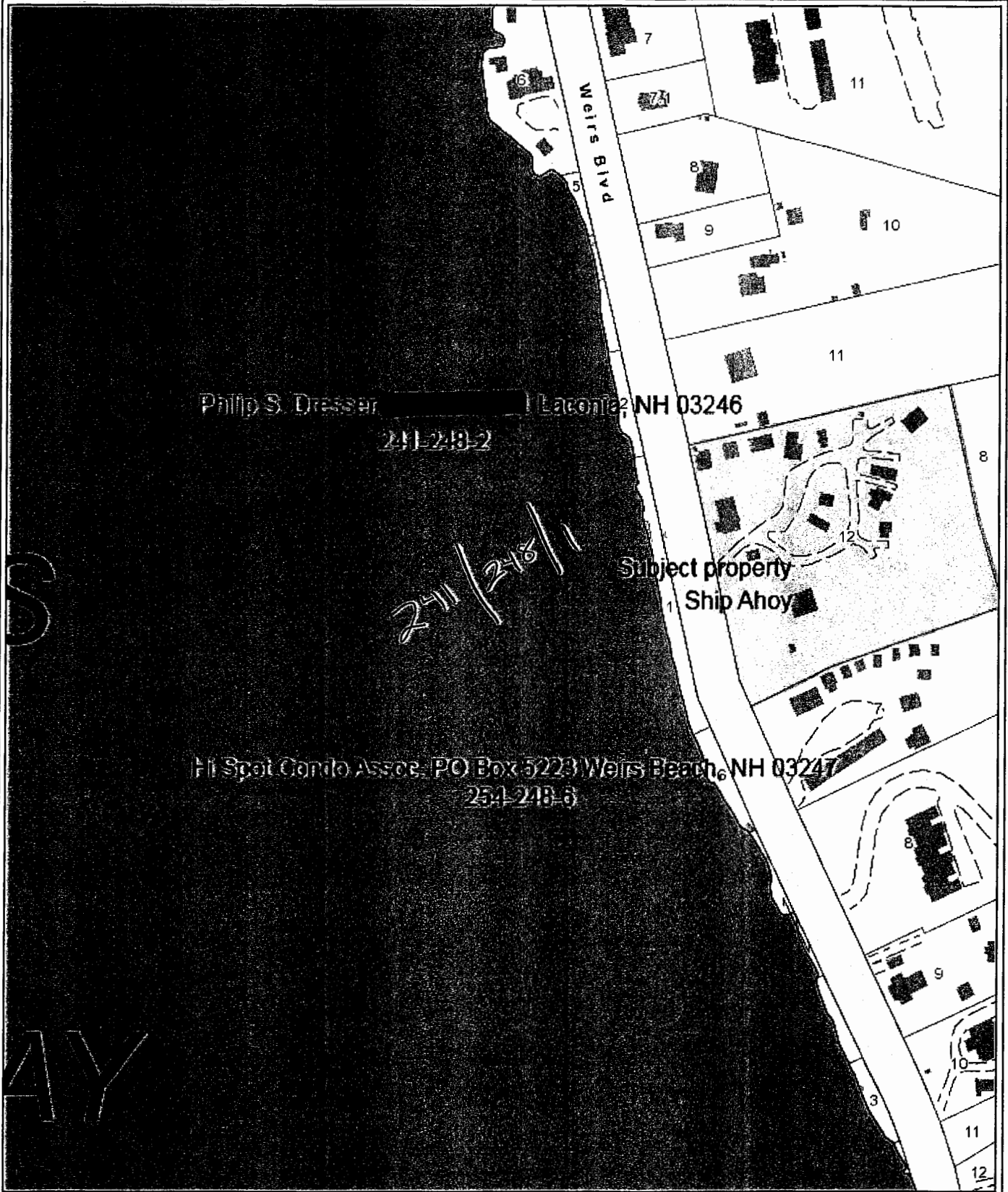

Laconia, NH
 1 Inch = 196 Feet
 March 30, 2015



Data shown on this map is provided for planning and informational purposes only. The municipality and CAI Technologies are not responsible for any use for other purposes or misuse or misrepresentation of this map.

www.cai-tech.com
 CAI Technologies

71°30'0"W 71°29'30"W 71°29'0"W 71°28'30"W 71°28'0"W 71°27'30"W 71°27'0"W 71°26'30"W 71°26'0"W

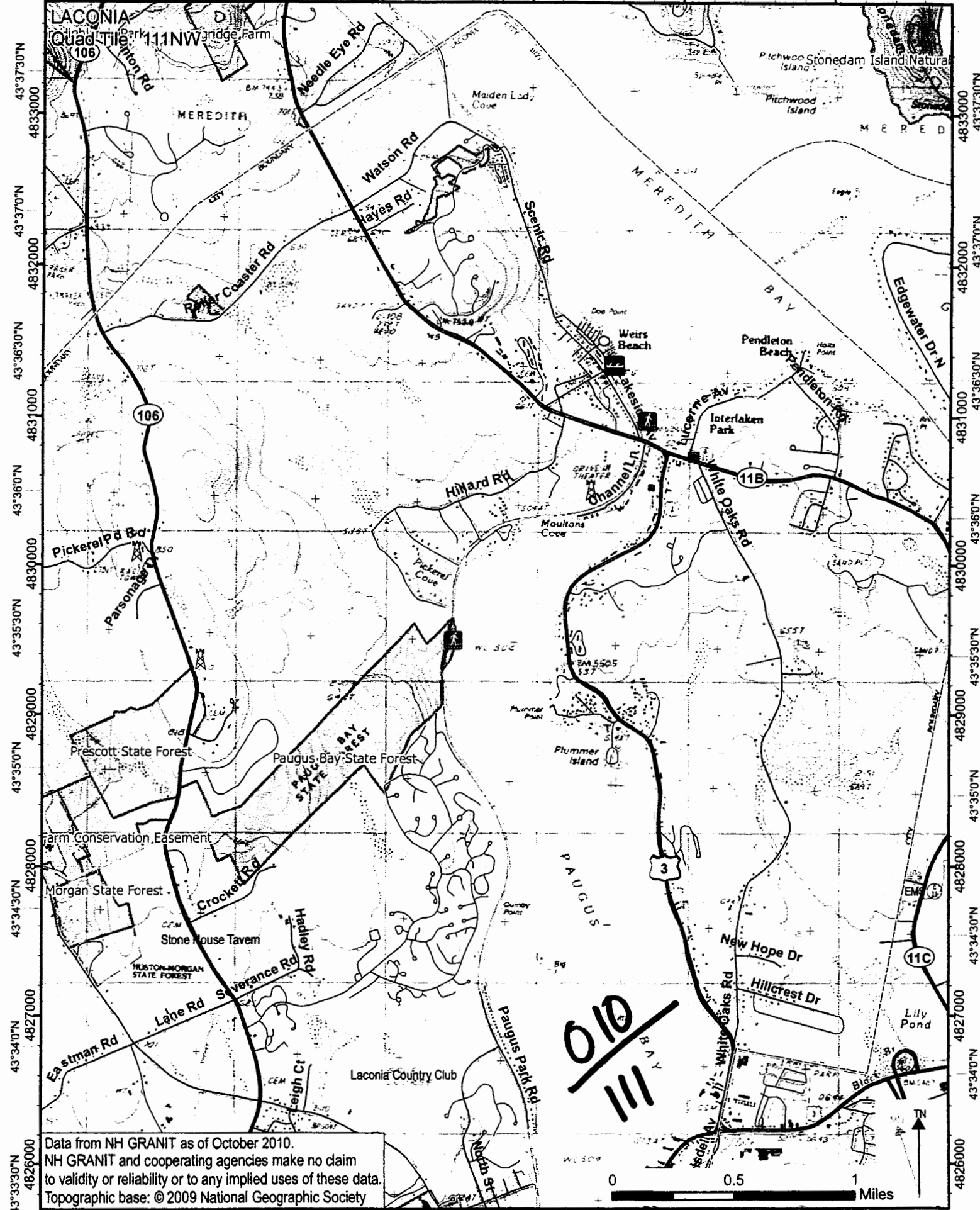

Data from NH GRANIT as of October 2010.
 NH GRANIT and cooperating agencies make no claim
 to validity or reliability or to any implied uses of these data.
 Topographic base: © 2009 National Geographic Society

OLD
 111
 BAY

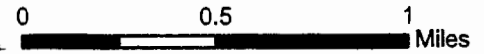

298000 299000 300000 301000 302000 303000 71°30'0"W 71°29'30"W 71°29'0"W 71°28'30"W 71°28'0"W 71°27'30"W 71°27'0"W 71°26'30"W 71°26'0"W



New Hampshire Natural Heritage Bureau

To: Kelli Morton
Po Box 7464
Gilford, NH 03247

Date: 10/10/2014

From: NH Natural Heritage Bureau

Re: Review by NH Natural Heritage Bureau of request dated 10/10/2014

NHB File ID: NHB14-3846

Applicant: Tom Wales, President

Location: Tax Map(s)/Lot(s): 241-248-12
Laconia

Project Description: Reconstruction of a docking facility damaged by ice.

The NH Natural Heritage database has been checked for records of rare species and exemplary natural communities near the area mapped below. The species considered include those listed as Threatened or Endangered by either the state of New Hampshire or the federal government. We currently have no recorded occurrences for sensitive species near this project area.

A negative result (no record in our database) does not mean that a sensitive species is not present. Our data can only tell you of known occurrences, based on information gathered by qualified biologists and reported to our office. However, many areas have never been surveyed, or have only been surveyed for certain species. An on-site survey would provide better information on what species and communities are indeed present.

This report is valid through 10/9/2015.



MAP OF PROJECT BOUNDARIES FOR NHB FILE ID: NHB14-3846

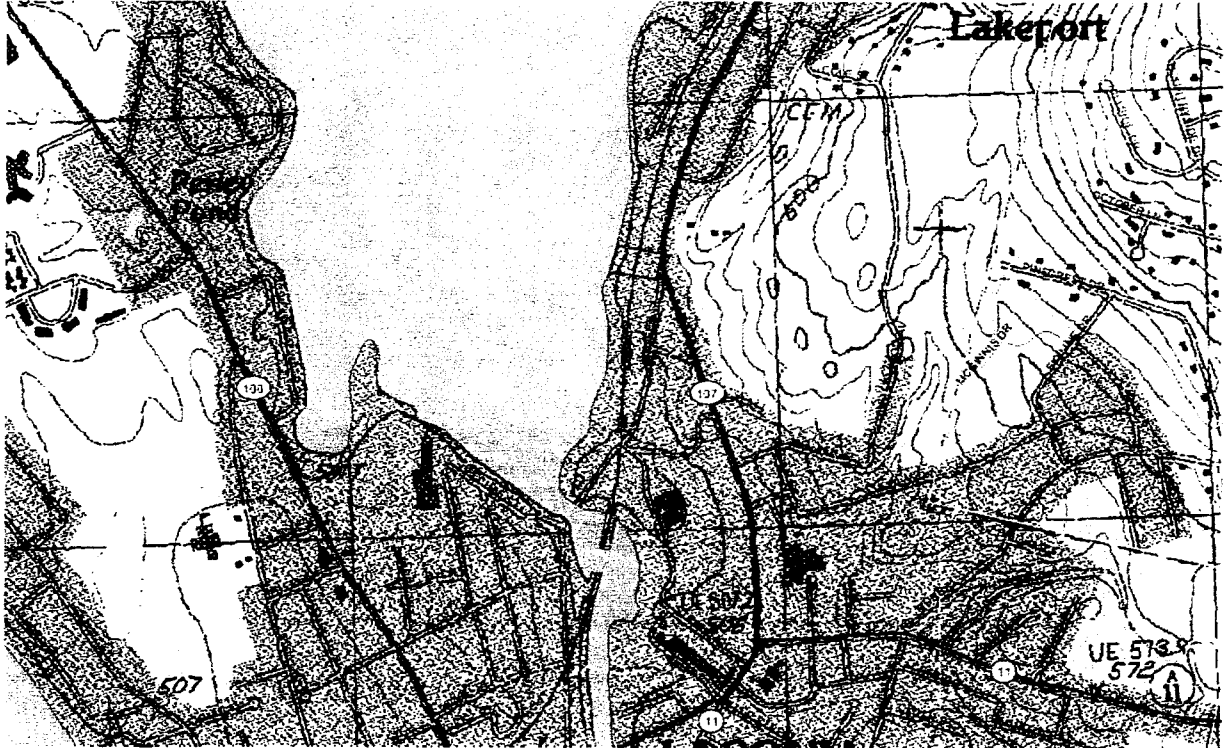

Abutter's List

Subject Property: 301 Weirs Boulevard
Laconia, NH 03246
Map 241 Lot 248-12

Abutter: Hi Spot Condo Assoc.
277 Weirs Blvd.
Laconia, NH 03246
Map 254 Lot 248-7

Philip Dresser
[REDACTED]
Laconia, NH 03246
Map 241 Lot 248-11

7013 1710 0000 0532 5849

U.S. Postal Service™
CERTIFIED MAIL™ RECEIPT
(Domestic Mail Only; No Insurance Coverage Provided)

For delivery information visit our website at www.usps.com

LACONIA NH 03246

Postage	S	\$0.49	0246
Certified Fee		\$3.30	
Return Receipt Fee (Endorsement Required)		\$0.00	
Restricted Delivery Fee (Endorsement Required)		\$0.00	
Total Postage & Fees	\$	\$3.79	

Postmark Here: LACONIA POST OFFICE SEP 12 2014

Sent To: Hi Spot Condo Assoc.
Street, Apt. No., or PO Box No.: 277 Weirs Blvd
City, State, ZIP+4: Laconia NH 03246

PS Form 3800, August 2006 See Reverse for Instructions

5285 2550 0000 0121 ET02

U.S. Postal Service™
CERTIFIED MAIL™ RECEIPT
(Domestic Mail Only; No Insurance Coverage Provided)

For delivery information visit our website at www.usps.com

LACONIA NH 03246

Postage	S	\$0.49	0246
Certified Fee		\$3.30	
Return Receipt Fee (Endorsement Required)		\$0.00	
Restricted Delivery Fee (Endorsement Required)		\$0.00	
Total Postage & Fees	\$	\$3.79	

Postmark Here: LACONIA POST OFFICE SEP 12 2014

Sent To: Phillip Dresser
Street, Apt. No., or PO Box No.: [REDACTED]
City, State, ZIP+4: Laconia NH 03246

PS Form 3800, August 2006 See Reverse for Instructions

Overlook at Winn Condo
257 Weirs Blvd.
Laconia, NH 03246
Map 254 Lot 248-8

2895 2550 0000 0121 ET02

U.S. Postal Service™
CERTIFIED MAIL™ RECEIPT
(Domestic Mail Only; No Insurance Coverage Provided)

For delivery information visit our website at www.usps.com

LACONIA NH 03246

Postage	S	\$0.49	0246
Certified Fee		\$3.30	
Return Receipt Fee (Endorsement Required)		\$0.00	
Restricted Delivery Fee (Endorsement Required)		\$0.00	
Total Postage & Fees	\$	\$3.79	

Postmark Here: LACONIA POST OFFICE SEP 12 2014

Sent To: Overlook at Winn Condo
Street, Apt. No., or PO Box No.: 257 Weirs Blvd
City, State, ZIP+4: Laconia NH 03246

PS Form 3800, August 2006 See Reverse for Instructions



Proposed Conditions
Map 241 Lot 248-12

Weirs Blvd. Route 3

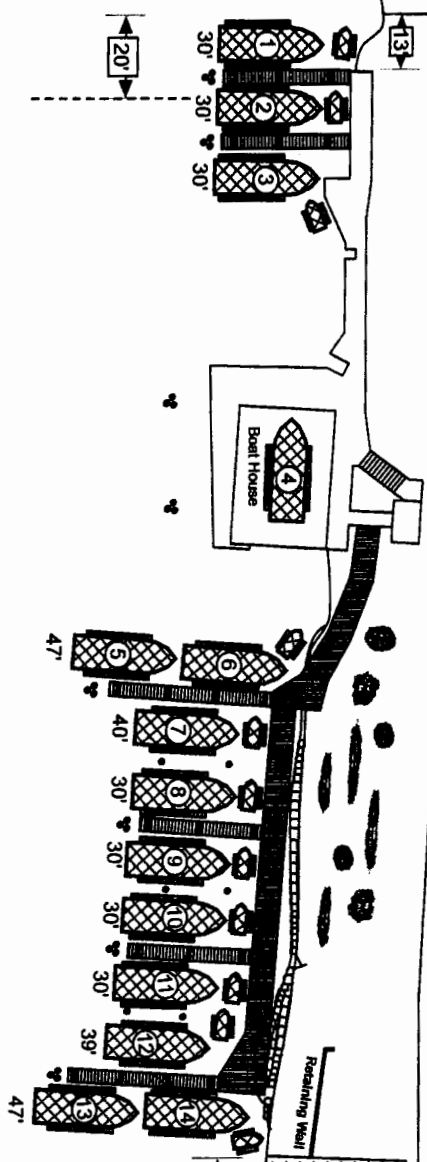

Lake Winnepesaukee

Boatlifts Are Seasonal

Area of Conservation

*RECEIVED
FEB 17 2015
DES*

Scale 1" = 30'

DIVERSIFIED MARINE CONSTRUCTION

David Farley
P.O. Box 7464
Gilford, NH 03247
Office (603) 528-4151
Fax (603) 527-8684

DRAWING DATE: July 6, 2014
DRAWN BY Matheru Crandall
Revision 1 Date: September 18, 2014
Revised By Dave Farley
Revision 2 Date: December 27, 2014
Revised By Dave Farley

Docking System
for
Ship-A-Hoy Condominium
301 Weirs Boulevard
Laconia, New Hampshire



Existing Conditions
Map 241 Lot 248-12

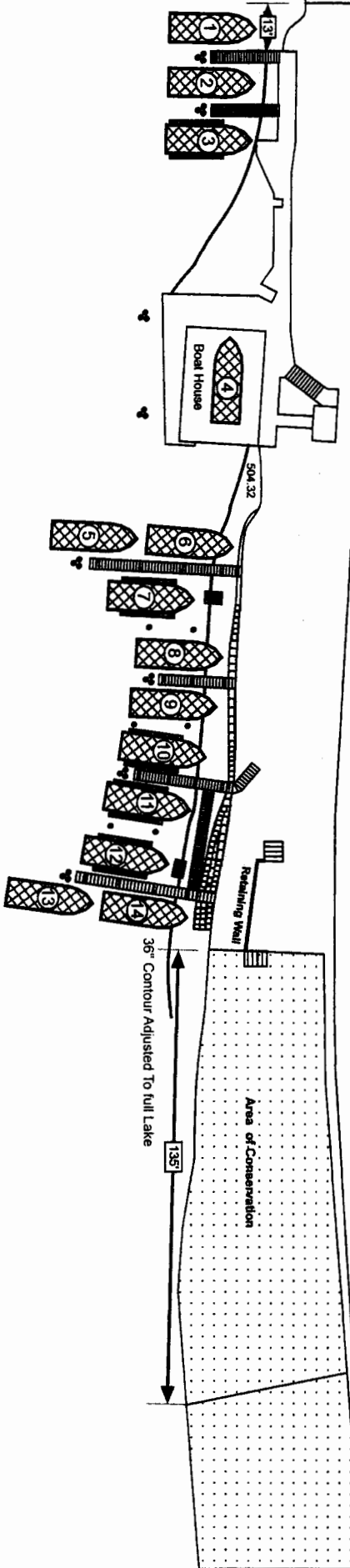

Lake Winnepesaukee

Weirs Blvd. Route 3

Scale 1" = 30'

DIVERSIFIED MARINE CONSTRUCTION

David Farley
P.O. Box 7464
Gilford, NH 03247
Office (603) 528-4151
Fax (603) 527-8684

DRAWING DATE: August 20, 2014
DRAWN BY Mathero Crandall
Revision 1 Date: September 22, 2014
Revised By Dave Farley
Revision 2 Date: December 21, 2014
Revised By Dave Farley

Docking System
for
Ship-A-Hoy Condominium
301 Weirs Boulevard
Laconia, New Hampshire