



The State of New Hampshire
Department of Environmental Services



83

Robert R. Scott, Commissioner

August 21, 2019

His Excellency, Governor Christopher T. Sununu
 and The Honorable Council
 State House
 Concord, NH 03301

REQUESTED ACTION

Approve Martha and Norman Harris' request to perform the following work on Lake Winnepesaukee in Meredith. File # 2019-00847. This project will not have significant impact on or adversely affect the values of Lake Winnepesaukee.

Remove an existing 7 foot x 45 foot 4 inch crib supported pier, impact 1050 square feet of bank along 35 linear feet of shoreline to construct a 35 foot x 34 foot irregular shaped perched beach with 4 foot wide steps to the water, install a 6 foot x 50 foot and 6 foot x 31 foot pile supported pier connected by a 6 foot x 25 foot connecting walkway in a "h" configuration along an existing breakwater, install two fender pile, a single seasonal boatlift and two seasonal personal watercraft lifts on an average of 234 linear feet of frontage along lake Winnepesaukee in Meredith.

The New Hampshire Department of Environmental Services (NHDES) imposed the following conditions as part of this approval:

1. All work shall be in accordance with revised plans by Watermark Marine Construction revision dated June 4, 2019 and as received by the NH Department of Environmental Services (NHDES) on June 12, 2019.
2. This permit is not valid and effective until it has been recorded with the appropriate county Registry of Deeds by the permittee. Prior to starting work under this permit, the permittee shall submit a copy of the recorded permit to the NHDES Wetlands Program by certified mail, return receipt requested.
3. The pre-existing non-conforming 7 foot x 45 foot 4 inch crib supported pier shall be completely removed from the frontage prior to the installation of any new structure on the frontage.
4. All development activities associated with this project shall be conducted in compliance with applicable requirements of RSA 483-B and NH Code of Administrative Rules Env-Wq 1400 during and after construction.
5. Work shall be carried out in a time and manner to avoid disturbances to migratory waterfowl breeding and nesting areas.
6. Work authorized shall be carried out such that discharges in spawning or nursery areas during spawning seasons shall be avoided, and impacts to such areas shall be avoided or minimized to the maximum extent practicable during all times of the year.
7. Appropriate siltation and erosion controls shall be in place prior to construction, shall be maintained during construction, and shall remain until the area is stabilized. Temporary controls shall be removed once the area has been stabilized.
8. Appropriate turbidity controls shall be installed prior to construction, shall be maintained during construction such that no turbidity escapes the immediate dredge area and shall remain until suspended particles have settled and water at the work site has returned to normal clarity.
9. All excavated material and construction-related debris shall be placed outside of the areas subject to RSA 482-A. Any spoil material deposited within 250 feet of any surface water shall comply with RSA-483-B.

www.des.nh.gov

29 Hazen Drive • PO Box 95 • Concord, NH 03302-0095

NHDES Main Line: (603) 271-3503 • Subsurface Fax: (603) 271-6683 • Wetlands Fax: (603) 271-6588

TDD Access: Relay NH 1 (800) 735-2964

10. The contractor responsible for completion of the work shall use techniques described in the New Hampshire Stormwater Manual, Volume 3, Erosion and Sediment Controls During Construction (December 2008).
11. Stone placed along the beach front for the purpose of retaining sand shall be placed above and landward of those rocks currently located along the normal high water line (Elevation 504.32). The rocks existing at the normal high water line shall remain undisturbed such that the natural shoreline remains visible and intact.
12. The steps installed in the area for access to the water shall be located completely landward and above the normal high water line (Elevation 504.32).
13. This permit shall not preclude the NHDES from initiating appropriate action if the NHDES later determines that any of the structures depicted as "existing" on the plans submitted by or on behalf of the permittee were not previously permitted or grandfathered.
14. No more than 10 cubic yards of sand shall be used and all sand shall be located above the normal high water line (Elevation 504.32).
15. The permittee or their contractor shall provide appropriate diversion of surface water runoff to prevent erosion of beach area.
16. Within three days of final grading or temporary suspension of work in an area that is in or adjacent to wetlands or surface waters, all exposed soil areas shall be stabilized by seeding and mulching during the growing season, or if not within the growing season, by mulching with tackifiers on slopes less than 3:1 or netting and pinning on slopes steeper than 3:1.
17. A combination of trees, shrubs and ground covers representing the density and species diversity of the vegetation present prior to construction shall be replanted beginning at a distance no greater than 5 feet landward from the beach area.
18. This permit does not authorize the removal of trees or saplings within the waterfront buffer that would result in a tree and sapling point score below the minimum required per RSA 483-B:9, V, (a)(2)(D)(iv).
19. Only those structures shown on the approved plans shall be installed or constructed along this frontage. All portions of the structures shall be at least 20 feet from the abutting property lines or the imaginary extension of those lines into the water.
20. Pilings shall be spaced a minimum of 12 feet apart as measured piling center to piling center.
21. All seasonal structures, including the boatlift, shall be removed for the non-boating season.
22. No work is authorized to the existing breakwater under this permit.

EXPLANATION

The NHDES approved this project on July 05, 2019. The NHDES supported its decision with the following findings:

1. This is a major impact project per Administrative Rule Env-Wt 303.02(d), construction of any dock adjacent to a breakwater.
2. Applicant has provided the NHDES with evidence that the property has insufficient water depth as required by Env-Wt 402.03(b)(2).
3. The NHDES has accepted the evidence of the physical hardship and approved the extension of a permanent pier beyond that permissible under Env-Wt 402.03(a)(1)(b).
4. The applicant has an average of 234 feet of shoreline frontage along Lake Winnepesaukee.
5. The proposed docking facility will provide 3 slips as defined per RSA 482-A:2, VIII and therefore meets Rule Env-Wt 402.13.
6. The NHDES finds that because the project is not of significant public interest and will not significantly impair the resources of Lake Winnepesaukee a public hearing under RSA 482-A:8 is not required.
7. The applicant has provided evidence which demonstrates that this proposal is the alternative with the least adverse impact to areas and environments under the NHDES' jurisdiction per Rule Env-Wt 302.03.

8. The applicant has demonstrated by plan and example that each factor listed in Rule Env-Wt 302.04(a) Requirements for Application Evaluation, has been considered in the design of the project.

Application file documents are being forwarded to the Governor and the Executive Council in connection with their consideration of this matter pursuant to RSA 482-A:3,II.(a) as it is a major project in public waters of the state.

Respectfully submitted,



Robert R. Scott
Commissioner



WETLANDS PERMIT APPLICATION

Water Division/ Wetlands Bureau

Land Resources Management

Check the status of your application: www.des.nh.gov/onestop



Rule RSA 482-A:10, Env-Wt 100.300

RECEIVED
MAR 20 2019
NHDES
LAND RESOURCES MANAGEMENT

COMPLETE

Administrative
MAR 20 2019

File No: 2019-00849
Check No: 1939
Amount: \$1,670.00
Fees: LSL

1. REVIEW TIME: Indicate your Review Time below. To determine review time, refer to Guidance Document A for Instructions.

- Standard Review (Minimum, Minor or Major Impact) Expedited Review (Minimum Impact only)

2. MITIGATION REQUIREMENT:
If mitigation is required, a Mitigation Pre-Application meeting must occur prior to submitting this Wetlands Permit Application. To determine if mitigation is required, please refer to the Determining Mitigation is Required Frequently Asked Questions.

Mitigation Pre-Application Meeting Date: Month: ___ Day: ___ Year: ___

N/A - Mitigation is not required

3. PROJECT LOCATION:
Separate wetland permit applications must be submitted for each municipality within which wetland impacts occur.

ADDRESS: 309 Bear Island TOWN/CITY: Meredith

TAX MAP: 106 BLOCK: 007 LOT: 00B UNIT: 000

USGS TOPO MAP WATERBODY NAME: Lake Winnepesaukee NA STREAM WATERSHED SIZE: NA

LOCATION COORDINATES (if known): Easting: 1,052,188.34 Northing: 414,155.57 Latitude/Longitude UTM State Plane

4. PROJECT DESCRIPTION:
Provide a brief description of the project outlining the scope of work. Attach additional sheets as needed to provide a detailed plan view of your project. Do not exceed 10 sheets. See Attached in the space provided below.

Install a 6ft x 50ft piling supported dock along breakwater and an adjacent 6ft x 31ft piling supported dock connected by a 6ft x 24ft connecting walkway to provide three of the four boatslips this property allows. Additionally, install a 750ft² perched beach along the shore, adjacent to the existing natural beach. Lastly, install a single seasonal boatlift and two seasonal PWC lifts.

5. SHORELINE FRONTAGE:

N/A This does not have shoreline frontage. SHORELINE FRONTAGE: 248.92ft

Shoreline Frontage is calculated by determining the average of the distances of the actual natural navigable shoreline frontage and a straight line drawn between the property lines, both of which are measured at the normal high water line (Env-Wt 101.89).

6. RELATED NHDES LAND RESOURCES MANAGEMENT PERMIT APPLICATIONS ASSOCIATED WITH THIS PROJECT:
Please indicate if any of the following permit applications are required and if required, the status of the application. To determine if other Land Resources Management permits are required, refer to the Land Resources Management Website.

Permit Type	Permit Required	File Number	Permit Application Status
Alteration of Terrain Permit Per RSA 485-A:17	<input type="checkbox"/> YES <input checked="" type="checkbox"/> NO	_____	<input type="checkbox"/> APPROVED <input type="checkbox"/> PENDING <input type="checkbox"/> DENIED
Individual Sewerage Disposal per RSA 485-A:2	<input type="checkbox"/> YES <input checked="" type="checkbox"/> NO	_____	<input type="checkbox"/> APPROVED <input type="checkbox"/> PENDING <input type="checkbox"/> DENIED
Subdivision Approval Per RSA 485-A	<input type="checkbox"/> YES <input checked="" type="checkbox"/> NO	_____	<input type="checkbox"/> APPROVED <input type="checkbox"/> PENDING <input type="checkbox"/> DENIED
Shoreland Permit Per RSA 483-B	<input type="checkbox"/> YES <input checked="" type="checkbox"/> NO	_____	<input type="checkbox"/> APPROVED <input type="checkbox"/> PENDING <input type="checkbox"/> DENIED

7. NATURAL HERITAGE BUREAU & DESIGNATED RIVERS:
See the Instructions & Attachments document for instructions to complete a & b below.

- a. Natural Heritage Bureau File ID: NHB 19 - 0652
- b. This project is within a Designated River corridor. The project is within 1/4 mile of: _____; and date a copy of the application was sent to the Local River Management Advisory Committee: Month: ___ Day: ___ Year: ___
- N/A - This project is not within a Designated River corridor.

lrn@des.nh.gov or (603) 271-2147

NHDES Wetlands Bureau, 29 Hazen Drive, PO Box 95, Concord, NH 03302-0095

www.des.nh.gov

8. APPLICANT INFORMATION - (Desired permit holder)

LAST NAME, FIRST NAME, M.I.: Harris, Norm and Martha

TRUST / COMPANY NAME: N/A

MAILING ADDRESS:

TOWN/CITY:

STATE:

ZIP CODE:

EMAIL or FAX: N/A

PHONE: N/A

ELECTRONIC COMMUNICATION: By Initialing here: N/A, I hereby authorize NHDES to communicate all matters relative to this application electronically.**9. PROPERTY OWNER INFORMATION - (If different than applicant)**

LAST NAME, FIRST NAME, M.I.: Harris, Norm and Martha

TRUST / COMPANY NAME: N/A

MAILING ADDRESS:

TOWN/CITY:

STATE:

ZIP CODE:

EMAIL or FAX: N/A

PHONE: N/A

ELECTRONIC COMMUNICATION: By Initialing here: N/A, I hereby authorize NHDES to communicate all matters relative to this application electronically.**10. AUTHORIZED AGENT INFORMATION**

LAST NAME, FIRST NAME, M.I.: Irving, Jamie C.

COMPANY NAME: Watermark Marine Construction

MAILING ADDRESS: 1218 Union Avenue

TOWN/CITY: Laconia

STATE: NH

ZIP CODE: 03246

EMAIL or FAX: jcl@watermarkmarine.com

PHONE: 603-293-4000

ELECTRONIC COMMUNICATION: By Initialing here: JCI, I hereby authorize NHDES to communicate all matters relative to this application electronically.**11. PROPERTY OWNER SIGNATURE**See the Instructions & Required Attachments document for clarification of the below statements

By signing the application, I am certifying that:

1. I authorize the applicant and/or agent indicated on this form to act in my behalf in the processing of this application, and to furnish upon request, supplemental information in support of this permit application.
2. I have reviewed and submitted information & attachments outlined in the Instructions and Required Attachment document.
3. All abutters have been identified in accordance with RSA 482-A:3, I and Env-Wt 100-900.
4. I have read and provided the required information outlined in Env-Wt 302.04 for the applicable project type.
5. I have read and understand Env-Wt 302.03 and have chosen the least impacting alternative.
6. Any structure that I am proposing to repair/replace was either previously permitted by the Wetlands Bureau or would be considered grandfathered per Env-Wt 101.47.
7. I have submitted a Request for Project Review (RPR) Form (www.nh.gov/nhdhr/review) to the NH State Historic Preservation Officer (SHPO) at the NH Division of Historical Resources to identify the presence of historical/ archeological resources while coordinating with the lead federal agency for National Historic Preservation Act (NHPA) 106 compliance.
8. I authorize NHDES and the municipal conservation commission to inspect the site of the proposed project.
9. I have reviewed the information being submitted and that to the best of my knowledge the information is true and accurate.
10. I understand that the willful submission of falsified or misrepresented information to the NHDES is a criminal act, which may result in legal action.
11. I am aware that the work I am proposing may require additional state, local or federal permits which I am responsible for obtaining.
12. The mailing addresses I have provided are up to date and appropriate for receipt of NHDES correspondence. NHDES will not forward returned



Property Owner Signature
Norman H. Harris
Print name legibly3/8/19
Date

lrm@des.nh.gov or (603) 271-2147

NHDES Wetlands Bureau, 29 Hazen Drive, PO Box 95, Concord, NH 03302-0095

www.des.nh.gov

MUNICIPAL SIGNATURES

12. CONSERVATION COMMISSION SIGNATURE

The signature below certifies that the municipal conservation commission has reviewed this application, and:

1. Waives its right to intervene per RSA 482-A:11
2. Believes that the application and submitted plans accurately represent the proposed project, and
3. Has no objection to permitting the proposed work.

Print name legibly

Date

DIRECTIONS FOR CONSERVATION COMMISSION

1. Expedited review ONLY requires that the conservation commission's signature is obtained in the space above.
2. Expedited review requires the Conservation Commission signature be obtained prior to the submittal of the original application to the Town/City Clerk for signature.
3. The Conservation Commission may refuse to sign. If the Conservation Commission does not sign this statement for any reason, the application is not eligible for expedited review and the application will be reviewed in the standard review time frame.

13. TOWN / CITY CLERK SIGNATURE

As required by Chapter 482-A:3 (amended 2014), I hereby certify that the applicant has filed four application forms, four detailed plans, and four USGS location maps with the town/city indicated below.

Print name legibly

Town/City

Date

DIRECTIONS FOR TOWN/CITY CLERK:

Per RSA 482-A:3,

1. For applications where "Expedited Review" is checked on page 1, if the Conservation Commission signature is not present, NHDES will accept the permit application, but it will NOT receive the expedited review time.
2. IMMEDIATELY sign the original application form and four copies in the signature space provided above;
3. Return the signed original application form and attachments to the applicant so that the applicant may submit the application form and attachments to NHDES by mail or hand delivery.
4. IMMEDIATELY distribute a copy of the application with one complete set of attachments to each of the following bodies: the municipal Conservation Commission, the local governing body (Board of Selectmen or Town/City Council), and the Planning Board; and
5. Retain one copy of the application form and one complete set of attachments and make them reasonably accessible for public review.

DIRECTIONS FOR APPLICANT:

1. Submit the single, original permit application form bearing the signature of the Town/ City Clerk, additional materials, and the application fee to NHDES by mail or hand delivery.

lrn@des.nh.gov or (603) 271-2147

NHDES Wetlands Bureau, 29 Hazen Drive, PO Box 95, Concord, NH 03302-0095

www.des.nh.gov

14 IMPACT AREA
 For each jurisdictional area that will be/has been impacted, provide square feet and, if applicable, linear feet of impact.
Permanent impacts (that will remain after the project is complete)
Temporary impacts (not intended to remain, and will be restored to pre-construction conditions) after the project is completed.
Intermittent Streams: linear footage distance of disturbance is measured along the thread of the channel.
Perennial Streams/Rivers: the total linear footage distance is calculated by summing the lengths of disturbance to the channel and each bank.

JURISDICTIONAL AREA	PERMANENT		TEMPORARY	
	Sq. Ft. / Un. Ft.		Sq. Ft. / Un. Ft.	
Forested wetland		<input type="checkbox"/> ATF		<input type="checkbox"/> ATF
Scrub-shrub wetland		<input type="checkbox"/> ATF		<input type="checkbox"/> ATF
Emergent wetland		<input type="checkbox"/> ATF		<input type="checkbox"/> ATF
Wet meadow		<input type="checkbox"/> ATF		<input type="checkbox"/> ATF
Intermittent stream channel	/	<input type="checkbox"/> ATF	/	<input type="checkbox"/> ATF
Perennial Stream / River channel	/	<input type="checkbox"/> ATF	/	<input type="checkbox"/> ATF
Lake / Pond	/	<input type="checkbox"/> ATF	/	<input type="checkbox"/> ATF
Bank - Intermittent stream	/	<input type="checkbox"/> ATF	/	<input type="checkbox"/> ATF
Bank - Perennial stream / River	/	<input type="checkbox"/> ATF	/	<input type="checkbox"/> ATF
Bank - Lake / Pond	750 /	<input type="checkbox"/> ATF	300 /	<input type="checkbox"/> ATF
Tidal water	/	<input type="checkbox"/> ATF	/	<input type="checkbox"/> ATF
Salt marsh		<input type="checkbox"/> ATF		<input type="checkbox"/> ATF
Sand dune		<input type="checkbox"/> ATF		<input type="checkbox"/> ATF
Prime wetland		<input type="checkbox"/> ATF		<input type="checkbox"/> ATF
Prime wetland buffer		<input type="checkbox"/> ATF		<input type="checkbox"/> ATF
Undeveloped Tidal Buffer Zone (TBZ)		<input type="checkbox"/> ATF		<input type="checkbox"/> ATF
Previously-developed upland in TBZ		<input type="checkbox"/> ATF		<input type="checkbox"/> ATF
Docking - Lake / Pond	630	<input type="checkbox"/> ATF		<input type="checkbox"/> ATF
Docking - River		<input type="checkbox"/> ATF		<input type="checkbox"/> ATF
Docking - Tidal Water		<input type="checkbox"/> ATF		<input type="checkbox"/> ATF
Vernal Pool		<input type="checkbox"/> ATF		<input type="checkbox"/> ATF
TOTAL	1,380 /		300 /	

15 APPLICATION FEE: See the Instructions & Required Attachments document for further instruction.

Minimum Impact Fee: Flat fee of \$200

Minor or Major Impact Fee: Calculate using the below table below

Permanent and Temporary (non-docking) 1,050 sq. ft. X \$0.20 = \$ 210.00

Temporary (seasonal) docking structure: sq. ft. X \$1.00 = \$

Permanent docking structure: 630 sq. ft. X \$2.00 = \$ 1,260.00

Projects proposing shoreline structures (including docks) add \$200 = \$ 200.00

Total = \$ 1,670.00

The Application Fee is the above calculated Total or \$200, whichever is greater = \$ 1,670.00

lrm@des.nh.gov or (603) 271-2147

NHDES Wetlands Bureau, 29 Hazen Drive, PO Box 95, Concord, NH 03302-0095

www.des.nh.gov

PROPERTY MAP
MEREDITH
NEW HAMPSHIRE

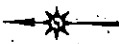

LEGEND

1/4" = 100' Scale	R11	1/4" = 100' Scale	1/4" = 100' Scale
1/4" = 100' Scale	74	1/4" = 100' Scale	1/4" = 100' Scale
1/4" = 100' Scale	1/4" = 100' Scale	1/4" = 100' Scale	1/4" = 100' Scale
1/4" = 100' Scale	1/4" = 100' Scale	1/4" = 100' Scale	1/4" = 100' Scale

SCALE IN FEET
0 100 200

John E. O'Donnell & Associates
633 Bald Hill Road
New Gloucester, Maine 04320

106

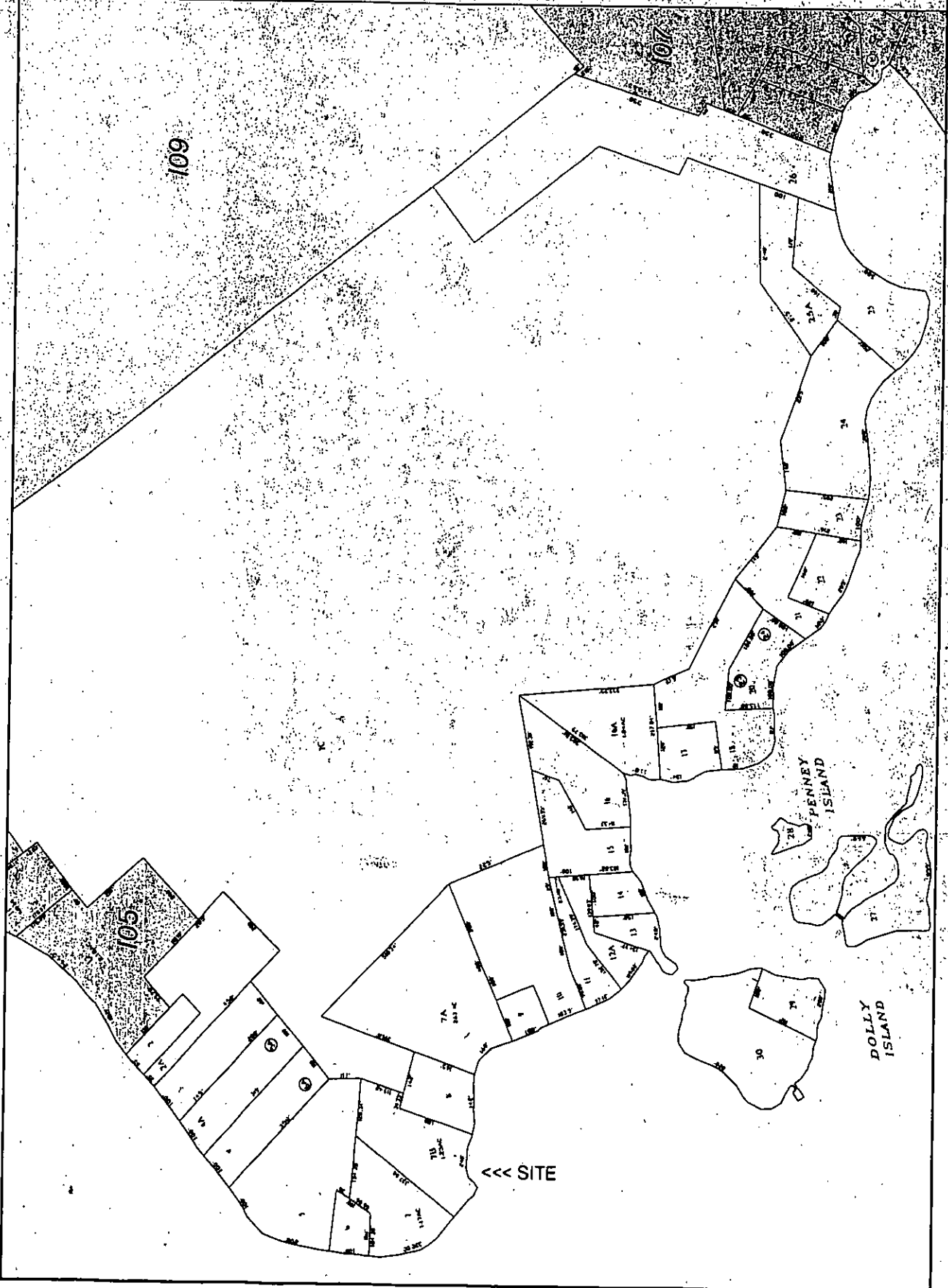

Harris Property

Legend

- State
- County
- City/Town

X: 1052188.340000
Y: 414155.570001

Map Scale
1: 10,000



© NH GRANIT, www.granit.unh.edu
Map Generated: 3/4/2019

Notes

Norm and Martha Harris
309 Bear Island, Meredith
T.M.L. #108-007-00B
NH Stateplane NAD83 (feet)
Easting: 1,052,188.34
Northing: 414,155.57

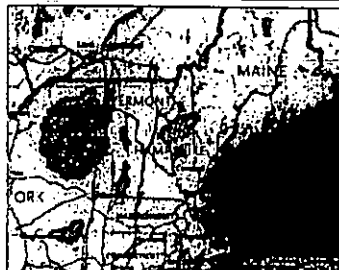



NEW HAMPSHIRE NATURAL HERITAGE BUREAU
NHB DATACHECK RESULTS LETTER

To: Jamie Irving
1218 Union Avenue
Laconia, NH 03246

From: NH Natural Heritage Bureau

Date: 2/27/2019 (valid for one year from this date)

Re: Review by NH Natural Heritage Bureau of request submitted 2/22/2019

NHB File ID: NHB19-0652

Applicant: Norm and Martha Harris

Location: Meredith
Tax Maps: 106-007-00B

Project Description: Install a "U" shaped piling dock adjacent to an existing breakwater. Install a perched beach landward of an existing natural beach where lawn currently exists. Add 2 seasonal jet ski lifts and 1 boat lift.

The NH Natural Heritage database has been checked by staff of the NH Natural Heritage Bureau and/or the NH Nongame and Endangered Species Program for records of rare species and exemplary natural communities near the area mapped below. The species considered include those listed as Threatened or Endangered by either the state of New Hampshire or the federal government.

It was determined that, although there was a NHB record (e.g., rare wildlife, plant, and/or natural community) present in the vicinity, we do not expect that it will be impacted by the proposed project. This determination was made based on the project information submitted via the NHB Datacheck Tool on 2/22/2019, and cannot be used for any other project.



NEW HAMPSHIRE NATURAL HERITAGE BUREAU
NHB DATACHECK RESULTS LETTER

MAP OF PROJECT BOUNDARIES FOR: NHB19-0652

NHB19-0652

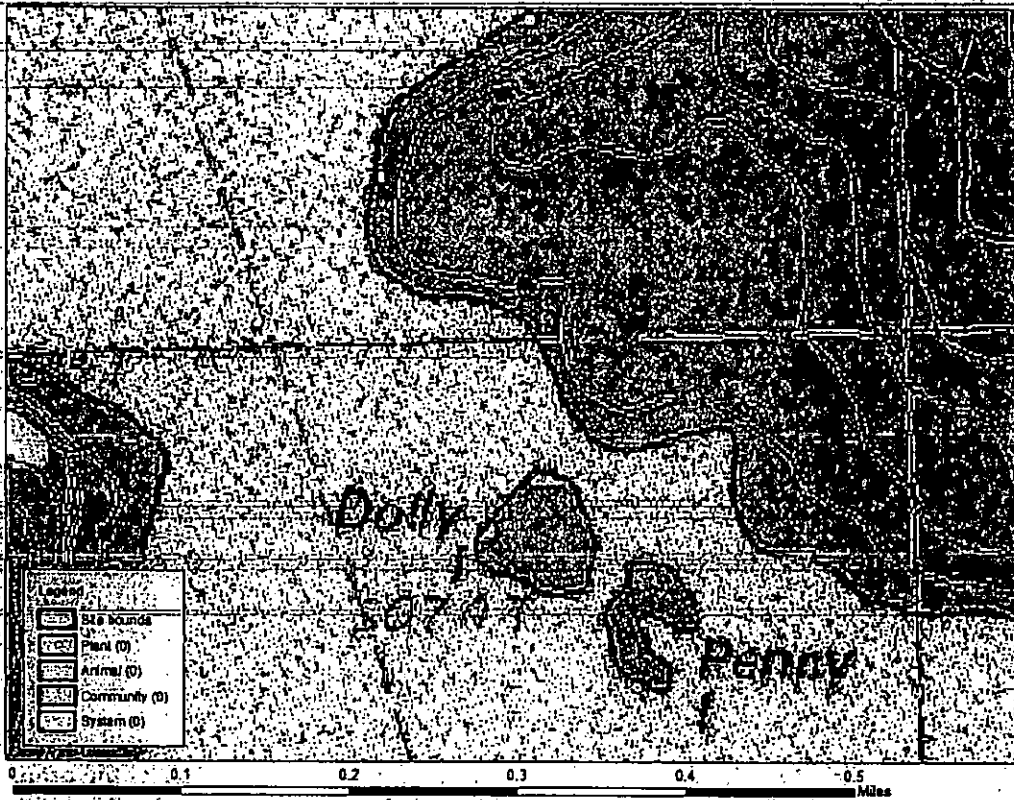

Abutter List

TM/L #I06-007-00B

Norm and Martha Harris

#I06-005-000

Braford and Holton Falk

#I06-007-000

David Lemieux

#I06-007-00G

Braford and Holton Falk

#I06-008-000

Amy Poole and Katherine Fong

7018 3090 0001 1358 4239

U.S. Postal Service™
CERTIFIED MAIL® RECEIPT
Domestic Mail Only

For delivery information, visit our website at www.usps.com™.

OFFICIAL USE

Certified Mail Fee	\$ 3.50
Extra Services & Fees (check box, add fee as appropriate)	
<input type="checkbox"/> Return Receipt (hardcopy)	\$ _____
<input type="checkbox"/> Return Receipt (electronic)	\$ _____
<input type="checkbox"/> Certified Mail Restricted Delivery	\$ _____
<input type="checkbox"/> Adult Signature Required	\$ _____
<input type="checkbox"/> Adult Signature Restricted Delivery	\$ _____
Postage	\$.50
Total Postage and Fees	\$ 4.00

Postmark Here
C-13
3/11/19

Braford and Holton Falk
452 Hampshire Road
Drexel Hall, PA 19026-1304

7018 3090 0001 1358 4222

U.S. Postal Service™
CERTIFIED MAIL® RECEIPT
Domestic Mail Only

For delivery information, visit our website at www.usps.com™.

OFFICIAL USE

Certified Mail Fee	\$ 3.50
Extra Services & Fees (check box, add fee as appropriate)	
<input type="checkbox"/> Return Receipt (hardcopy)	\$ _____
<input type="checkbox"/> Return Receipt (electronic)	\$ _____
<input type="checkbox"/> Certified Mail Restricted Delivery	\$ _____
<input type="checkbox"/> Adult Signature Required	\$ _____
<input type="checkbox"/> Adult Signature Restricted Delivery	\$ _____
Postage	\$.50
Total Postage and Fees	\$ 4.00

Postmark Here
C-13
3/11/19

David Lemieux
15 Comstock Drive
Wrentham, MA 02093

7018 3090 0001 1358 4215

U.S. Postal Service™
CERTIFIED MAIL® RECEIPT
Domestic Mail Only

For delivery information, visit our website at www.usps.com™.

OFFICIAL USE

Certified Mail Fee	\$ 3.50
Extra Services & Fees (check box, add fee as appropriate)	
<input type="checkbox"/> Return Receipt (hardcopy)	\$ _____
<input type="checkbox"/> Return Receipt (electronic)	\$ _____
<input type="checkbox"/> Certified Mail Restricted Delivery	\$ _____
<input type="checkbox"/> Adult Signature Required	\$ _____
<input type="checkbox"/> Adult Signature Restricted Delivery	\$ _____
Postage	\$.50
Total Postage and Fees	\$ 4.00

Postmark Here
C-13
3/11/19

Amy Poole and Katherine Fong
399 Bean Hill Road
Northfield, NH 03276

Lake Winnepesaukee

Full Lake Shoreline 504.32

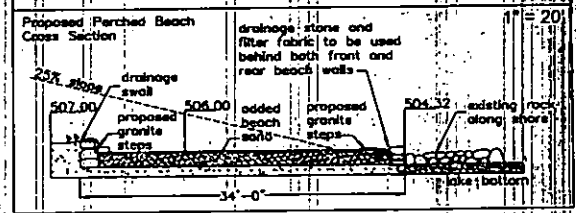
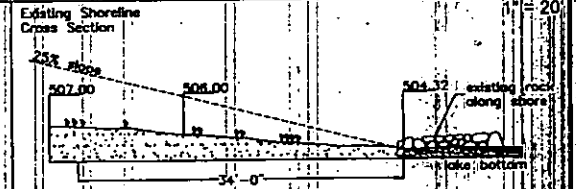
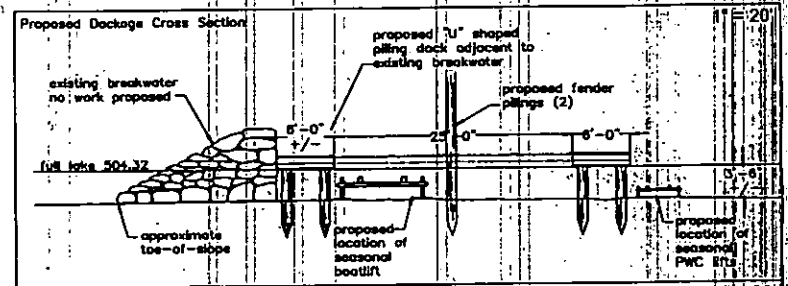
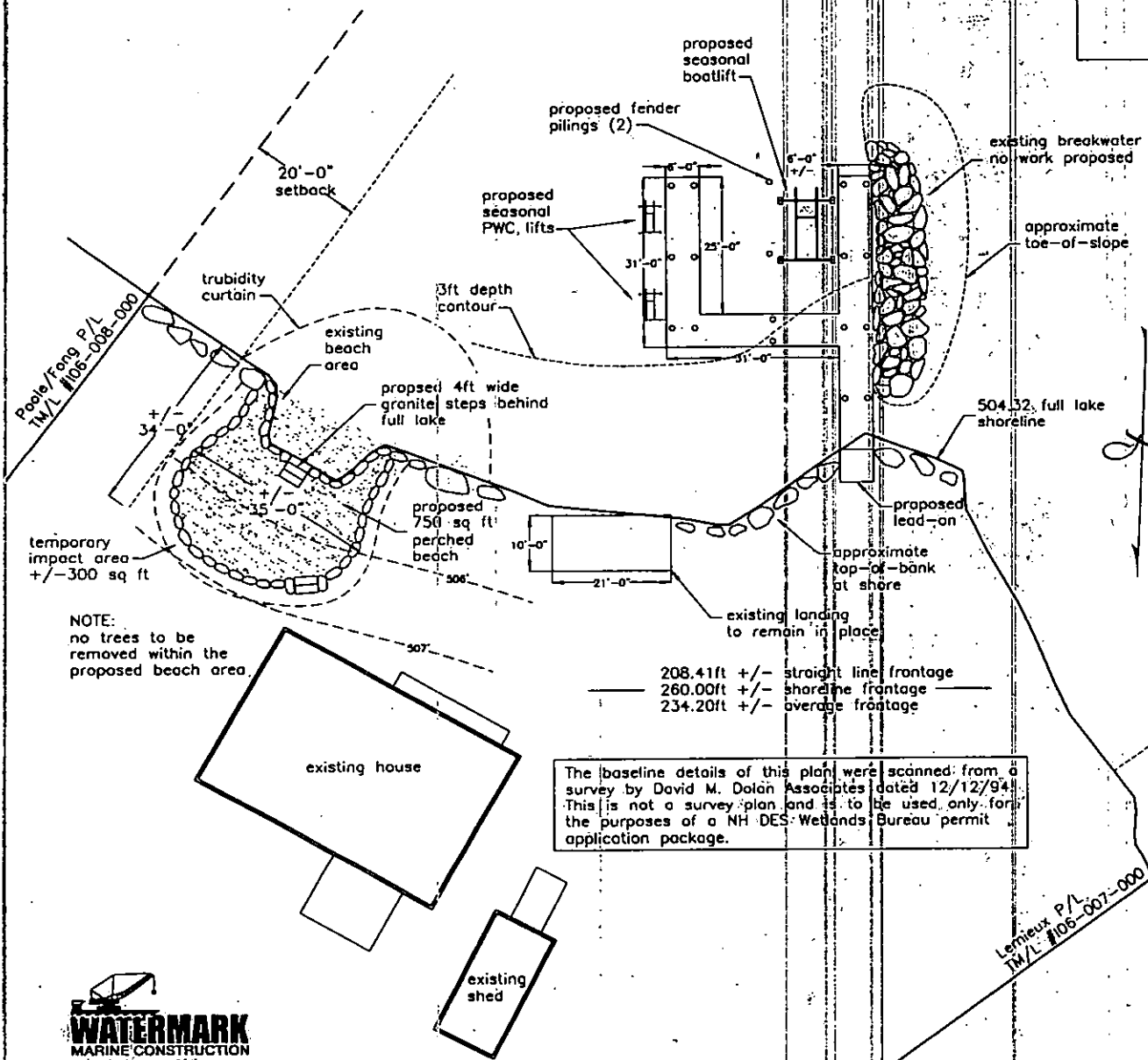

The baseline details of this plan were scanned from a survey by David M. Dolan Associates dated 12/12/94. This is not a survey plan and is to be used only for the purposes of a NH DES Wetlands Bureau permit application package.

RECEIVED
JUN 12 2019
NHDES
LAND RESOURCES MANAGEMENT

Harris Property
Proposed Conditions
Meredith, NH
02/14/19 1" = 30'

REV: 06/04/19