



The State of New Hampshire
Department of Environmental Services



Sam
124

Robert R. Scott, Commissioner

May 10, 2018

His Excellency, Governor Christopher T. Sununu
 and The Honorable Council
 State House
 Concord, NH 03301

REQUESTED ACTION

Approve Richard LeSavoy 2013 Revocable Trust's request to perform the following work on the Lamprey River, in Newmarket. File # 2018-00223. This project will not have significant impact on or adversely affect the values of the Lamprey River.

Impact 451 square feet within the upland tidal buffer zone for construction of a 4 foot wide x 112.7 foot long wooden walkway and staircase accessway and impact 363 square feet of tidal wetland to construct a tidal docking structure consisting of a 4 foot wide x 20 foot long permanent pier connecting to a 3 foot wide x 30 foot long seasonal gangway and a 10 foot x 20 foot seasonal float. The overall structure length seaward of the highest observable tide line is 66 feet, providing two slips on 125 feet of frontage, on the Lamprey River, in Newmarket.

The New Hampshire Department of Environmental Services (NHDES) imposed the following conditions as part of this approval:

1. All work shall be in accordance with plans by Ambit Engineering, Inc. dated November 2017, and revised through March 16, 2018 as received by the NHDES on March 19, 2018.
2. This permit shall not be effective until recorded at the Rockingham County Registry of Deeds office by the permittee. A copy of the recorded permit shall be submitted to the NHDES Wetlands Bureau prior to the commencement of construction.
3. Not less than 5 state business days prior to starting work authorized by this permit, the permittee shall notify the NHDES Wetlands Bureau Pease office and the local conservation commission in writing of the date on which work under this permit is expected to start.
4. There shall be no removal of mature trees along the shoreline of the river on this property associated with the construction of the dock and access way.
5. In accordance with the approved plans and project narrative, there shall be no grading or excavation of the shoreline associated with the construction of the access way and installation of the docking structure.
6. This tidal docking structure consisting of a 4 foot wide x 112.7 foot long wooden walkway and staircase to a 4 foot wide x 20 foot long permanent pier connecting to a 3 foot wide x 30 foot long seasonal gangway and a 10 foot x 20 foot seasonal float, the overall structure length seaward of the highest observable tide line is 73 feet (including helical moorings), providing two slips on 125 feet of frontage, shall be the only structure on the frontage.
7. The height of the pier's decking over the surface of the tidal wetland at normal high tide shall be equal to or greater than the width of the decking.
8. Decking shall have at least 3/4-inch spacing between the decking planks to provide sufficient sunlight penetration and rainfall to underlying vegetation.

www.des.nh.gov

29 Hazen Drive • PO Box 95 • Concord, NH 03302-0095

NHDES Main Line: (603) 271-3503 • Subsurface Fax: (603) 271-6683 • Wetlands Fax: (603) 271-6588

TDD Access: Relay NH 1 (800) 735-2964

9. The seasonal structures, including but not limited to the gangway and float, shall be removed during the non-boating season and stored on the existing pier or in an upland location.
10. Any future work in jurisdiction as specified in RSA 482-A or RSA 483-B on this property will require a new application and approval by the NHDES Wetlands Bureau.
11. No person undertaking any activity shall cause or contribute to, or allow the activity to cause or contribute to, any violations of the surface water quality standards in RSA 485-A and New Hampshire Administrative Rule Env-Wq 1700.
12. Appropriate siltation and erosion controls shall be in place prior to construction, shall be maintained during construction, and shall remain in place until the area is stabilized. Temporary controls shall be removed once the area has been stabilized.
13. Construction of the dock shall occur from a barge equipped with a crane, at low tide, to reduce potential impacts to the river bank and the estuarine intertidal and subtidal wetlands.
14. Pile driving or pile removal work shall be done during low tide.
15. Pilings to be removed shall be cut level with the substrate rather than pulled, in order to limit the creation of turbidity.
16. All work shall be conducted in a manner so as to minimize turbidity and sedimentation to surface waters and wetlands.
17. All work shall be conducted in a manner that avoids excessive discharge of sediment to fish spawning areas.
18. All construction-related debris shall be properly disposed of outside of the areas subject to RSA 482-A.

EXPLANATION

The NHDES Wetlands Bureau approved this project on April 10, 2018. The NHDES supported its decision with the following findings:

1. This is a Major Project per New Hampshire Administrative Rule Env-Wt 303.02(a), projects in sand dunes, tidal wetlands, or bogs, except for the repair of existing structures pursuant to New Hampshire Administrative Rule Env-Wt 303.04(v).
2. The need for the proposed impacts has been demonstrated by the applicant per New Hampshire Administrative Rule Env-Wt 302.01.
3. There is currently no dock present on the frontage.
4. The applicant has provided evidence which demonstrates that this proposal is the alternative with the least adverse impact to areas and environments under the department's jurisdiction per New Hampshire Administrative Rule Env-Wt 302.03.
5. The dock is the minimum length necessary to provide access at this location and float stops will prevent the dock from sitting on the mud at low tide.
6. The applicant has demonstrated by plan and example that each factor listed in New Hampshire Administrative Rule Env-Wt 302.04(a) and (c), Requirements for Application Evaluation, has been considered in the design of the project.
7. In correspondence dated February 14, 2018, the Lamprey River Local River Advisory Committee submitted written comment to NHDES on the project and expressed concerns for the deterioration of the quality of aquatic vegetation.
8. Based on the comments provided by the Natural Heritage Bureau (NHB) and also that the design incorporates a 1:1 height to width ratio of the pier, the NHDES finds that the applicant has minimized impacts to aquatic vegetation to the maximum extent practicable.

9. The NHB report submitted with the application package (NHB17-3541) identified potential impacts to exemplary natural communities and threatened or endangered plant species including: low brackish riverbank marsh; sparsely vegetated intertidal system, and subtidal systems plus five state-listed endangered plant species, including: Atlantic mudwort, eastern grasswort, perennial saltmarsh American-aster, seaside brookweed and Tundra Alkali grass.
10. In correspondence dated March 15, 2018, the NHB emphasized the importance of minimizing impacts to vegetation in the project area and determined that the project, as proposed, would have minimal impact to the resource.
11. In correspondence dated January 30, 2018, the Pease Development Authority, Division of Ports and Harbors, determined that the project would have no negative effect on navigation in the channel.
12. This dock is consistent with other tidal dock facility approvals in the seacoast.
13. The NHDES inspection of the site on March 30, 2018 found that plans accurately depicted field conditions and the proposed design would not obstruct near-shore navigation.

Application file documents are being forwarded to the Governor and Executive Council in connection with their consideration of this matter pursuant to RSA 482-A:3,II.(a) as it is a major project in public waters of the state.

We respectfully submit this request for your consideration.

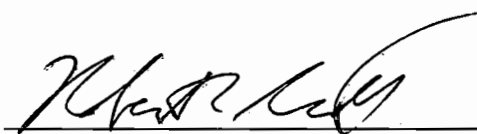

Robert R. Scott
Commissioner



WETLANDS PERMIT APPLICATION

Land Resources Management
Wetlands Bureau

Check the status of your application: www.des.nh.gov/onestop



RSA/Rule: RSA 482-A/ Env-Wt 100-900

	<p align="center">COMPLETE JAN 25 2018</p> <p align="center">DESIGNATED RIVER</p>	2018-00223
		9150
		\$726.20
		Emk

1. REVIEW TIME REVIEW UNDER RSA 483
 Indicate your Review Time below. Refer to Guidance Document A for instructions.

Standard Review (Minimum, Minor or Major Impact) Expedited Review (Minimum Impact only)

2. PROJECT LOCATION:
 Separate applications must be filed with each municipality that jurisdictional impacts will occur in.

ADDRESS: **14 Birch Drive** TOWN/CITY: **Newmarket**

TAX MAP: **U3** BLOCK: LOT: **93** UNIT:

USGS TOPO MAP WATERBODY NAME: **Lamprey River** NA STREAM WATERSHED SIZE: NA

LOCATION COORDINATES (if known): **X:1,181,916.6194 Y:209,212.2364** Latitude/Longitude UTM State Plane

3. PROJECT DESCRIPTION:
 Provide a brief description of the project outlining the scope of work. Attach additional sheets as needed to provide a detailed explanation of your project. DO NOT reply "See Attached" in the space provided below.

The project proposes 363 sq. ft. of permanent impact to tidal wetlands for construction of a tidal docking structure consisting of a 4' x 20' fixed pier, a 3' x 30' aluminum gangway, and 10' x 20' float located by moorings (overall structure length 70') providing two slips on 125 feet of shoreline frontage. The project also proposes 451 sq.ft. of permanent impact to the previously developed 100' Tidal Buffer Zone for an elevated wooden walkway to provide foot access to the tidal docking structure.

4. SHORELINE FRONTAGE

NA This lot has no shoreline frontage. SHORELINE FRONTAGE: **125 feet**

Shoreline frontage is calculated by determining the average of the distances of the actual natural navigable shoreline frontage and a straight line drawn between the property lines, both of which are measured at the normal high water line.

5. RELATED PERMITS, ENFORCEMENT, EMERGENCY AUTHORIZATION, SHORELAND, ALTERATION OF TERRAIN, ETC

6. NATURAL HERITAGE BUREAU & DESIGNATED RIVERS:
 See the Instructions & Required Attachments document for instructions to complete a & b below.

a. Natural Heritage Bureau File ID: NHB 17 - 3541

b. Designated River the project is in ¼ miles of: _____; and
 date a copy of the application was sent to the Local River Management Advisory Committee: Month: ___ Day: ___ Year: ___

NA

7. APPLICANT INFORMATION (Desired permit holder)LAST NAME, FIRST NAME, M.I.: **LeSavoy, Richard**TRUST / COMPANY NAME: **Richard LeSavoy 2013 Revocable Trust**

MAILING ADDRESS: [REDACTED]

TOWN/CITY: **Newmarket**STATE: **NH**ZIP CODE: **03857**

EMAIL or FAX: [REDACTED]

PHONE: [REDACTED]

ELECTRONIC COMMUNICATION: By initialing here: _____, I hereby authorize NHDES to communicate all matters relative to this application electronically

8. PROPERTY OWNER INFORMATION (If different than applicant)

LAST NAME, FIRST NAME, M.I.:

TRUST / COMPANY NAME:

MAILING ADDRESS:

TOWN/CITY:

STATE:

ZIP CODE:

EMAIL or FAX:

PHONE:

ELECTRONIC COMMUNICATION: By initialing here _____, I hereby authorize NHDES to communicate all matters relative to this application electronically

9. AUTHORIZED AGENT INFORMATIONLAST NAME, FIRST NAME, M.I.: **Riker, Steven, D.**COMPANY NAME: **Ambit Engineering, Inc.**MAILING ADDRESS: **200 Griffin Road, Unit 3**TOWN/CITY: **Portsmouth**STATE: **NH**ZIP CODE: **03801**EMAIL or FAX: **sdr@ambitengineering.com**PHONE: **603-430-9282**ELECTRONIC COMMUNICATION: By initialing here *SR*, I hereby authorize NHDES to communicate all matters relative to this application electronically**10. PROPERTY OWNER SIGNATURE**

See the Instructions & Required Attachments document for clarification of the below statements

By signing the application, I am certifying that:

1. I authorize the applicant and/or agent indicated on this form to act in my behalf in the processing of this application, and to furnish upon request, supplemental information in support of this permit application.
2. I have reviewed and submitted information & attachments outlined in the Instructions and Required Attachment document.
3. All abutters have been identified in accordance with RSA 482-A:3, I and Env-Wt 100-900.
4. I have read and provided the required information outlined in Env-Wt 302.04 for the applicable project type.
5. I have read and understand Env-Wt 302.03 and have chosen the least impacting alternative.
6. Any structure that I am proposing to repair/replace was either previously permitted by the Wetlands Bureau or would be considered grandfathered per Env-Wt 101.47.
7. I have submitted a Request for Project Review (RPR) Form (www.nh.gov/nhdhr/review) to the NH State Historic Preservation Officer (SHPO) at the NH Division of Historical Resources to identify the presence of historical/ archeological resources while coordinating with the lead federal agency for NHPA 106 compliance.
8. I authorize NHDES and the municipal conservation commission to inspect the site of the proposed project.
9. I have reviewed the information being submitted and that to the best of my knowledge the information is true and accurate.
10. I understand that the willful submission of falsified or misrepresented information to the New Hampshire Department of Environmental Services is a criminal act, which may result in legal action.
11. I am aware that the work I am proposing may require additional state, local or federal permits which I am responsible for obtaining.

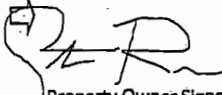
 Property Owner Signature	Agent-See Authorization Steven D. Riker Print name legibly	1 / 24 / 18 Date
---	--	----------------------------

MUNICIPAL SIGNATURES

11. CONSERVATION COMMISSION SIGNATURE

The signature below certifies that the municipal conservation commission has reviewed this application, and:

1. Waives its right to intervene per RSA 482-A:11;
2. Believes that the application and submitted plans accurately represent the proposed project; and
3. Has no objection to permitting the proposed work.

	Print name legibly	Date
--	--------------------	------

DIRECTIONS FOR CONSERVATION COMMISSION

1. Expedited review ONLY requires that the conservation commission's signature is obtained in the space above.
2. Expedited review requires the Conservation Commission signature be obtained prior to the submittal of the original application to the Town/City Clerk for signature.
3. The Conservation Commission may refuse to sign. If the Conservation Commission does not sign this statement for any reason, the application is not eligible for expedited review and the application will reviewed in the standard review time frame.

12. TOWN / CITY CLERK SIGNATURE

As required by Chapter 482-A:3 (amended 2014), I hereby certify that the applicant has filed four application forms, four detailed plans, and four USGS location maps with the town/city indicated below.

	Terri J. Littlefield	NEUMARLET	Jan 24, 2018
Town/City Clerk Signature	Print name legibly	Town/City	Date

DIRECTIONS FOR TOWN/CITY CLERK:

Per RSA 482-A:3,

1. For applications where "Expedited Review" is checked on page 1, if the Conservation Commission signature is not present, NHDES will accept the permit application, but it will NOT receive the expedited review time.
2. IMMEDIATELY sign the original application form and four copies in the signature space provided above;
3. Return the signed original application form and attachments to the applicant so that the applicant may submit the application form and attachments to NHDES by mail or hand delivery.
4. IMMEDIATELY distribute a copy of the application with one complete set of attachments to each of the following bodies: the municipal Conservation Commission, the local governing body (Board of Selectmen or Town/City Council), and the Planning Board; and
5. Retain one copy of the application form and one complete set of attachments and make them reasonably accessible for public review.

DIRECTIONS FOR APPLICANT:

1. Submit the single, original permit application form bearing the signature of the Town/ City Clerk, additional materials, and the application fee to NHDES by mail or hand delivery.

13. IMPACT AREA			
For each jurisdictional area that will be/has been impacted, provide square feet and, if applicable, linear feet of impact.			
Permanent impacts that will remain after the project is complete			
Temporary impacts not intended to remain (and will be restored to pre-construction conditions) after the project is complete			
JURISDICTIONAL AREA	PERMANENT Sq. Ft. / Lin. Ft.		TEMPORARY Sq. Ft. / Lin. Ft.
Forested wetland		<input type="checkbox"/> ATF	<input type="checkbox"/> ATF
Scrub-shrub wetland		<input type="checkbox"/> ATF	<input type="checkbox"/> ATF
Emergent wetland		<input type="checkbox"/> ATF	<input type="checkbox"/> ATF
Wet meadow		<input type="checkbox"/> ATF	<input type="checkbox"/> ATF
Intermittent stream		<input type="checkbox"/> ATF	<input type="checkbox"/> ATF
Perennial Stream / River	/	<input type="checkbox"/> ATF	/
Lake / Pond	/	<input type="checkbox"/> ATF	/
Bank - Intermittent stream	/	<input type="checkbox"/> ATF	/
Bank - Perennial stream / River	/	<input type="checkbox"/> ATF	/
Bank - Lake / Pond	/	<input type="checkbox"/> ATF	/
Tidal water	/	<input type="checkbox"/> ATF	/
Salt marsh		<input type="checkbox"/> ATF	<input type="checkbox"/> ATF
Sand dune		<input type="checkbox"/> ATF	<input type="checkbox"/> ATF
Prime wetland		<input type="checkbox"/> ATF	<input type="checkbox"/> ATF
Prime wetland buffer		<input type="checkbox"/> ATF	<input type="checkbox"/> ATF
Undeveloped Tidal Buffer Zone (TBZ)		<input type="checkbox"/> ATF	<input type="checkbox"/> ATF
Previously-developed upland in TBZ		<input type="checkbox"/> ATF	451
Docking - Lake / Pond		<input type="checkbox"/> ATF	<input type="checkbox"/> ATF
Docking - River		<input type="checkbox"/> ATF	<input type="checkbox"/> ATF
Docking - Tidal Water	363	<input type="checkbox"/> ATF	<input type="checkbox"/> ATF
TOTAL	363 /		451 /

14. APPLICATION FEE: See the Instructions & Required Attachments document for further instruction.

Minimum Impact Fee: Flat fee of \$ 200

Minor or Major Impact Fee: Calculate using the below table below

Permanent and Temporary (non-docking)	<u>451 sq. ft.</u>	X \$0.20 =	<u>\$ 90.20</u>
Temporary (seasonal) docking structure:	<u>290 sq. ft.</u>	X \$1.00 =	<u>\$ 290.00</u>
Permanent docking structure:	<u>73 sq. ft.</u>	X \$2.00 =	<u>\$ 146.00</u>
Projects proposing shoreline structures (including docks) add \$200 =			<u>\$ 200.00</u>
Total =			<u>\$ 726.20</u>

The Application Fee is the above calculated Total or \$200, whichever is greater = \$

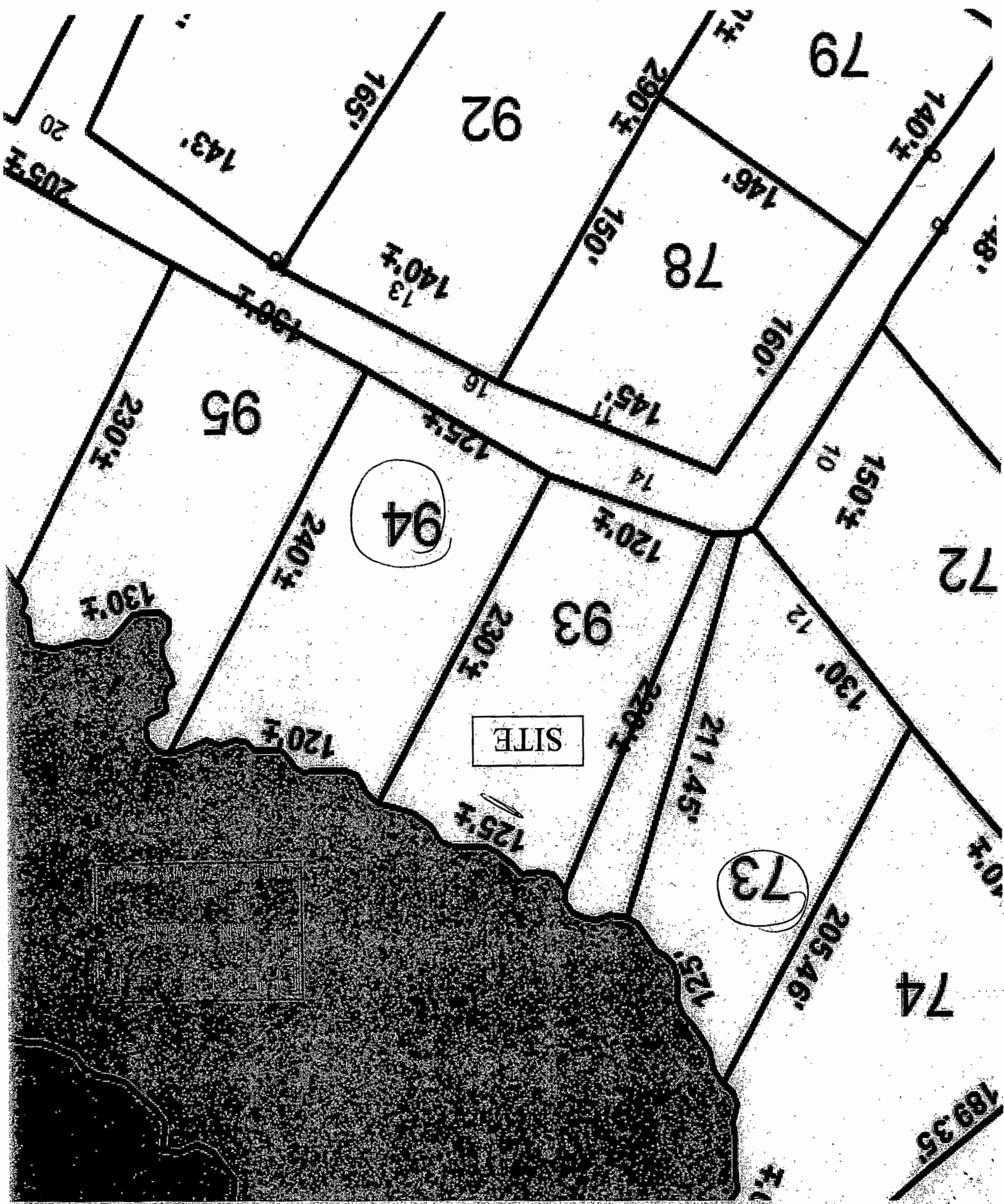

Map by NH GRANIT



Legend

- State
- County
- City/Town

RECEIVED
JAN 25 2018
NHDES
LAND RESOURCES MANAGEMENT

Map Scale

1: 25,977



© NH GRANIT, www.granit.unh.edu

Map Generated: 11/28/2017

Notes

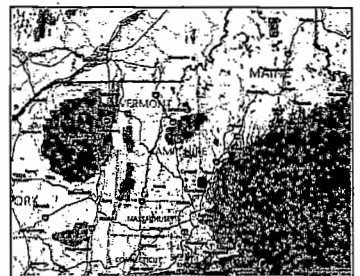

Memo



NH NATURAL HERITAGE BUREAU
NHB DATACHECK RESULTS LETTER

To: John Chagnon, Ambit Engineering, Inc
200 Griffin Road
Unit 3
Portsmouth, NH 03801

From: Amy Lamb, NH Natural Heritage Bureau
Date: 12/5/2017 (valid for one year from this date)
Re: Review by NH Natural Heritage Bureau

NHB File ID: NHB17-3541 Town: Newmarket Location: Tax Maps: Tax Map U3, Lot 93
Description: The project proposes a tidal docking structure to provide safe boating access to the Lamprey River.

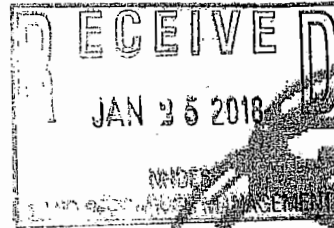

As requested, I have searched our database for records of rare species and exemplary natural communities, with the following results:

Comments: There are several sensitive plant species and exemplary natural communities associated with this portion of the river. Please send a site plan of existing and proposed conditions, site photos (if available), and detail how impacts to rare plant populations will be avoided/minimized. NHB may recommend rare plant species surveys prior to construction.

Natural Community	State	Federal	Notes
Low brackish riverbank marsh*	--	--	Threats to these communities are primarily alterations to the hydrology of the wetland (such as ditching or tidal restrictions that might affect the sheet flow of tidal waters across the intertidal flat) and increased input of nutrients and pollutants in storm runoff.
Sparsely vegetated intertidal system	--	--	Threats to these communities are primarily alterations to the hydrology of the wetland (such as alterations that might affect the sheet flow of tidal waters across the intertidal flat) and increased input of nutrients and pollutants in storm runoff.
Subtidal system	--	--	Threats to these communities are primarily alterations to the hydrology of the wetland (such as alterations that might affect the sheet flow of tidal waters across the intertidal flat) and increased input of nutrients and pollutants in storm runoff.
Plant species	State ¹	Federal	Notes
Atlantic mudwort (<i>Limosella australis</i>)*	E	--	Occurs on tidal mud flats and sandy or muddy shores. Sensitive to siltation and declines in water quality.
eastern grasswort (<i>Lilaeopsis chinensis</i>)*	E	--	Threats are primarily alterations to the hydrology of the wetland, such as ditching or tidal restrictions that might affect the sheet flow of tidal waters across the intertidal flat, activities that eliminate plants, and increased input of nutrients and pollutants in

Memo



NH NATURAL HERITAGE BUREAU
NHB DATACHECK RESULTS LETTER

perennial saltmarsh American-aster (<i>Symphyotrichum tenuifolium</i> var. <i>tenuifolium</i>)	E	--	storm runoff. Threats to this estuarine species are primarily alterations to the hydrology of the wetland, such as ditching or tidal restrictions that might affect the sheet flow of tidal waters across the intertidal flat, activities that eliminate plants, and increased input of nutrients and pollutants in storm runoff.
seaside brookweed (<i>Samolus valerandi</i> ssp. <i>parviflorus</i>)*	E	--	Occurs on river and streambanks, as well as estuarine and seashore habitats. Threats include direct destruction of the plants and major alterations of their habitat.
Tundra Alkali Grass (<i>Puccinellia pumila</i>)*	E	--	Primarily vulnerable to changes to the hydrology of its habitat, especially alterations that change water levels. It may also be susceptible to increased pollutants and nutrients carried in stormwater runoff.

¹Codes: "E" = Endangered, "T" = Threatened, "SC" = Special Concern, "N" = an exemplary natural community or a rare species tracked by NH Natural Heritage that has not yet been added to the official state list. An asterisk (*) indicates that the most recent report for that occurrence was more than 20 years ago.

A negative result (no record in our database) does not mean that a sensitive species is not present. Our data can only tell you of known occurrences, based on information gathered by qualified biologists and reported to our office. However, many areas have never been surveyed, or have only been surveyed for certain species. An on-site survey would provide better information on what species and communities are indeed present.

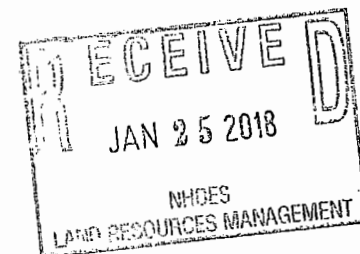

Department of Natural and Cultural Resources
Division of Forests and Lands
(603) 271-2214 fax: 271-6488

DNCR/NHB
172 Pembroke Rd.
Concord, NH 03301

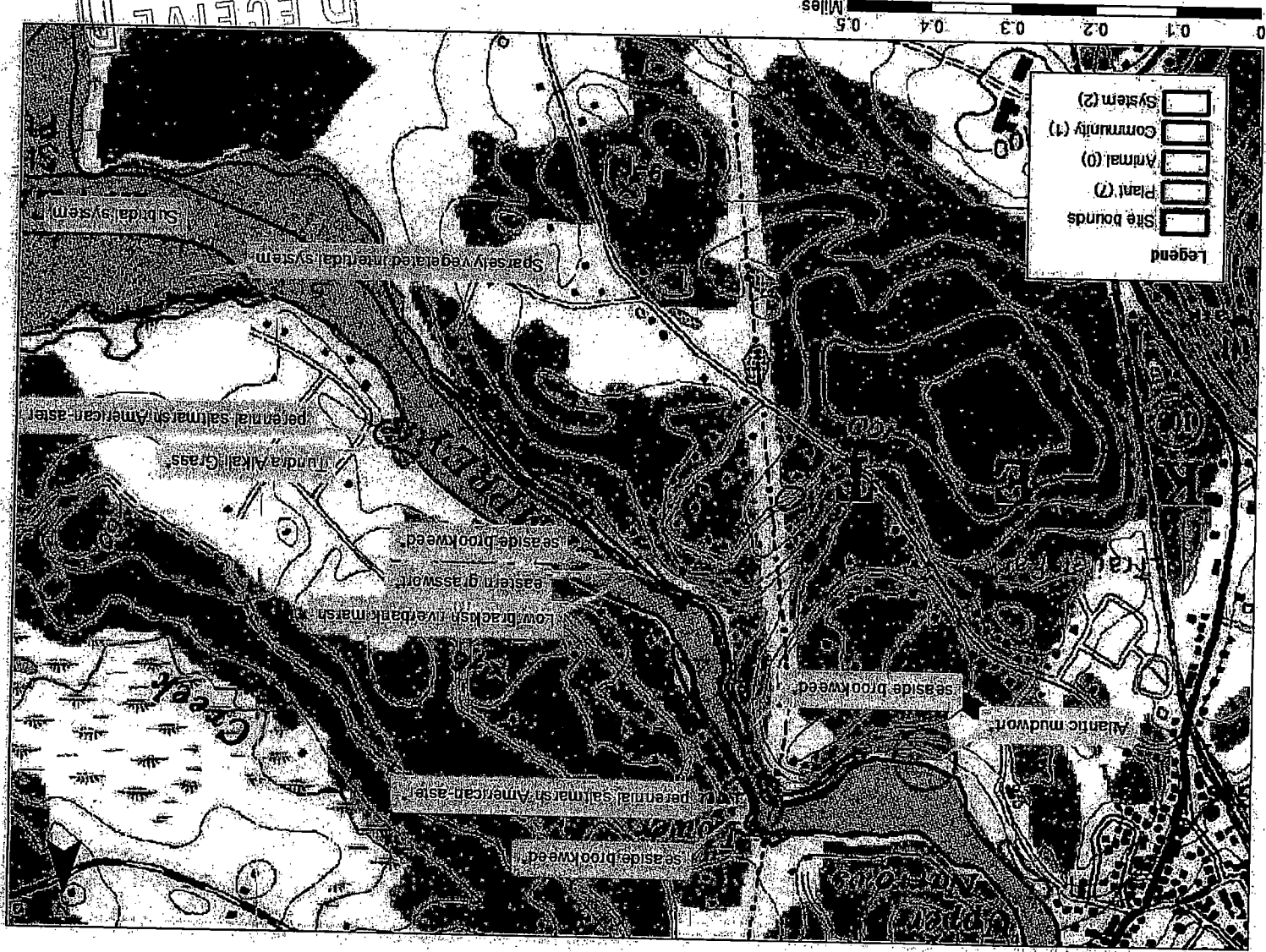

NHB17-3541

RECEIVED
 JAN 25 2018
 NHHDES MANAGEMENT

New Hampshire Natural Heritage Bureau - Community Record

Low brackish riverbank marsh

Legal Status

Federal: Not listed
State: Not listed

Conservation Status

Global: Not ranked (need more information)
State: Critically imperiled due to rarity or vulnerability

Description at this Location

Conservation Rank: Historical records only - current condition unknown.

Comments on Rank: Largely pristine area, with heavy human impact threatening.

Detailed Description: 1989: A narrow zone of intertidal mudflats on both sides of river interspersed with rocky areas and brackish tidal marsh extending from downtown Newmarket nearly to mouth of river. *Lilaeopsis chinensis* (eastern lilaeopsis) and *Samolus parviflorus* (false water pimpernel), both present in quantity. 1984: *Eleocharis halophila* (salt-loving spike-rush) and *Limosella australis* (subulata) (Atlantic mudwort) found.

General Area: 1984?: *Scirpus robustus* (stout bulrush) in adjacent marsh. *Aster tenuifolius* (large salt marsh aster) in *Spartina* sp. of north shore of lower narrows.

General Comments: 1989: Need more fieldwork on north shore. Sewage treatment plant effluent, residential and new building activities are a continuing threat.

Management

Comments:

Location

Survey Site Name: Lamprey River Narrows

Managed By: Levy Fee

County: Rockingham

Town(s): Newmarket

Size: 7.2 acres

Elevation: 20 feet

Precision: Within (but not necessarily restricted to) the area indicated on the map.

Directions: From Rte. 108 in Newmarket, take New Road to Young Road. Follow to sewage treatment plant. North shore access from Smith Garrison Road.

Dates documented

First reported: 1983

Last reported: 1989-08-03

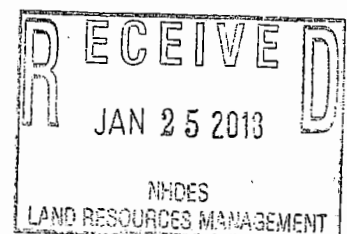

New Hampshire Natural Heritage Bureau - System Record

Subtidal system

Legal Status

Federal: Not listed
State: Not listed

Conservation Status

Global: Not ranked (need more information)
State: Rare or uncommon

Description at this Location

Conservation Rank: Not ranked
Comments on Rank:

Detailed Description: Channels and bay bottoms that vary in width from a few feet to almost a mile across, covered by water even at low tide. Patches of subtidal *eelgrass bed* occur at the edge of the adjacent sparsely vegetated intertidal system.

General Area: 2010: Borders a sparsely vegetated intertidal system.

General Comments:
Management
Comments:

Location

Survey Site Name: Great Bay
Managed By: Portsmouth Country Club

County: Rockingham
Town(s): Newington
Size: 3207.7 acres

Elevation:

Precision: Within (but not necessarily restricted to) the area indicated on the map.

Directions: Occurs throughout the Great Bay estuary, from the upper total reaches of tributary streams to the confluence of the bay with the Piscataqua River.

Dates documented

First reported: 1997-06-17

Last reported: 2010-10-13

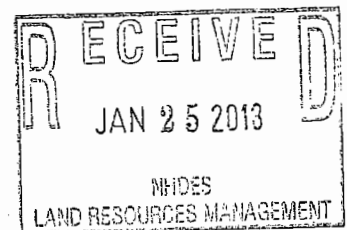

New Hampshire Natural Heritage Bureau - Plant Record

Atlantic mudwort (*Limosella australis*)**Legal Status**

Federal: Not listed
 State: Listed Endangered

Conservation Status

Global: Apparently secure but with cause for concern
 State: Critically imperiled due to rarity or vulnerability

Description at this Location

Conservation Rank: Historical records only - current condition unknown.
 Comments on Rank:

Detailed Description: 1996: Found very few individuals (7-8 plants). Poor success in each stage of life cycle, with feeble vigor. 1989: None seen. 1984: Between 101-1000 flowering, mature plants, 10-100 square yards of population area. Abundance of flowering material. 1983: Colony observed, at flowering stage.

General Area: 1996: Lower marsh substrate is a mix of mud, cobble, and small boulders. The dominant plant is *Spartina alterniflora* (smooth cord-grass). Other associates include *Polygonum ramosissimum* (bushy knotweed), *Scirpus pungens* (three-square rush), *Scirpus maritimus* (saltmarsh bulrush), *Amaranthus cannabinus* (water hemp), and *Carex gynandra* (perfect-awned sedge). 1983: Tidal river estuary. Mudflats within river banks. Mud (ooze) underlain by peaty muck. Saturated to inundated.

General Comments: 1989: Human activity may be cause of decline. 1984: Site is planned to be a boat access ramp by the New Hampshire Fish and Game Department.

Management Comments: 1984: Recommend watching this population from year to year to ascertain its status.

Location

Survey Site Name: Lamprey River Narrows
 Managed By:

County: Rockingham
 Town(s): Newmarket
 Size: 2.8 acres

Elevation: 25 feet

Precision: Within (but not necessarily restricted to) the area indicated on the map.

Directions: Southwest side of Lamprey River Narrows. From Newmarket, take Rte. 108 (Main St.) south to Exeter St. Take 3rd(?) left, heading east on New Rd. Take first left onto Young Lane. Drive down dirt road to boat ramp and park. Site is upstream from Lower narrows and near sewage treatment plant, near foot of boat ramp.

Dates documented

First reported: 1983-07-18

Last reported: 1996-07-10

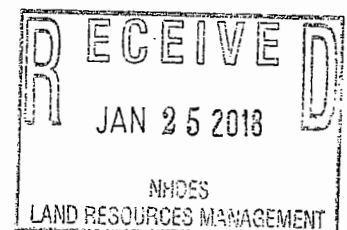

New Hampshire Natural Heritage Bureau - Plant Record

perennial saltmarsh American-aster (*Symphotrichum tenuifolium* var. *tenuifolium*)**Legal Status**

Federal: Not listed
State: Listed Endangered

Conservation Status

Global: Demonstrably widespread, abundant, and secure
State: Critically imperiled due to rarity or vulnerability

Description at this Location

Conservation Rank: Good quality, condition and landscape context ('B' on a scale of A-D).
Comments on Rank: 1989: A-: One of the best occurrences of this plant in New Hampshire.

Detailed Description: 2010: Area 1: 30+ flowering plants plus additional plants in area to west not surveyed; vigor normal; successfully producing fruit. 1999: Area 3: 5 small flowering plants, with 2-3 stems each. 1989: Area 1/2: About 100 plants, 50% flowering, sparsely scattered on same population area. Appears to have increased in numbers since last visit. 1984: Area 1: Between 11-50 flowering, mature plants sparsely scattered in 10-100 square yards of population area. 1973: Specimen collected.

General Area: 2010: Area 1: Occurs in low wet areas (seepy, seaward side of berm). Associated plant species are common glasswort (*Salicornia depressa*), small salt marsh aster (*Symphotrichum subulatum*), salt-meadow cordgrass (*Spartina patens*), smooth cordgrass (*Spartina alterniflora*), salt marsh rush (*Juncus gerardii*), seabeach sand spurrey (*Spergularia salina*), seaside arrowgrass (*Triglochin maritimum*), marsh elder (*Iva frutescens*), and others. 1999: Area 3: Salt marsh ledge. 1984: Area 1: Upper border of muddy, gravelly shore. Small salt marsh. Associated species include smooth cordgrass (*Spartina alterniflora*), salt-meadow cordgrass (*S. patens*), salt marsh rush (*Juncus gerardii*), stout bulrush (*Bolboschoenus robustus*), prolific knotweed (*Polygonum ramosissimum* ssp. *prolificum*), drooping smartweed (*Persicaria lapathifolia*), salt marsh plantain (*Plantago maritima* var. *juncooides*), and seaside goldenrod (*Solidago sempervirens*). 1973: Upper edge of saltmarsh, with salt marsh gerardia (*Agalinis maritima*) and small-flowered gerardia (*A. paupercula*).

General Comments:

Management: 1999: No evidence of disturbance.
Comments:

Location

Survey Site Name: Lamprey River Mouth
Managed By: Moody Point Open Space

County: Rockingham

Town(s): Newmarket

Size: 1.1 acres

Elevation: 20 feet

Precision: Within (but not necessarily restricted to) the area indicated on the map.

Directions: 2010: Area 1: Moody Point. Park at trail head on south side of Cushing Road. 1999: Area 3: [About 1,500 feet NW of the main population (on the east side of the river).] 1989: Area 2: Same as 1984 [but mapped further west]. 1984: Area 1: Upper border of muddy-gravelly shore - small salt marsh - almost at Moody's Point, at the mouth of the Lamprey River. 1973: Upper border of salt marsh, along eastern side of mouth of Lamprey River (8/8). Upper edge of saltmarsh at mouth of Lamprey River at north side of river mouth (8/10).

Dates documented

First reported: 1973-08-08

Last reported: 2010-09-09

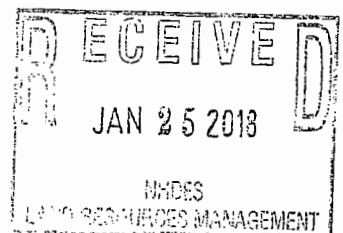

New Hampshire Natural Heritage Bureau - Plant Record
seaside brookweed (*Samolus valerandi* ssp. *parviflorus*)

Legal Status

Federal: Not listed
 State: Listed Endangered

Conservation Status

Global: Demonstrably widespread, abundant, and secure
 State: Critically imperiled due to rarity or vulnerability

Description at this Location

Conservation Rank: Historical records only - current condition unknown.
 Comments on Rank:

Detailed Description: 1989: Same status. 1984: Between 101-1000 flowering, fruiting, mature plants on 10-100 square yards of population area.

General Area: Tidal mudflat in river bed. Undeveloped mud, peat and gravel.

General Comments:

Management

Comments:

Location

Survey Site Name: Lamprey River Narrows -- South Shore

Managed By: Levy Fee

County: Rockingham

Town(s): Newmarket

Size: 3.1 acres

Elevation: 25 feet

Precision: Within (but not necessarily restricted to) the area indicated on the map.

Directions: Newmarket. Lamprey River narrows. Below upper narrows and just above, and below lower narrows on south side of river.

Dates documented

First reported: 1984

Last reported: 1989-08-03

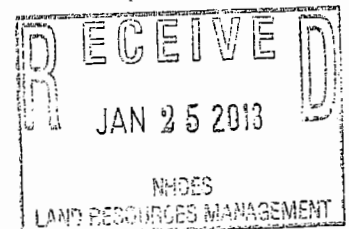

New Hampshire Natural Heritage Bureau - Plant Record
seaside brookweed (*Samolus valerandi* ssp. *parviflorus*)

Legal Status

Federal: Not-listed
 State: Listed Endangered

Conservation Status

Global: Demonstrably widespread, abundant, and secure
 State: Critically imperiled due to rarity or vulnerability

Description at this Location

Conservation Rank: Historical records only - current condition unknown.
 Comments on Rank: Doing well.

Detailed Description: 1989: ca. 75 mature plants, 50 percent flowering, fruiting. Plus 200 first year rosettes on 10-100 square yards population area. 1984: Between 1-10 first year leaved plants on 1-5 square yards of population area.

General Area: Moist to saturated, mud bank.

General Comments: Area not thoroughly searched, yet still appears to be more vigorous than on previous visit.

Management
 Comments:

Location

Survey Site Name: Lamprey River Narrows -- North Shore
 Managed By: Heron Point Open Space

County: Rockingham

Town(s): Newmarket

Size: 2.8 acres

Elevation: 20 feet

Precision: Within (but not necessarily restricted to) the area indicated on the map.

Directions: Newmarket. Lamprey River narrows. Northeast bank of Lamprey River estuary.

Dates documented

First reported: 1984

Last reported: 1989-08-04

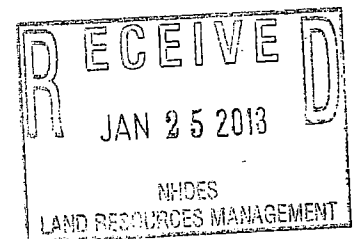

New Hampshire Natural Heritage Bureau - Plant Record

Tundra Alkali Grass (*Puccinellia pumila*)**Legal Status**

Federal: Not listed
 State: Listed Endangered

Conservation Status

Global: Demonstrably widespread, abundant, and secure
 State: Critically imperiled due to rarity or vulnerability

Description at this Location

Conservation Rank: Historical records only - current condition unknown.
 Comments on Rank:

Detailed Description: 1973: Specimen collected.
 General Area: 1973: Salt marsh.
 General Comments:
 Management
 Comments:

Location

Survey Site Name: Lamprey River Salt Marsh
 Managed By: Moody Point Open Space

County: Rockingham
 Town(s): Newmarket
 Size: 9.1 acres

Elevation:

Precision: Within 1.5 miles of the area indicated on the map (location information is vague or uncertain).

Directions: 1973: Lamprey River, salt marsh.

Dates documented

First reported: 1973-08-08 Last reported: 1973-08-08

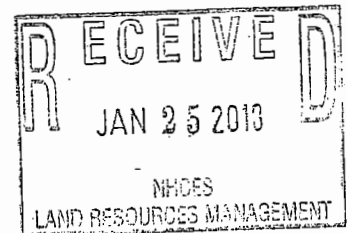

ABUTTER'S LIST

JN 2552.25

**Richard LeSavoy 2013 Revocable Trust
14 Birch Drive
Newmarket, NH**

MAP	LOT	NAME(S)	PO BOX	STREET ADDRESS	CITY/STATE/ZIP
U3	94	Christian W. Archila		[REDACTED]	Windham, NH 03087
U3	73	Kristine D. Wilber & Steven R. Peckham		[REDACTED]	Newmarket, NH 03857
Engineer		Ambit Engineering, Inc. Civil Engineers & Land Surveyors		200 Griffin Road, Unit 3	Portsmouth, NH 03801
Applicant/Owner					
U3	93	Richard LeSavoy 2013 Revocable Trust Richard LeSavoy Trustee		[REDACTED]	Newmarket, NH 03857

