



**THE STATE OF NEW HAMPSHIRE  
DEPARTMENT OF TRANSPORTATION**



**CHRISTOPHER D. CLEMENT, SR.  
COMMISSIONER**

**JEFF BRILLHART, P.E.  
ASSISTANT COMMISSIONER**

Bureau of Construction  
July 23, 2014

Her Excellency, Governor Margaret Wood Hassan  
and the Honorable Council  
State House  
Concord, New Hampshire 03301

**REQUESTED ACTION**

1. Authorize the Department of Transportation to enter into a contract with Alvin J. Coleman & Son, Inc. (Vendor 154411) of Conway, NH on the basis of a low bid of \$686,674.50 for minor expansion and reconfiguration of the Portsmouth Transportation Center, the Park and Ride facility located on the southern end of the Pease Tradeport in Portsmouth, from the date of Governor and Council approval through October 31, 2014 unless extended by the Department in accordance with the Standard Specifications. 100% Federal Funds.

Funding is available as follows:	<u>FY 2015</u>
04-96-96-963515-3054	
Consolidated Federal Aid	
400-500870 Highway Contract Payments	\$686,674.50

2. Further authorize that a contingency in the amount of \$48,067.22 be approved for payment of latent conditions, which may appear during the construction of the project. The contingency requested is 7% of the contract amount.

Funding is available as follows:	<u>FY 2015</u>
04-96-96-963515-3054	
Consolidated Federal Aid	
400-500870 Highway Contract Payments	\$48,067.22

**EXPLANATION**

This project is part of the Congestion Mitigation and Air Quality (CMAQ) Program. The work involves minor expansion of approximately 10,300 S.F. of new pavement at the north end of the auxiliary lot, addition of parallel parking spaces (38) along the main lot/access drive, overlay and restriping at the main and auxiliary lot, and other incidental work. This facility was constructed in two phases, between 1999 and 2001. There are approximately 995 existing spaces. The facility is at or over capacity nearly every business day. The recently initiated East-West Express bus service has also increased demand. The proposed construction and reconfiguration will add 210 additional spaces to address the immediate capacity shortfall. Further study of the long term needs and potential solutions will continue under the parent project 20222A.

The contingency amount is proposed to be 7% of the contract amount. The scope of work is fixed, and adjusting limits to offset quantity overruns is not practical. This is short duration project with an aggressive construction schedule.

The Contractor has been prequalified by this Department. The Contract has been approved by the Attorney General as to form and execution, and the Department has certified that the necessary funds are available and that the bid reasonably conforms to the engineer's estimate in accordance with State procedure. Copies of the fully executed contract are on file at the Secretary of State's Office and the Department of Administrative Service's Office, and subsequent to Governor and Council approval will be on file at the Department of Transportation.

This project funding is 80% federal funds with 20% state match. Turnpike toll credit is being utilized for match requirements, effectively using 100% federal funds.

A copy of the Tabulation of Bids received for this project is attached along with the Contract Supplemental Sheet and a map indicating the location of the project.

Sincerely,

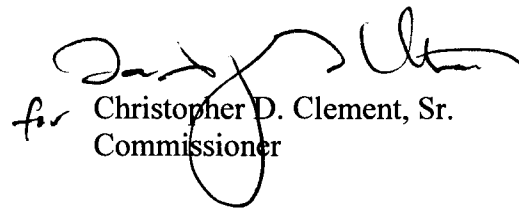
  
for Christopher D. Clement, Sr.  
Commissioner

CDC/md

Department Estimate: \$717,911.75  
Contract Amount: \$686,674.50  
Under Estimate: \$ 31,237.25

Attachments

June 10, 2014

## SUPPLEMENTAL PROJECT INFORMATION SHEET

**DESCRIPTION:** The project involves a minor expansion and reconfiguration of the Portsmouth Transportation Center, the Park and Ride facility located on the southern end of the Pease Tradeport in Portsmouth. The expansion consists of adding approximately 10,300 sf of new pavement at the north end of the auxiliary lot and the addition of 38 parallel parking spaces along the north side of the main lot. Reconfiguration of the auxiliary lot consists of removing and replacing existing curbed islands, overlay and re-striping. Incidental work includes curb and sidewalk relocation, overlay of the main lot loop road, modifications to lighting, relocation and installation of conduit for fiber optics and security cameras, replacement of landscaping, and minor modifications to the existing drainage and detention ponds.

**FEDERAL FUNDING:** Construction funding is 80% Federal Funding with the anticipated utilization of Turnpike Toll Credits as the State's 20% match.

**CONTINGENCY:** The contingency amount is proposed to be 7% of the contract amount. The scope of work is fixed, and adjusting limits to offset quantity overruns is not practical. This is short duration project with an aggressive construction schedule.

**PROJECT INITIATED:** The project was initiated at the request of the Bureau of Rail & Transit, based on the 2009 *Portsmouth-Manchester Airport Bus Feasibility Study*, which concluded that "expanding parking at the PTC will be key to implementing the services discussed in this study"(p. 30).

**PROJECT EXPLANATION:** This facility was constructed in two phases, between 1999 and 2001. There are approximately 995 existing spaces. The facility is at or over capacity nearly every business day. The recently initiated East-West Express bus service has also increased demand. The proposed construction and reconfiguration will add 210 additional spaces to address the immediate capacity shortfall. Further study of the long term needs and potential solutions will continue under the parent project 20222A.

**TRAFFIC IMPLICATIONS:** The majority of traffic impacts will be within the existing parking lots. Construction will impact Grafton Drive for a short time for access to detention ponds and matching in of paving and striping. Parking lot work phasing has been coordinated with the Operator, resulting in a 3 phase sequence that impacts a maximum of 300 spaces at any one time.

**COMPLETION DATE:** October 31, 2014

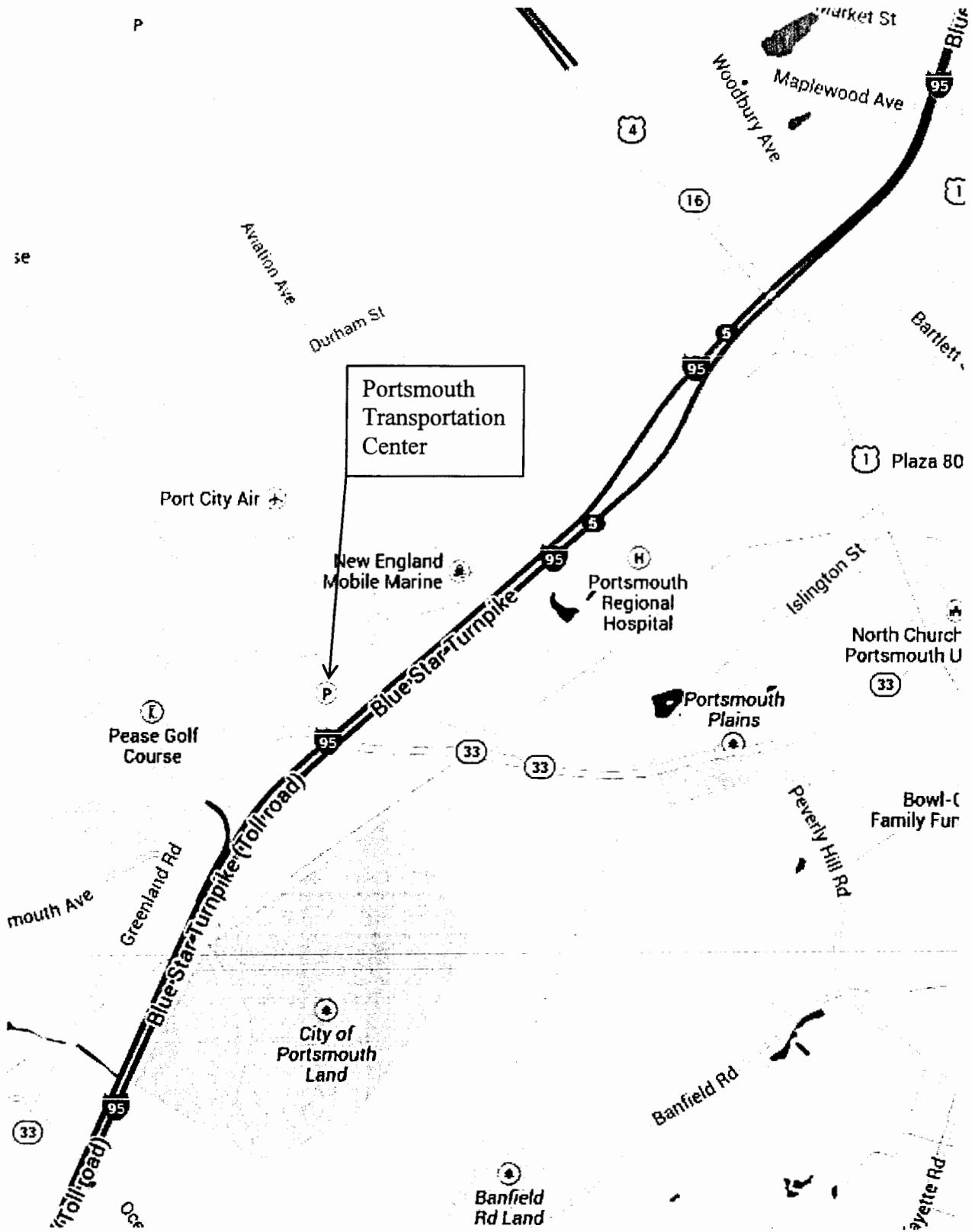

Portsmouth 2022B  
 Portsmouth Transportation Center Improvements

**State of New Hampshire  
Department of Transportation**

20222B.01

**Project:** PORTSMOUTH X-A004(090)  
20222B

**County and Code:** ROCKINGHAM COUNTY 015

**Date Bids Open:** July 10, 2014

**Scope of Work:** MINOR EXPANSION AND RECONFIGURATION OF PARK  
AND RIDE

**Location:** PORTSMOUTH TRANSPORTATION CENTER LOCATED  
AT PEASE TRADEPORT

**Completion Date:** October 31, 2014

A ALVIN J. COLEMAN & SON, INC.  
9 NH ROUTE 113 CONWAY, NH 03818 \$686,674.50

B JOHN H LYMAN & SONS INC  
310 HOYT ROAD GILFORD NH 03249 \$820,652.25

Item No:	Description	Unit	Quantity	A		B	
				Unit Price	Total	Unit Price	Total
201.101	CLEARING AND GRUBBING	A	0.70	\$4,680.00	\$3,276.00	\$7,000.00	\$4,900.00
201.881	INVASIVE SPECIES CONTROL TYPE I	SY	1,810.00	\$1.50	\$2,715.00	\$5.00	\$9,050.00
203.1	COMMON EXCAVATION	CY	3,880.00	\$11.50	\$44,620.00	\$17.00	\$65,960.00
203.2	ROCK EXCAVATION	CY	32.00	\$12.00	\$384.00	\$90.00	\$2,880.00
203.601	EMBANKMENT-IN-PLACE	CY	810.00	\$7.30	\$5,913.00	\$6.00	\$4,860.00
206.19	COMMON STRUCTURE EXCAVATION EXPLORATORY	CY	50.00	\$19.50	\$975.00	\$28.00	\$1,400.00
209.1	GRANULAR BACKFILL	CY	90.00	\$29.00	\$2,610.00	\$54.00	\$4,860.00
214	FINE GRADING	U	1.00	\$6,950.00	\$6,950.00	\$2,500.00	\$2,500.00
304.4	CRUSHED STONE (FINE GRADATION) (F)	CY	480.00	\$22.00	\$10,560.00	\$29.00	\$13,920.00
304.5	CRUSHED STONE (COARSE GRADATION) (F)	CY	840.00	\$22.50	\$18,900.00	\$29.00	\$24,360.00
403.11	HOT BITUMINOUS PAVEMENT, MACHINE METHOD	TON	1,960.00	\$75.00	\$147,000.00	\$81.00	\$158,760.00
403.1109	HOT BITUMINOUS PAVEMENT, MACHINE METHOD, HIGH STRENGTH	TON	925.00	\$85.00	\$78,625.00	\$103.50	\$95,737.50
403.12	HOT BITUMINOUS PAVEMENT, HAND METHOD	TON	60.00	\$110.00	\$6,600.00	\$140.00	\$8,400.00
403.6	PAVEMENT JOINT ADHESIVE	LF	26,000.00	\$0.10	\$2,600.00	\$1.10	\$28,600.00
417	COLD PLANING BITUMINOUS SURFACES	SY	250.00	\$10.00	\$2,500.00	\$9.00	\$2,250.00
585.3	STONE FILL, CLASS C	CY	40.00	\$29.00	\$1,160.00	\$40.00	\$1,600.00
593.421	GEOTEXTILE; PERM CONTROL CL.2, NON-WOVEN	SY	100.00	\$1.50	\$150.00	\$1.00	\$100.00
603.00212	12" R.C. PIPE, 2000D	LF	120.00	\$63.50	\$7,620.00	\$51.00	\$6,120.00
603.82212	12" PE PIPE (TYPE S)	LF	35.00	\$51.50	\$1,802.50	\$41.00	\$1,435.00
604.0007	POLYETHYLENE LINER	EA	7.00	\$150.00	\$1,050.00	\$150.00	\$1,050.00
604.12	CATCH BASINS TYPE B	U	5.00	\$2,080.00	\$10,400.00	\$3,800.00	\$19,000.00

Item No:	Description	Unit	Quantity	A		B	
				Unit Price	Total	Unit Price	Total
604.22	DROP INLETS TYPE B	U	2.00	\$1,330.00	\$2,660.00	\$3,500.00	\$7,000.00
604.4	RECONSTRUCTING/ADJUSTING CATCH BASIN & DROP INLET	LF	32.00	\$330.00	\$10,560.00	\$300.00	\$9,600.00
604.62	DRAINAGE MANHOLE COVERS AND FRAMES	EA	2.00	\$355.00	\$710.00	\$350.00	\$700.00
604.9101	OUTLET CONTROL STRUCTURE	U	1.00	\$2,850.00	\$2,850.00	\$4,900.00	\$4,900.00
604.9102	OUTLET CONTROL STRUCTURE	U	1.00	\$2,850.00	\$2,850.00	\$4,900.00	\$4,900.00
606.0001	STEEL BEAM FOR BEAM GUARDRAIL, INCLUDING HARDWARE	LF	75.00	\$28.00	\$2,100.00	\$66.00	\$4,950.00
606.0142	6"X8" WOOD POST ASSEMBLIES FOR BEAM GUARDRAIL POSTS	EA	6.00	\$48.00	\$288.00	\$130.00	\$780.00
607.9306	RESETTING CHAIN LINK FENCE WITH VINYL COATED STEEL FABRIC, 6' HIGH	LF	54.00	\$30.00	\$1,620.00	\$70.00	\$3,780.00
608.12	2" BITUMINOUS SIDEWALK (F)	SY	500.00	\$13.00	\$6,500.00	\$14.50	\$7,250.00
608.24	4" CONCRETE SIDEWALK (F)	SY	12.00	\$70.00	\$840.00	\$80.00	\$960.00
608.54	DETECTABLE WARNING DEVICES, CAST IRON	SY	1.00	\$500.00	\$500.00	\$300.00	\$300.00
609.02	CURVED GRANITE CURB	LF	300.00	\$27.50	\$8,250.00	\$36.00	\$10,800.00
609.5	RESET GRANITE CURB	LF	2,500.00	\$6.00	\$15,000.00	\$14.00	\$35,000.00
614.331	3" STEEL CONDUIT	LF	50.00	\$20.00	\$1,000.00	\$22.00	\$1,100.00
614.511	CONCRETE PULL BOX 14"	EA	2.00	\$350.00	\$700.00	\$385.00	\$770.00
614.522	MOLDED PULL BOX 13"X24"	EA	3.00	\$350.00	\$1,050.00	\$385.00	\$1,155.00
614.523	MOLDED PULL BOX 17"X30"	EA	9.00	\$380.00	\$3,420.00	\$420.00	\$3,780.00
614.72114	2" PVC CONDUIT, SCHEDULE 40	LF	645.00	\$7.00	\$4,515.00	\$8.00	\$5,160.00
614.72118	2" PVC CONDUIT, SCHEDULE 80	LF	36.00	\$18.00	\$648.00	\$20.00	\$720.00

Item No:	Description	Unit	Quantity	A		B	
				Unit Price	Total	Unit Price	Total
614.73118	3" PVC CONDUIT, SCHEDULE 80	LF	100.00	\$20.00	\$2,000.00	\$22.00	\$2,200.00
614.73214	3" 2-DUCT PVC CONDUIT, SCHEDULE 40	LF	1,150.00	\$9.50	\$10,925.00	\$10.50	\$12,075.00
614.74118	4" PVC CONDUIT, SCHEDULE 80	LF	65.00	\$28.00	\$1,820.00	\$31.00	\$2,015.00
615.02	TRAFFIC SIGN TYPE B (F)	SF	5.00	\$30.00	\$150.00	\$29.00	\$145.00
615.03	TRAFFIC SIGN TYPE C (F)	SF	125.25	\$30.00	\$3,757.50	\$30.00	\$3,757.50
615.06	TRAFFIC SIGN TYPE CC (F)	SF	15.75	\$10.00	\$157.50	\$11.00	\$173.25
618.61	UNIFORMED OFFICERS WITH VEHICLE	\$	6,000.00	\$1.00	\$6,000.00	\$1.00	\$6,000.00
618.7	FLAGGERS	HR	900.00	\$12.50	\$11,250.00	\$28.00	\$25,200.00
619.1	MAINTENANCE OF TRAFFIC	U	1.00	\$11,800.00	\$11,800.00	\$5,500.00	\$5,500.00
619.25	PORTABLE CHANGEABLE MESSAGE SIGN	U	2.00	\$2,910.00	\$5,820.00	\$3,000.00	\$6,000.00
621.61	FIBER OPTIC DELINEATOR	EA	3.00	\$150.00	\$450.00	\$165.00	\$495.00
625.25	CONCRETE LIGHT POLE BASE TYPE B (2' REVEAL)	EA	2.00	\$950.00	\$1,900.00	\$1,045.00	\$2,090.00
625.622	RESET/RELOCATE LIGHT POLE WITHOUT BREAKAWAY BASE	EA	2.00	\$1,100.00	\$2,200.00	\$1,200.00	\$2,400.00
628.2	SAWED BITUMINOUS PAVEMENT	LF	630.00	\$1.50	\$945.00	\$2.00	\$1,260.00
632.0104	RETROREFLECTIVE PAINT PAVE. MARKING, 4" LINE	LF	43,700.00	\$0.35	\$15,295.00	\$0.45	\$19,665.00
632.0106	RETROREFLECTIVE PAINT PAVE. MARKING, 6" LINE	LF	300.00	\$0.25	\$75.00	\$0.55	\$165.00
632.0118	RETROREFLECTIVE PAINT PAVE. MARKING, 18" LINE	LF	550.00	\$2.00	\$1,100.00	\$1.10	\$605.00
632.02	RETROREFLECTIVE PAINT PAVEMENT MARKING, SYMBOL OR WORD	SF	120.00	\$5.00	\$600.00	\$2.20	\$264.00
632.911	OBLITERATE PAVE. MARKING LINE, 12" WIDE & UNDER	LF	19,700.00	\$0.50	\$9,850.00	\$0.55	\$10,835.00



Item No:	Description	Unit	Quantity	A		B	
				Unit Price	Total	Unit Price	Total
632.92	OBLITERATE PAVEMENT MARKING, SYMBOL OR WORD	SF	350.00	\$1.00	\$350.00	\$1.30	\$455.00
641	LOAM	CY	460.00	\$15.50	\$7,130.00	\$51.00	\$23,460.00
645.3	EROSION STONE	TON	60.00	\$24.50	\$1,470.00	\$40.00	\$2,400.00
645.43	TEMPORARY SLOPE STABILIZATION TYPE C	SY	570.00	\$1.90	\$1,083.00	\$1.00	\$570.00
645.531	SILT FENCE	LF	2,200.00	\$2.00	\$4,400.00	\$3.00	\$6,600.00
645.7	STORM WATER POLLUTION PREVENTION PLAN	U	1.00	\$2,500.00	\$2,500.00	\$1,800.00	\$1,800.00
645.71	MONITORING SWPPP AND EROSION AND SEDIMENT CONTROLS	HR	80.00	\$65.00	\$5,200.00	\$85.00	\$6,800.00
646.31	TURF ESTABLISHMENT WITH MULCH AND TACKIFIERS	SY	4,850.00	\$0.40	\$1,940.00	\$1.00	\$4,850.00
650.2	LANDSCAPING	U	1.00	\$54,700.00	\$54,700.00	\$26,000.00	\$26,000.00
670.02	SEDIMENT SUMP MEASURING BLOCK	EA	2.00	\$385.00	\$770.00	\$300.00	\$600.00
677.51024	24-STRAND SINGLE MODE FIBER OPTIC CABLE	LF	925.00	\$4.20	\$3,885.00	\$5.00	\$4,625.00
677.53	FIBER OPTIC SPLICE	EA	2.00	\$2,320.00	\$4,640.00	\$2,550.00	\$5,100.00
677.562	FIBER OPTIC PATCH PANEL (24-POSITION)	EA	2.00	\$2,650.00	\$5,300.00	\$2,900.00	\$5,800.00
677.5822	1 GBPS FIBER ETHERNET SWITCH	EA	1.00	\$3,630.00	\$3,630.00	\$4,000.00	\$4,000.00
692	MOBILIZATION	U	1.00	\$55,000.00	\$55,000.00	\$40,000.00	\$40,000.00
697.11	INVASIVE SPECIES CONTROL AND MANAGEMENT PLAN	U	1.00	\$1,110.00	\$1,110.00	\$400.00	\$400.00
699	MISCELLANEOUS TEMPORARY EROSION AND SEDIMENT CONTROL	\$	5,000.00	\$1.00	\$5,000.00	\$1.00	\$5,000.00
1010.15	FUEL ADJUSTMENT	\$	10,000.00	\$1.00	\$10,000.00	\$1.00	\$10,000.00
1010.2	ASPHALT CEMENT ADJUSTMENT	\$	10,000.00	\$1.00	\$10,000.00	\$1.00	\$10,000.00

\$820,652.25

\$686,674.50

# A - PS&E Comparison

PS&E = NHDOT Cost Estimate

Item No:	Description	Unit	Quantity	A-Bidder		PS&E		A-PS&E Difference
				Unit Price	Total	Unit Price	Total	
201.101	CLEARING AND GRUBBING	A	0.70	\$4,680.00	\$3,276.00	\$12,000.00	\$8,400.00	(\$5,124.00)
201.881	INVASIVE SPECIES CONTROL TYPE I	SY	1,810.00	\$1.50	\$2,715.00	\$5.00	\$9,050.00	(\$6,335.00)
203.1	COMMON EXCAVATION	CY	3,880.00	\$11.50	\$44,620.00	\$10.00	\$38,800.00	\$5,820.00
203.2	ROCK EXCAVATION	CY	32.00	\$12.00	\$384.00	\$40.00	\$1,280.00	(\$896.00)
203.601	EMBANKMENT-IN-PLACE	CY	810.00	\$7.30	\$5,913.00	\$15.00	\$12,150.00	(\$6,237.00)
206.19	COMMON STRUCTURE EXCAVATION EXPLORATORY	CY	50.00	\$19.50	\$975.00	\$50.00	\$2,500.00	(\$1,525.00)
209.1	GRANULAR BACKFILL	CY	90.00	\$29.00	\$2,610.00	\$30.00	\$2,700.00	(\$90.00)
214	FINE GRADING	U	1.00	\$6,950.00	\$6,950.00	\$8,800.00	\$8,800.00	(\$1,850.00)
304.4	CRUSHED STONE (FINE GRADATION) (F)	CY	480.00	\$22.00	\$10,560.00	\$22.00	\$10,560.00	\$0.00
304.5	CRUSHED STONE (COARSE GRADATION) (F)	CY	840.00	\$22.50	\$18,900.00	\$20.00	\$16,800.00	\$2,100.00
403.11	HOT BITUMINOUS PAVEMENT, MACHINE METHOD	TON	1,960.00	\$75.00	\$147,000.00	\$82.00	\$160,720.00	(\$13,720.00)
403.1109	HOT BITUMINOUS PAVEMENT, MACHINE METHOD, HIGH STRENGTH	TON	925.00	\$85.00	\$78,625.00	\$90.00	\$83,250.00	(\$4,625.00)
403.12	HOT BITUMINOUS PAVEMENT, HAND METHOD	TON	60.00	\$110.00	\$6,600.00	\$125.00	\$7,500.00	(\$900.00)
403.6	PAVEMENT JOINT ADHESIVE	LF	26,000.00	\$0.10	\$2,600.00	\$0.25	\$6,500.00	(\$3,900.00)
417	COLD PLANING BITUMINOUS SURFACES	SY	250.00	\$10.00	\$2,500.00	\$5.00	\$1,250.00	\$1,250.00
585.3	STONE FILL, CLASS C	CY	40.00	\$29.00	\$1,160.00	\$30.00	\$1,200.00	(\$40.00)
593.421	GEOTEXTILE; PERM CONTROL CL.2, NON-WOVEN	SY	100.00	\$1.50	\$150.00	\$2.00	\$200.00	(\$50.00)
603.00212	12" R.C. PIPE, 2000D	LF	120.00	\$63.50	\$7,620.00	\$50.00	\$6,000.00	\$1,620.00
603.82212	12" PE PIPE (TYPE S)	LF	35.00	\$51.50	\$1,802.50	\$40.00	\$1,400.00	\$402.50
604.0007	POLYETHYLENE LINER	EA	7.00	\$150.00	\$1,050.00	\$175.00	\$1,225.00	(\$175.00)
604.12	CATCH BASINS TYPE B	U	5.00	\$2,080.00	\$10,400.00	\$2,000.00	\$10,000.00	\$400.00

# A - PS&E Comparison

PS&E = NHDOT Cost Estimate

Item No.	Description	Unit	Quantity	A-Bidder		PS&E		A-PS&E Difference
				Unit Price	Total	Unit Price	Total	
604.22	DROP INLETS TYPE B	U	2.00	\$1,330.00	\$2,660.00	\$1,800.00	\$3,600.00	(\$940.00)
604.4	RECONSTRUCTING/ADJUSTING CATCH BASIN & DROP INLET	LF	32.00	\$330.00	\$10,560.00	\$350.00	\$11,200.00	(\$640.00)
604.62	DRAINAGE MANHOLE COVERS AND FRAMES	EA	2.00	\$355.00	\$710.00	\$350.00	\$700.00	\$10.00
604.9101	OUTLET CONTROL STRUCTURE	U	1.00	\$2,850.00	\$2,850.00	\$4,000.00	\$4,000.00	(\$1,150.00)
604.9102	OUTLET CONTROL STRUCTURE	U	1.00	\$2,850.00	\$2,850.00	\$4,000.00	\$4,000.00	(\$1,150.00)
606.0001	STEEL BEAM FOR BEAM GUARDRAIL, INCLUDING HARDWARE	LF	75.00	\$28.00	\$2,100.00	\$6.00	\$450.00	\$1,650.00
606.0142	6"X8" WOOD POST ASSEMBLIES FOR BEAM GUARDRAIL POSTS	EA	6.00	\$48.00	\$288.00	\$15.00	\$90.00	\$198.00
607.9306	RESETTING CHAIN LINK FENCE WITH VINYL COATED STEEL FABRIC, 6' HIGH	LF	54.00	\$30.00	\$1,620.00	\$20.00	\$1,080.00	\$540.00
608.12	2" BITUMINOUS SIDEWALK (F)	SY	500.00	\$13.00	\$6,500.00	\$20.00	\$10,000.00	(\$3,500.00)
608.24	4" CONCRETE SIDEWALK (F)	SY	12.00	\$70.00	\$840.00	\$50.00	\$600.00	\$240.00
608.54	DETECTABLE WARNING DEVICES, CAST IRON	SY	1.00	\$500.00	\$500.00	\$350.00	\$350.00	\$150.00
609.02	CURVED GRANITE CURB	LF	300.00	\$27.50	\$8,250.00	\$30.00	\$9,000.00	(\$750.00)
609.5	RESET GRANITE CURB	LF	2,500.00	\$6.00	\$15,000.00	\$9.00	\$22,500.00	(\$7,500.00)
614.331	3" STEEL CONDUIT	LF	50.00	\$20.00	\$1,000.00	\$18.00	\$900.00	\$100.00
614.511	CONCRETE PULL BOX 14"	EA	2.00	\$350.00	\$700.00	\$350.00	\$700.00	\$0.00
614.522	MOLDED PULL BOX 13"X24"	EA	3.00	\$350.00	\$1,050.00	\$300.00	\$900.00	\$150.00
614.523	MOLDED PULL BOX 17"X30"	EA	9.00	\$380.00	\$3,420.00	\$400.00	\$3,600.00	(\$180.00)
614.72114	2" PVC CONDUIT, SCHEDULE 40	LF	645.00	\$7.00	\$4,515.00	\$7.50	\$4,837.50	(\$322.50)
614.72118	2" PVC CONDUIT, SCHEDULE 80	LF	36.00	\$18.00	\$648.00	\$18.00	\$648.00	\$0.00

## A - PS&amp;E Comparison

Item No:	Description	Unit	Quantity	A-Bidder		PS&E		A-PS&E Difference
				Unit Price	Total	Unit Price	Total	
614.73118	3" PVC CONDUIT, SCHEDULE 80	LF	100.00	\$20.00	\$2,000.00	\$20.00	\$2,000.00	\$0.00
614.73214	3" 2-DUCT PVC CONDUIT, SCHEDULE 40	LF	1,150.00	\$9.50	\$10,925.00	\$10.00	\$11,500.00	(\$575.00)
614.74118	4" PVC CONDUIT, SCHEDULE 80	LF	65.00	\$28.00	\$1,820.00	\$20.00	\$1,300.00	\$520.00
615.02	TRAFFIC SIGN TYPE B (F)	SF	5.00	\$30.00	\$150.00	\$60.00	\$300.00	(\$150.00)
615.03	TRAFFIC SIGN TYPE C (F)	SF	125.25	\$30.00	\$3,757.50	\$40.00	\$5,010.00	(\$1,252.50)
615.06	TRAFFIC SIGN TYPE CC (F)	SF	15.75	\$10.00	\$157.50	\$15.00	\$236.25	(\$78.75)
618.61	UNIFORMED OFFICERS WITH VEHICLE	\$	6,000.00	\$1.00	\$6,000.00	\$1.00	\$6,000.00	\$0.00
618.7	FLAGGERS	HR	900.00	\$12.50	\$11,250.00	\$22.00	\$19,800.00	(\$8,550.00)
619.1	MAINTENANCE OF TRAFFIC	U	1.00	\$11,800.00	\$11,800.00	\$25,000.00	\$25,000.00	(\$13,200.00)
619.25	PORTABLE CHANGEABLE MESSAGE SIGN	U	2.00	\$2,910.00	\$5,820.00	\$3,500.00	\$7,000.00	(\$1,180.00)
621.61	FIBER OPTIC DELINEATOR	EA	3.00	\$150.00	\$450.00	\$150.00	\$450.00	\$0.00
625.25	CONCRETE LIGHT POLE BASE TYPE B (2' REVEAL)	EA	2.00	\$950.00	\$1,900.00	\$800.00	\$1,600.00	\$300.00
625.622	RESET/RELOCATE LIGHT POLE WITHOUT BREAKAWAY BASE	EA	2.00	\$1,100.00	\$2,200.00	\$525.00	\$1,050.00	\$1,150.00
628.2	SAWED BITUMINOUS PAVEMENT	LF	630.00	\$1.50	\$945.00	\$2.00	\$1,260.00	(\$315.00)
632.0104	RETROREFLECTIVE PAINT PAVE. MARKING, 4" LINE	LF	43,700.00	\$0.35	\$15,295.00	\$0.20	\$8,740.00	\$6,555.00
632.0106	RETROREFLECTIVE PAINT PAVE. MARKING, 6" LINE	LF	300.00	\$0.25	\$75.00	\$0.40	\$120.00	(\$45.00)
632.0118	RETROREFLECTIVE PAINT PAVE. MARKING, 18" LINE	LF	550.00	\$2.00	\$1,100.00	\$3.00	\$1,650.00	(\$550.00)
632.02	RETROREFLECTIVE PAINT PAVEMENT MARKING, SYMBOL OR WORD	SF	120.00	\$5.00	\$600.00	\$2.00	\$240.00	\$360.00
632.911	OBLITERATE PAVE. MARKING LINE, 12" WIDE & UNDER	LF	19,700.00	\$0.50	\$9,850.00	\$0.25	\$4,925.00	\$4,925.00

## A - PS&E Comparison

Item No.	Description	Unit	Quantity	A-Bidder		PS&E		A-PS&E Difference
				Unit Price	Total	Unit Price	Total	
632.92	OBLITERATE PAVEMENT MARKING, SYMBOL OR WORD	SF	350.00	\$1.00	\$350.00	\$1.00	\$350.00	\$0.00
641	LOAM	CY	460.00	\$15.50	\$7,130.00	\$25.00	\$11,500.00	(\$4,370.00)
645.3	EROSION STONE	TON	60.00	\$24.50	\$1,470.00	\$35.00	\$2,100.00	(\$630.00)
645.43	TEMPORARY SLOPE STABILIZATION TYPE C	SY	570.00	\$1.90	\$1,083.00	\$2.00	\$1,140.00	(\$57.00)
645.531	SILT FENCE	LF	2,200.00	\$2.00	\$4,400.00	\$3.00	\$6,600.00	(\$2,200.00)
645.7	STORM WATER POLLUTION PREVENTION PLAN	U	1.00	\$2,500.00	\$2,500.00	\$2,500.00	\$2,500.00	\$0.00
645.71	MONITORING SWPPP AND EROSION AND SEDIMENT CONTROLS	HR	80.00	\$65.00	\$5,200.00	\$55.00	\$4,400.00	\$800.00
646.31	TURF ESTABLISHMENT WITH MULCH AND TACKIFIERS	SY	4,850.00	\$0.40	\$1,940.00	\$1.00	\$4,850.00	(\$2,910.00)
650.2	LANDSCAPING	U	1.00	\$54,700.00	\$54,700.00	\$25,000.00	\$25,000.00	\$29,700.00
670.02	SEDIMENT SUMP MEASURING BLOCK	EA	2.00	\$385.00	\$770.00	\$450.00	\$900.00	(\$130.00)
677.51024	24-STRAND SINGLE MODE FIBER OPTIC CABLE	LF	925.00	\$4.20	\$3,885.00	\$4.00	\$3,700.00	\$185.00
677.53	FIBER OPTIC SPLICE	EA	2.00	\$2,320.00	\$4,640.00	\$2,500.00	\$5,000.00	(\$360.00)
677.562	FIBER OPTIC PATCH PANEL (24-POSITION)	EA	2.00	\$2,650.00	\$5,300.00	\$1,500.00	\$3,000.00	\$2,300.00
677.5822	1 GBPS FIBER ETHERNET SWITCH	EA	1.00	\$3,630.00	\$3,630.00	\$3,750.00	\$3,750.00	(\$120.00)
692	MOBILIZATION	U	1.00	\$55,000.00	\$55,000.00	\$50,000.00	\$50,000.00	\$5,000.00
697.11	INVASIVE SPECIES CONTROL AND MANAGEMENT PLAN	U	1.00	\$1,110.00	\$1,110.00	\$500.00	\$500.00	\$610.00
699	MISCELLANEOUS TEMPORARY EROSION AND SEDIMENT CONTROL	\$	5,000.00	\$1.00	\$5,000.00	\$1.00	\$5,000.00	\$0.00
1010.15	FUEL ADJUSTMENT	\$	10,000.00	\$1.00	\$10,000.00	\$1.00	\$10,000.00	\$0.00
1010.2	ASPHALT CEMENT ADJUSTMENT	\$	10,000.00	\$1.00	\$10,000.00	\$1.00	\$10,000.00	\$0.00

\$686,674.50

\$717,911.75

(\$31,237.25)







# CERTIFICATE OF LIABILITY INSURANCE

DATE (MM/DD/YYYY)  
7/23/2014

THIS CERTIFICATE IS ISSUED AS A MATTER OF INFORMATION ONLY AND CONFERS NO RIGHTS UPON THE CERTIFICATE HOLDER. THIS CERTIFICATE DOES NOT AFFIRMATIVELY OR NEGATIVELY AMEND, EXTEND OR ALTER THE COVERAGE AFFORDED BY THE POLICIES BELOW. THIS CERTIFICATE OF INSURANCE DOES NOT CONSTITUTE A CONTRACT BETWEEN THE ISSUING INSURER(S), AUTHORIZED REPRESENTATIVE OR PRODUCER, AND THE CERTIFICATE HOLDER.

**IMPORTANT:** If the certificate holder is an ADDITIONAL INSURED, the policy(ies) must be endorsed. If SUBROGATION IS WAIVED, subject to the terms and conditions of the policy, certain policies may require an endorsement. A statement on this certificate does not confer rights to the certificate holder in lieu of such endorsement(s).

<b>PRODUCER</b> THE ROWLEY AGENCY INC. 139 Loudon Road P.O. Box 511 Concord NH 03302-0511	<b>CONTACT NAME:</b> Donna Bickford <b>PHONE (A/C No Ext):</b> (603) 224-2562 <b>FAX (A/C No):</b> (603) 224-8012 <b>E-MAIL ADDRESS:</b> dbickford@rowleyagency.com
	<b>INSURER(S) AFFORDING COVERAGE</b> <b>INSURER A:</b> Liberty Mutual Fire Ins. Co. <b>INSURER B:</b> Starr Indemnity <b>INSURER C:</b> Maine Employers Mutual AIns Co <b>INSURER D:</b> <b>INSURER E:</b> <b>INSURER F:</b>
<b>INSURED</b> Alvin J. Coleman & Son, Inc. 9 NH Route 113 Conway NH 03818-9505	

**COVERAGES**                      **CERTIFICATE NUMBER:** 2014-15 AJC cet                      **REVISION NUMBER:**

THIS IS TO CERTIFY THAT THE POLICIES OF INSURANCE LISTED BELOW HAVE BEEN ISSUED TO THE INSURED NAMED ABOVE FOR THE POLICY PERIOD INDICATED. NOTWITHSTANDING ANY REQUIREMENT, TERM OR CONDITION OF ANY CONTRACT OR OTHER DOCUMENT WITH RESPECT TO WHICH THIS CERTIFICATE MAY BE ISSUED OR MAY PERTAIN, THE INSURANCE AFFORDED BY THE POLICIES DESCRIBED HEREIN IS SUBJECT TO ALL THE TERMS, EXCLUSIONS AND CONDITIONS OF SUCH POLICIES. LIMITS SHOWN MAY HAVE BEEN REDUCED BY PAID CLAIMS.

INSR LTR	TYPE OF INSURANCE	ADDL SUBR INSR WVD	POLICY NUMBER	POLICY EFF (MM/DD/YYYY)	POLICY EXP (MM/DD/YYYY)	LIMITS
A	<b>GENERAL LIABILITY</b> <input checked="" type="checkbox"/> COMMERCIAL GENERAL LIABILITY <input type="checkbox"/> CLAIMS-MADE <input checked="" type="checkbox"/> OCCUR GEN'L AGGREGATE LIMIT APPLIES PER: <input type="checkbox"/> POLICY <input checked="" type="checkbox"/> PRO-JECT <input type="checkbox"/> LOC		TB2Z11261307064	7/1/2014	7/1/2015	EACH OCCURRENCE \$ 1,000,000 DAMAGE TO RENTED PREMISES (Ea occurrence) \$ 300,000 MED EXP (Any one person) \$ 5,000 PERSONAL & ADV INJURY \$ 1,000,000 GENERAL AGGREGATE \$ 2,000,000 PRODUCTS - COMP/OP AGG \$ 2,000,000
	<b>AUTOMOBILE LIABILITY</b> <input checked="" type="checkbox"/> ANY AUTO <input type="checkbox"/> ALL OWNED AUTOS <input checked="" type="checkbox"/> HIRED AUTOS <input type="checkbox"/> SCHEDULED AUTOS <input checked="" type="checkbox"/> NON-OWNED AUTOS		AS2Z11261307014	7/1/2014	7/1/2015	COMBINED SINGLE LIMIT (Ea accident) \$ 2,000,000 BODILY INJURY (Per person) \$ BODILY INJURY (Per accident) \$ PROPERTY DAMAGE (Per accident) \$
B	<b>UMBRELLA LIAB</b> <input checked="" type="checkbox"/> OCCUR <input checked="" type="checkbox"/> EXCESS LIAB <input type="checkbox"/> CLAIMS-MADE DED \$      RETENTION \$ 0		1000021034	7/1/2014	7/1/2015	EACH OCCURRENCE \$ 10,000,000 AGGREGATE \$ 10,000,000
C	<b>WORKERS COMPENSATION AND EMPLOYERS' LIABILITY</b> ANY PROPRIETOR/PARTNER/EXECUTIVE OFFICER/MEMBER EXCLUDED? (Mandatory in NH) If yes, describe under DESCRIPTION OF OPERATIONS below	Y/N N	N/A 1810091667 3A STATES: ME	7/1/2014	7/1/2015	<input checked="" type="checkbox"/> WC STATUTORY LIMITS <input type="checkbox"/> OTHER E.L. EACH ACCIDENT \$ 500,000 E.L. DISEASE - EA EMPLOYEE \$ 500,000 E.L. DISEASE - POLICY LIMIT \$ 500,000

DESCRIPTION OF OPERATIONS / LOCATIONS / VEHICLES (Attach ACORD 101, Additional Remarks Schedule, if more space is required)  
 Project: Portsmouth X-A004(090), 20222B  
 The State of New Hampshire-Department of Transportation is included as an additional insured on all liability policies except workers comp when required by written contract with the named insured.

<b>CERTIFICATE HOLDER</b>  State of New Hampshire-Dept of Transporta PO Box 483 Concord, NH 03302-0483	<b>CANCELLATION</b>  SHOULD ANY OF THE ABOVE DESCRIBED POLICIES BE CANCELLED BEFORE THE EXPIRATION DATE THEREOF, NOTICE WILL BE DELIVERED IN ACCORDANCE WITH THE POLICY PROVISIONS.  AUTHORIZED REPRESENTATIVE  Donna Bickford/DTB <i>Donna L. Bickford</i>
--	---



# CERTIFICATE OF LIABILITY INSURANCE

DATE (MM/DD/YYYY)  
7/23/2014

THIS CERTIFICATE IS ISSUED AS A MATTER OF INFORMATION ONLY AND CONFERS NO RIGHTS UPON THE CERTIFICATE HOLDER. THIS CERTIFICATE DOES NOT AFFIRMATIVELY OR NEGATIVELY AMEND, EXTEND OR ALTER THE COVERAGE AFFORDED BY THE POLICIES BELOW. THIS CERTIFICATE OF INSURANCE DOES NOT CONSTITUTE A CONTRACT BETWEEN THE ISSUING INSURER(S), AUTHORIZED REPRESENTATIVE OR PRODUCER, AND THE CERTIFICATE HOLDER.

IMPORTANT: If the certificate holder is an ADDITIONAL INSURED, the policy(ies) must be endorsed. If SUBROGATION IS WAIVED, subject to the terms and conditions of the policy, certain policies may require an endorsement. A statement on this certificate does not confer rights to the certificate holder in lieu of such endorsement(s).

PRODUCER THE ROWLEY AGENCY INC. 139 Loudon Road P.O. Box 511 Concord NH 03302-0511	CONTACT NAME: Donna Bickford
	PHONE (A/C, No, Ext): (603) 224-2562 FAX (A/C, No): (603) 224-8012 E-MAIL ADDRESS: dbickford@rowleyagency.com
INSURED State of NH - Dept. of Transportation c/o Alvin J Coleman & Son Inc 9 NH Route 113 Conway NH 03818-9505	INSURER(S) AFFORDING COVERAGE
	INSURER A: Liberty Mutual Fire Ins. Co.
	INSURER B:
	INSURER C:
	INSURER D:
	INSURER E:

COVERAGES CERTIFICATE NUMBER: 14-15 OCP REVISION NUMBER:

THIS IS TO CERTIFY THAT THE POLICIES OF INSURANCE LISTED BELOW HAVE BEEN ISSUED TO THE INSURED NAMED ABOVE FOR THE POLICY PERIOD INDICATED. NOTWITHSTANDING ANY REQUIREMENT, TERM OR CONDITION OF ANY CONTRACT OR OTHER DOCUMENT WITH RESPECT TO WHICH THIS CERTIFICATE MAY BE ISSUED OR MAY PERTAIN, THE INSURANCE AFFORDED BY THE POLICIES DESCRIBED HEREIN IS SUBJECT TO ALL THE TERMS, EXCLUSIONS AND CONDITIONS OF SUCH POLICIES. LIMITS SHOWN MAY HAVE BEEN REDUCED BY PAID CLAIMS.

INSR LTR	TYPE OF INSURANCE	ADDL SUBR INSR WVD	POLICY NUMBER	POLICY EFF (MM/DD/YYYY)	POLICY EXP (MM/DD/YYYY)	LIMITS
A	GENERAL LIABILITY		TF1-Z11-261307-084	08/01/2014	08/01/2015	EACH OCCURRENCE \$ 2,000,000
	<input type="checkbox"/> COMMERCIAL GENERAL LIABILITY					DAMAGE TO RENTED PREMISES (Ea occurrence) \$
	<input type="checkbox"/> CLAIMS-MADE <input checked="" type="checkbox"/> OCCUR					MED EXP (Any one person) \$
	<input checked="" type="checkbox"/> Owners & Contractors					PERSONAL & ADV INJURY \$
	GEN'L AGGREGATE LIMIT APPLIES PER:					GENERAL AGGREGATE \$ 3,000,000
	<input checked="" type="checkbox"/> POLICY <input type="checkbox"/> PRO-JECT <input type="checkbox"/> LOC					PRODUCTS - COM/OP AGG \$
	AUTOMOBILE LIABILITY					COMBINED SINGLE LIMIT (Ea accident) \$
	<input type="checkbox"/> ANY AUTO					BODILY INJURY (Per person) \$
	<input type="checkbox"/> ALL OWNED AUTOS	<input type="checkbox"/> SCHEDULED AUTOS				BODILY INJURY (Per accident) \$
	<input type="checkbox"/> HIRED AUTOS	<input type="checkbox"/> NON-OWNED AUTOS				PROPERTY DAMAGE (Per accident) \$
	UMBRELLA LIAB	<input type="checkbox"/> OCCUR				EACH OCCURRENCE \$
	EXCESS LIAB	<input type="checkbox"/> CLAIMS-MADE				AGGREGATE \$
	DED	RETENTION \$				\$
	WORKERS COMPENSATION AND EMPLOYERS' LIABILITY					WC STATUTORY LIMITS OTH-ER
	ANY PROPRIETOR/PARTNER/EXECUTIVE OFFICER/MEMBER EXCLUDED? (Mandatory in NH)	<input type="checkbox"/> Y/N	N/A			E.L. EACH ACCIDENT \$
	If yes, describe under DESCRIPTION OF OPERATIONS below					E.L. DISEASE - EA EMPLOYEE \$
						E.L. DISEASE - POLICY LIMIT \$

DESCRIPTION OF OPERATIONS / LOCATIONS / VEHICLES (Attach ACORD 101, Additional Remarks Schedule, if more space is required)

Re: NHDOT-Portsmouth 20222B - Minor expansion and reconfiguration of the Portsmouth Transportation Center, the park and ride facility located on the southern end of Pease Tradeport in Portsmouth, NH

### CERTIFICATE HOLDER

### CANCELLATION

State of NH-Department of Transportation PO Box 483 Concord, NH 03302-0483	SHOULD ANY OF THE ABOVE DESCRIBED POLICIES BE CANCELLED BEFORE THE EXPIRATION DATE THEREOF, NOTICE WILL BE DELIVERED IN ACCORDANCE WITH THE POLICY PROVISIONS.
	AUTHORIZED REPRESENTATIVE  Donna Bickford/DTB <i>Donna L. Bickford</i>