



The State of New Hampshire
DEPARTMENT OF ENVIRONMENTAL SERVICES

Thomas S. Burack, Commissioner



September 20, 2013

Her Excellency, Governor Margaret Wood Hassan
and The Honorable Council
State House
Concord, NH 03301

REQUESTED ACTION

Approve Exeter Mills LLC's request to perform the following work on Squamscott River, in Exeter. File # 2013-00512. This project will not have significant impact on or adversely affect the values of Squamscott River.

Construct a 6 ft. x 20 ft. permanent pier leading to a 4 ft. x 35 ft. seasonal gangway landing on a 10 ft. x 20 ft. seasonal float to provide all-tide water access on 730 linear ft. of shoreline frontage on the Squamscott River.

The Department imposed the following conditions as part of this approval:

1. All work shall be in accordance with plans by Riverside & Pickering Marine Contractors dated January 30, 2013 and revised July 5, 2013, as received by DES on July 18, 2013.
2. Any further alteration of areas on this property that are within the jurisdiction of the DES Wetlands Bureau will require a new application and/or further permitting by the Bureau.
3. DES Wetlands Bureau Southeast Region staff and the Exeter Conservation Commission shall be notified in writing prior to commencement of work and upon its completion.
4. This permit shall not be effective until it has been recorded with the Rockingham County Registry of Deeds office by the Permittee. A copy of the recorded permit shall be submitted to the DES Wetlands Bureau by certified mail, return receipt requested, prior to construction.
5. All activities shall be in accordance with the Shoreland Water Quality Protection Act, RSA 483-B. The owner is responsible for obtaining any Shoreland Permit that may be required per RSA 483-B, for construction, excavation or fill that will occur within the Protected Shoreland.

EXPLANATION

The DES Wetlands Bureau approved this project on August 16, 2013. DES supported its decision with the following findings:

1. This is a major impact project per Administrative Rule Env-Wt 303.02(a).

DES Web site: www.des.nh.gov

P.O. Box 95, 29 Hazen Drive, Concord, New Hampshire 03302-0095

Telephone: (603) 271-2147 • Fax: (603) 271-6588 • TDD Access: Relay NH 1-800-735-2964

2. The need for the proposed impacts has been demonstrated by the applicant per Env-Wt 302.01.
3. The applicant has provided evidence which demonstrates that this proposal is the alternative with the least adverse impact to areas and environments under the department's jurisdiction per Env-Wt 302.03.
4. The applicant has demonstrated by plan and example that each factor listed in Env-Wt 302.04(a) and (c), Requirements for Application Evaluation, has been considered in the design of the project.
5. A memo from the NH Natural Heritage Bureau (NHB) dated January 23, 2013 identified the spongy-leaved arrowhead (*Sagittaria montevidensis* ssp. *spongiosa*) in the vicinity of the proposed impacts. NHB recommended a survey of this plant at this particular location to avoid and minimize impacts to this state-endangered species.
6. In response to the NHB memo, the applicant had the area surveyed for spongy-leaved arrowhead and repositioned the docking system north and added an additional 5 ft. to the gangway to ensure the float will not impact the plant. The NHB "does not expect impact to this population."
7. DES Staff conducted a field inspection of the proposed project on August 15, 2013. Inspections confirmed the location of the salt marsh, the proposed pier, and found the spongy-leaved arrowhead as identified in the NHB memo and plans.
8. This structure will have no adverse impact on the marine resources in the area.
9. The NH PDA Division of Ports and Harbors, Chief Harbor Master has determined that "...the structure will have no negative effect on navigation in the channel."
10. No comments were received from federal agencies.
11. The Exeter Conservation Commission "voted not to oppose the application as proposed."

Application file documents are being forwarded to the Governor and Executive Council in connection with their consideration of this matter pursuant to RSA 482-A:3, II.(a) as it is a major project in public waters of the state.

We respectfully submit this request for your consideration.

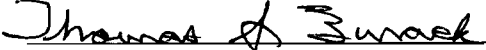
Thomas S. Burack
Commissioner



THE STATE OF NEW HAMPSHIRE
 DEPARTMENT OF ENVIRONMENTAL SERVICES
 LAND RESOURCES MANAGEMENT
 WETLANDS BUREAU
 29 Hazen Drive, PO Box 95
 Concord, NH 03302-0095



Phone: (603) 271-2147 Fax: (603) 271-6588
 Website: <http://des.nh.gov/organization/divisions/water/wetlands/index.htm>
 Permit Application Status: <http://des.nh.gov/onestop/index.htm>

WETLANDS PERMIT APPLICATION

RECEIVED Administrative Use Only FEB 21 2013 NHDES LAND RESOURCES MANAGEMENT	COMPLETE Administrative Use Only FEB 21 2013	Administrative Use Only	File Number: 2013-00512
			Check No. 5045
			Amount \$880.00
			Initials Emk

1. REVIEW TIME AND IMPACT TYPE: Use Attachment "A" to determine review time and impact type.

Expedited Review, Minimum Impact
 Standard Review, Minimum Impact
 Standard Review, Minor or Major Impact

2. PROJECT LOCATION:

ADDRESS: 10 Chestnut Street		TOWN/CITY: Exeter	
TAX MAP: 64	BLOCK:	LOT: 51	UNIT:
LOCATION COORDINATES: N 177,017.42 E 1,176,884.23		<input type="checkbox"/> Latitude/Longitude <input type="checkbox"/> UTM <input checked="" type="checkbox"/> State Plane	

3. PROPERTY OWNER INFORMATION:

NAME: Exeter Mills, LLC	
EMAIL or FAX: * See Applicant Info	PHONE: * See Applicant Info
MAILING ADDRESS: 8 Newmarket Road, Suite 2	
TOWN/CITY: Durham	STATE: NH ZIP CODE: 03824

4. APPLICANT INFORMATION:

NAME: Zachary Taylor, Riverside & Pickering Marine Contractors	
EMAIL or FAX: zach@riversideandpickering.com	PHONE: (207) 451-9229
MAILING ADDRESS: P.O. Box 368	
TOWN/CITY: Eliot	STATE: ME ZIP CODE: 03903

5. AGENT INFORMATION:

NAME:	COMPANY NAME:
EMAIL or FAX:	PHONE:
MAILING ADDRESS:	
TOWN/CITY:	STATE: ZIP CODE:

6. CHECK BOX TO INDICATE APPLICABLE PROJECT TYPES:

- | | |
|--|--|
| <input type="checkbox"/> Excluding culverts and bridges, all work in the bed or bank of a lake/pond of which the property owner(s) listed on page 1 do NOT own the entire bed and banks of the lake/pond.
<input checked="" type="checkbox"/> Dock construction, maintenance, repair or replacement on a RIVER. | <input type="checkbox"/> Work in a wetland, stream, river (excluding docks on rivers), prime wetland, prime wetland buffer, tidal water, salt marsh, sand dune, tidal buffer zone or in a pond of which the entire bed and banks are owned by the property owner(s) listed on page 1.
<input type="checkbox"/> All culvert and bridge construction, maintenance, repair or replacement. |
|--|--|

7. PROJECT DESCRIPTION:

- 1) Construct and install a 6'X20' fixed pier and associated access ramp with a 4'X30' arched aluminum gangway installed at the end of the pier leading down to a 10'X20' float located by moorings.
 2) The size of the parcel is +/- 7.0 acres.

8. INDICATE AREA OF PROPOSED IMPACTS FOR EACH RESOURCE:

Resource:	Permanent Sq. Ft.	Permanent Lin. Ft.	Temporary Sq. Ft.	Temporary Lin. Ft.	After-the-fact Sq. Ft.	After-the-fact Lin. Ft.
Forested wetland		-		-		-
Scrub-shrub wetland		-		-		-
Emergent wetland		-		-		-
Wet meadow		-		-		-
Bog		-		-		-
Prime wetland		-		-		-
Prime wetland buffer		-		-		-
Docking structure	180	-	320	-		-
Tidal Buffer Zone		-		-		-
Tidal water		-		-		-
Salt Marsh		-		-		-
Sand dune		-		-		-
Intermittent Stream						
Perennial Stream						
River						
Lake						
Pond						
Other						

Total	180	320			
-------	-----	-----	--	--	--

9 - 13. IF APPLICABLE, PROVIDE:

9. Cubic yards of proposed sand for beach replenishment:

10. Cubic yards of proposed dredge material for surface water dredge:

11. Contributing watershed size(s) of impacted stream(s) and river(s) (acres or square miles):

12. U. S. Geological Survey Topographic Map Waterbody name: **Squamscott River**

13. ONLY Required for docking structures	(a) Straight line distance pin to pin (lin. ft.)	(b) Actual natural navigable shoreline pin to pin (lin. ft.)	(a) + (b) / 2 = Shoreline Frontage (lin. ft.):
	681.35'	+/- 779'	730.175'

14. APPLICATION FEE:

Minimum Impact, Expedited Review Application: Flat fee of \$ 200

- OR -

Minimum, Minor or Major Impact, Standard Review Application: Complete calculation below

Total temporary and permanent impacts:	_____ sq. ft.	X \$0.20 =	_____
Temporary Docking Structure:	320 sq. ft.	X \$1.00 =	320.00
Permanent Docking Structure:	180 sq. ft.	X \$2.00 =	360.00
Projects proposing shoreline structures add \$200 or NA =			200.00
Total =			\$880.00
The Application Fee is above calculated Total or \$200, whichever is greater =			\$880.00

15. INDICATE RELATED FILE / APPROVAL NO. AND STATUS:

Existing Wetlands Bureau file no. this application is replacing:

Wetlands Bureau enforcement (subject and abutting properties):

Wetlands Bureau emergency authorization (subject property):

Wetlands Bureau denials (subject and abutting properties):

Wetlands Bureau withdrawals (subject and abutting properties):

Wetlands Bureau approvals (subject and abutting properties):

Shoreland Program waiver or permit:

Alteration of Terrain Bureau:

Watershed Management Program:

Subsurface Systems Bureau:

Other NHDES Programs and Bureaus:

City/Town:

State Agencies:

Federal Agencies:

16. THE SUBMITTED APPLICATION WILL BE RETURNED TO YOU IF THE FOLLOWING INFORMATION IS NOT PROVIDED:

- A. Attach application fee, check or money order payable to the NH DES Wetlands Bureau (RSA 482-A:3,I & Env-Wt 505.01(c))
- B. Applicant and Town Clerk signatures, numbers 19 and 23 on pages 5 and 6 of this form (Env-Wt 501.01(d)&(e) & 505.01(m)&(o))
- C. Narrative description of the proposed project, number 7 on page 2 of this form (Env-Wt 501.02(a) & 505.01(l))
- D. Documentation from Department of Resources and Economic Development's Natural Heritage Bureau (NHB) indicating that NHB has reviewed your project. Documentation can be obtained online at: <https://www2.des.state.nh.us/nhbdatacheck/> or by phone (603) 271-2215 x 323. Please attach the REQUIRED letter/memo and map provided by NHB.
- E. Attach a U. S. Geological Survey topographic map upon which the property lines and project limits have been outlined. The map must be at an unaltered scale of 1:24,000 or 1" = 2,000 feet (1:25,000 metric map). (Env-Wt 501.02(a)(4) & 505.01(g))
- F. Attach a legible copy or tracing of the tax map from the municipal office (Env-Wt 501.02(a)(1)& 505.01(e))
- G. Attach legible and labeled color photographs clearly depicting the jurisdictional areas to be impacted, the resource outside of impact area, any shoreline structures and culvert inlet/outlets (Env-Wt 501.02(a)(3) & 505.01(i))
- H. Attach overview, cross-section and profile plans as applicable (Env-Wt 501.02(a)(2) & 505.01(h))

17A. INFORMATION REQUIRED FOR COMPLETION OF TECHNICAL REVIEW FOR ALL PROJECTS:

- A. Is the project within a ¼ mile of a designated river? <http://des.nh.gov/organization/divisions/water/wmb/rivers/designriv.htm>
 - Y N. **If yes:** 1. Indicate river: Exeter/Squamscott
 - 2. As required by RSA 482-A:3,I(d)(2), I have notified the Local River Advisory Committee (<http://des.nh.gov/organization/divisions/water/wmb/rivers/lac/index.htm>) by sending a copy of the complete application and supporting materials via certified mail on: **Day: 2 Month: 19 Year: 2013**
 - 3. Attach a copy of the certified mail receipt with your application submittal (RSA 482-A:3,I(d)(2))
- B. Attach a completed U.S. Army Corps of Engineers New Hampshire Programmatic General Permit (PGP) Appendix B – Required Information and Corps Secondary Impact Checklist (Attachment B).
- C. Does the project require compensatory mitigation pursuant to Env-Wt 302.03? Y N
If yes, attach materials outlined in AND a completed Mitigation Agreement Form (Env-Wt 501.02(a)(6) & 501.06)
Link: http://des.nh.gov/organization/commissioner/pip/forms/wetlands/documents/mitigation_form.doc
- D. Attach a copy or tracing of the town tax map showing the property of the applicant, the location of the proposed project on the property, and the location of properties of abutters with each lot labeled with the abutter's name(s) and mailing address(es); or a list of abutters' names and mailing addresses to cross-reference with the tax map (Env-Wt 501.02(a)(1) & 505.01(f)). Abutter Notification Exceptions see Env-Wt 501.01(c)
- E. Attach a construction sequence (Env-Wt 501.02(a)(5) & 505.01)
- F. Is/are (a) waiver(s) to wetland rules being requested? Y N **If yes,** attach the waiver request(s) as outlined in Env-Wt 204
- G. All stream/river crossing projects, attach a response to Env-Wt 904.01, General Design Considerations (except single family residential access for Tier 1 and Tier 2 crossings pursuant to Env-Wt 303.04(z) & 901.03(e))
- H. If the applicant is not the property owner, attach a written letter of permission from the property owner granting the applicant permission to act on their behalf
- I. Will impacts occur within 20 feet of an abutting property line or imaginary extension thereof over surface water? Y N
If yes, attach the signed permission letter(s) from the affected abutters (Env-Wt 304.04). This letter must be notated if your project is a boat docking facility (RSA 482-A:3-XIII(c))

17B. INFORMATION REQUIRED FOR COMPLETION OF TECHNICAL REVIEW FOR MINIMUM IMPACT PROJECTS:

- J. Refer to Attachment A: Determination for Project Impact Classification & Review Time, Section 2: Minimum Impact Project Requirements, and indicate the letter for the Minimum Impact rule that describes your project: **Env-Wt 303.04** ____
- K. Attach required pages from Attachment A: Determination for Project Impact Classification & Review Time, as instructed on the attachment.
- L. Attach a statement demonstrating need for the proposed project (Pursuant to Env-Wt 302.03)
- M. Attach a statement demonstrating that the proposal is the alternative with the least adverse impact to areas and environments under the department's jurisdiction in accordance with Env-Wt 302.03. (Env-Wt 505.01(d)&(y)).

17C. INFORMATION REQUIRED FOR COMPLETION OF TECHNICAL REVIEW FOR MINOR AND MAJOR IMPACT PROJECTS:

- N. Attach a response to questions outlined in Env-Wt 302.04(a)
- O. Attach a vernal pool survey and report (Env-Wt 302.04(a))
- P. If a wetland delineation is required, provide a NH Certified Wetland Scientist Stamp on attached plans (Env-Wt 301.01)

18. SEE LISTED WETLAND RULE(S) FOR APPLICABLE PROJECT TYPE(S) PLAN REQUIREMENTS:

<input type="checkbox"/> Minimum	Env-Wt 505.01
<input checked="" type="checkbox"/> Minor and Major	Env-Wt 501.02
<input type="checkbox"/> Subdivision	Env-Wt 304.09(c)
<input type="checkbox"/> Vegetative & riprap bank stabilization (river, stream, lake, pond)	Env-Wt 404.03 & 404.04
<input type="checkbox"/> Retaining Walls	Env-Wt 404.05
<input type="checkbox"/> Shoreline	Env-Wt 501.02(c)
<input checked="" type="checkbox"/> Tidal	Env-Wt 501.02(b)
<input type="checkbox"/> Protected Shoreland (SWQP)	Env-Wt 501.02(d)
<input type="checkbox"/> New Tier 1 Stream Crossing (Exempt: Env-Wt 303.04(z))	Env-Wt 903.03(a) & 904.01
<input type="checkbox"/> Tier 1 stream crossing or replacement	Env-Wt 903.03(a) & 904.01
<input type="checkbox"/> New Tier 2 stream crossing (Exempt: Env-Wt 303.04(z))	Env-Wt 903.03(a), 904.01, 904.03 (e), 904.03(f)
<input type="checkbox"/> Tier 2 stream crossing repair or replacement	Env-Wt 903.03(a), 904.01, 904.03 (e), 904.03(f)
<input type="checkbox"/> All Tier 3 Stream Crossings	Env-Wt 903.03 (a) & (b) , 904.01, 904.04(d), 904.04(g), 904.05

Wetland Rules Link: <http://des.nh.gov/organization/commissioner/legal/rules/documents/env-wt100-900.pdf>

19. APPLICANT AND AGENT SIGNATURES REQUIRED FOR ALL APPLICATIONS:

By signing the application, I am certifying that:

1. All abutters have been identified in accordance with RSA 482-A:3, I and Env-Wt 100-900.
2. I have read and provided the required information outlined in Env-Wt 302.04 for the applicable project type.
3. I have read and understand Env-Wt 302.03 and have chosen the least impacting alternative.
4. Any structure that I am proposing to repair/replace was either previously permitted by the Wetlands Bureau or would be considered grandfathered per Env-Wt 101.44.
5. I have submitted a copy of the application materials to the NH State Historic Preservation Officer.
6. I authorize the municipal conservation commission to inspect the site of the proposed project.
7. I have reviewed the information being submitted and that to the best of my knowledge the information is true and accurate.
8. I understand that the willful submission of falsified or misrepresented information to the New Hampshire Department of Environmental Services is a criminal act, which may result in legal action.
9. I am aware that the work I am proposing may require additional state, local or federal permits.
10. The mailing addresses I have provided are up to date and appropriate for receipt of DES correspondence. DES will not forward returned mail.



Signature of Applicant _____ Zachary Taylor _____ 2/15/13
 Print name legibly _____ Date

Signature of Authorized Agent (if applicable) _____ Print name legibly _____ Date

20. ELECTRONIC COMMUNICATION:

By initialing here, I the applicant or authorized agent in accordance with RSA 482-A:3, XIV (b), hereby authorize DES to communicate all matters relative to this application electronically with the individual's email addresses provided on pg. 1 of the application:

ZI

21. CONSERVATION COMMISSION SIGNATURE REQUIRED FOR EXPEDITED APPLICATIONS ONLY:

Expedited Applications ONLY require that the Conservation Commission signature is obtained prior to submitting the final application to the Town/City Clerk for signature and mailing to the NHDES Wetlands Bureau. *The Conservation Commission is not required to sign. If the Conservation Commission does not sign this statement for any reason, then the application is not eligible for expedited review and shall be reviewed in the standard review time.*

The signature below certifies that the municipal conservation commission has reviewed this application, and: 1) waives its right to intervene per RSA 482-A:11; 2) believes that the application and submitted plans accurately represent the proposed project; and 3) has no objection to permitting the proposed work.

Authorized Commission Signature

Print name legibly

Date

22. APPLICATION SUBMITTAL:

APPLICANT:

1. If sought, obtain the Conservation Commissions signature as outlined above on this page, no. 21;
2. Submit the original application form and materials, four copies, application fee check and any required municipal fees (authorized by RSA 482-A:3,I) to the town/city clerk.

TOWN/CITY CLERK:

Per RSA 482-A:3,I(d):

1. Collect from the applicant the postal receipts demonstrating that all abutters and the Local Advisory Committee were sent proper notice;
2. Immediately sign the original application and four copies in the signature space provided on this pg. no. 23 below;
3. Retain one copy of the application form and all attachments that will remain with the town/city clerk and will be made reasonably accessible to the public;
4. Immediately distribute a copy of the application with attachments to the municipal Conservation Commission, the local governing body (Board of Selectmen or Town/City Council), and the Planning Board in accordance with RSA 482-A:3, I; and
5. IMMEDIATELY send the original application materials and filing fee, by CERTIFIED MAIL to the NHDES Wetlands Bureau at the address indicated on the front of this application.

23. TOWN/CITY CLERK SIGNATURE REQUIRED FOR ALL APPLICATIONS:

I hereby certify that the applicant has filed five application forms, five detailed plans, and five USGS location maps with the town/city indicated below. As required by Chapter 482-A:3 (amended 1991), and I have received and retained certified postal receipts (or copies) for all abutters identified by the applicant.

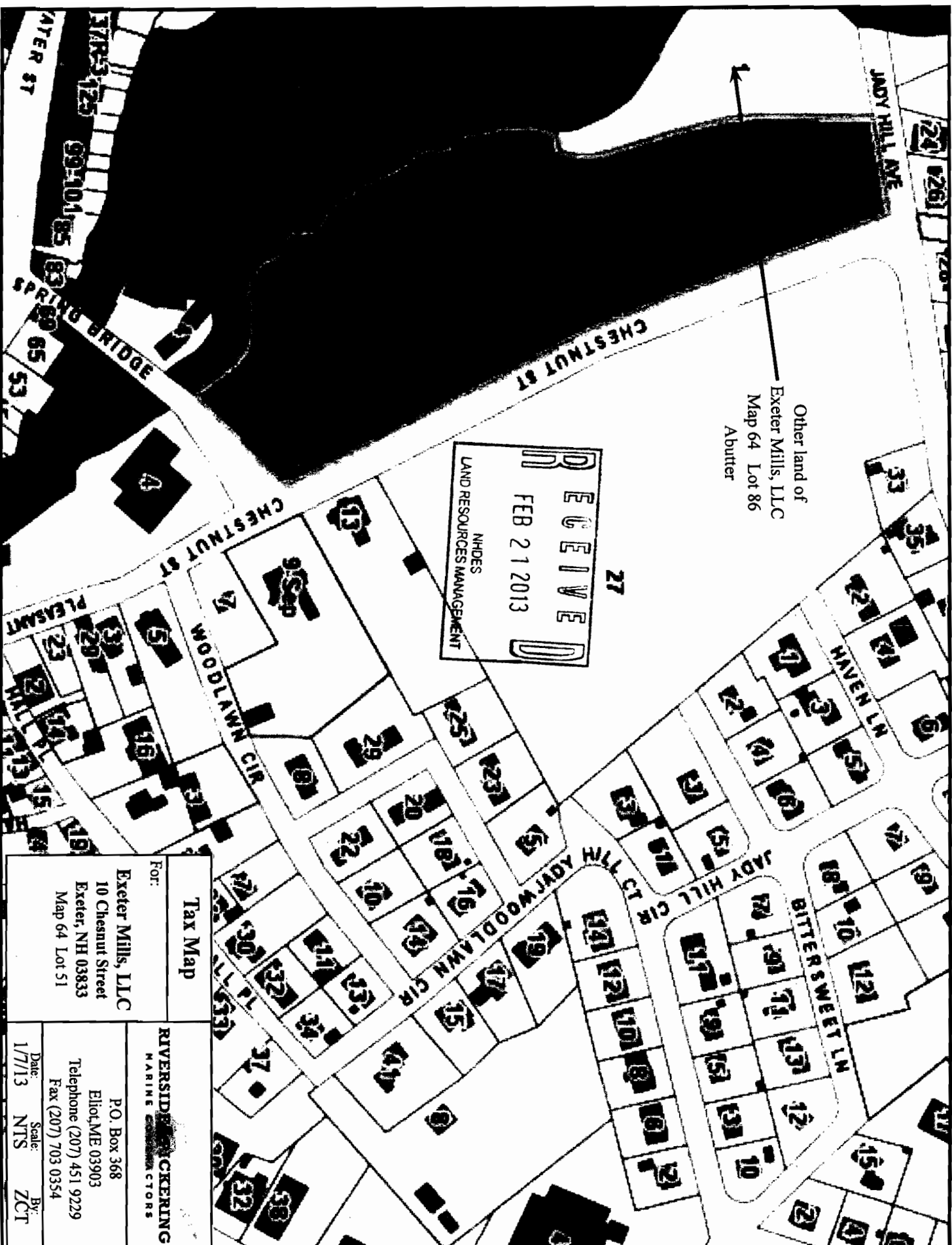

Other land of
Exeter Mills, LLC
Map 64 Lot 86
Abutter

RECEIVED
FEB 21 2013
NHDES
LAND RESOURCES MANAGEMENT

Tax Map	
For: Exeter Mills, LLC 10 Chesnut Street Exeter, NH 03833 Map 64 Lot 51	
RIVERSIDE ENGINEERING MARINE CONTRACTORS	
P.O. Box 368 Elliot, ME 03903 Telephone (207) 451 9229 Fax (207) 703 0354	Date: 1/7/13 Scale: NTS By: ZCT

(EPPING)

070° 58' 05.71" W
043° 00' 23.28" N

(NEWMARKET)

EXETER QUADRANGLE
NEW HAMPSHIRE
TOPOGRAPHIC SERIES

(KITTERY)

070° 55' 24.03" W
043° 00' 23.28" N

(KINGSTON)

(Unavailable)



042° 57' 35.86" N
070° 58' 05.71" W

(NEWBURYPORT)
SCALE 1:24000

042° 57' 35.86" N

(HAVERHILL)

Produced by MyTopo Terrain Navigator
Topography based on USGS 1:24,000
Maps

North American 1983 Datum (NAD83)
Universal Transverse Mercator Projection

To place on the predicted North American
1927 move the projection lines 10M N and
41M E

Declination



GN 1.32° W
MN 15.33° W

CONTOUR INTERVAL 3 ME
NATIONAL GEODETIC VERTICAL

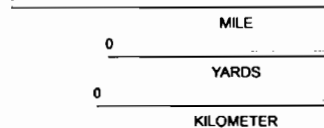

Site Map

For:

Exeter Mills, LLC
10-20 Chestnut Street
Exeter, NH 03833
Map 64 Lot 51

RIVERSIDE & JACKERING
MARINE CONTRACTORS

P.O. Box 368
Eliot, ME 03903
Telephone (207) 451 9229
Fax (207) 703 0354

Date: 12/17/12 Scale: NTS By: ZCT

FEB 21 2013
 NHDES
 LAND RESOURCES MANAGEMENT



NEW HAMPSHIRE NATURAL HERITAGE BUREAU

DRED - DIVISION OF FORESTS & LANDS

PO Box 1856 - 172 PEMBROKE ROAD, CONCORD, NH 03302-1856
(603) 271-2214

To: Zachary Taylor, Riverside and Pickering Marine Contractors
Allen Folsom, Riverside and Pickering Marine Contractors

From: Melissa Coppola, NHB-Environmental Information Specialist

Date: January 23, 2013

Subject: NHB12-3784

This memo is a follow-up to NHB12-3784 which had indicated three state-listed plant species in the vicinity of the proposed project. The Natural Heritage Bureau (NHB) requested further details about the project to: 1) determine the potential for impacts and 2) provide appropriate recommendations to avoid impacts if necessary.

NHB is recommending a survey for the spongy-leaved arrowhead (*Sagittaria montevidensis* ssp. *spongiosa*) during the growing season because this species has been documented within the brackish marsh at this location. NHB can conduct this survey in late-May or early June and then provide recommendations on how to avoid and minimize impacts to this state-endangered species. Any survey conducted outside of the growing season cannot truly confirm the presence or absence of this species on site. NHB is willing to work with the landowner and consultants to help the project continue to move forward, while reducing impacts to rare plant species.

Should you have any further questions, contact me at 603-271-2215 ext. 323 or at Melissa.Coppola@dred.state.nh.us.

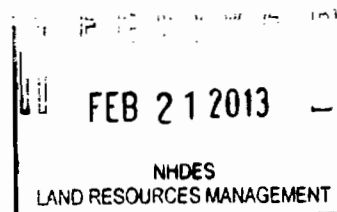

Memo

To: Zachary Taylor
P.O. Box 368
Eliot, ME 03903

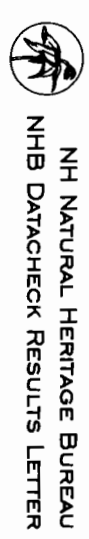
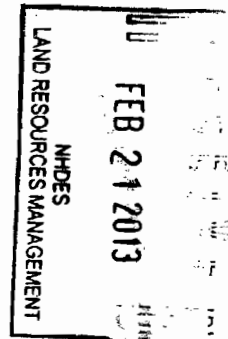

NH NATURAL HERITAGE BUREAU
NHB DATACHECK RESULTS LETTER

From: Melissa Coppola, NH Natural Heritage Bureau
Date: 12/19/2012 (valid for one year from this date)
Re: Review by NH Natural Heritage Bureau
NHB File ID: NHB12-3784
Description: Construct a 6'x20' fixed pier with a 4'x30' aluminum gangway landing on a 10'x20' float system located on moorings
cc: Kim Tuttle
Town: Exeter
Location: Tax Maps: 64-51

As requested, I have searched our database for records of rare species and exemplary natural communities, with the following results.

Comments:

Plant species

Plant species	State ¹	Federal	Notes
climbing hempvine (<i>Mikania scandens</i>)*	E	--	Threats include changes to the hydrology (e.g., water levels) of its habitat and increased sedimentation or nutrients and pollutants in stormwater runoff.
little-headed spikesedge (<i>Eleocharis parvula</i>)	T	--	Threats are primarily alterations to the hydrology of the wetland, such as ditching or tidal restrictions that might affect the sheet flow of tidal waters across the intertidal flat, activities that eliminate plants, and increased input of nutrients and pollutants in storm runoff.
Spongy-leaved Arrowhead (<i>Sagittaria montevdensis</i> ssp. <i>spongiosa</i>)	E	--	Primarily vulnerable to changes to the hydrology of its habitat, especially alterations that change water levels. It may also be susceptible to increased pollutants and nutrients carried in stormwater runoff.

Vertebrate species

Vertebrate species	State ¹	Federal	Notes
Common Moorhen (<i>Gallinula chloropus</i>)	SC	--	Contact the NH Fish & Game Dept (see below).
Osprey (<i>Pandion haliaetus</i>)	SC	--	Contact the NH Fish & Game Dept (see below).
Pied-billed Grebe (<i>Podilymbus podiceps</i>)	T	--	Contact the NH Fish & Game Dept (see below).
Sora (<i>Porzana carolina</i>)	SC	--	Contact the NH Fish & Game Dept (see below).

¹Codes: "E" = Endangered, "T" = Threatened, "--" = an exemplary natural community, or a rare species tracked by NH Natural Heritage that has not yet been added to the official state list. An asterisk (*) indicates that the most recent report for that occurrence was more than 20 years ago.

Contact for all animal reviews: Kim Tuttle, NH F&G, (603) 271-6544.

Memo



NH NATURAL HERITAGE BUREAU
NHB DATACHECK RESULTS LETTER

A negative result (no record in our database) does not mean that a sensitive species is not present. Our data can only tell you of known occurrences, based on information gathered by qualified biologists and reported to our office. However, many areas have never been surveyed, or have only been surveyed for certain species. An on-site survey would provide better information on what species and communities are indeed present.

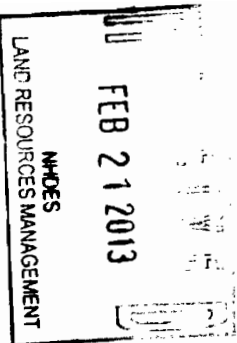

Department of Resources and Economic Development
Division of Forests and Lands
(603) 271-2214 fax: 271-6488

DRED/NHB
PO Box 1856
Concord NH 03302-1856

NHB12-3784



NH NATURAL HERITAGE BUREAU

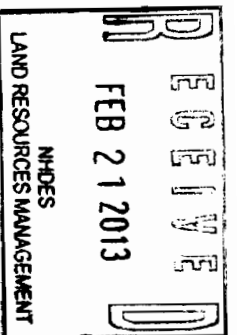

Known locations of rare species and exemplary natural communities

Note: Mapped locations are not always exact. Occurrences that are not in the vicinity of the project are not shown.

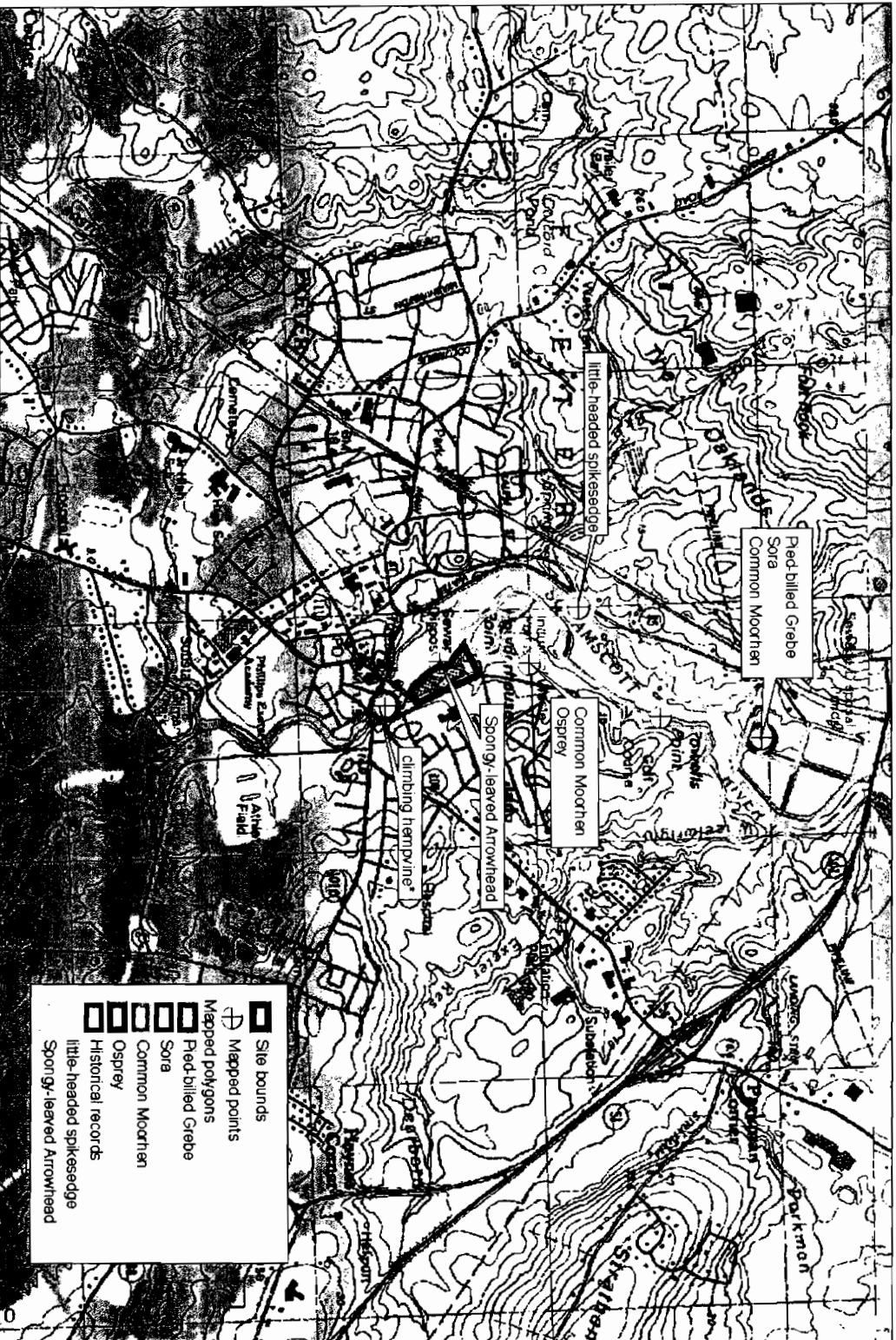

*Historical record

U.S. Postal Service
CERTIFIED MAIL RECEIPT
(Domestic Mail Only; No Insurance Coverage Provided)

For delivery information visit our website at www.usps.com.

EXETER NH 03833 **OFFICIAL USE**

Postage	\$ 00.46	0903 03 Postmark Here
Certified Fee	\$3.10	
Return Receipt Fee (Endorsement Required)	\$2.55	
Restricted Delivery Fee (Endorsement Required)	\$0.00	
Total	\$6.11	

7011 2000 0001 7751 9748

Exeter Mills, LLC
 10-20 Chestnut Street
 Exeter, NH 03833

U.S. Postal Service
CERTIFIED MAIL RECEIPT
(Domestic Mail Only; No Insurance Coverage Provided)

For delivery information visit our website at www.usps.com.

EXETER NH 03833 **OFFICIAL USE**

Postage	\$ 01.52	0903 03 Postmark Here
Certified Fee	\$3.10	
Return Receipt Fee (Endorsement Required)	\$2.55	
Restricted Delivery Fee (Endorsement Required)	\$0.00	
Total Postage & Fees	\$7.17	

7011 2000 0001 7751 9748

Exeter River Local Advisory Committee
 Donald Clement, Chair
 c/o Theresa Walker, RPC
 156 Water Street
 Exeter, NH 03833

02/19/2013

FEB 21 2013
 NHDES
 LAND RESOURCES MANAGEMENT

Abutter Notifications	
For: Exeter Mills, LLC 10-20 Chestnut Street Exeter, NH 03833 Map 64 Lot 51	RIVERSIDE & PICKERING MARINE CONTRACTORS P.O. Box 368 Eliot, ME 03903 Telephone (207) 451 9229 Fax (207) 703 0354

PLAN REFERENCES
 1. PLAN ENTITLED "EXISTING CONDITIONS PLAN" FOR GUARDIAN LIFE INSURANCE COMPANY OF AMERICA PREPARED BY CAMMETT ENGINEERING, AMESBURY, MA. REVISED 6-5-2012.



RECEIVED
 JUL 18 2013
 NHDES
 LAND RESOURCES MANAGEMENT

LEGEND

	SPARSE-leaved Arrowhead (<i>Sagittaria montivardensis</i> ssp. <i>spongiosa</i>)
	DENSE-leaved Arrowhead (<i>Sagittaria montivardensis</i> ssp. <i>spongiosa</i>)
	EMERGENT VEG (E2EM1)
	APPRX. MHW
	LAWN

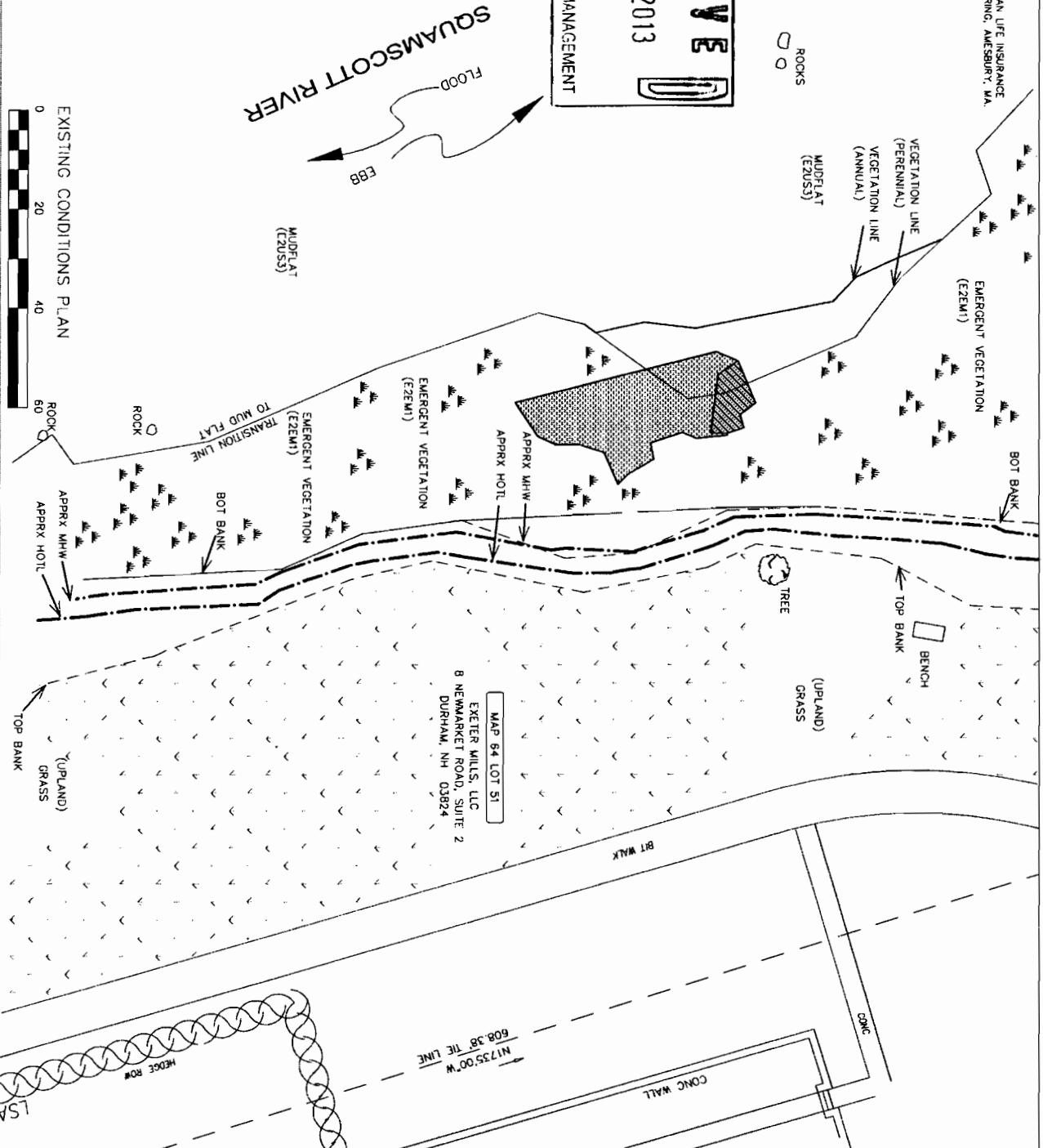

REVISIONS	
Date	Description
7/3/13	LOCATED NHB SPECIES, ADJUST PIER LOCATION AND GANGWAY LENGTH

RIVERSIDE & TICKERING
 MARINE CONTRACTORS

EXETER MILLS, LLC.
PROPOSED PIER AND FLOAT

Date: 1/30/2013
 Drawn By: APF
 Checked By: ZCT

Address: 10 CHESTNUT STREET City: EXETER, NH Approved: _____ Date: _____
 Map & Lot #: MAP 64 LOT 51 Drawing Scale: 1"=20' Title: _____ Job Class: _____

Sheet 1 of 3

PLAN REFERENCES
 1. PLAN ENTITLED "EXISTING CONDITIONS PLAN" FOR GUARDIAN LIFE INSURANCE COMPANY OF AMERICA PREPARED BY CAMELLET ENGINEERING, AMESBURY, MA. REVISED 6-5-2012.



PER REF # 1

LEGEND

- PROPOSED DOCK
- SPARSE Spogy-leaved Arrowhead (Sagittaria montevidensis ssp. spongiosa)
- DENSE Spogy-leaved Arrowhead (Sagittaria montevidensis ssp. spongiosa)
- EMERGENT VEG (E2EM1)
- APPRX HOTL MHW, MLW
- LAWN

EXETER
 JUL 18 2013
 NHDES
 LAND RESOURCES MANAGEMENT

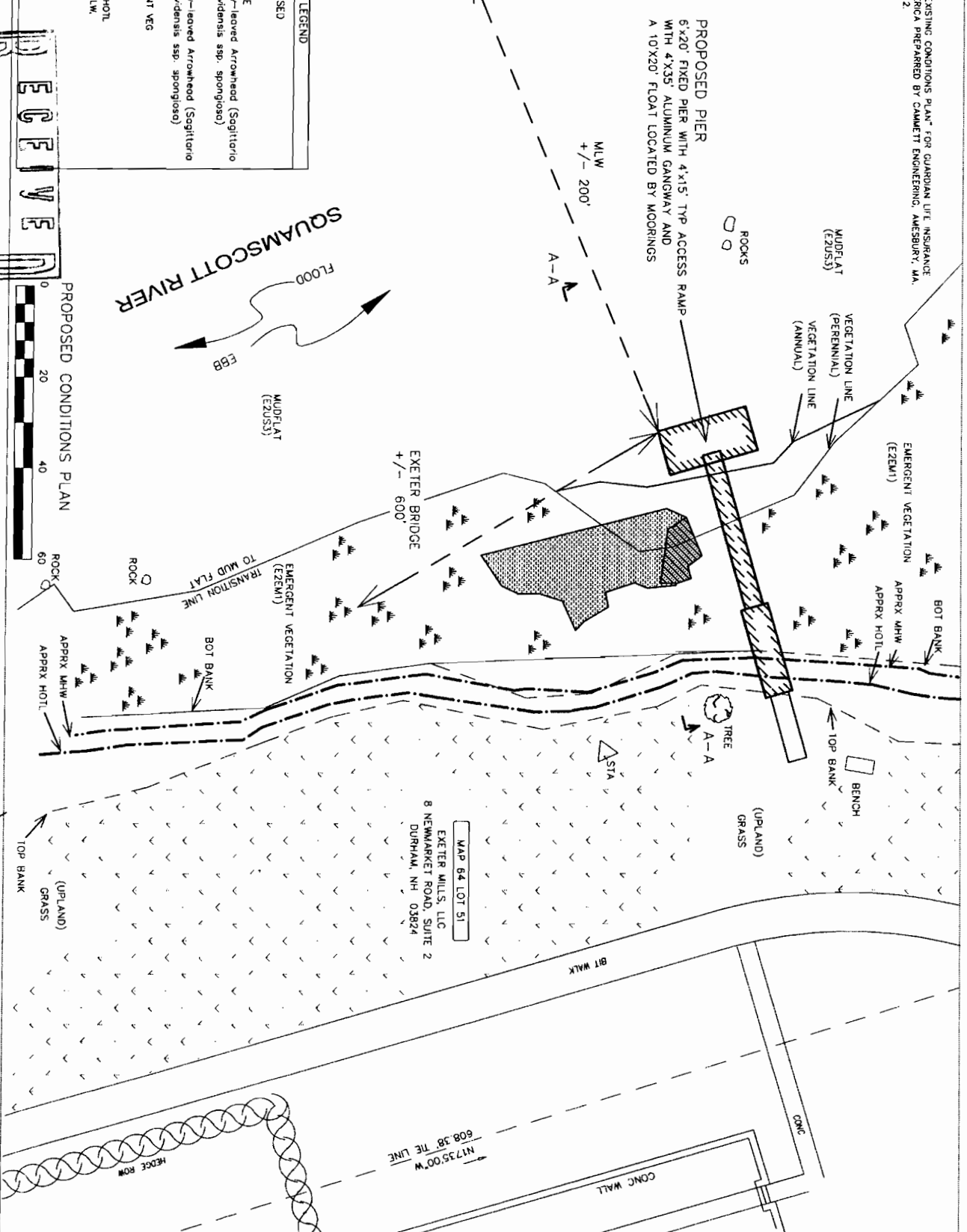
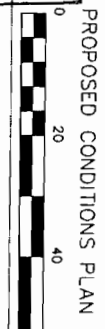

REVISIONS	
Date	Description
7/5/13	LOCATED NHD SPECIES, ADJUST PIER LOCATION AND GANGWAY LENGTH

RIVERSIDE TICKERING
 MARINE CONTRACTORS

EXETER MILLS, LLC.
 PROPOSED PIER AND FLOAT

Address: 10 CHESTNUT STREET City: EXETER, NH

Map & Lot #: MAP 64 LOT 51 Drawing Scale: 1" = 20'

Date: 1/30/2013
 Drawn By: APF
 Checked By: ZCT

Approved: _____ Date: _____
 Title: _____ Job Desc: _____

File # 623-12
 Sheet 2 of 3

NOTES

- 1) THE FLOAT WILL BE DRY AT LOW TIDE. FLOAT WILL BE SUPPORTED BY SKIDS
- 2) ALL PILINGS AND STRUCTURAL TIMBER WILL BE PRESSURE TREATED SYP.
- 3) GANGWAY WILL BE MADE OF ALUMINUM WITH RUBBER NON-SKID DECKING.
- 4) THE PROPOSED STRUCTURE WILL BE BUILT TO INDUSTRY STANDARDS WITH A 1 FOOT TO 1 FOOT RATIO OF PIER WIDTH TO DISTANCE FROM THE BOTTOM OF THE LONGITUDINAL SUPPORTS ABOVE THE SUBSTRATE INHABITING WETLANDS VEGETATION. DECKING WILL HAVE A 3/4" GAP BETWEEN THE DECK BOARDS AS WELL. BOTH OF THESE MEASURES WILL HELP PROMOTE THE AMBIENT LIGHT LEVELS UNDER THE FIXED PIER.

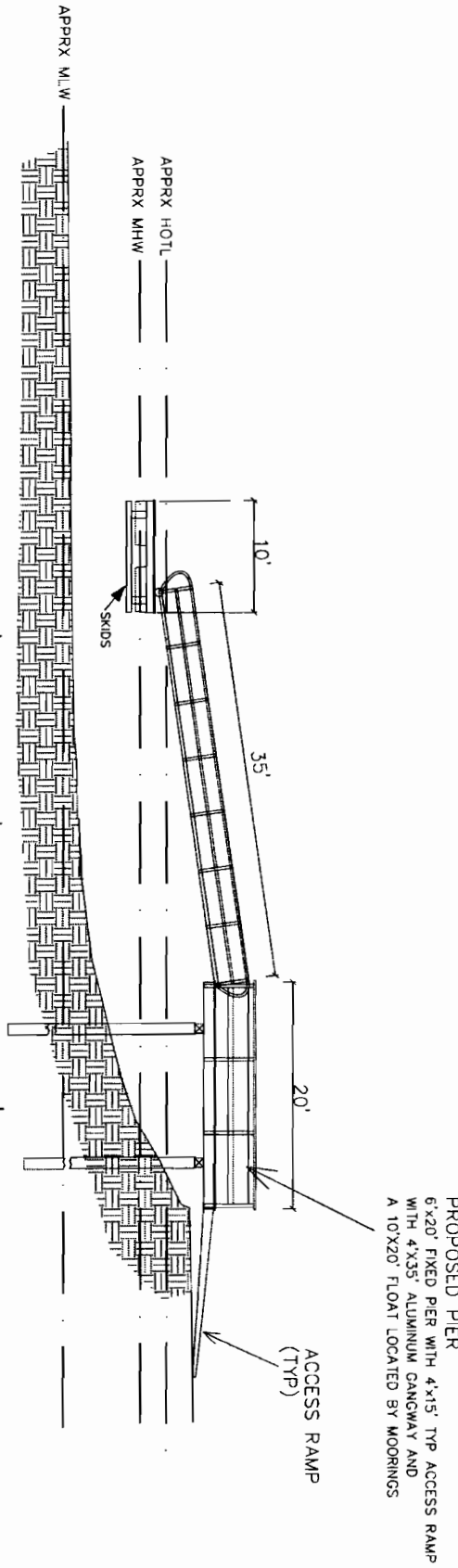

MUDFLAT (E2US3)

EMERGENT VEG. (ANNUAL) (E2EM1)

EMERGENT VEG. S. ALTERNIFLORA (PERENNIAL) (E2EM1)

UPLAND



REGISTERED

JUL 18 2013

NHDES

LAND RESOURCES MANAGEMENT

REVISIONS Date: 7/5/13 Description: LOCATED NEW SPECIES, ADJUST PIER LOCATION AND GANGWAY LENGTH		EXETER MILLS, LLC. PROPOSED PIER AND FLOAT		Date: 1/30/2013 Drawn By: APF Checked By: ZCT
		Address: 10 CHESTNUT STREET City: EXETER, NH	Approved: _____ Date: _____	Map & Lot #: MAP 64 LOT 51 Drawing Scale: 1"=10' Title: _____ Job Class: _____
File #: 623-12 Sheet 3 of 3				